

10 9 8 7 6 5 4 3 2 1

F
E
D
C
B
A

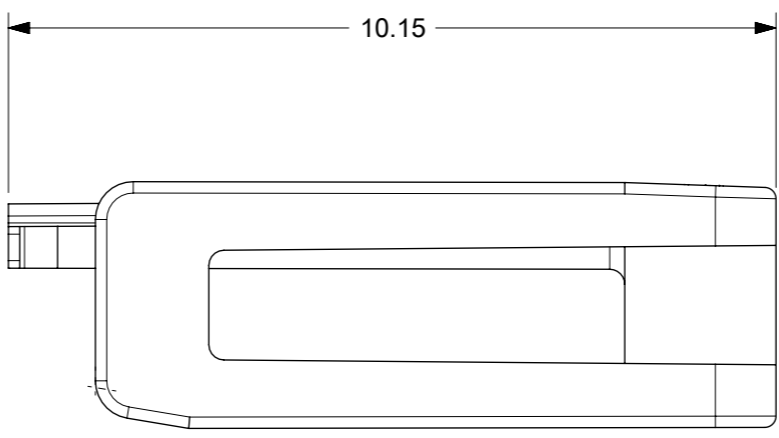
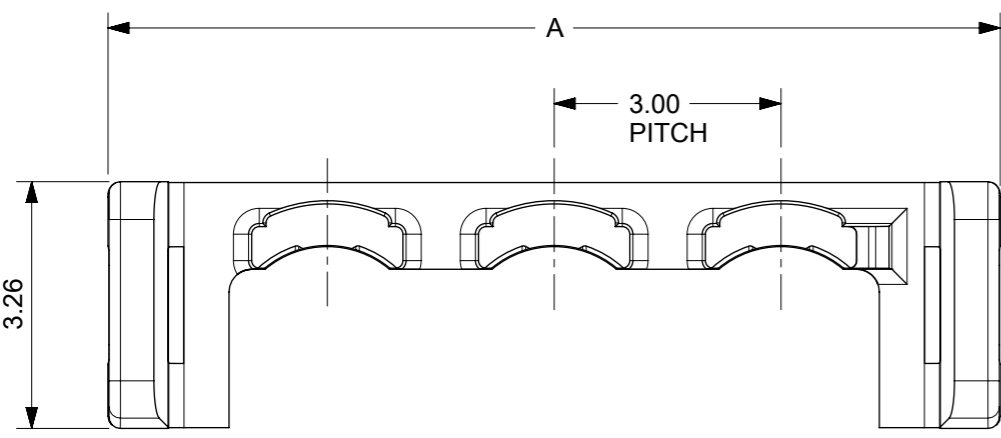
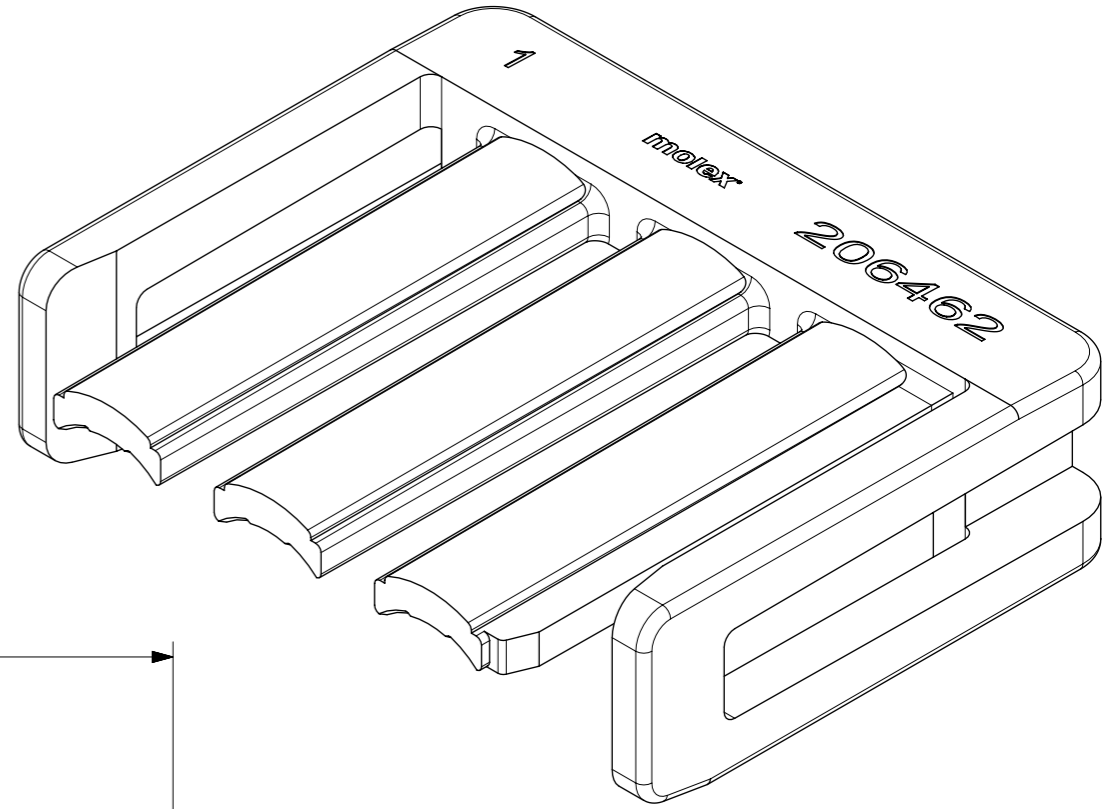

| PART NO. | | CKT | A | NOTE |
|--------------|--------------|-----|-------|-------------------------------|
| MATERIAL "0" | MATERIAL "1" | | | |
| 2064620100 | 2064620110 | 1 | 5.80 | *DESIGNATES PART NOT RELEASED |
| 2064620200 | 2064620210 | 2 | 8.80 | |
| 2064620300 | 2064620310 | 3 | 11.80 | |
| 2064620400 | 2064620410 | 4 | 14.80 | |
| 2064620500 | 2064620510* | 5 | 17.80 | |
| 2064620600 | 2064620610* | 6 | 20.80 | |
| 2064620700 | 2064620710* | 7 | 23.80 | |
| 2064620800 | 2064620810* | 8 | 26.80 | |
| 2064620900 | 2064620910* | 9 | 29.80 | |
| 2064621000 | 2064621010* | 10 | 32.80 | |
| 2064621100 | 2064621110* | 11 | 35.80 | |
| 2064621200 | 2064621210* | 12 | 38.80 | |

- NOTES:**
- MATERIAL:**
 "0": NYLON, UL 94V-0, GLOW-WIRE CAPABLE, COLOR: NATURAL
 "1": NYLON, UL 94V-0, LOW HALOGEN, COLOR: NATURAL
 - THESE PARTS ARE USED WITH 206461 HOUSING SERIES
 - SHALL CONFIRM TO PRODUCT SPECIFICATION : 2064600000-PS
 - COMPLY WITH PACKAGING SPECIFICATION : 2064620000-PK
 - COSMETIC SPECIFICATION: PS-45499-002 CLASS B.

| | | | | | | | | | |
|---|--|------------------------|--|-------------------------------|--|--------------|--|-----------------------------|--|
| THIS DRAWING CONTAINS INFORMATION THAT IS PROPRIETARY TO MOLEX ELECTRONIC TECHNOLOGIES, LLC AND SHOULD NOT BE USED WITHOUT WRITTEN PERMISSION | | | | | | | | | |
| DIMENSION UNITS | | SCALE | | CURRENT REV DESC: | | | | molex | |
| mm | | NTS | | | | | | | |
| GENERAL TOLERANCES (UNLESS SPECIFIED) | | | | EC NO: 722782 | | | | TPA MICRO-FIT + SOLUTION | |
| ANGULAR TOL ± 0.5 ° | | | | DRWN: ZIXUAQ 2022/07/08 | | | | | |
| 4 PLACES ± | | | | CHK'D: XQZHANG 2022/09/28 | | | | PRODUCT CUSTOMER DRAWING | |
| 3 PLACES ± | | | | APPR: XQZHANG 2022/09/28 | | | | | |
| 2 PLACES ± 0.25 | | | | INITIAL REVISION: | | | | DOCUMENT NUMBER | |
| 1 PLACE ± 0.35 | | | | DRWN: SMAHAJANSHET 2018/05/08 | | | | 2064620000-SD | |
| 0 PLACES ± | | | | APPR: NCSR 2019/04/02 | | | | DOC TYPE DOC PART REVISION | |
| DRAFT WHERE APPLICABLE MUST REMAIN WITHIN DIMENSIONS | | THIRD ANGLE PROJECTION | | DRAWING | | SERIES | | MATERIAL NUMBER | |
| | | | | A3-SIZE | | 206462 | | CUSTOMER | |
| | | | | | | SEE TABLE | | GENERAL MARKET | |
| | | | | | | SHEET NUMBER | | 1 OF 1 | |

9 8 7 6 5 4 3 2 1