

HF
Halogen Free

LF

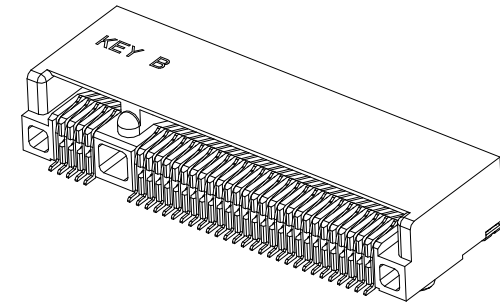
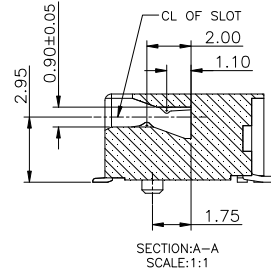
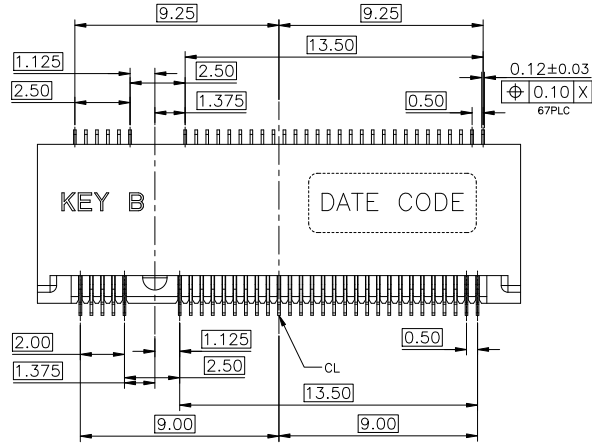

NOTES:

- MATERIAL:
 - HOUSING:HIGH TEMPERATURE THERMOPLASTIC,UL94V-0,COLOR:BLACK.
 - CONTACT:COPPER ALLOY.
 - SOLDER PEG:STAINLESS STEEL.
- FINISH:
 - CONTACT:
 - UNDERPLATING NICKEL 50u" MIN OVERALL
 - MATING AREA:GOLD PLATING,THICKNESS SEE TABLE
 - SOLDER AREA:GOLD FLASH 1u"MIN.
 - SOLDER PEG:
 - UNDERPLATING NICKEL 50u" MIN OVERALL
 - 80u"MIN MATTE TIN ON SURFACE
- DATE CODE : YYWDX
 - YY: YEAR (09: 2009)
 - WW: WEEK (25: THE 25TH WEEK)
 - D: DAY (1~7: SUNDAY~SATURDAY)
 - L: LINE NUMBER OF ASSEMBLY (A: LINE A)
 - X: D OR N (D: DAY; N: NIGHT)
- PRODUCT SPECIFICATION SEE FCI GS-12-1195
- PART NUMBER DESCRIPTION: 10128793-00XRFL

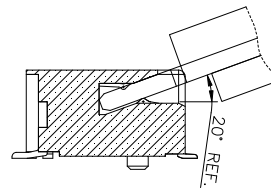
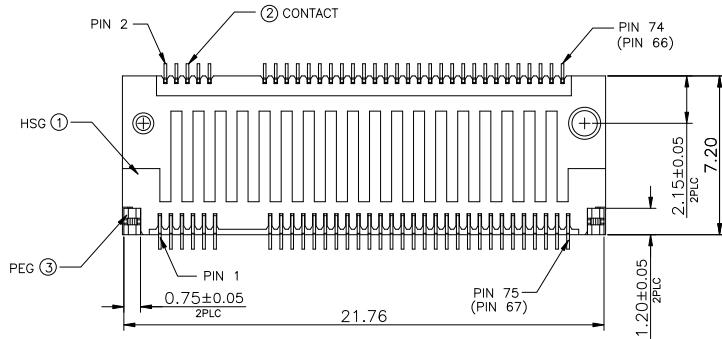
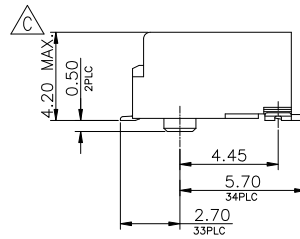
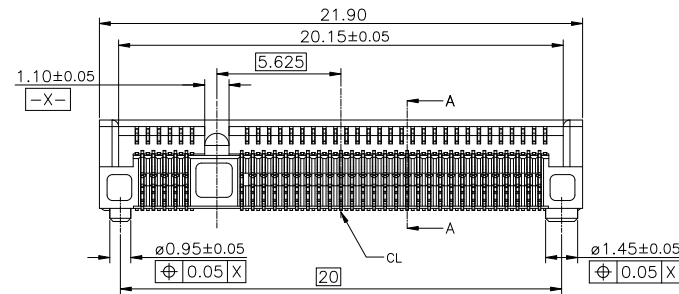

- LF:LEAD FREE & RoHS COMPLIANCE
- PACKAGE CODE: R: TAPE & REEL PACKING
- PLATING CODE:
 - GOLD FLASH ON CONTACT AREA
 - 15u"Min GOLD ON CONTACT AREA
 - 30u"Min GOLD ON CONTACT AREA

| mat'l. code | | | | surface | tolerance | projection | product family |
|-------------|----------------|-----|------------|---------------------------------------|------------|------------|---|
| ltr | ecn no | dr | date | tolerances unless otherwise specified | | | title |
| A | | BF | 2013-04-18 | angles | .X ±0.3 | mm | |
| B | ELX-T-19318 | TAI | 2014-11-10 | 0 | .XX ±0.25 | scale | M.2 CONNECTOR 4.2H_STD_KEY B |
| C | ELX-T-20858 | TAI | 2015-05-11 | X*±2* | .XXX ±0.05 | | |
| | | | | dr | BEER FU | 2013-05-02 | dwg no sheet 1 of 3 size 10128793 A4 type Customer Drawing |
| | | | | enrg | BEER FU | 2013-05-02 | |
| | | | | chr | BEER FU | 2013-05-02 | |
| | | | | appd | BEER FU | 2013-05-02 | |
| sheet index | revision sheet | C | C | C | | | |
| | | 1 | 2 | 3 | | | |

| | |
|--------------|-----------------|
| 30u" Au | 10128793-005RLF |
| 15u" Au | 10128793-004RLF |
| GOLD FLASH | 10128793-001RLF |
| CONTACT AREA | FCI P/N |



HF
Halogen Free



PLUG PCB

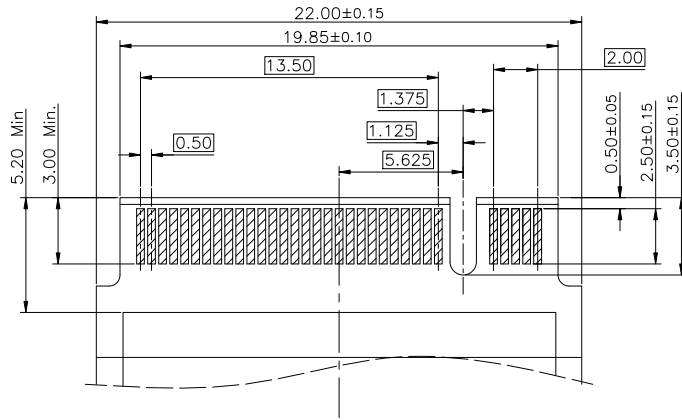

BOTTOM SIDE

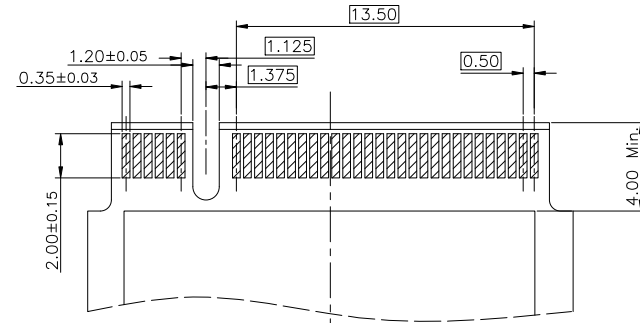
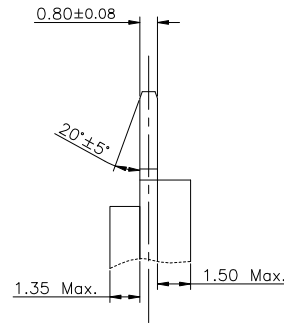

TOP SIDE

RECOMMENDED PCB LAYOUT

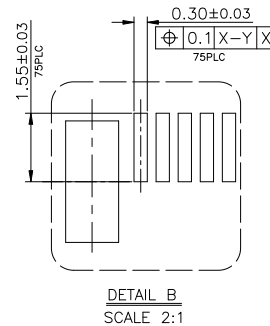
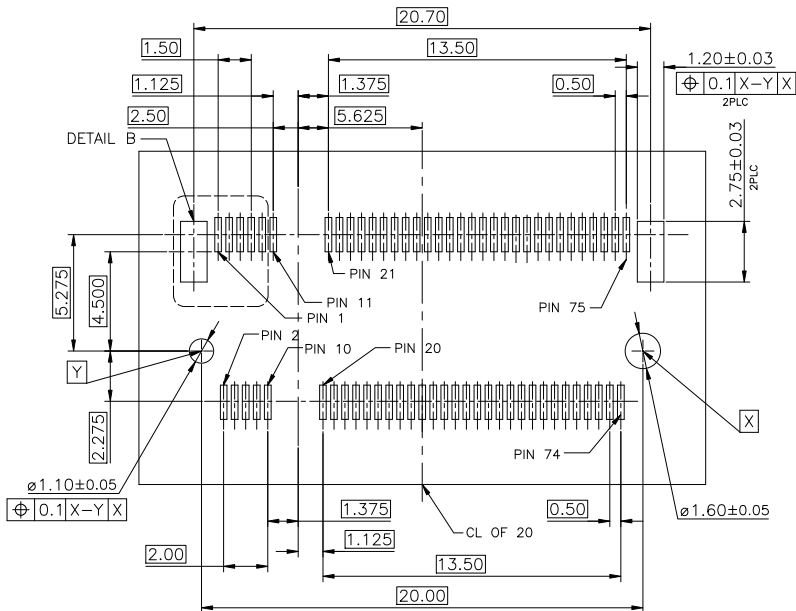

| | | | |
|--|----------|------------------|------|
| | dwg no | sheet 2 of 3 | size |
| | 10128793 | | A4 |
| | type | Customer Drawing | |

| | | | | | | | | | | | | | | | | | | | |
|-------------|----------------|-----|-----|-----|--|--|--|--|--|--|--|--|--|--|--|--|--|--|--|
| sheet index | revision sheet | C 1 | C 2 | C 3 | | | | | | | | | | | | | | | |
|-------------|----------------|-----|-----|-----|--|--|--|--|--|--|--|--|--|--|--|--|--|--|--|

HF
Halogen Free



FEEDING DIRECTION →

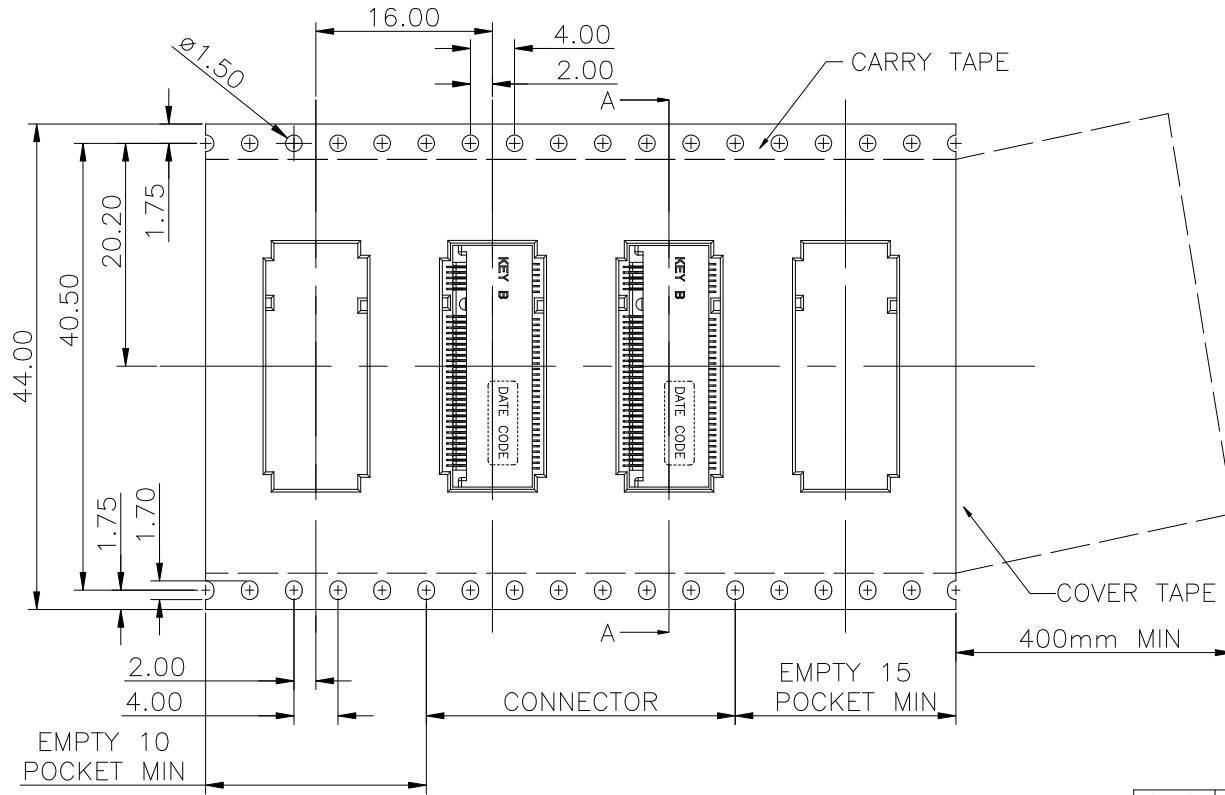
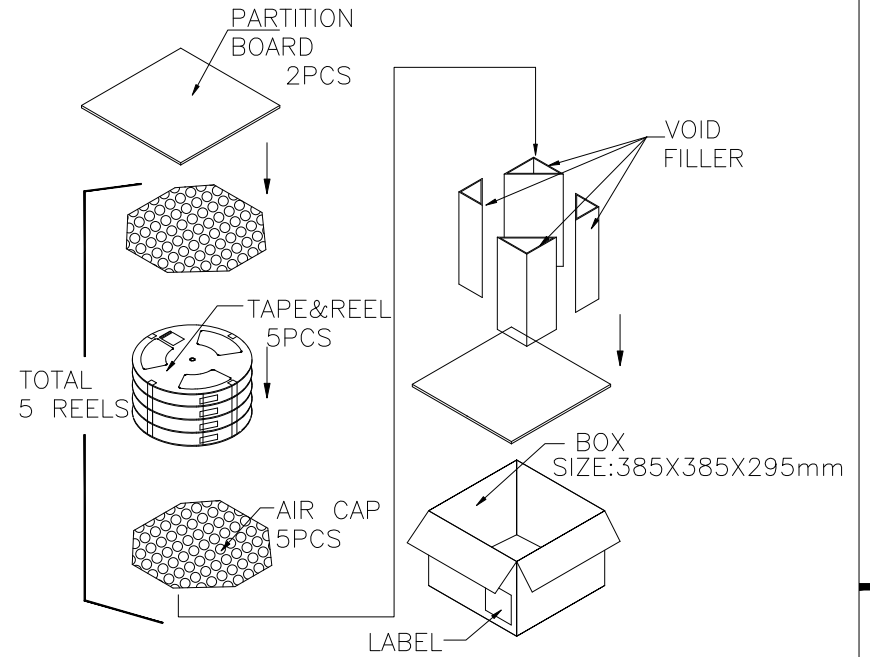
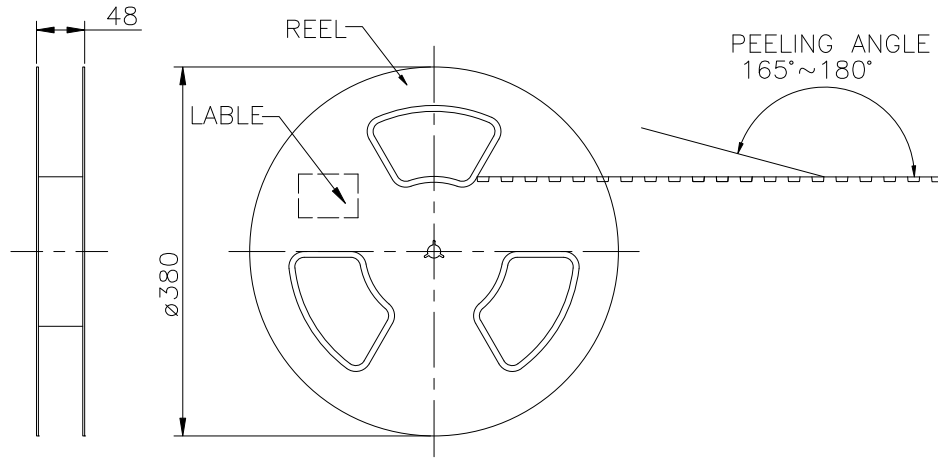

| | | | | |
|----------|-----------|---------|--------------|------------|
| 1100 | 5 | 5500 | 10.33Kg | 5.53Kg |
| PCS/TAPE | REELS/BOX | PCS/BOX | GROSS WEIGHT | NET WEIGHT |

| | | | |
|--|-----------------------|--------------|------|
| | dwg no | sheet 3 of 3 | size |
| | 10128793 | | A4 |
| | type Customer Drawing | | |

| | | | | | | | | | | | | | | | | | | | |
|-------------|----------------|-----|-----|-----|--|--|--|--|--|--|--|--|--|--|--|--|--|--|--|
| sheet index | revision sheet | C 1 | C 2 | C 3 | | | | | | | | | | | | | | | |
|-------------|----------------|-----|-----|-----|--|--|--|--|--|--|--|--|--|--|--|--|--|--|--|