

SECTION Y-Y

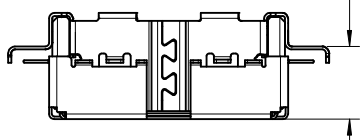

(SEE SHEET2 FOR  
DETAIL DIMENSION)

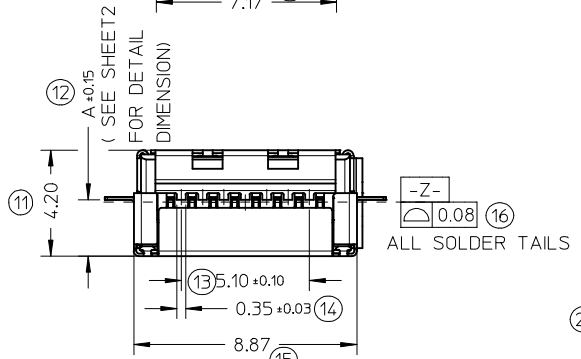
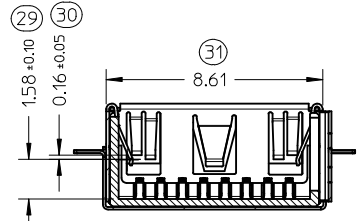

SECTION Z-Z

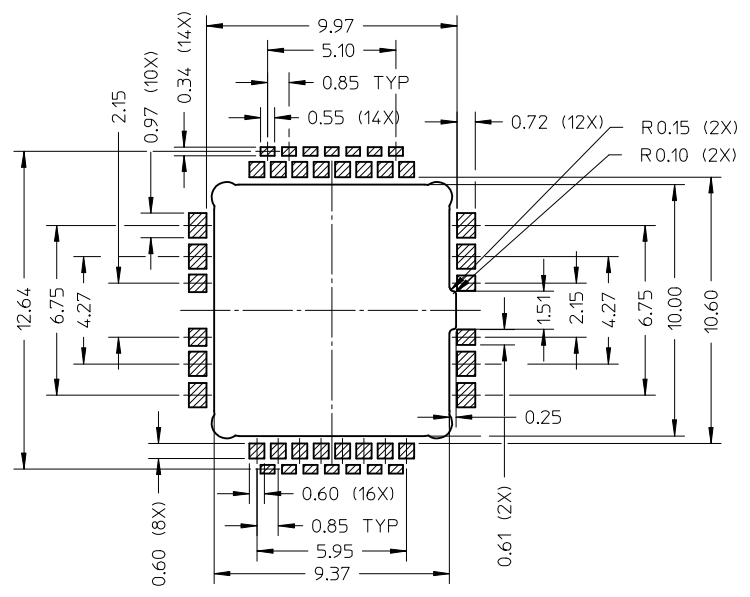

RECOMMEND PWB LAYOUT  
GENERAL TOLERANCE 0.05mm

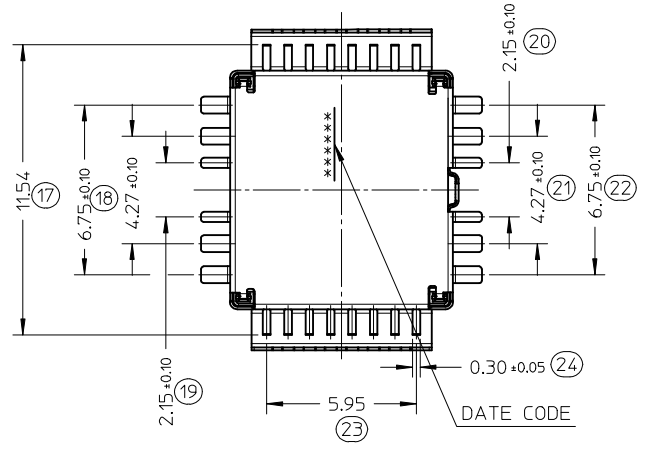

RELEASED EC NO: SH2013-076 DRWN: WJHUO 2012/12/10 CHYD: APPR: AYIN 2013/01/08	QUALITY SYMBOLS DESCRIPTION	GENERAL TOLERANCES (UNLESS SPECIFIED)		DIMENSION STYLE MM ONLY		SCALE 5:1	DESIGN UNITS METRIC	THIRD ANGLE PROJECTION		
				DRAWN BY WJHUO	DATE 2012/12/10	TITLE SMIA75++ CAMERA SOCKET THROUGH BOARD 16 PIN BOTTOM CONTACT				
				CHECKED BY	DATE	APPROVED BY AYIN				
				APPROVED BY AYIN	DATE 2013/01/08	MATERIAL NO. SEE TABLE				
		DRAFT WHERE APPLICABLE MUST REMAIN WITHIN DIMENSIONS		SIZE A3		DOCUMENT NO. SD-105168-001			SHEET NO. 1 OF 2	



10 9 8 7 6 5 4 3 2 1

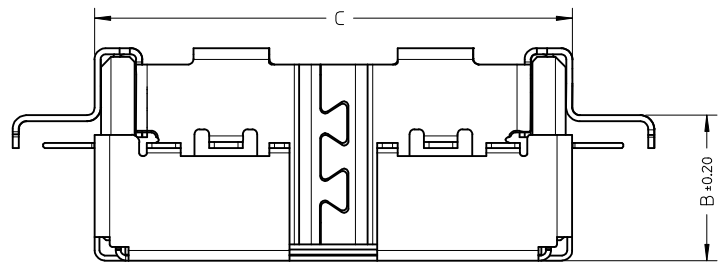
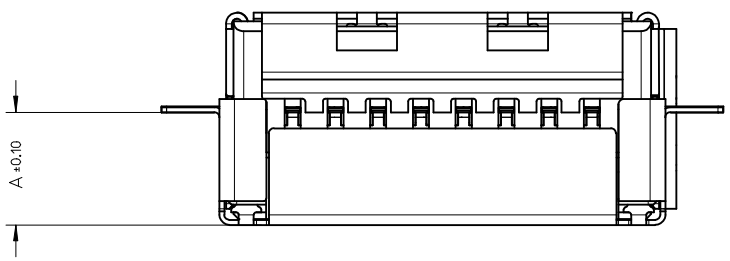

1051680301	3.00	3.67	9.50
1051680601	2.90	3.57	9.50
1051680201	2.80	3.47	9.50
1051680501	2.70	3.37	9.50
1051680101	2.60	3.27	9.50
1051680091	2.40	3.07	9.50
1051680081	2.20	2.87	9.50
1051680071	2.00	2.69	9.90
1051680061	1.80	2.49	9.90
1051680051	1.60	2.29	9.90
1051680041	1.40	2.09	9.90
1051680031	1.20	1.89	9.90
1051680021	1.00	1.69	9.90
1051680011	0.80	1.49	9.90
1051680001	0.60	1.29	9.90
1051680401	0.50	1.29	9.90
PART NO.	DIM. A	DIM. B	DIM. C

NOTES:

- 1.MATERIA:
  - HOUSING: HIGH-TEMP THERMAL PLASTIC BLACK, UL94 V-0
  - TERMINAL: COPPER ALLOY, THICKNESS:0.10MM.
  - MAIN SHEL: COPPER ALLOY, THICKNESS:0.12MM
  - BOTTOM SHELL: COPPER ALLOY, THICKNESS:0.10MM
- 2. FINISH
  - TERMINAL: 2 MICROMETER MINIMUM NICKEL UNDERPLATING OVERALL, GOLD PLATING 0.3 MICROMETER MINIMUM ON CONTACT AREA, GOLD FLASH PLATING ON SOLDER AREA.
  - MAIN SHELL:2 MICROMETER MINIMUM NICKEL UNDERPLATING OVERALL, 0.8~2.8 MICROMETER BRIGHT TIN PLATING OVERALL.
  - BOTTOM SHELL :2 MICROMETER MINIMUM SOLDERABLE NICKEL UNDERPLATING OVERALL.
- 3. MECHANICAL CHARACTER:
  - 3.1. DURABILITY:30CYCLES
- 4. ELECTRICAL CHARACTER:
  - 4.1. RATED VOLTAGE: 10V DC MAX.
  - 4.2. RATED CURRENT: 0.5A MAX.
  - 4.3. LOW LEVEL CONTACT RESISTANT:60mOHM
- 5. PACKING:TAPE AND REEL,DETAIL SEE PK-105168-001.
- 6. COPLANARITY:0.08MM
- 7. PRODUCT SPECIFICATION: PS-105168-001
- 8. COMPLIANT TO RoHS DIRECTIVE 2002/95/EC AND ELV DIRECTIVE 2000/53/EC.

RELEASED EC NO: SH2013-0176 DRWN:WJHUO 2012/12/10 CHKD: APPR:AYIN 2013/01/08 REV	QUALITY SYMBOLS	GENERAL TOLERANCES (UNLESS SPECIFIED)		DIMENSION STYLE MM ONLY		SCALE 10:1	DESIGN UNITS METRIC	THIRD ANGLE PROJECTION	
		mm	INCH	DRAWN BY WJHUO	DATE 2012/12/10	TITLE SMIA75++ CAMERA SOCKET THROUGH BOARD 16 PIN BOTTOM CONTACT			
		4 PLACES ± ---	± ---	CHECKED BY	DATE				
		3 PLACES ± ---	± ---	APPROVED BY	DATE 2013/01/08				
		2 PLACES ± 0.15	± ---	MATERIAL NO.	DOCUMENT NO. SD-105168-001	SHEET NO. 2 OF 2			
	1 PLACE ± 0.20	± ---	DRAFT WHERE APPLICABLE MUST REMAIN WITHIN DIMENSIONS		SEE TABLE THIS DRAWING CONTAINS INFORMATION THAT IS PROPRIETARY TO MOLEX INCORPORATED AND SHOULD NOT BE USED WITHOUT WRITTEN PERMISSION				
	0 PLACE ± ---	± ---	ANGULAR ± 3 °		SIZE A3				

9 8 7 6 5 4 3 2 1