

10 9 8 7 6 5 4 3 2 1

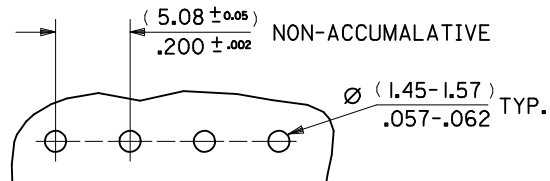

RECOMMENDED PCB HOLE DIMENSIONS

| No OF CCTS. | DIMn. A | DIMn. B |
|-------------|--------------------|----------------------------------|
| 2 | (8.08) .318 | (5.08 ± 0.13) .200 ± .005 |
| 3 | (13.16) .518 | (10.16 ± 0.13) .400 ± .005 |
| 4 | (18.24) .718 | (15.24 ± 0.13) .600 ± .005 |
| 5 | (23.32) .918 | (20.32 ± 0.13) .800 ± .005 |
| 6 | (28.40) 1.118 | (25.40 ± 0.15) 1.000 ± .006 |
| 7 | (33.48) 1.318 | (30.48 ± 0.18) 1.200 ± .007 |
| 8 | (38.56) 1.518 | (35.56 ± 0.18) 1.400 ± .007 |
| 9 | (43.64) 1.718 | (40.64 ± 0.20) 1.600 ± .008 |
| 10 | (48.72) 1.918 | (45.72 ± 0.20) 1.800 ± .008 |
| 11 | (53.80) 2.118 | (50.80 ± 0.20) 2.000 ± .008 |
| 12 | (58.88) 2.318 | (55.88 ± 0.23) 2.200 ± .009 |

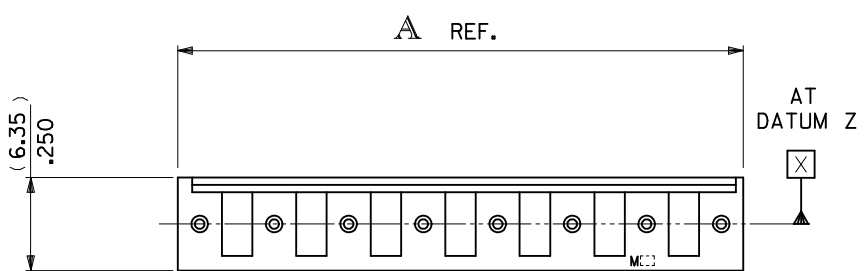
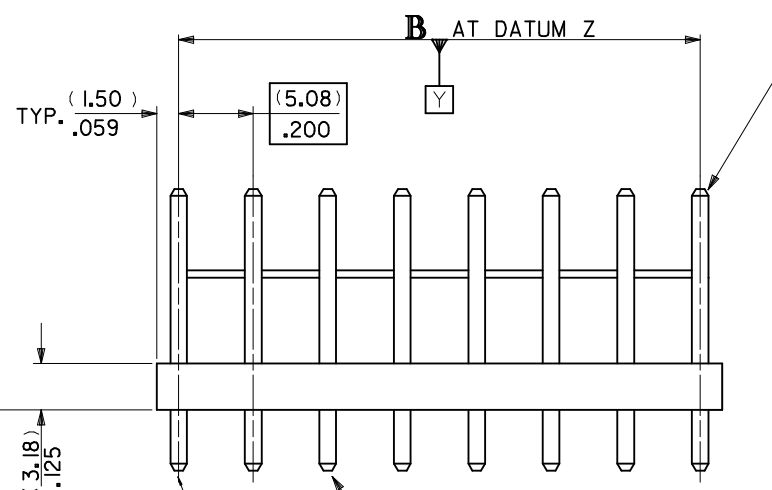

TIPS ONLY
 $\text{Ø} (0.51) / .020 \text{ Z X Y}$

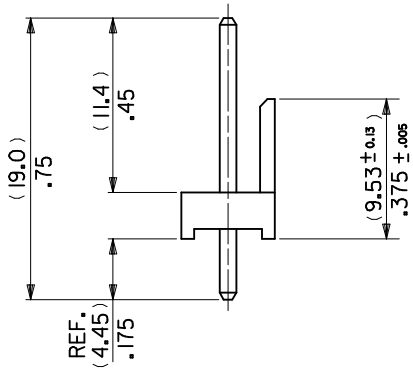

TIPS ONLY
 $\text{Ø} (0.38) / .015 \text{ Z X Y}$

AE-2599M-N*-*
 VOID CKT.
 LOCn.
 NO. OF CKTS. VERSION
 SEE SHEET 2

- NOTES:
1. WAFER MATERIAL: NYLON 6/6, UL94V-2
TERMINAL PIN: (1.14)/.045 DIA. BRASS
 2. FOR PLATING, SEE CHARTS.
 3. PRODUCT SPECIFICATION: PS-99020-0087
 4. PIN PUSH OUT FORCE (13.34N)/3LBS. MIN.
 5. PINS MUST CONFORM TO MOLEX SOLDERABILITY SPEC. ES-152.
 6. RECOMMENDED PCB THICKNESS 1.6MM.
 7. THIS PART CONFORMS TO CLASS B REQUIREMENTS OF COSMETIC SPECIFICATION PS-45499-002.

| | | | | | | | | | | |
|---|---|---------------------------------------|-------------|---|---------------------------|--------------|--|------------------------|--|--|
| ADDED NEW 10 CKT P/N EC NO: UCP2017-0758 DRWN:SS06 CHKD: APPR: SHWARG 2016/10/14 2016/10/14 AG | QUALITY SYMBOLS $\nabla = 0$ $\nabla = 0$ $\nabla = 0$ | GENERAL TOLERANCES (UNLESS SPECIFIED) | | DIMENSION STYLE MM/IN | | SCALE 3:1 | DESIGN UNITS METRIC | THIRD ANGLE PROJECTION | | |
| | | 4 PLACES | ± --- | ± --- | DRAWN BY | DATE | TITLE WAFER KK (5.08)/.200 CENTRES WITH POLARIZING WALL molex | | | |
| | | 3 PLACES | ± --- | ± 0.010 | MC | 23/02/1988 | | | | |
| | | 2 PLACES | ± 0.25 | ± 0.014 | CHECKED BY | DATE | DOCUMENT NO. SDAE-2599M-N* | | | |
| 1 PLACE | ± 0.35 | ± --- | DMORIARTY | 98/10/09 | | | | | | |
| 0 PLACE | ± | ± | APPROVED BY | DATE | MATERIAL NO. SEE CHART | | SHEET NO. 1 OF 2 | | | |
| ANGULAR ± --- ° DRAFT WHERE APPLICABLE MUST REMAIN WITHIN DIMENSIONS | | SIZE B | | THIS DRAWING CONTAINS INFORMATION THAT IS PROPRIETARY TO MOLEX INCORPORATED AND SHOULD NOT BE USED WITHOUT WRITTEN PERMISSION | | | | | | |

9 8 7 6 5 4 3 2 1

| No. OF CCTS. |
|--------------|
| 2 |
| 3 |
| 4 |
| 5 |
| 6 |
| 7 |
| 8 |
| 9 |
| 10 |
| 11 |
| 12 |
| PLATING |

| AE-2599M-NA | |
|------------------------------------|----------------|
| PART No. | ENG. No. |
| 10-08-502I | AE-2599M- 2 A |
| ↑ 503I | ↑ 3 A |
| 504I | 4 A |
| 505I | 5 A |
| 506I | 6 A |
| 507I | 7 A |
| 508I | 8 A |
| 509I | 9 A |
| 510I | 10 A |
| ↓ 511I | ↓ 11 A |
| 10-08-512I | AE-2599M- 12 A |
| 0.00254/.000100 MIN MATTE TIN OVER | |
| 0.00127/.000050 MIN NICKEL | |

| AE-2599M-NA-* | | | |
|---|-----------------|------------|---------------------|
| PART No. | ENG. No. | PART No. | ENG. No. |
| 38-00-0888 | AE-2599M- 3 A-1 | 38-00-7480 | AE-2599M- 8 A-5 |
| 38-00-7089 | ↑ 3 A-2 | 38-00-7486 | ↑ 8 A-1,5 |
| 38-00-7586 | 3 A-3 | 38-00-7097 | 8 A-3,5 |
| 38-00-7091 | 4 A-1,3 | 38-00-7606 | 8 A-3,6 |
| 38-00-7090 | 4 A-2 | 38-00-7598 | 8 A-5,7 |
| 38-00-7092 | 4 A-3 | 38-00-7485 | 8 A-5,8 |
| 38-00-4903 | 4 A-2,3 | 38-00-8278 | 08 A-2 |
| 38-00-7483 | 5 A-2 | 38-00-7660 | 8 A-3 |
| 38-00-7610 | 5 A-2,4 | 38-00-7707 | 8 A-6 |
| 38-00-7093 | 5 A-3 | 38-00-8277 | 8 A-7 |
| 38-00-7594 | 5 A-4 | 38-00-7609 | 9 A-2 |
| 38-00-7487 | 5 A-5 | 38-00-7084 | 9 A-3 |
| 38-00-7584 | 6 A-2 | 38-00-7585 | 9 A-4 |
| 38-00-7094 | 6 A-3 | 38-00-7607 | 9 A-4,7 |
| 38-00-7095 | 6 A-4 | 38-00-7098 | 9 A-5 |
| 38-00-7096 | 6 A-5 | 38-00-7599 | 9 A-6 |
| 38-00-7100 | 6 A-4,5 | 38-00-7670 | 9 A-7 |
| 38-00-7479 | 6 A-6 | 38-00-7484 | 10 A-3 |
| 38-00-1208 | 7 A-2 | 38-00-4902 | 10 A-4 |
| 38-00-7608 | 7 A-2,5 | 38-00-4905 | 10 A-6 |
| 38-00-7481 | 7 A-3 | 46999-0806 | 10 A-5,8 |
| 38-00-0887 | 7 A-4 | 38-00-7099 | 11 A-5 |
| 38-00-7595 | 7 A-5 | 38-00-4900 | 12 A-2 |
| 38-00-7596 | 7 A-6 | 38-00-7482 | 12 A-4 |
| 38-00-7664 | 8 A-3 | 38-00-4899 | 12 A-6 |
| 38-00-7597 | AE-2599M- 8 A-4 | 38-00-4904 | 12 A-8 |
| | | 38-00-4901 | 12 A-9 |
| | | 38-00-7600 | 12 A-3,10 |
| | | 38-00-7601 | AE-2599M- 12 A-6,10 |
| 0.00254/.000100 MIN MATTE TIN OVER 0.00127/.000050 NICKEL | | | |

| | | | | | | | | | | | |
|---|---------------------|---------------------------------------|--|--------------------------|---------------------|--|-------------------------------|------------------------|--|--|--|
| ADDED NEW 10 CKT P/N EC NO: UCP2017-0758 DRWNS:SS06 2016/10/14 CHKD: APPR: JSHWARG 2016/10/14 AG | QUALITY SYMBOLS | GENERAL TOLERANCES (UNLESS SPECIFIED) | | DIMENSION STYLE MM/IN | | SCALE --- | DESIGN UNITS METRIC | THIRD ANGLE PROJECTION | | | |
| | | 4 PLACES ± --- ± --- | 3 PLACES ± --- ± 0.010 | DRAWN BY MC | DATE 1988/02/23 | TITLE WAFER KK (5.08)/.200 CENTRES WITH POLARIZING WALL molex | | | | | |
| | | 2 PLACES ± 0.25 ± 0.014 | 1 PLACE ± 0.35 ± --- | CHECKED BY DMORIARTY | DATE 1988/02/23 | | | | | | |
| | | 0 PLACE ± --- ± | ANGULAR ± --- ° DRAFT WHERE APPLICABLE MUST REMAIN WITHIN DIMENSIONS | | APPROVED BY DATE | MATERIAL NO. SEE CHART | DOCUMENT NO. SDAE-2599M-N* | SHEET NO. 2 OF 2 | | | |
| THIS DRAWING CONTAINS INFORMATION THAT IS PROPRIETARY TO MOLEX INCORPORATED AND SHOULD NOT BE USED WITHOUT WRITTEN PERMISSION | | | | | | | | | | | |