

REVISIONS			
REV	DESCRIPTION, ECN, EAR NO.	DATE	APP'D
A	PROPOSAL	APR 12/17	L.CHAN

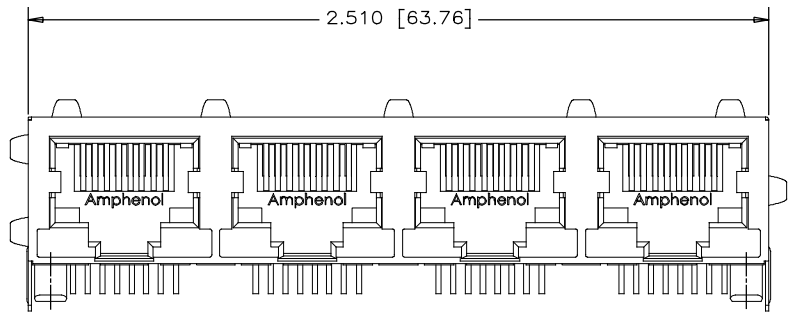

FRONT VIEW

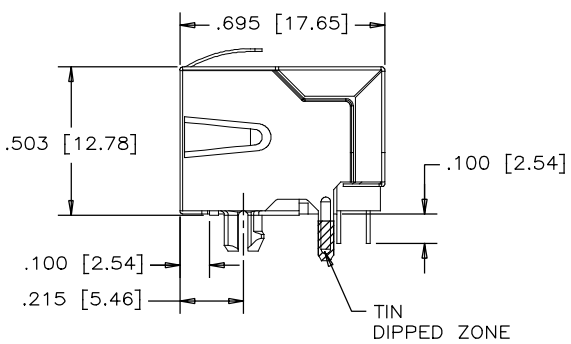

SIDE VIEW

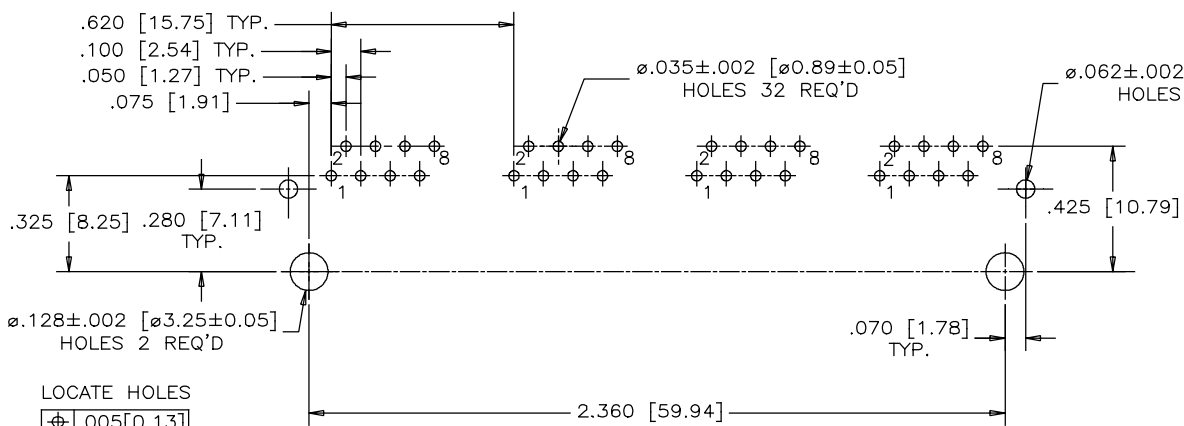

RECOMMENDED P.C.B. LAYOUT  
(COMPONENT SIDE OF BOARD)

LOCATE HOLES  
 $\phi$  .005 [0.13]  
 HOLE DIMENSIONS  
 ARE BASIC

**MATERIALS:**

- CONTACTS: PHOSPHOR BRONZE,  
 PLATING: SELECTIVE GOLD PLATING ON MATING SURFACES SEE AMPHENOL PART NUMBER FOR DETAIL.  
 50 MICRO" MIN. NICKEL OVERALL.  
 100 MICRO" MIN. MATTE TIN OR GOLD FLASH ON TAILS.
- HOUSING: HIGH TEMPERATURE THERMOPLASTIC  
 COLOR - BLACK, FLAMMABILITY RATING UL 94V-0
- SHIELD: COPPER ALLOY  
 PLATING: NICKEL WITH TIN DIPPED PCB TAILS.

RECOMMENDED SOLDERING TEMPERATURE:  
 WAVE SOLDERING AT 260°C MAXIMUM FOR 10 SEC MAXIMUM

OPERATING TEMPERATURE: -40°C TO 85°C

PART NUMBER: RJSBE-X380-C4

- GOLD PLATING OPTION:
- D = 6u" GOLD PLATING
  - G = 15u" GOLD PLATING
  - J = 30u" GOLD PLATING
  - 5 = 50u" GOLD PLATING

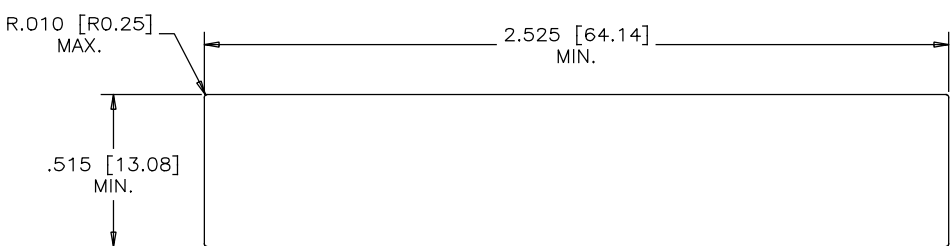

RECOMMENDED PANEL CUTOUT

UNLESS SPECIFIED OTHERWISE		DRAWN <i>Hanson.C</i>	DATE <i>APR 12/17</i>
PRIMARY UNITS INCH		CHECKED <i>LAWRENCE.C</i>	DATE <i>APR 12/17</i>
SECONDARY MILLIMETER		M.E. APP'D	
REFERENCE IN PARENTHESES		Q.A. APP'D	
GENERAL TOLERANCES		DWG APPR.	
1 DECIMAL PLACE ±0.025		ENG. REL. NO.	
2 DECIMAL PLACES ±0.020		REF.	
3 DECIMAL PLACES ±0.015		THIRD ANGLE PROJECTION	
ANGULAR DEGREES ±1.0°		DO NOT SCALE DRAWING	

<b>Amphenol Canada Corp.</b> www.amphenolcanada.com	
TITLE	4 PORT MODULAR JACK, 8 POSITION, 8 CONTACT, SHIELDED, WITHOUT LED, WITH .100[2.54] CONTACT LENGTH, - RoHS COMPLIANT
DWG. NO.	P-RJSBE-X380-C4
REV	A
CODE ID NO. 03554	DWG SIZE: C   SCALE: N/A   SHEET 1 OF 1