

1	BLACK
2	GREEN/YELLOW
3	WHITE

WIRING DIAGRAM

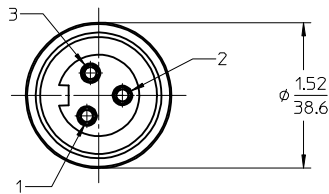
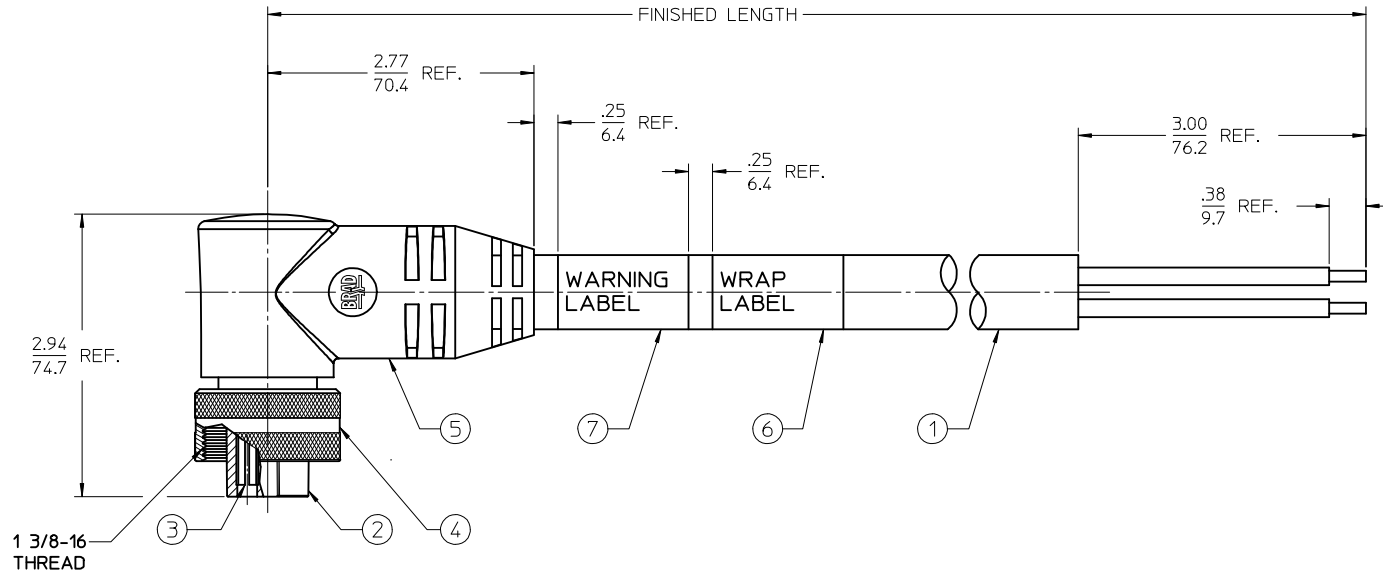

FEMALE FACE VIEW

NOTES:

- 1) MATERIAL: SEE TABLE
- 2) FINISHES: SEE TABLE
- 3) WRAP LABEL IS MARKED WITH P/N, DATE CODE VOLTAGE & AMPERAGE
- 4) MATES WITH: QUICK CHANGE 3 POLE RECEPTACLE
- 5) ELECTRICAL DATA:
10AWG UL TYPE: TC-ER STRANDED CABLE
MAX VOLTAGE: 600V
MAX CURRENT: 32A
PROTECTION IP67 (WHEN MATED)
TEMPERATURE RANGE: -20°C TO 90°C
- 6) PACKAGING:
CABLE ASSEMBLIES ARE BAGGED SEPERATLY IN POLY BAGS WITH BAR CODE LABEL ATTACHED TO OUTSIDE OF BAG.
- 7) ASSEMBLY IS RoHS COMPLIANT

PART NUMBER LEGEND

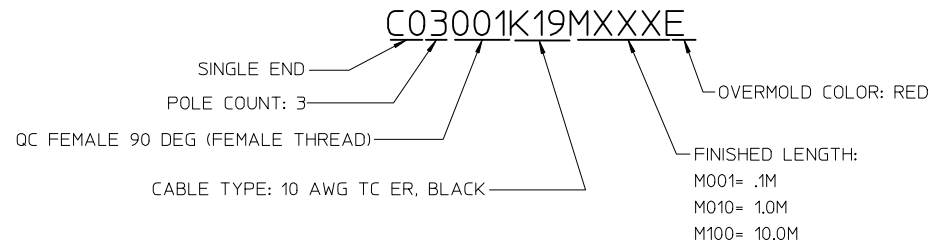

7	1	WARNING LABEL	VINYL	ORANGE/BLACK
6	1	WRAP LABEL	VINYL	BLACK/YELLOW
5	1	OVERMOLD	PVC	RED
4	1	COUPLING	ALUMINUM	CLEAR ANODIZE
3	3	CONTACT SOCKET	Cu ALLOY	GOLD PLATED
2	1	INSERT	PVC	BLACK
1	1	CABLE, 10/3 TC-ER (SEE NOTE 5)	TPE JACKET	BLACK
ITEM	QTY.	DESCRIPTION	MATERIAL	FINISH

RELEASED	EC NO: IPG2016-0830	2015/12/04
DRWNR:STONE	CHKD:	2016/02/29
APPR: BWOODMAN	DESCRIPTION	
REV		

QUALITY SYMBOLS	▽=0	
▽=0		
▽=0		
GENERAL TOLERANCES (UNLESS SPECIFIED)		
	mm	
	INCH	
4 PLACES	± .03	± .001
3 PLACES	± .03	± .001
2 PLACES	± .03	± .001
1 PLACE	± .03	± .001
0 PLACE	± .03	± .001
ANGULAR ± 1°		
DRAFT WHERE APPLICABLE MUST REMAIN WITHIN DIMENSIONS		

DIMENSION STYLE	
IN/MM	
DRAWN BY	DATE
RSTONE	2015/12/04
CHECKED BY	DATE
APPROVED BY	DATE
BWOODMAN	2016/02/29
MATERIAL NO.	
-	

SCALE	DESIGN UNITS	THIRD ANGLE PROJECTION
1:1	INCH	
TITLE		
QUICK CHANGE CORD ASSY		
FEMALE 90 DEG, RED		
10AWG TPE CABLE		
molex		
DOCUMENT NO.	SHEET NO.	
SD-130063-093	1 OF 1	
THIS DRAWING CONTAINS INFORMATION THAT IS PROPRIETARY TO MOLEX INCORPORATED AND SHOULD NOT BE USED WITHOUT WRITTEN PERMISSION		