



ANATECH ELECTRONICS INC
RF & Microwave Filters & Products

1850-1910 MHz / 1930-1990 MHz Ceramic Duplexer

Part Number: AM1880-1960D1004



<u>Characteristics</u>	<u>Band 1</u>	<u>Band 2</u>
Passband:	1850-1910 MHz	1930-1990 MHz
Bandwidth:	60 MHz	60 MHz
Passband Return Loss:	10 dB	10 dB
Passband Insertion Loss:	3.4 dB	3.2 dB
Passband Ripple:	2.30 dB	2.30 dB
Input / Output Impedance:	50 Ohms	50 Ohms
Isolation:	50 dB	50 dB
Power Handling:	5 W max	5 W max

<u>Mechanical</u>	
Mounting Method:	SMT
Dimensions:	61.85 x 11.2 x 8 mm

<u>Environmental</u>	
Operating Temperature:	-40 to +70 deg.C
Storage Temperature:	-50 to +90 deg.C

This product is RoHS compliant.

Outline Drawing:

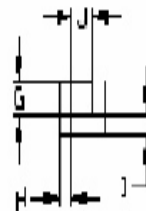
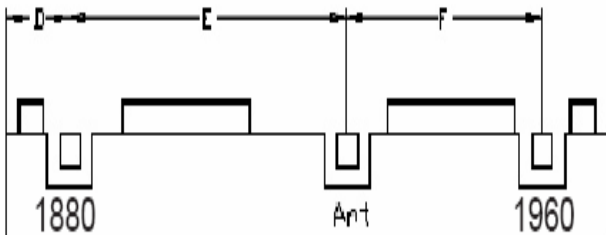
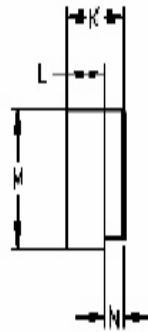
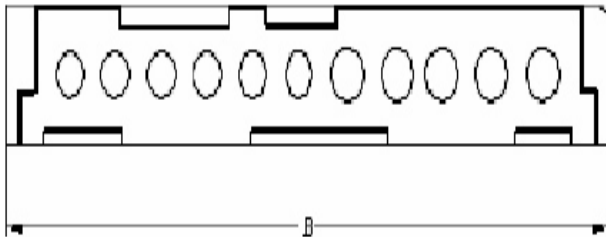

Dim	Nominal (mm)	Tolerance (mm) +/- or max
A		
B	61.85	max
C		
D	6.43	0.25
E	27.82	0.13
F	19.49	0.13
G	2.03	0.13
H	1.27	0.13
I	1.27	0.13
J	2.03	0.13
K	11.2	max
L	9.0	Max
M	8.0	max
N	2.2	0.13



ANATECH ELECTRONICS INC
RF & Microwave Filters & Products

**1850-1910 MHz / 1930-1990 MHz
Ceramic Duplexer
Part Number: AM1880-1960D1004**



Response Plot:

