

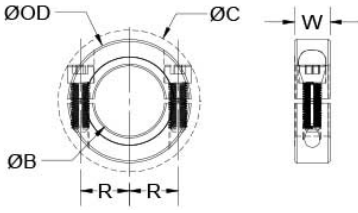

SP-46-A

Ruland SP-46-A, 2 7/8" Two-Piece Shaft Collar, Aluminum, Clamp Style, 4 1/4" OD, 0.875" Width



Description

Ruland SP-46-A is a two-piece shaft collar with a 2.8750" bore, 4 1/4" OD, and 0.875" width. The clamp style design does not mar the shaft, is easy to remove, and is indefinitely adjustable. It is commonly used for guiding, spacing, stopping, mounting, and component alignment. Equipment manufacturers benefit from the tightly controlled face to bore perpendicularity (TIR of ? .002"). Perpendicularity is critical for alignment when the shaft collar is used as a load bearing face, mechanical stop, or for mounting components such as gears or bearings. Proprietary processes have been developed by Ruland to maintain superior fit, finish, and holding power. SP-46-A is stamped with the Ruland name and bore size for ease of identification. Halves are mated throughout the manufacturing process for proper fit and alignment. Forged screws test beyond ANSI standards to ensure maximum holding power. SP-46-A is manufactured from solid bar stock sourced from select North American mills and machined to a fine burr free finish. Ruland uses high grade 2024 aluminum for increased screw seating torque. SP-46-A is RoHS3 and REACH compliant and manufactured in our Marlborough, MA factory under strict controls using proprietary processes.

Product Specifications

Bore (B)	2.8750 in	Bore Tolerance	+0.0020 in / +0.0005 in
Outer Diameter (OD)	4 1/4 in	Clearance Diameter (C) MAX	4.499 in
Width (W)	0.875 in	Width Tolerance	+0.003 in / -0.010 in
Recommended Gap	0.125 in	Recommended Shaft Tolerance	+0.0000 in / -0.0005 in
Forged Clamp Screw	3/8-24	Screw Material	Alloy Steel
Hex Wrench Size	5/16 in	Screw Finish	Black Oxide
Seating Torque	570 lb-in	Screw Location (R)	1.813 in
Number of Screws	2 ea	Material Specification	2024-T351 Aluminum Bar
Finish Specification	Bright, No Plating	Manufacturer	Ruland Manufacturing
Country of Origin	USA	Temperature	-40°F to 225°F (-40°C to 107°C)
Weight (lbs)	0.682200	UPC	634529021552
Tariff Code	8483.60.8000	UNSPC	31162811

Note 1 Performance ratings are for guidance only. The user must determine suitability for a particular application.

Prop 65  **WARNING** This product can expose you to the chemical Ethylene Thiourea, known to the State of California to cause cancer and birth defects or other reproductive harm. For more information go to www.P65Warnings.ca.gov.

Installation Instructions

1. Use the SP-46-A two-piece shaft collar as it is received.
2. Wipe the bore clean.
3. Apply a thin coat of light oil to the shaft.
4. Place the collar onto the desired shaft location with the groove side as the work surface. Tighten the collar using a 5/16 in hex wrench until a slight resistance is felt.
5. Be sure to maintain the gap of 0.125 in between the two halves of the collar during installation.
6. Wring collar into its final position and tighten the screw to the full recommended seating torque of 570 lb-in using a 5/16 in torque wrench.