

PRODUCT NUMBER	REMARKS
88973-101LF	SOLDER TO BOARD
88973-111LF	PRESS FIT

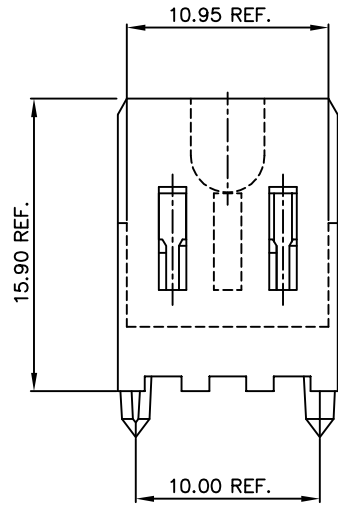

These holes are required when a shroud is used

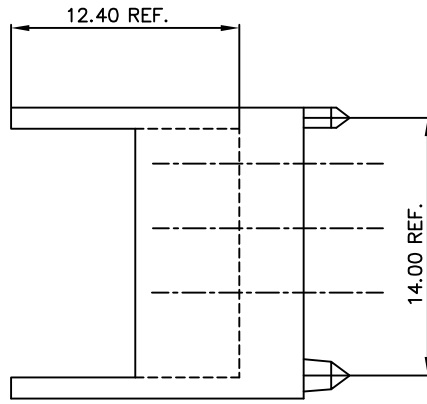
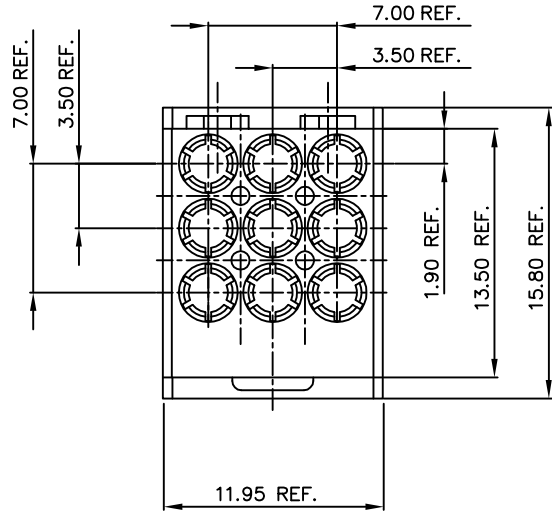
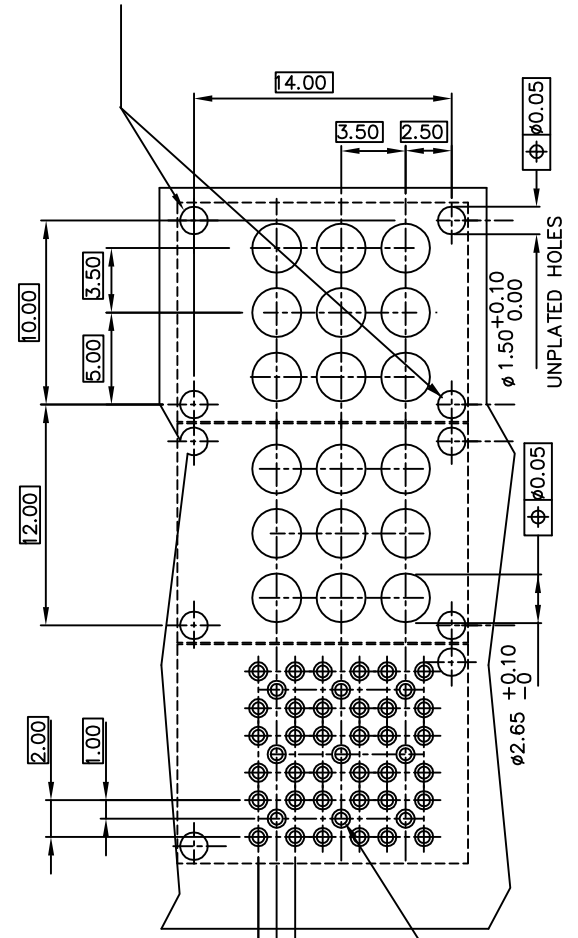

RECOMMENDED HOLE PATTERN
COMPONENT SIDE
FOR FEED THROUGH AND
SOLDER TO BOARD.

- NOTES:
- MATERIAL:
THERMOPL. POLYESTER 30% GLASS
FLAME RETARDANT ACC. UL 94-V0
COLOR NATURAL.
 - WHEN USING THIS PRODUCT IN A
STRAIGHT TO BOARD APPLICATION
THE FOLLOWING MUST BE TAKEN
INTO ACCOUNT:
-101LF HOUSING IS TO BE USED
FOR THE SOLDER TO BOARD
INSERT 88980-00ZLF.
-111LF HOUSING IS TO BE USED
FOR THE PRESS FIT TO BOARD
INSERT 88978-001LF.

- THIS PRODUCT MEETS EUROPEAN UNION DIRECTIVES AND OTHER
COUNTRY REGULATIONS AS DESCRIBED IN GS-22-008.
- THE HOUSING WILL WITHSTAND EXPOSURE TO 260 DEGREE PEAK
TEMPERATURE FOR 10 SECONDS IN A WAVE SOLDER APPLICATION.
WITH A 1.6mm MINIMUM THICK CIRCUIT BOARD.

mat'l. code SEE NOTE 1		tolerances unless otherwise specified		CUSTOMER COPY		ELECTRONICS www.fciconnect.com	
ltr	ecm no	dr	date	linear	projection	title	
A	H10348	DAN	920424			HEADER MINI COAX STRAIGHT 3x3	
B	H20755	DAN	921124			product family	
C	H60040	RVI	960119	angles		CENTRAL(tm)	
D	H70112	RMA	970218	dr	D Andrews	920424	code
E	H90476	DOB	990816	eng	D Andrews	920424	213
F	pc05-0438	CLU	051102	chr	P Schaik	920424	sheet
				app	H Cooljmans	960119	1 of 1
sheet	revision	F					
index	sheet	1					

Tous droits réservés. Reproduction ou communication sans la
 autorisation écrite de FCI est formellement interdite.
 All rights reserved. Reproduction or communication without written
 authority from FCI is prohibited.

All rights reserved. Reproduction or communication without written
 authority from FCI is prohibited.