

3401-002 D*MA Connectors

Features/Benefits

- D*Sub Connector type
- Removable Contacts technology
- Standard and High Density available
- From 9 to 104 ways
- ESCC Specification. Reference 3401002

Typical Applications

- Satellite Structure Space Harnesses
- Payloads Harnesses
- Test Harnesses
- Launchers Harnesses

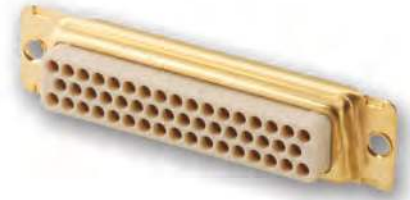

Connectors with crimp, snap-in, removable contacts .

Connectors normally supplied without contacts (suffix F0 in the description, not marked on the connector). The contacts should be ordered separately.

When supplied with contacts (no suffix F0), the connectors are equipped with contacts:

Size 20/20 for D*MA Connectors standard density

Size 22/22 for D*MA Connectors high density

Packaging unit: 1 piece (plastic bag) for connectors, 250 pieces for contacts.

Dust cap and insertion/extraction tool supplied with each connector, only for quality level ESA/ESCC

PARTICULARITIES:

- Shells copper alloy for size E, A, B, C, D
- Shells Aluminium alloy for size F (104 ways)
- Fixing option E (captive nut)
- Fixing option Y (dual float mount)

How to order – ESA/ESCC Quality Level

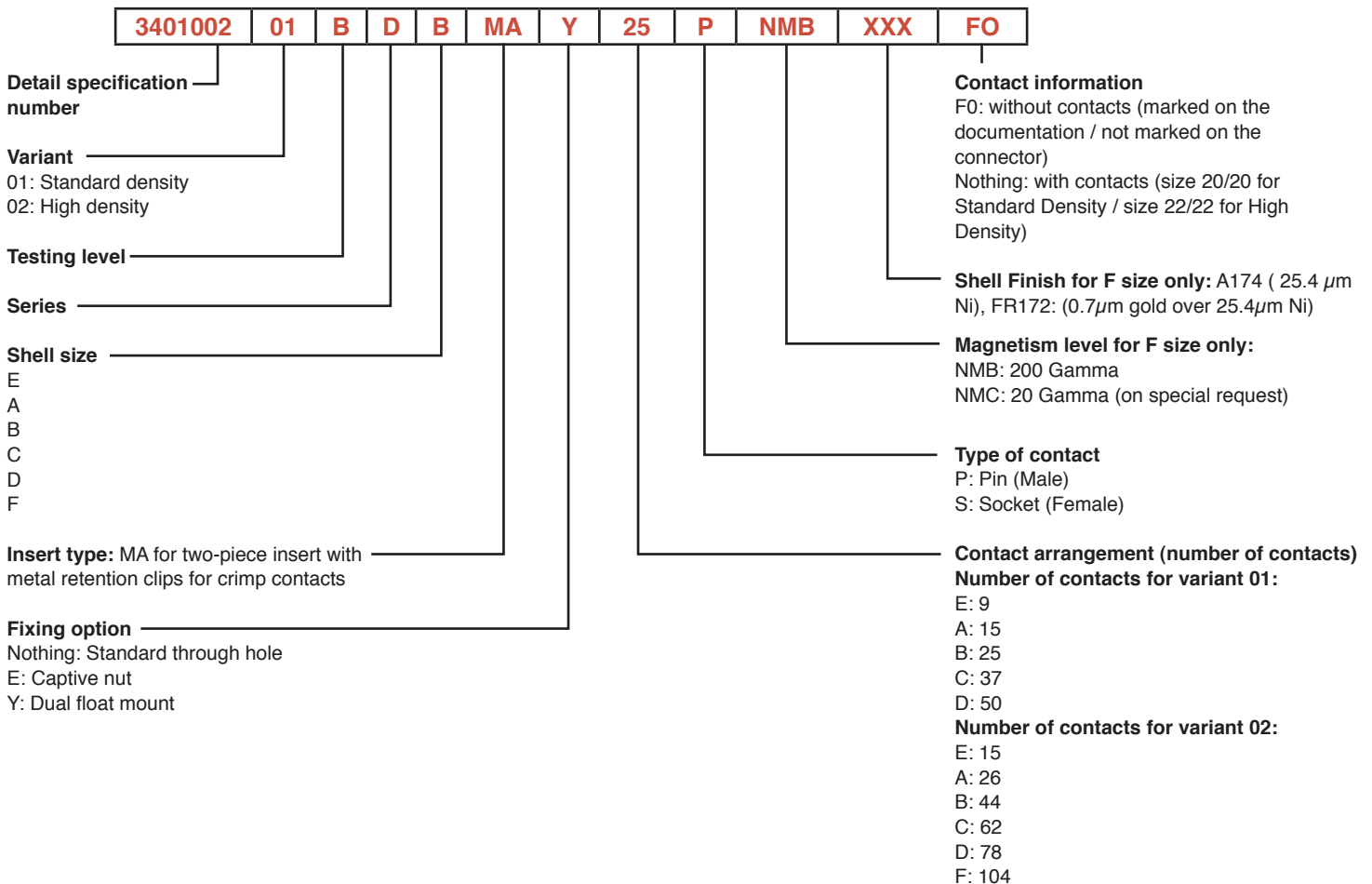

3401-002 D*MA Connectors

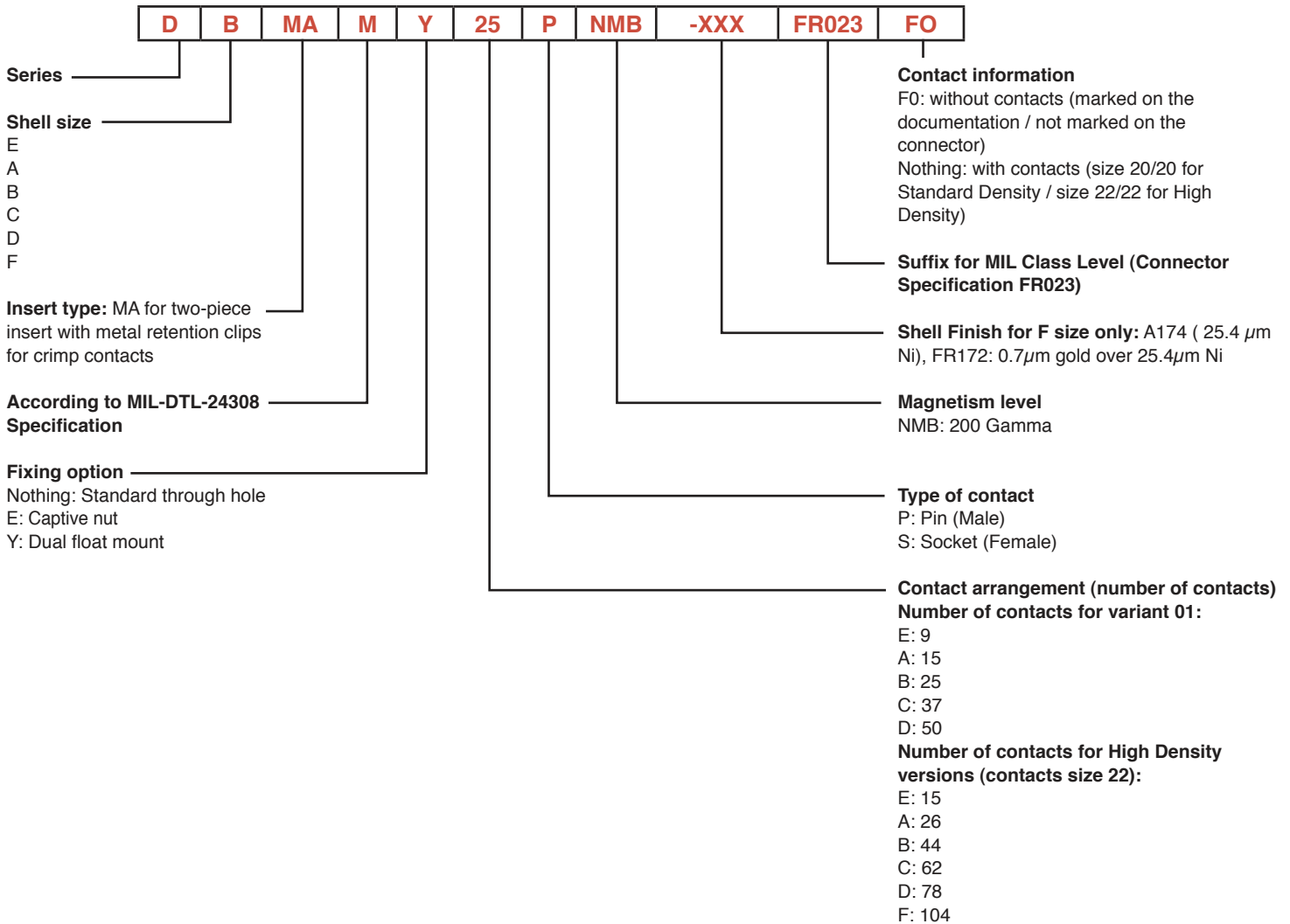

3401-002 D*MA Connectors

How to order – FR022 Quality Level

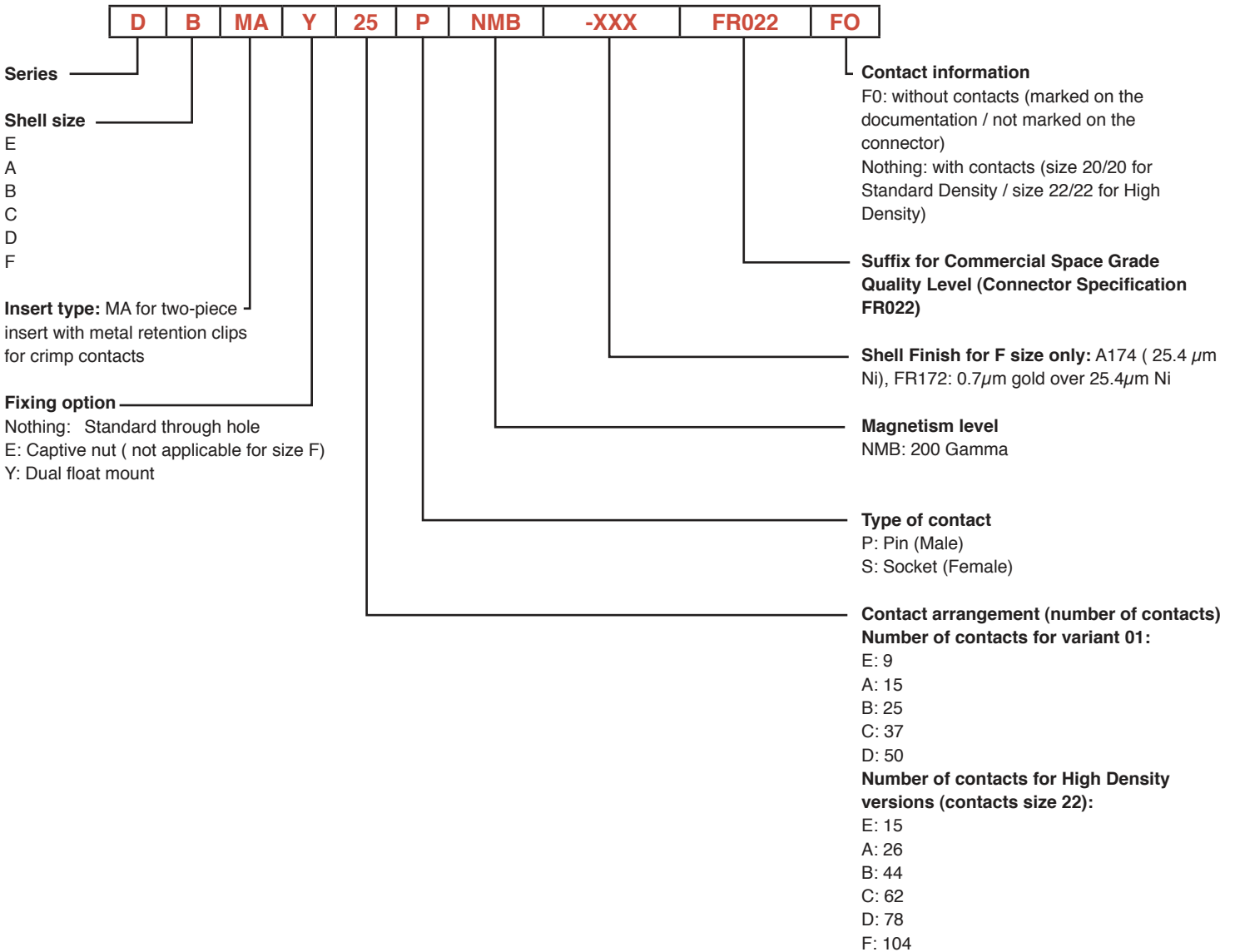

3401-002 D*MA Connectors

Specific Dimensions

Connectors equipped with contacts size 20/20 – 20/26 – 22/22

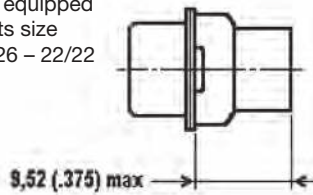

Connectors equipped with contacts size 20/18

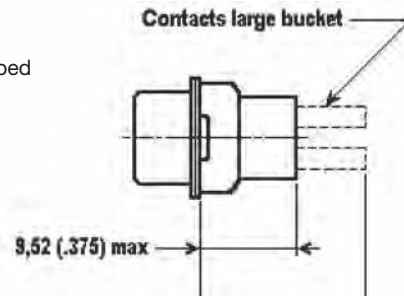

D*MA connectors with contacts

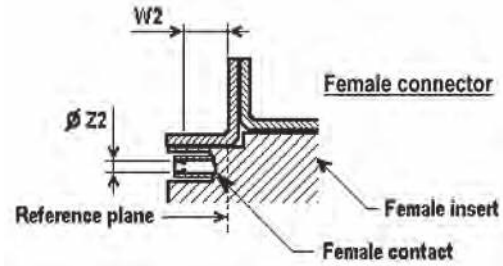
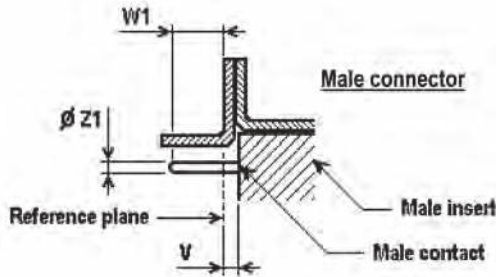

| Shell Size | V max | W1 min (Full pin diameter) | | W1 max (Full pin diameter) | | W2 min (Square ended pin) | |
|------------|-------------|----------------------------|-------------|----------------------------|-------------|---------------------------|-------------|
| | | S.D. (# 20) | H.D. (# 22) | S.D. (# 20) | H.D. (# 22) | S.D. (# 20) | H.D. (# 22) |
| E | 0,40 (.016) | 4,36 (.172) | 4,43 (.174) | 5,48 (.216) | 5,45 (.215) | 3,77 (.148) | 3,63 (.143) |
| A | 0,40 (.016) | 4,36 (.172) | 4,43 (.174) | 5,48 (.216) | 5,45 (.215) | 3,77 (.148) | 3,63 (.143) |
| B | 0,60 (.024) | 4,26 (.168) | 4,33 (.170) | 5,38 (.212) | 5,45 (.215) | 3,77 (.148) | 3,63 (.143) |
| C | 0,60 (.024) | 4,26 (.168) | 4,33 (.170) | 5,38 (.212) | 5,45 (.215) | 3,77 (.148) | 3,63 (.143) |
| D | 0,60 (.024) | 4,26 (.168) | 4,33 (.170) | 5,38 (.212) | 5,45 (.215) | 3,77 (.148) | 3,63 (.143) |
| F | 0,60 (.024) | N.A. | 4,33 (.170) | N.A. | 5,45 (.215) | N.A. | 3,63 (.143) |

Z1: 0,99 (.039) / 1,04 (.041) S.D.* (# 20), or 0,75 (.0295) / 0,77 (.0305) H.D.* (# 22)

Z2: to accommodate a 1,02 (.040) diameter pin S.D.* (# 20), or a 0,76 (.030) diameter pin H.D.* (# 22)

* SD: Standard density

HD: High density

Weights

| Max Weight (grams) without contacts and without accessories** | Shell Size | Standard Density | High Density |
|---|------------|------------------|--------------|
| | E | 6.0 | 6.0 |
| | A | 8.3 | 8.0 |
| | B | 13.6 | 12.0 |
| | C | 18.9 | 17.0 |
| | D | 22.3 | 20.0 |
| | F | N.A. | 25 |

** For contacts weight, refer to next page

For dual float mount (Y), weight if applicable, added 0,60 grams

For captive nut (E), weight if applicable, added 0,65 grams

Cross References

Type • Without contacts

| Description ESA/ESCC | Part Number |
|---------------------------------|--------------|
| 340100201B DEMA9PNMBF0 | C115370-5010 |
| 340100201B DEMA9SNMBF0 | C115370-5011 |
| 340100201B DAMA15PNMBF0 | C115370-5012 |
| 340100201B DAMA15SNMBF0 | C115370-5013 |
| 340100201B DBMA25PNMBF0 | C115370-5014 |
| 340100201B DBMA25SNMBF0 | C115370-5015 |
| 340100201B DCMA37PNMBF0 | C115370-5016 |
| 340100201B DCMA37SNMBF0 | C115370-5017 |
| 340100201B DDMA50PNMBF0 | C115370-5018 |
| 340100201B DDMA50SNMBF0 | C115370-5019 |
| 340100202B DEMA15PNMBF0 | C115368-5030 |
| 340100202B DEMA15SNMBF0 | C115368-5031 |
| 340100202B DAMA26PNMBF0 | C115368-5032 |
| 340100202B DAMA26SNMBF0 | C115368-5033 |
| 340100202B DBMA44PNMBF0 | C115368-5034 |
| 340100202B DBMA44SNMBF0 | C115368-5035 |
| 340100202B DCMA62PNMBF0 | C115368-5036 |
| 340100202B DCMA62SNMBF0 | C115368-5037 |
| 340100202B DDMA78PNMBF0 | C115368-5038 |
| 340100202B DDMA78SNMBF0 | C115368-5039 |
| 340100202B DFMA104PNMB-A174-F0 | C115368-5092 |
| 340100202B DFMA104SNMB-A174-F0 | C115368-5093 |
| 340100202B DFMA104PNMB-FR172-F0 | C115368-5082 |
| 340100202B DFMA104SNMB-FR172-F0 | C115368-5083 |

| Description FR022 | Part Number |
|----------------------------|--------------|
| DEMA9PNMB-FR022-F0 | C115370-3210 |
| DEMA9SNMB-FR022-F0 | C115370-3211 |
| DAMA15PNMB-FR022-F0 | C115370-3212 |
| DAMA15SNMB-FR022-F0 | C115370-3213 |
| DBMA25PNMB-FR022-F0 | C115370-3214 |
| DBMA25SNMB-FR022-F0 | C115370-3215 |
| DCMA37PNMB-FR022-F0 | C115370-3216 |
| DCMA37SNMB-FR022-F0 | C115370-3217 |
| DDMA50PNMB-FR022-F0 | C115370-3218 |
| DDMA50SNMB-FR022-F0 | C115370-3219 |
| DEMA15PNMB-FR022-F0 | C115368-3200 |
| DEMA15SNMB-FR022-F0 | C115368-3201 |
| DAMA26PNMB-FR022-F0 | C115368-3202 |
| DAMA26SNMB-FR022-F0 | C115368-3203 |
| DBMA44PNMB-FR022-F0 | C115368-3204 |
| DBMA44SNMB-FR022-F0 | C115368-3205 |
| DCMA62PNMB-FR022-F0 | C115368-3206 |
| DCMA62SNMB-FR022-F0 | C115368-3207 |
| DDMA78PNMB-FR022-F0 | C115368-3218 |
| DDMA78SNMB-FR022-F0 | C115368-3219 |
| DFMA104PNMB-A174-FR022-F0 | C115368-3292 |
| DFMA104SNMB-A174-FR022-F0 | C115368-3293 |
| DFMA104PNMB-FR172-FR022-F0 | C115368-3282 |
| DFMA104SMB-FR172-FR022-F0 | C115368-3283 |

*FR023 under request only

| Description ESA/ESCC | Part Number |
|----------------------------------|--------------|
| 340100201B DEMAY9PNMBF0 | C115370-5030 |
| 340100201B DEMAY9SNMBF0 | C115370-5031 |
| 340100201B DAMAY15PNMBF0 | C115370-5032 |
| 340100201B DAMAY15SNMBF0 | C115370-5033 |
| 340100201B DBMAY25PNMBF0 | C115370-5034 |
| 340100201B DBMAY25SNMBF0 | C115370-5035 |
| 340100201B DCMAY37PNMBF0 | C115370-5036 |
| 340100201B DCMAY37SNMBF0 | C115370-5037 |
| 340100201B DDMAY50PNMBF0 | C115370-5038 |
| 340100201B DDMAY50SNMBF0 | C115370-5039 |
| 340100202B DEMAY15PNMBF0 | C115368-5040 |
| 340100202B DEMAY15SNMBF0 | C115368-5041 |
| 340100202B DAMAY26PNMBF0 | C115368-5042 |
| 340100202B DAMAY26SNMBF0 | C115368-5043 |
| 340100202B DBMAY44PNMBF0 | C115368-5044 |
| 340100202B DBMAY44SNMBF0 | C115368-5045 |
| 340100202B DCMAY62PNMBF0 | C115368-5046 |
| 340100202B DCMAY62SNMBF0 | C115368-5047 |
| 340100202B DDMAY78PNMBF0 | C115368-5048 |
| 340100202B DDMAY78SNMBF0 | C115368-5049 |
| 340100202B DFMAY104PNMB-A174-F0 | C115368-5096 |
| 340100202B DFMAY104SNMB-A174-F0 | C115368-5097 |
| 340100202B DFMAY104PNMB-FR172-F0 | C115368-5086 |
| 340100202B DFMAY104SNMB-FR172-F0 | C115368-5087 |

| Description FR022 | Part Number |
|-----------------------------|--------------|
| DEMAY9PNMB-FR022-F0 | C115370-3230 |
| DEMAY9SNMB-FR022-F0 | C115370-3231 |
| DAMAY15PNMB-FR022-F0 | C115370-3232 |
| DAMAY15SNMB-FR022-F0 | C115370-3233 |
| DBMAY25PNMB-FR022-F0 | C115370-3234 |
| DBMAY25SNMB-FR022-F0 | C115370-3235 |
| DCMAY37PNMB-FR022-F0 | C115370-3236 |
| DCMAY37SNMB-FR022-F0 | C115370-3237 |
| DDMAY50PNMB-FR022-F0 | C115370-3238 |
| DDMAY50SNMB-FR022-F0 | C115370-3239 |
| DEMAY15PNMB-FR022-F0 | C115368-3230 |
| DEMAY15SNMB-FR022-F0 | C115368-3231 |
| DAMAY26PNMB-FR022-F0 | C115368-3232 |
| DAMAY26SNMB-FR022-F0 | C115368-3233 |
| DBMAY44PNMB-FR022-F0 | C115368-3234 |
| DBMAY44SNMB-FR022-F0 | C115368-3235 |
| DCMAY62PNMB-FR022-F0 | C115368-3236 |
| DCMAY62SNMB-FR022-F0 | C115368-3237 |
| DDMAY78PNMB-FR022-F0 | C115368-3238 |
| DDMAY78SNMB-FR022-F0 | C115368-3239 |
| DFMAY104PNMB-A174-FR022-F0 | C115368-3296 |
| DFMAY104SNMB-A174-FR022-F0 | C115368-3297 |
| DFMAY104PNMB-FR172-FR022-F0 | C115368-3286 |
| DFMAY104SMB-FR172-FR022-F0 | C115368-3287 |

*FR023 under request only



*Dimensions are shown in mm (inch)
Dimensions subject to change*

D*MA Connectors and Contacts

| Description ESA/ESCC | Part Number |
|----------------------------------|--------------|
| 340100201B DEMA9PNMBF0 | C115370-5050 |
| 340100201B DEMA9SNMBF0 | C115370-5051 |
| 340100201B DAMAE15PNMBF0 | C115370-5052 |
| 340100201B DAMAE15SNMBF0 | C115370-5053 |
| 340100201B DBMAE25PNMBF0 | C115370-5054 |
| 340100201B DBMAE25SNMBF0 | C115370-5055 |
| 340100201B DCMAE37PNMBF0 | C115370-5056 |
| 340100201B DCMAE37SNMBF0 | C115370-5057 |
| 340100201B DDMAE50PNMBF0 | C115370-5058 |
| 340100201B DDMAE50SNMBF0 | C115370-5059 |
| 340100202B DEMA15PNMBF0 | C115368-5070 |
| 340100202B DEMA15SNMBF0 | C115368-5071 |
| 340100202B DAMAE26PNMBF0 | C115368-5072 |
| 340100202B DAMAE26SNMBF0 | C115368-5073 |
| 340100202B DBMAE44PNMBF0 | C115368-5074 |
| 340100202B DBMAE44SNMBF0 | C115368-5075 |
| 340100202B DCMAE62PNMBF0 | C115368-5076 |
| 340100202B DCMAE62SNMBF0 | C115368-5077 |
| 340100202B DDMAE78PNMBF0 | C115368-5078 |
| 340100202B DDMAE78SNMBF0 | C115368-5079 |
| 340100202B DFMAE104PNMB-A174-F0 | C115368-6066 |
| 340100202B DFMAE104SNMB-A174-F0 | C115368-6067 |
| 340100202B DFMAE104PNMB-FR172-F0 | C115368-6062 |
| 340100202B DFMAE104SNMB-FR172-F0 | C115368-6063 |

| Description FR022 | Part Number |
|-----------------------------|--------------|
| DEMA9PNMB-FR022-F0 | C115370-3250 |
| DEMA9SNMB-FR022-F0 | C115370-3251 |
| DAMAE15PNMB-FR022-F0 | C115370-3252 |
| DAMAE15SNMB-FR022-F0 | C115370-3253 |
| DBMAE25PNMB-FR022-F0 | C115370-3254 |
| DBMAE25SNMB-FR022-F0 | C115370-3255 |
| DCMAE37PNMB-FR022-F0 | C115370-3256 |
| DCMAE37SNMB-FR022-F0 | C115370-3257 |
| DDMAE50PNMB-FR022-F0 | C115370-3258 |
| DDMAE50SNMB-FR022-F0 | C115370-3259 |
| DEMA15PNMB-FR022-F0 | C115368-3250 |
| DEMA15SNMB-FR022-F0 | C115368-3251 |
| DAMAE26PNMB-FR022-F0 | C115368-3252 |
| DAMAE26SNMB-FR022-F0 | C115368-3253 |
| DBMAE44PNMB-FR022-F0 | C115368-3254 |
| DBMAE44SNMB-FR022-F0 | C115368-3255 |
| DCMAE62PNMB-FR022-F0 | C115368-3256 |
| DCMAE62SNMB-FR022-F0 | C115368-3257 |
| DDMAE78PNMB-FR022-F0 | C115368-3258 |
| DDMAE78SNMB-FR022-F0 | C115368-3259 |
| DFMAE104PNMB-A174-FR022-F0 | C115368-3456 |
| DFMAE104SNMB-A174-FR022-F0 | C115368-3457 |
| DFMAE104PNMB-FR172-FR022-F0 | C115368-3452 |
| DFMAE104SNMB-FR172-FR022-F0 | C115368-3453 |

*FR023 under request only

Male (Pin) Crimp Contacts

| Bucket Type | Size | Wire Size | ESA/ESCC Quality Level | | FR023 Quality Level | | FR022 Quality Level | |
|-------------|-------|--------------------|------------------------|----------------|---------------------|----------------|---------------------|----------------|
| | | | Description | Part Number | Description | Part Number | Description | Part Number |
| | | AWG | | | | | | |
| Standard | 20/20 | 20 / 22 / 24 | 340100501B | C330-8996-101H | 330-8996-101-FR023 | C330-8996-101E | 330-8996-101-FR022 | C330-8996-101D |
| Reduced | 20/26 | 26 / 28 / 30* | 340100503B | C330-8997-101H | 330-8997-101-FR023 | C330-8997-101E | 330-8997-101-FR022 | C330-8997-101D |
| Large | 20/18 | 18 / 20 / 2x22* | 340100505B | C330-8995-101H | 330-8995-101-FR023 | C330-8995-101E | 330-8995-101-FR022 | C330-8995-101D |
| Standard | 22/22 | 22 / 24 / 26 / 28* | 340100507B | C330-8998-101H | 330-8998-101-FR023 | C330-8998-101E | 330-8998-101-FR022 | C330-8998-101D |

Female (Socket) Crimp Contacts

| Bucket Type | Size | Wire Size | ESA/ESCC Quality Level | | FR023 Quality Level | | FR022 Quality Level | |
|-------------|-------|--------------------|------------------------|----------------|---------------------|----------------|---------------------|----------------|
| | | | Description | Part Number | Description | Part Number | Description | Part Number |
| | | AWG | | | | | | |
| Standard | 20/20 | 20 / 22 / 24 | 340100502B | C031-8996-101H | 031-8996-101-FR023 | C031-8996-101E | 031-8996-101-FR022 | C031-8996-101D |
| Reduced | 20/26 | 26 / 28 / 30* | 340100504B | C031-8997-101H | 031-8997-101-FR023 | C031-8997-101E | 031-8997-101-FR022 | C031-8997-101D |
| Large | 20/18 | 18 / 20 / 2x22* | 340100506B | C031-8995-101H | 031-8995-101-FR023 | C031-8995-101E | 031-8995-101-FR022 | C031-8995-101D |
| Standard | 22/22 | 22 / 24 / 26 / 28* | 340100508B | C031-8998-101H | 031-8998-101-FR023 | C031-8998-101E | 031-8998-101-FR022 | C031-8998-101D |

*Not approved by ESA.



Dimensions are shown in mm (inch)
Dimensions subject to change

Connectors with contacts

| Description ESA/ESCC | Part Number |
|------------------------------|--------------|
| 340100201B DEMA9PNMB | C115370-5000 |
| 340100201B DEMA9SNMB | C115370-5001 |
| 340100201B DAMA15PNMB | C115370-5002 |
| 340100201B DAMA15SNMB | C115370-5003 |
| 340100201B DBMA25PNMB | C115370-5004 |
| 340100201B DBMA25SNMB | C115370-5005 |
| 340100201B DCMA37PNMB | C115370-5006 |
| 340100201B DCMA37SNMB | C115370-5007 |
| 340100201B DDMA50PNMB | C115370-5008 |
| 340100201B DDMA50SNMB | C115370-5009 |
| 340100202B DEMA15PNMB | C115368-5020 |
| 340100202B DEMA15SNMB | C115368-5021 |
| 340100202B DAMA26PNMB | C115368-5022 |
| 340100202B DAMA26SNMB | C115368-5023 |
| 340100202B DBMA44PNMB | C115368-5024 |
| 340100202B DBMA44SNMB | C115368-5025 |
| 340100202B DCMA62PNMB | C115368-5026 |
| 340100202B DCMA62SNMB | C115368-5027 |
| 340100202B DDMA78PNMB | C115368-5028 |
| 340100202B DDMA78SNMB | C115368-5029 |
| 340100202B DFMA104PNMB-A174 | C115368-5090 |
| 340100202B DFMA104SNMB-A174 | C115368-5091 |
| 340100202B DFMA104PNMB-FR172 | C115368-5080 |
| 340100202B DFMA104SNMB-FR172 | C115368-5081 |

| Description FR022 | Part Number |
|------------------------|--------------|
| DEMA9PNMB-FR022 | C115370-3200 |
| DEMA9SNMB-FR022 | C115370-3201 |
| DAMA15PNMB-FR022 | C115370-3202 |
| DAMA15SNMB-FR022 | C115370-3203 |
| DBMA25PNMB-FR022 | C115370-3204 |
| DBMA25SNMB-FR022 | C115370-3205 |
| DCMA37PNMB-FR022 | C115370-3206 |
| DCMA37SNMB-FR022 | C115370-3207 |
| DDMA50PNMB-FR022 | C115370-3208 |
| DDMA50SNMB-FR022 | C115370-3209 |
| DEMA15PNMB-FR022 | C115368-3200 |
| DEMA15SNMB-FR022 | C115368-3201 |
| DAMA26PNMB-FR022 | C115368-3202 |
| DAMA26SNMB-FR022 | C115368-3203 |
| DBMA44PNMB-FR022 | C115368-3204 |
| DBMA44SNMB-FR022 | C115368-3205 |
| DCMA62PNMB-FR022 | C115368-3206 |
| DCMA62SNMB-FR022 | C115368-3207 |
| DDMA78PNMB-FR022 | C115368-3208 |
| DDMA78SNMB-FR022 | C115368-3209 |
| DFMA104PNMB-A174-FR022 | C115368-3290 |
| DFMA104SNMB-A174-FR022 | C115368-3291 |
| DFMA104PMB-FR172-FR022 | C115368-3280 |
| DFMA104SMB-FR172-FR022 | C115368-3281 |

*FR023 under request only

| Description ESA/ESCC | Part Number |
|-------------------------------|--------------|
| 340100201B DEMAY9PNMB | C115370-5020 |
| 340100201B DEMAY9SNMB | C115370-5021 |
| 340100201B DAMAY15PNMB | C115370-5022 |
| 340100201B DAMAY15SNMB | C115370-5023 |
| 340100201B DBMAY25PNMB | C115370-5024 |
| 340100201B DBMAY25SNMB | C115370-5025 |
| 340100201B DCMAY37PNMB | C115370-5026 |
| 340100201B DCMAY37SNMB | C115370-5027 |
| 340100201B DDMAY50PNMB | C115370-5028 |
| 340100201B DDMAY50SNMB | C115370-5029 |
| 340100202B DEMAY15PNMB | C115368-5040 |
| 340100202B DEMAY15SNMB | C115368-5041 |
| 340100202B DAMAY26PNMB | C115368-5042 |
| 340100202B DAMAY26SNMB | C115368-5043 |
| 340100202B DBMAY44PNMB | C115368-5044 |
| 340100202B DBMAY44SNMB | C115368-5045 |
| 340100202B DCMAY62PNMB | C115368-5046 |
| 340100202B DCMAY62SNMB | C115368-5047 |
| 340100202B DDMAY78PNMB | C115368-5048 |
| 340100202B DDMAY78SNMB | C115368-5049 |
| 340100202B DFMAY104PNMB-A174 | C115368-5094 |
| 340100202B DFMAY104SNMB-A174 | C115368-5095 |
| 340100202B DFMAY104PNMB-FR172 | C115368-5084 |
| 340100202B DFMAY104SNMB-FR172 | C115368-5085 |

| Description FR022 | Part Number |
|-------------------------|--------------|
| DEMAY9PNMB-FR022 | C115370-3220 |
| DEMAY9SNMB-FR022 | C115370-3221 |
| DAMAY15PNMB-FR022 | C115370-3222 |
| DAMAY15SNMB-FR022 | C115370-3223 |
| DBMAY25PNMB-FR022 | C115370-3224 |
| DBMAY25SNMB-FR022 | C115370-3225 |
| DCMAY37PNMB-FR022 | C115370-3226 |
| DCMAY37SNMB-FR022 | C115370-3227 |
| DDMAY50PNMB-FR022 | C115370-3228 |
| DDMAY50SNMB-FR022 | C115370-3229 |
| DEMAY15PNMB-FR022 | C115368-3220 |
| DEMAY15SNMB-FR022 | C115368-3221 |
| DAMAY26PNMB-FR022 | C115368-3222 |
| DAMAY26SNMB-FR022 | C115368-3223 |
| DBMAY44PNMB-FR022 | C115368-3224 |
| DBMAY44SNMB-FR022 | C115368-3225 |
| DCMAY62PNMB-FR022 | C115368-3226 |
| DCMAY62SNMB-FR022 | C115368-3227 |
| DDMAY78PNMB-FR022 | C115368-3228 |
| DDMAY78SNMB-FR022 | C115368-3229 |
| DFMAY104PNMB-A174-FR022 | C115368-3294 |
| DFMAY104SNMB-A174-FR022 | C115368-3295 |
| DFMAY104PMB-FR172-FR022 | C115368-3284 |
| DFMAY104SMB-FR172-FR022 | C115368-3285 |

*FR023 under request only



Dimensions are shown in mm (inch)
Dimensions subject to change

3401-002 D*MA Connectors

| Description ESA/ESCC | Part Number |
|-------------------------------|--------------|
| 340100201B DEMA9PNMB | C115370-5040 |
| 340100201B DEMA9SNMB | C115370-5041 |
| 340100201B DAMAE15PNMB | C115370-5042 |
| 340100201B DAMAE15SNMB | C115370-5043 |
| 340100201B DBMAE25PNMB | C115370-5044 |
| 340100201B DBMAE25SNMB | C115370-5045 |
| 340100201B DCMAE37PNMB | C115370-5046 |
| 340100201B DCMAE37SNMB | C115370-5047 |
| 340100201B DDMAE50PNMB | C115370-5048 |
| 340100201B DDMAE50SNMB | C115370-5049 |
| 340100202B DEMA15PNMB | C115368-5060 |
| 340100202B DEMA15SNMB | C115368-5061 |
| 340100202B DAMAE26PNMB | C115368-5062 |
| 340100202B DAMAE26SNMB | C115368-5063 |
| 340100202B DBMAE44PNMB | C115368-5064 |
| 340100202B DBMAE44SNMB | C115368-5065 |
| 340100202B DCMAE62PNMB | C115368-5066 |
| 340100202B DCMAE62SNMB | C115368-5067 |
| 340100202B DDMAE78PNMB | C115368-5068 |
| 340100202B DDMAE78SNMB | C115368-5069 |
| 340100202B DFMAE104PNMB-A174 | C115368-6064 |
| 340100202B DFMAE104SNMB-A174 | C115368-6065 |
| 340100202B DFMAE104PNMB-FR172 | C115368-6060 |
| 340100202B DFMAE104SNMB-FR172 | C115368-6061 |

| Description FR022 | Part Number |
|-------------------------|--------------|
| DEMAE9PNMB-FR022 | C115370-3240 |
| DEMAE9SNMB-FR022 | C115370-3241 |
| DAMAE15PNMB-FR022 | C115370-3242 |
| DAMAE15SNMB-FR022 | C115370-3243 |
| DBMAE25PNMB-FR022 | C115370-3244 |
| DBMAE25SNMB-FR022 | C115370-3245 |
| DCMAE37PNMB-FR022 | C115370-3246 |
| DCMAE37SNMB-FR022 | C115370-3247 |
| DDMAE50PNMB-FR022 | C115370-3248 |
| DDMAE50SNMB-FR022 | C115370-3249 |
| DEMAE15PNMB-FR022 | C115368-3240 |
| DEMAE15SNMB-FR022 | C115368-3241 |
| DAMAE26PNMB-FR022 | C115368-3242 |
| DAMAE26SNMB-FR022 | C115368-3243 |
| DBMAE44PNMB-FR022 | C115368-3244 |
| DBMAE44SNMB-FR022 | C115368-3245 |
| DCMAE62PNMB-FR022 | C115368-3246 |
| DCMAE62SNMB-FR022 | C115368-3247 |
| DDMAE78PNMB-FR022 | C115368-3248 |
| DDMAE78SNMB-FR022 | C115368-3249 |
| DFMAE104PNMB-A174-FR022 | C115368-3454 |
| DFMAE104SNMB-A174-FR022 | C115368-3455 |
| DFMAE104PMB-FR172-FR022 | C115368-3450 |
| DFMAE104SMB-FR172-FR022 | C115368-3451 |

*FR023 under request only

When supplied with contacts (no suffix F0), the connectors are equipped with contacts:

Size 20/20 for D*MA Connectors standard density

Size 22/22 for D*MA Connectors high density



Dimensions are shown in mm (inch)
Dimensions subject to change

3401-005 D*MA Contacts

Male (Pin) Crimp Contacts

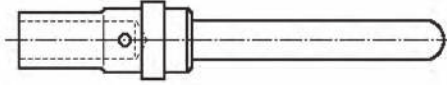
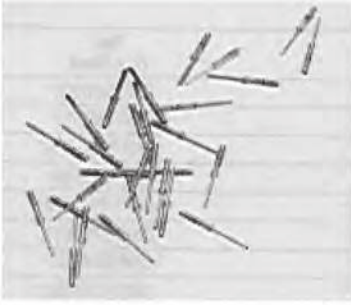

| Contact Type | Max Weight (grams) |
|--------------|--------------------|
| Pin 20/20 | 0.16 |
| Pin 20/26 | 0.18 |
| Pin 20/18 | 0.30 |
| Pin 22/22 | 0.08 |

| Bucket Type | Size | Wire Size | ESA/ESCC Quality Level | | FR023 Quality Level | | FR022 Quality Level | |
|-------------|-------|--------------------|------------------------|----------------|---------------------|----------------|---------------------|----------------|
| | | AWG | Description | Part Number | Description | Part Number | Description | Part Number |
| Standard | 20/20 | 20 / 22 / 24 | 340100501B | C330-8996-101H | 330-8996-101-FR023 | C330-8996-101E | 330-8996-101-FR022 | C330-8996-101D |
| Reduced | 20/26 | 26 / 28 / 30* | 340100503B | C330-8997-101H | 330-8997-101-FR023 | C330-8997-101E | 330-8997-101-FR022 | C330-8997-101D |
| Large | 20/18 | 18 / 20 / 2x22* | 340100505B | C330-8995-101H | 330-8995-101-FR023 | C330-8995-101E | 330-8995-101-FR022 | C330-8995-101D |
| Standard | 22/22 | 22 / 24 / 26 / 28* | 340100507B | C330-8998-101H | 330-8998-101-FR023 | C330-8998-101E | 330-8998-101-FR022 | C330-8998-101D |

Size explanation:

Eg: 20/26: 20 means contacts for standard density D*MA

26 means max gauge acceptable

Eg: 22/22: 22 means contact for high density D*MA

22 means max gauge acceptable

Female (Socket) Crimp Contacts

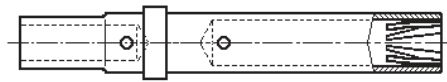

| Contact Type | Max Weight (grams) |
|--------------|--------------------|
| Skt 20/20 | 0.18 |
| Skt 20/26 | 0.21 |
| Skt 20/18 | 0.32 |
| Skt 22/22 | 0.11 |

| Bucket Type | Size | Wire Size | ESA/ESCC Quality Level | | FR023 Quality Level | | FR022 Quality Level | |
|-------------|-------|--------------------|------------------------|----------------|---------------------|----------------|---------------------|----------------|
| | | AWG | Description | Part Number | Description | Part Number | Description | Part Number |
| Standard | 20/20 | 20 / 22 / 24 | 340100502B | C031-8996-101H | 031-8996-101-FR023 | C031-8996-101E | 031-8996-101-FR022 | C031-8996-101D |
| Reduced | 20/26 | 26 / 28 / 30* | 340100504B | C031-8997-101H | 031-8997-101-FR023 | C031-8997-101E | 031-8997-101-FR022 | C031-8997-101D |
| Large | 20/18 | 18 / 20 / 2x22* | 340100506B | C031-8995-101H | 031-8995-101-FR023 | C031-8995-101E | 031-8995-101-FR022 | C031-8995-101D |
| Standard | 22/22 | 22 / 24 / 26 / 28* | 340100508B | C031-8998-101H | 031-8998-101-FR023 | C031-8998-101E | 031-8998-101-FR022 | C031-8998-101D |

Note *: Not approved by ESA

Contacts are without marking and without ink color coding (non-outgassing)

Residual magnetism level NMB (200 Gamma max)

For other residual magnetism level, consult factory

Packaging unit: 250 pieces (plastic bag)



Dimensions are shown in mm (inch)
Dimensions subject to change

3401-005 D*MA Contacts

Male Contact Size 20/20

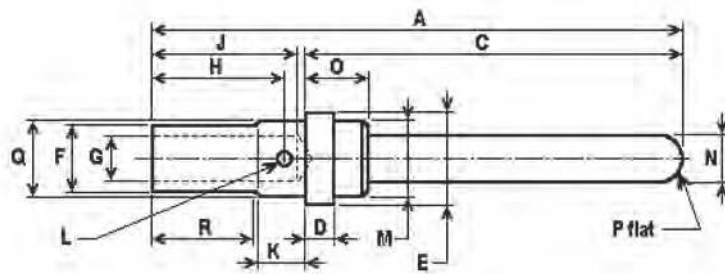

| mm | A | C | D | ∅E | ∅F | ∅G | H | J | K | ∅L | ∅M | ∅N | O | ∅P | ∅Q | R |
|-----|-------|-------|------|------|------|------|------|------|------|------|------|------|------|------|------|------|
| Min | - | 9,80 | 0,74 | 2,08 | 1,65 | 1,09 | 3,40 | 3,81 | 1,01 | 0,64 | 1,78 | 0,99 | 1,65 | - | 1,73 | 2,40 |
| Max | 14,14 | 10,00 | 0,84 | 2,16 | 1,73 | 1,17 | 3,68 | 4,70 | 1,24 | 0,80 | 1,85 | 1,04 | 1,75 | 0,30 | 1,80 | - |

| (Inch) | A | C | D | ∅E | ∅F | ∅G | H | J | K | ∅L | ∅M | ∅N | O | ∅P | ∅Q | R |
|--------|------|------|------|------|------|------|------|------|------|------|------|------|------|------|------|------|
| Min | - | .386 | .029 | .082 | .065 | .043 | .134 | .150 | .040 | .025 | .070 | .039 | .065 | - | .068 | .094 |
| Max | .557 | .394 | .033 | .085 | .068 | .046 | .145 | .185 | .049 | .031 | .073 | .041 | .069 | .012 | .071 | - |

Female Contact Size 20/20

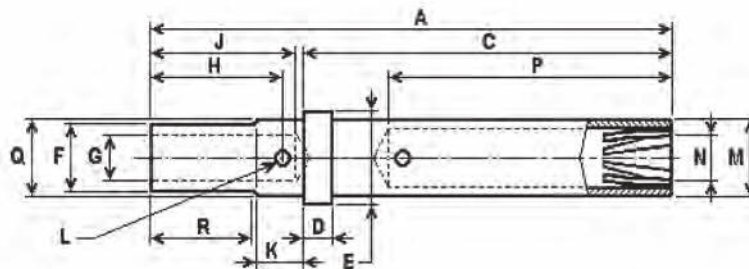

| mm | A | C | D | ∅E | ∅F | ∅G | H | J | K | ∅L | ∅M | ∅N | P | ∅Q | R |
|-----|-------|------|------|------|------|------|------|------|------|------|------|------|------|------|------|
| Min | - | 9,45 | 0,74 | 2,08 | 1,65 | 1,09 | 3,40 | 3,81 | 1,01 | 0,64 | 1,75 | 1,07 | 7,37 | 1,73 | 2,40 |
| Max | 13,80 | 9,65 | 0,84 | 2,16 | 1,73 | 1,17 | 3,68 | 4,70 | 1,24 | 0,80 | 1,85 | 1,14 | 7,87 | 1,80 | - |

| (Inch) | A | C | D | ∅E | ∅F | ∅G | H | J | K | ∅L | ∅M | ∅N | P | ∅Q | R |
|--------|------|------|------|------|------|------|------|------|------|------|------|------|-----|------|------|
| Min | - | .373 | .029 | .082 | .065 | .043 | .134 | .150 | .040 | .025 | .069 | .042 | .29 | .068 | .094 |
| Max | .543 | .379 | .033 | .085 | .068 | .046 | .145 | .185 | .049 | .031 | .073 | .045 | .31 | .071 | - |

3401-005 D*MA Contacts

Male Contact Size 20/26

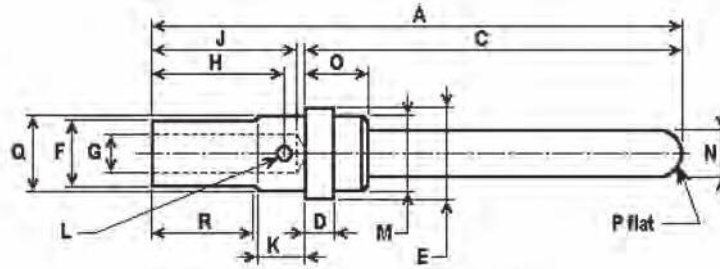

| mm | A | C | D | ∅E | ∅F | ∅G | H | J | K | ∅L | ∅M | ∅N | O | ∅P | ∅Q | R |
|-----|-------|-------|------|------|------|------|------|------|------|------|------|------|------|------|------|------|
| Min | - | 9,80 | 0,74 | 2,08 | 1,65 | 0,59 | 3,40 | 3,81 | 1,01 | 0,45 | 1,78 | 0,99 | 1,65 | - | 1,73 | 2,40 |
| Max | 14,14 | 10,00 | 0,84 | 2,16 | 1,73 | 0,66 | 3,68 | 4,70 | 1,24 | 0,55 | 1,85 | 1,04 | 1,75 | 0,30 | 1,80 | - |

| (Inch) | A | C | D | ∅E | ∅F | ∅G | H | J | K | ∅L | ∅M | ∅N | O | ∅P | ∅Q | R |
|--------|------|------|------|------|------|------|------|------|------|------|------|------|------|------|------|------|
| Min | - | .386 | .029 | .082 | .065 | .023 | .134 | .150 | .040 | .018 | .070 | .039 | .065 | - | .068 | .094 |
| Max | .557 | .394 | .033 | .085 | .068 | .026 | .145 | .185 | .049 | .022 | .073 | .041 | .069 | .012 | .071 | - |

Female Contact Size 20/26

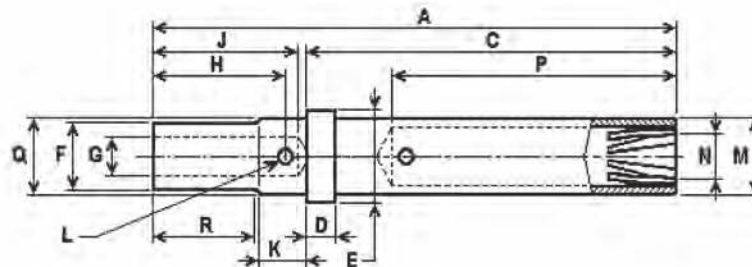

| mm | A | C | D | ∅E | ∅F | ∅G | H | J | K | ∅L | ∅M | ∅N | P | ∅Q | R |
|-----|-------|------|------|------|------|------|------|------|------|------|------|------|------|------|------|
| Min | - | 9,45 | 0,74 | 2,08 | 1,65 | 0,59 | 3,40 | 3,81 | 1,01 | 0,45 | 1,75 | 1,07 | 7,37 | 1,73 | 2,40 |
| Max | 13,80 | 9,65 | 0,84 | 2,16 | 1,73 | 0,66 | 3,68 | 4,70 | 1,24 | 0,55 | 1,85 | 1,14 | 7,87 | 1,80 | - |

| (Inch) | A | C | D | ∅E | ∅F | ∅G | H | J | K | ∅L | ∅M | ∅N | P | ∅Q | R |
|--------|------|------|------|------|------|------|------|------|------|------|------|------|-----|------|------|
| Min | - | .373 | .029 | .082 | .065 | .023 | .134 | .150 | .040 | .018 | .069 | .042 | .29 | .068 | .094 |
| Max | .543 | .379 | .033 | .085 | .068 | .026 | .145 | .185 | .049 | .022 | .073 | .045 | .31 | .071 | - |

3401-005 D*MA Contacts

Male Contact Size 20/18

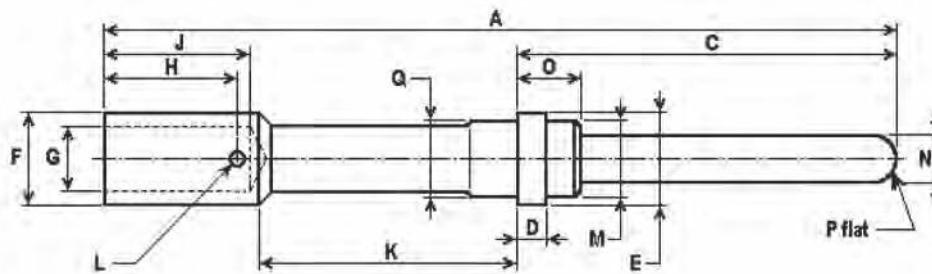

| mm | A | C | D | ∅ E | ∅ F | ∅ G | H | J | K | ∅ L | ∅ M | ∅ N | O | ∅ P | ∅ Q |
|-----|-------|-------|------|------|------|------|------|------|------|------|------|------|------|------|------|
| Min | - | 9,80 | 0,74 | 2,08 | 2,09 | 1,65 | 3,81 | 4,32 | 6,15 | 0,60 | 1,78 | 0,99 | 1,65 | - | 1,73 |
| Max | 21,13 | 10,00 | 0,84 | 2,16 | 2,18 | 1,74 | 4,00 | 4,70 | 6,45 | 0,80 | 1,85 | 1,04 | 1,75 | 0,30 | 1,80 |

| (Inch) | A | C | D | ∅ E | ∅ F | ∅ G | H | J | K | ∅ L | ∅ M | ∅ N | O | ∅ P | ∅ Q |
|--------|------|------|------|------|------|------|------|------|------|------|------|------|------|------|------|
| Min | - | .386 | .029 | .082 | .082 | .065 | .150 | .170 | .242 | .024 | .070 | .039 | .065 | - | .068 |
| Max | .832 | .394 | .033 | .085 | .086 | .069 | .157 | .185 | .254 | .031 | .073 | .041 | .069 | .012 | .071 |

Female Contact Size 20/18

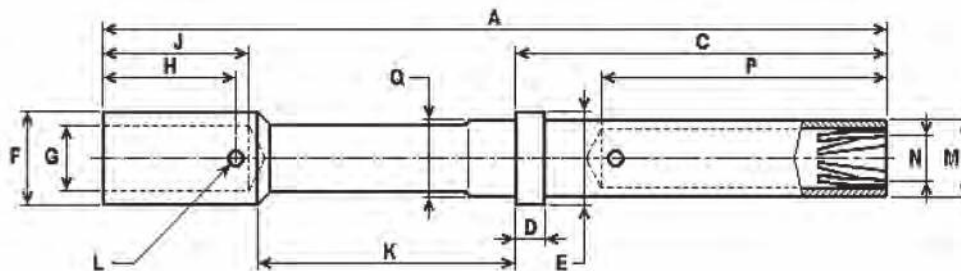

| mm | A | C | D | ∅ E | ∅ F | ∅ G | H | J | K | ∅ L | ∅ M | ∅ N | P | ∅ Q |
|-----|-------|------|------|------|------|------|------|------|------|------|------|------|------|------|
| Min | - | 9,45 | 0,74 | 2,08 | 2,09 | 1,65 | 3,81 | 4,32 | 6,15 | 0,60 | 1,75 | 1,07 | 7,37 | 1,73 |
| Max | 20,80 | 9,65 | 0,84 | 2,16 | 2,18 | 1,74 | 4,00 | 4,70 | 6,45 | 0,80 | 1,85 | 1,14 | 7,87 | 1,80 |

| (Inch) | A | C | D | ∅ E | ∅ F | ∅ G | H | J | K | ∅ L | ∅ M | ∅ N | P | ∅ Q |
|--------|------|------|------|------|------|------|------|------|------|------|------|------|-----|------|
| Min | - | .373 | .029 | .082 | .082 | .065 | .150 | .170 | .242 | .024 | .069 | .042 | .29 | .068 |
| Max | .819 | .379 | .033 | .085 | .086 | .069 | .157 | .185 | .254 | .031 | .073 | .045 | .31 | .071 |

3401-005 D*MA Contacts

Male Contact Size 22/22

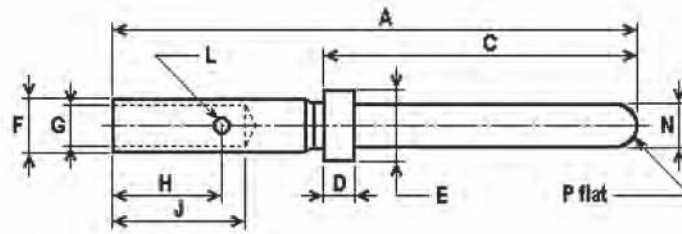

| mm | A | C | D | ∅ E | ∅ F | ∅ G | H | J | ∅ L | ∅ N | ∅ P |
|-----|-------|------|------|------|------|------|------|------|------|------|------|
| Min | - | 7,49 | 0,74 | 1,52 | 1,17 | 0,85 | 3,09 | 3,58 | 0,46 | 0,75 | - |
| Max | 13,64 | 7,62 | 0,84 | 1,57 | 1,22 | 0,90 | 3,27 | 3,99 | 0,56 | 0,77 | 0,20 |

| (Inch) | A | C | D | ∅ E | ∅ F | ∅ G | H | J | ∅ L | ∅ N | ∅ P |
|--------|------|------|------|------|------|-------|------|------|------|-------|------|
| Min | - | .295 | .029 | .060 | .046 | .0335 | .122 | .141 | .018 | .0295 | - |
| Max | .537 | .300 | .033 | .062 | .048 | .0355 | .129 | .157 | .022 | .0305 | .008 |

Female Contact Size 22/22

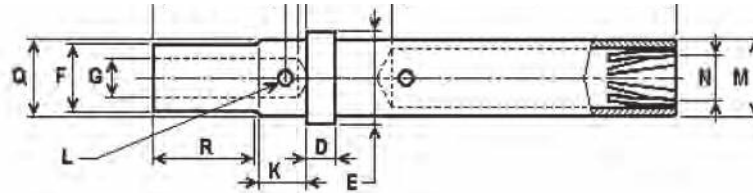

| mm | A | C | ∅ F | ∅ G | H | J | ∅ L | ∅ M | ∅ N | P |
|-----|-------|------|------|------|------|------|------|------|------|------|
| Min | - | 7,08 | 1,17 | 0,85 | 3,09 | 3,58 | 0,46 | 1,52 | 0,78 | 5,55 |
| Max | 13,41 | 7,34 | 1,22 | 0,90 | 3,27 | 3,99 | 0,56 | 1,57 | - | 5,85 |

| (Inch) | A | C | ∅ F | ∅ G | H | J | ∅ L | ∅ M | ∅ N | P |
|--------|------|------|------|-------|------|------|------|------|------|------|
| Min | - | .279 | .046 | .0335 | .122 | .141 | .018 | .060 | .031 | .219 |
| Max | .528 | .289 | .048 | .0355 | .129 | .157 | .022 | .062 | - | .230 |

D*MA Contacts Assembly

Application Tools

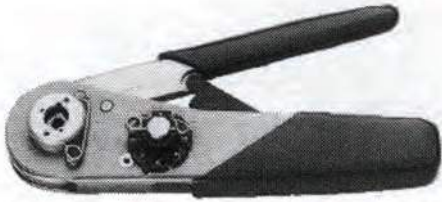

Hand Crimp Tool and locator should be ordered separately



Insertion/Extraction Tool

Supplied with each connector, for quality level ESA/ESCC
To be ordered separately for quality levels FR023 and FR022

| Contact | Plastic Insertion/Extraction Tool Description | Plastic Insertion/Extraction Tool Part Number | Plastic Extraction Tool Description | Plastic Extraction Tool Part Number |
|---------|---|---|-------------------------------------|-------------------------------------|
| 20/20 | - | - | CET-20-11 | C 323-7010-000 |
| 20/26 | - | - | CET-20-11 | C 323-7010-000 |
| 20/18 | - | - | CET-20-11 | C 323-7010-000 |
| 22/22 | CIET-22D | C 274-7048-000 | - | - |

| Contact | Wire Size | Crimp Tool Description | Crimp tool Part Number | Locator Description | Locator Part Number | Selector Position* |
|---------|-----------|------------------------|------------------------|--------------------------------------|------------------------|--------------------|
| 20/20 | AWG 20 | M22520/2-01 | C 995-0001-584 | M22520/2-08 | C 995-0001-604 | 7 |
| | AWG 22 | M22520/2-01 | C 995-0001-584 | M22520/2-08 | C 995-0001-604 | 6 |
| | AWG 24 | M22520/2-01 | C 995-0001-584 | M22520/2-08 | C 995-0001-604 | 5 |
| 20/26 | AWG 26 | M22520/2-01 | C 995-0001-584 | M22520/2-08 ** | C 995-0001-604 | 7 |
| | AWG 28 | M22520/2-01 | C 995-0001-584 | M22520/2-08 ** | C 995-0001-604 | 6 |
| | AWG 30 | M22520/2-01 | C 995-0001-584 | M22520/2-08 ** | C 995-0001-604 | 6 |
| 20/18 | AWG 18 | M22520/2-01 | C 995-0001-584 | K250 | C 980-0005-722 | 8 |
| | AWG 20 | M22520/2-01 | C 995-0001-584 | K250 | C 980-0005-722 | 7 |
| 22/22 | AWG 22 | M22520/2-01 | C 995-0001-584 | M22520/2-09 (Pin) or /2-06 (Skt) *** | C 995-0001-734 or -739 | 4 |
| | AWG 24 | M22520/2-01 | C 995-0001-584 | M22520/2-09 (Pin) or /2-06 (Skt) *** | C 995-0001-734 or -739 | 3 |
| | AWG 26 | M22520/2-01 | C 995-0001-584 | M22520/2-09 (Pin) or /2-06 (Skt) *** | C 995-0001-734 or -739 | 2 |
| | AWG 28 | M22520/2-01 | C 995-0001-584 | M22520/2-09 (Pin) or /2-06 (Skt) *** | C 995-0001-734 or -739 | 1 |

* For information only. Wire tensile strength test shall govern. For ESA/ESCC, see ECSS-Q-70-26 (replaces ESA PSS-01-726).

** Locator L3198-20HD (Part number 995-0001-325) can also be used for contacts 20/26.

*** Locator M22520/2-06 (Part number 995-0001-739) can also be used for both Pin and Skt contacts.

Assembly Instructions

Wire Stripping

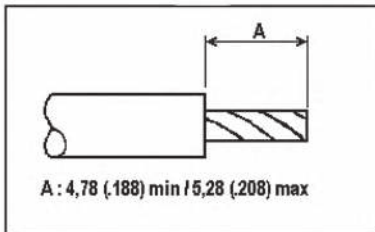

Cut wires to length. Strip insulation per above illustration. Check for broken or frayed wires.

Contact Crimping



Insert contact and wire into proper crimp tool and locator. Crimp contact to wire. Inspect crimp.

Contact Insertion (1)

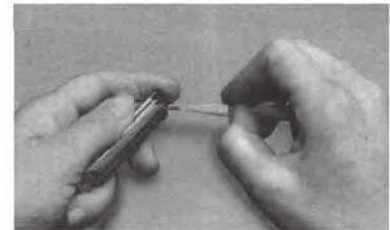

Center wired contact in groove of insertion tool with tool tip butting contact. Insert contact into cavity until a positive stop is felt. Inspect insertion.

Contact Insertion (2)

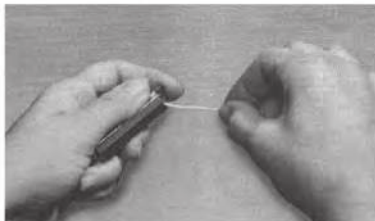

To be sure contact is locked securely, pull back lightly on wire. Repeat for balance of contacts working row by row across the insulator

Contact Extraction (1)

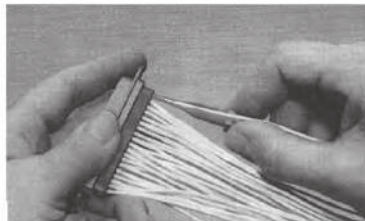

Place wire into extraction tool tip.

Contact Extraction (2)

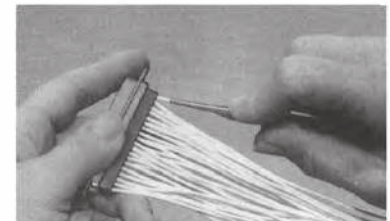

Insert tool tip into contact cavity until tip bottoms against contact shoulder, releasing tines. Hold wire against tool with finger and remove tool and contact. Repeat for balance of contacts.



*Dimensions are shown in mm (inch)
Dimensions subject to change*



*Dimensions are shown in mm (inch)
Dimensions subject to change*