

SECTION A-A
HIGH TAIL

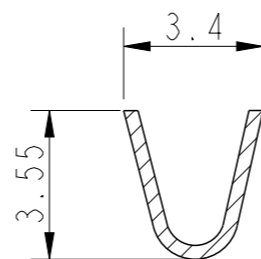

SECTION A-A
STANDARD TAIL

NOTES:

1. MATERIAL: HIGH CONDUCTIVITY COPPER ALLOY.
2. PLATING :
CONTACT AREA : OPTIONAL, SEE PART NUMBER LOGIC
CRIMP AREA : 100μ" MINIMUM BRIGHT TIN
UNDER LAYER : 30μ"-50μ" MINIMUM NICKEL
3. REFER APPLICATION SPECIFICATION GS-20-0687 FOR MATING CONNECTOR.
4. RoHS & HF COMPLAINT
4. PRODUCT SPECIFICATION: GS-12-1405
5. PACKING SPECIFICATION: GS-14-2595
6. APPLICATION SPECIFICATION: GS-20-0687
7. APPLICABLE AWG : 12AWG, 14AWG AND 16 AWG.
8. THIS LF PRODUCT MEETS EUROPEAN UNION DIRECTIVES AND OTHER COUNTRY REGULATIONS AS DESCRIBED IN GS-47-0004
9. PART NUMBER SCHEME:
10158070- X X X LF

LEAD FREE

STRUCTURE STATUS:

- 1: STANDARD TAIL(14-16AWG)
- 2: HIGH TAIL (12AWG)

FINISH:

- 0: 30μ" MINIMUM GOLD PLATING SELECTIVE
- 1: 15μ" MINIMUM GOLD PLATING SELECTIVE
- 2: 100μ" TIN PLATING OVER ALL
- 3: GOLD FLASH SELECTIVE

MATERIAL:

- 1: HIGH CONDUCTIVITY COPPER ALLOY

spec ref	dr	Akhil Rajan	2020/08/22	projection	MM	size	A3	scale	5:1
tolerance std	eng	Paul Mithun	2022/09/29			ecn no	ELX-I-44915-1	rel level	Released
ISO 406 ISO 1101	chr	-	-						
surface	appr	Kuriakose, San	2022/09/29	RECEPTACLE CRIMP TERMINAL		dwg no	10158070	rev	B
ISO 1302	linear	0.X	±0.30	Minitek Power 5.7 HCC		Product - Customer Drw		sheet 1 of 1	
	angular	0°	±°	cat. no. -		PDS: Rev :B		STATUS:Released	