

-DATE CODE-

example: **M5B15A1**

- M -> Molex initial
- 5 -> Year(2015)
- B -> Month(November) 1, ...,9, A, B, C
- 15 -> Date(15th)
- A -> Site initial(Ansant)
- 1 -> Manufacture line number

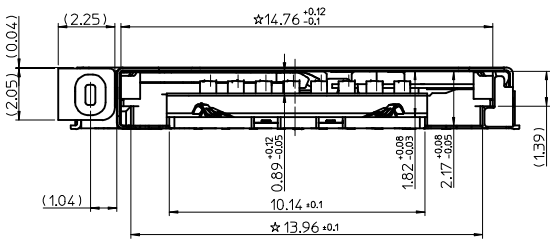
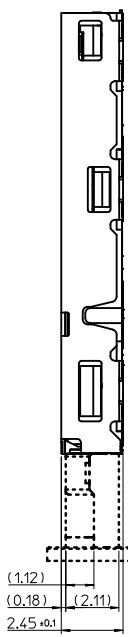
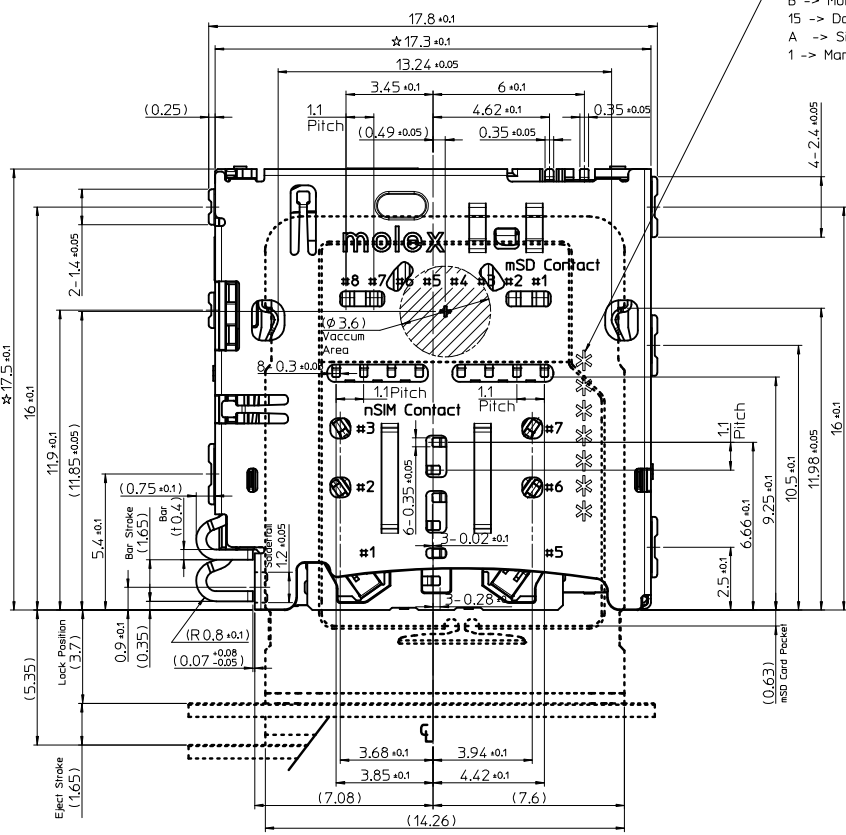

1. MATERIALS:
 - 1-1. HOUSING : HIGH TEMPERATURE THERMOPLASTIC,UL 94V-0, BLACK
 - 1-2. CONTACT & DETECT & SWITCH TER'L : COPPER ALLOY
 - 1-3. METAL SHELL & EJECT BAR & EJECT HINGE & RIGHT/LEFT LATCH : STAINLESS STEEL
2. FINISHES:
 - 2-1. CONTACT TER'L : 1.25-5.5 MICRON NICKEL UNDER-PLATED"
 - MIN. 0.05 MICRON GOLD ON CONTACT AREA,
 - MIN. 0.20 MICRON PALLADIUM-NICKEL ON mSD CONTACT AREA,
 - MIN. 0.30 MICRON PALLADIUM-NICKEL ON nSIM CONTACT AREA,
 - MIN. 0.05 MICRON GOLD ON SOLDER AREA
 - 2-2. DETECT & SWITCH TER'L : 1.25-5.5 MICRON NICKEL UNDER-PLATED"
 - MIN. 0.20 MICRON PALLADIUM-NICKEL ON CONTACT AREA,
 - MIN. 0.05 MICRON GOLD ON CONTACT AREA,
 - MIN. 0.05 MICRON GOLD ON SOLDER AREA
 - 2-3. METAL SHELL & EJECT HINGE & RIGHT/LEFT LATCH :
 - 1.25-5.5 MICRON NICKEL OVER ALL
- ★ 3. COPLANARITY OF SOLDER TAILS : 0.08mm MAX.(BEFORE & AFTER REFLOW)
4. PRODUCT SPECIFICATION : PS-104277-001
5. PACKAGING SPECIFICATION : SPK-104277-002
6. ★ IS CTF DIMENSION EQUAL TO MOLEX MAJOR QUALITY SYMBOLS

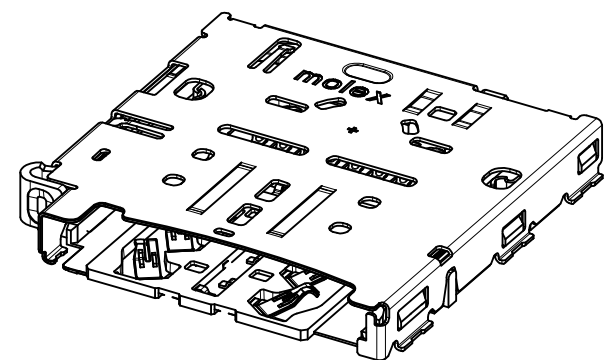

[Circuit diagram for Detection Switch of Card Tray]

Tray insertion condition	Tray detection switch	Circuit
Without Tray	Open	
Tray inserted	Close	

1042771421	104277-1421
MATERIAL NO.	ORDER NO.

PROPOSAL
 EC NO: KOR2016-0090
 DRWN: IHYOU 2016/09/24
 CHKD:
 APPR: YSKI M02 2016/09/28

QUALITY SYMBOLS
 ▼=0
 ▽=0

	GENERAL TOLERANCES (UNLESS SPECIFIED)	
	mm	INCH
4 PLACES	± 0.12	± 0.005
3 PLACES	± 0.12	± 0.005
2 PLACES	± 0.12	± 0.005
1 PLACE	± 0.15	± 0.005
0 PLACE	± 0.15	± 0.005

ANGULAR ± 1 °
 DRAFT WHERE APPLICABLE MUST REMAIN WITHIN DIMENSIONS

DIMENSION STYLE		SCALE	DESIGN UNITS	THIRD ANGLE PROJECTION
MM ONLY		5/1	METRIC	
DRAWN BY	DATE	TITLE		
IHYOU	2016/01/21	MSD/NSIM COMBO SOCKET BAR-PUSH TRAY TYPE 2.45H 8P/6P		
CHECKED BY	DATE	molex		
SHCHU	2016/01/21			
APPROVED BY	DATE	MATERIAL NO.	DOCUMENT NO.	SHEET NO.
YSKIM02	2016/09/28	SEE TABLE	SD-104277-001	1 OF 5

THIS DRAWING CONTAINS INFORMATION THAT IS PROPRIETARY TO MOLEX INCORPORATED AND SHOULD NOT BE USED WITHOUT WRITTEN PERMISSION

Detail_A
(Scale 8/1)
Solderfall : G3,G4

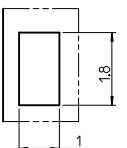

Detail_B
(Scale 8/1)
Solderfall : G2,G6,G7,G8

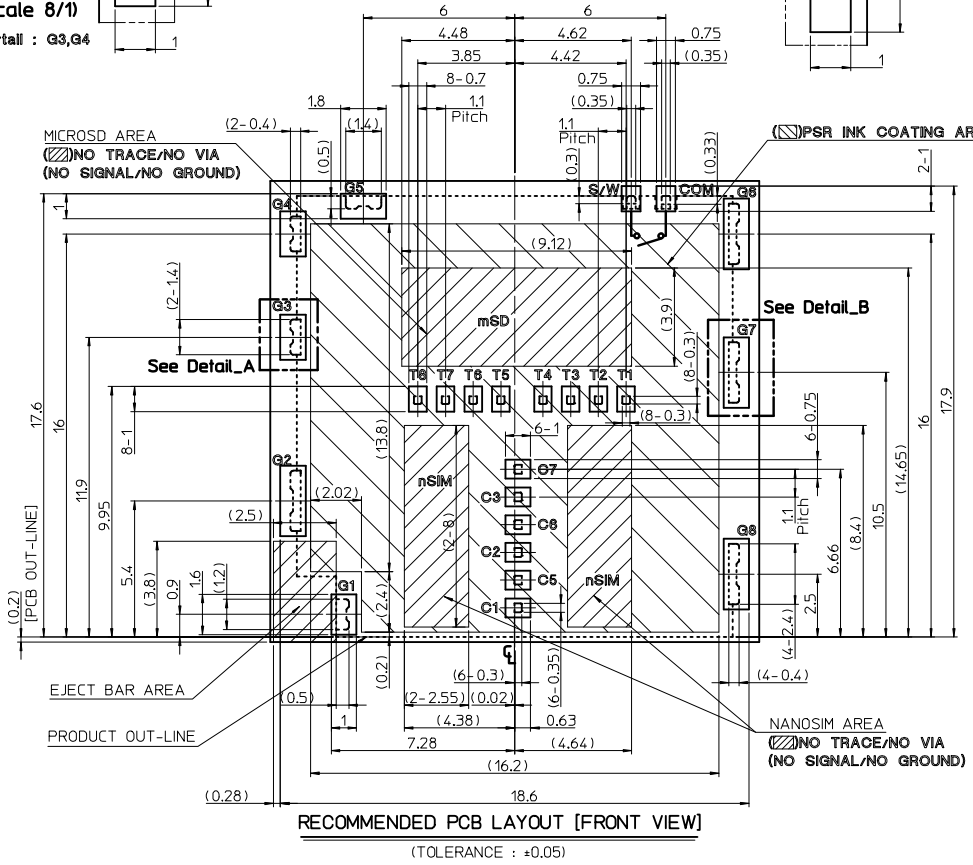
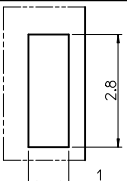

RECOMMENDED PCB LAYOUT [FRONT VIEW]
(TOLERANCE : ±0.05)

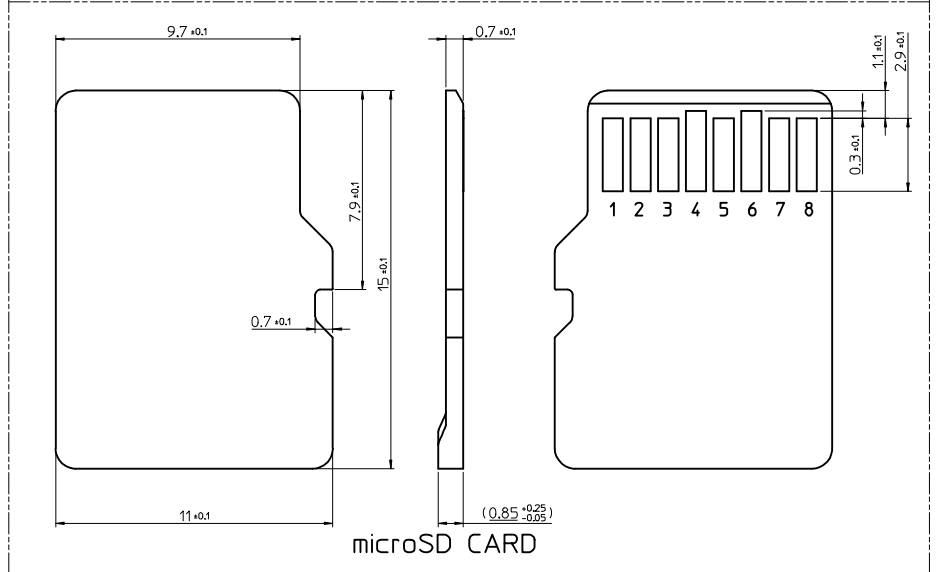
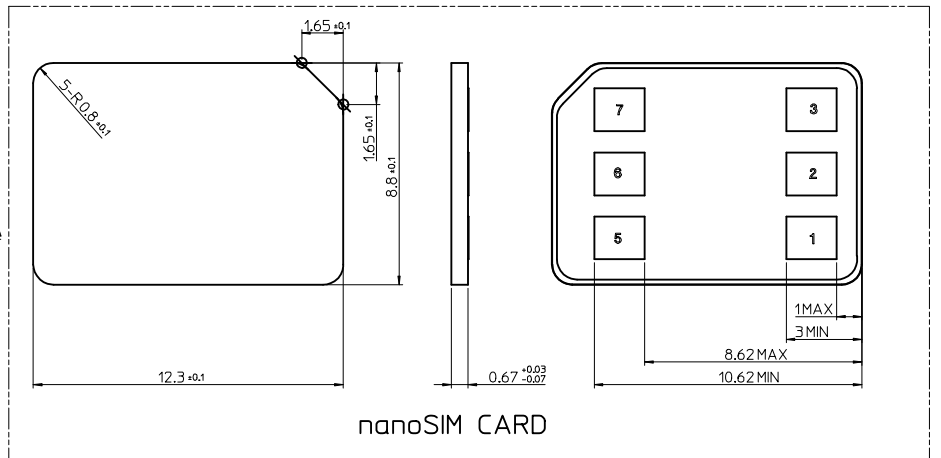

* This product has no C4, C8 Contact terminal [nanoSIM CARD PIN-MAP]

*There is only one tray insertion/removal detection switch physically.

Therefore, After tray detection, This product is necessary to detect the SIM or SD Card separately in software.

PIN NO.	DESCRIPTION
C1	Vcc(Supply V)
C2	RST(Reset)
C3	CLK(Clock)
(C4)	(None)
C5	GND(Ground)
C6	Vpp(Program V)
C7	I/O
(C8)	(None)

[microSD CARD PIN-MAP]

PIN NO.	DESCRIPTION
T1	DAT2
T2	CD/DAT3 ²
T3	COM
T4	V _{DD}
T5	CLK
T6	V _{SS} (GND)
T7	DAT0
T8	DAT1

G1-G8	GROUND or NOT CONNECT
S/W	TRAY DETECTOR
COM	GND or COMMON

PROPOSAL	EC NO: KOR2016-0090	2016/09/24
DRWN:HYOU	CHKD:	APPR:YSK1M02
DESCRIPTION		
REV		

QUALITY SYMBOLS	GENERAL TOLERANCES (UNLESS SPECIFIED)	
	mm	INCH
▽=0	4 PLACES ± ---	± ---
◻=0	3 PLACES ± 0.12	± ---
	2 PLACES ± 0.12	± ---
	1 PLACE ± 0.15	± ---
	0 PLACE ± 0.15	± ---
	ANGULAR ± 1 °	
	DRAFT WHERE APPLICABLE MUST REMAIN WITHIN DIMENSIONS	

[Reference Standards]
 -. microSD Card Specification Addendum Version 4.00
 -. ETSI TS 102 221 V12.0.0, Smart Cards, UICC-Terminal interface, Physical and logical characteristics

DIMENSION STYLE	SCALE	DESIGN UNITS	THIRD ANGLE PROJECTION
MM ONLY	5/1	METRIC	THIRD ANGLE PROJECTION
DRAWN BY	DATE	TITLE	
IHYOU	2016/01/21	MSD/NSIM COMBO SOCKET BAR-PUSH TRAY TYPE 2.45H 8P/6P	
CHECKED BY	DATE	molex	
SHCHU	2016/01/21		
APPROVED BY	DATE	ENTER PART	
YSK1M02	2016/09/28	SD-104277-001	
MATERIAL NO.	DOCUMENT NO.	SHEET NO.	
A3		2 OF 5	
THIS DRAWING CONTAINS INFORMATION THAT IS PROPRIETARY TO MOLEX INCORPORATED AND SHOULD NOT BE USED WITHOUT WRITTEN PERMISSION			

TRAY REFERENCE DRAWING

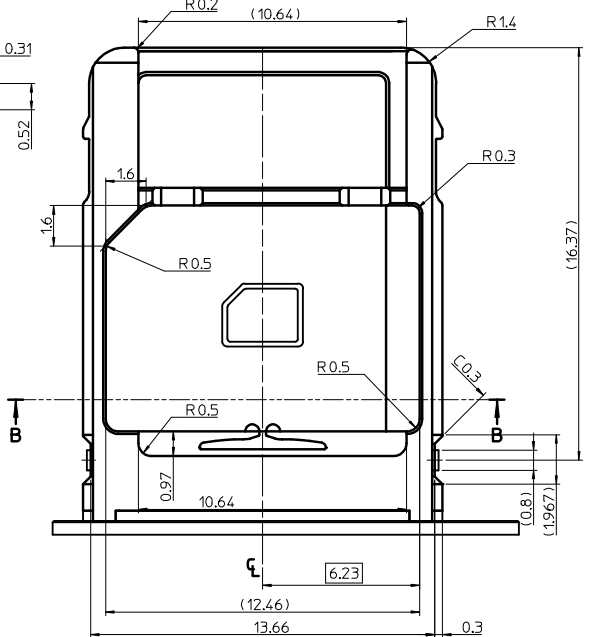
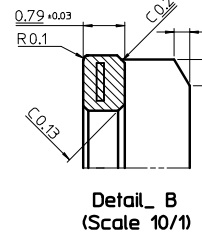
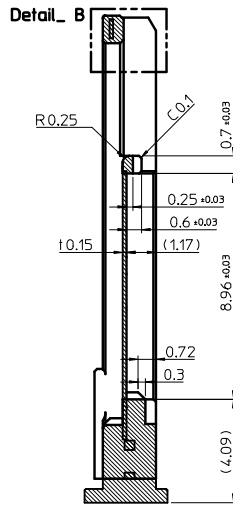
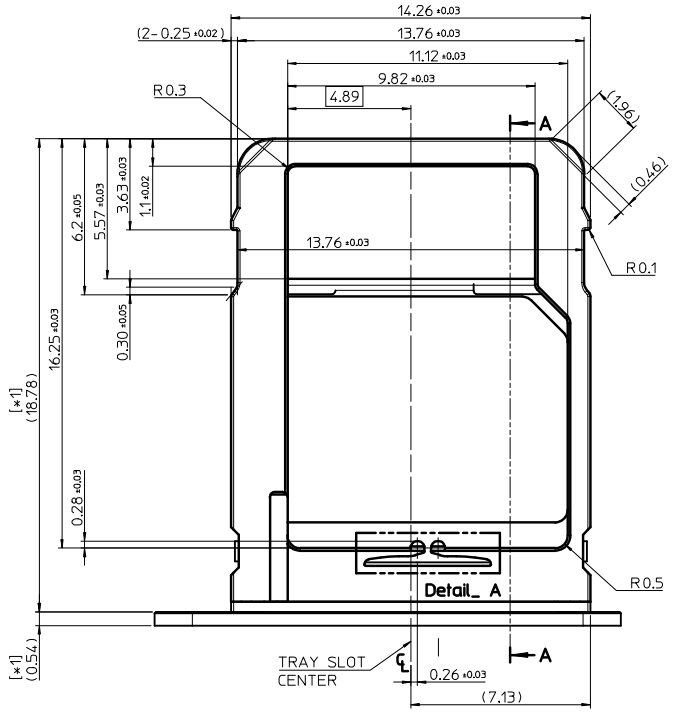
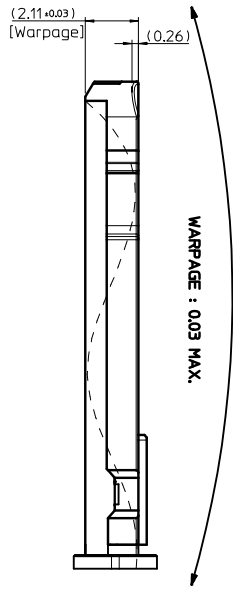
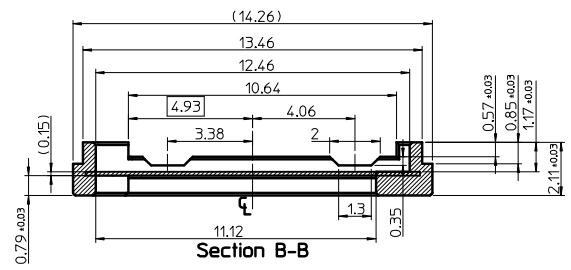
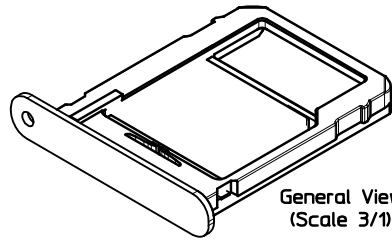
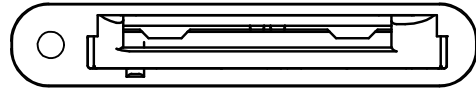

Section A-A

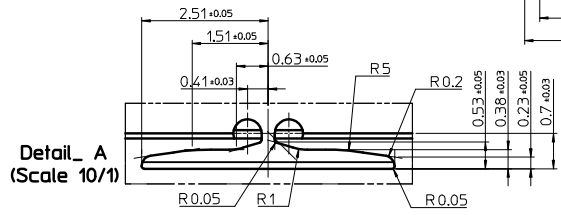

Detail A (Scale 10/1)

WARPAGE : 0.03 MAX.

APPLICABLE PLASTIC(Insert Molding) TRAY
(REFERENCE ONLY)
TOLERANCE : ±0.05
COPLANALITY 0.05MAX
SURFACE ROUGHNESS : Ra=0.5 μm MAX.

[*1]CUSTOMER CAN DECIDE THIS DIMENSION.

REFERENCE ONLY
There is a proposed drawing for concept.
so the dimensions are subject to change without notice.
Also, this model is tentative, and has the possibility of changing.

PROPOSAL	EC NO: KOR2016-0090	2016/09/24	2016/09/28
DRWN:HYOU	CHKD:	APPR:YSK1M02	
REV	DESCRIPTION		

QUALITY SYMBOLS	▽=0
	◻=0

GENERAL TOLERANCES (UNLESS SPECIFIED)	mm	INCH
	4 PLACES ± ---	± ---
	3 PLACES ± 0.12	± ---
	2 PLACES ± 0.12	± ---
	1 PLACE ± 0.15	± ---
	0 PLACE ± 0.15	± ---
	ANGULAR ± 1 °	
DRAFT WHERE APPLICABLE MUST REMAIN WITHIN DIMENSIONS		

DIMENSION STYLE		SCALE	DESIGN UNITS	THIRD ANGLE PROJECTION
MM ONLY		5/1	METRIC	
DRAWN BY	DATE	TITLE		
IHYOU	2016/01/21	MSD/NSIM COMBO SOCKET BAR-PUSH TRAY TYPE 2.45H 8P/6P		
CHECKED BY	DATE	molex		
SHCHU	2016/01/21			
APPROVED BY	DATE	DOCUMENT NO. SD-104277-001		
YSK1M02	2016/09/28	SHEET NO. 4 OF 5		
MATERIAL NO.	ENTER PART			
A3	THIS DRAWING CONTAINS INFORMATION THAT IS PROPRIETARY TO MOLEX INCORPORATED AND SHOULD NOT BE USED WITHOUT WRITTEN PERMISSION			

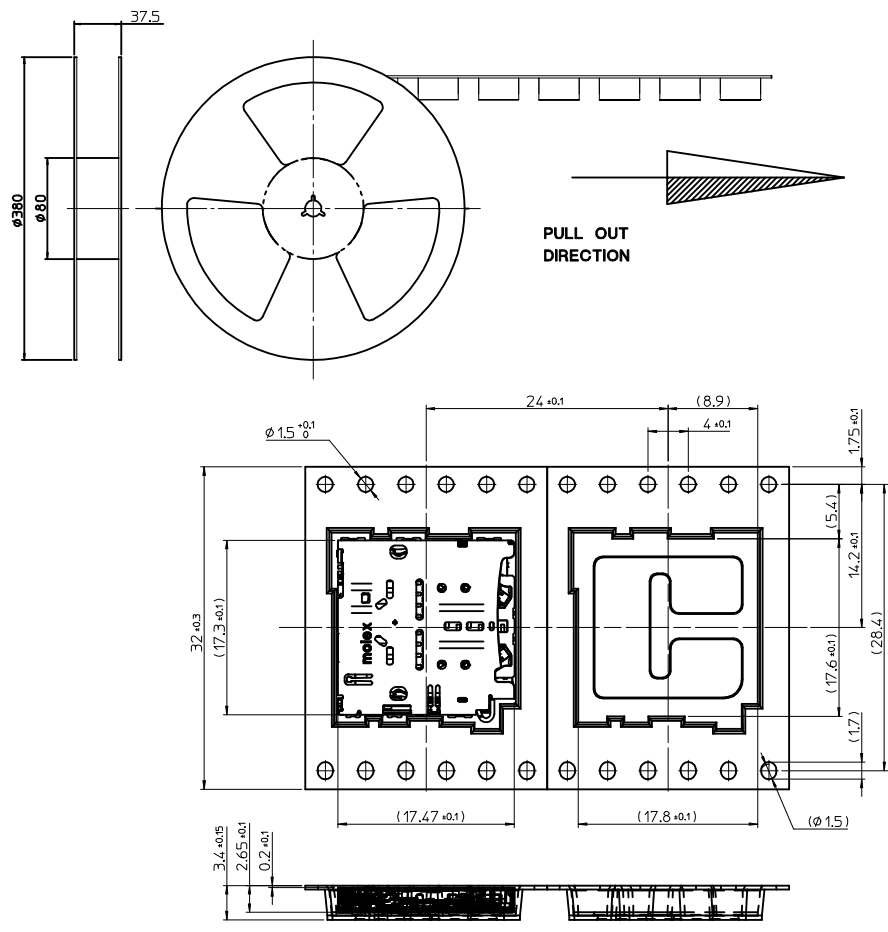

NOTES

- 1. QUANTITY OF CONNECTORS : 1,000PCS/REEL
- 2. LEAD LENGTH

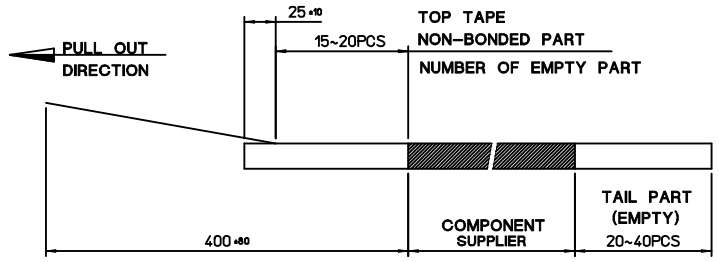

- 3. PEELING OFF FORCE OF COVER TAPE : 0.1N~0.59N(10.2GF~60GF)
(PEELING DIRECTION AS SHOW IN FOLLOW FIG.)
- PEELING OFF SPEED : 300mm/Min.(Ref.)

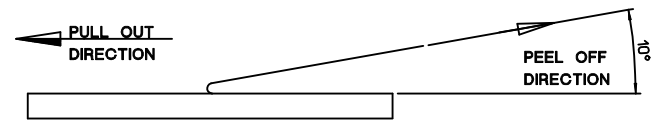

PROPOSAL EC NO: KOR2016-0090 DRWN: IHYOU 2016/09/24 CHKD: APPR: YSK1M02 2016/09/28	QUALITY SYMBOLS ▽ = 0 ◻ = 0	GENERAL TOLERANCES (UNLESS SPECIFIED) mm INCH 4 PLACES ± --- ± --- 3 PLACES ± --- ± --- 2 PLACES ± --- ± --- 1 PLACE ± 0.25 ± --- 0 PLACE ± --- ± --- ANGULAR ± 1 °	DIMENSION STYLE MM ONLY DRAWN BY: IHYOU DATE: 2016/01/21 CHECKED BY: SHCHU DATE: 2016/01/21 APPROVED BY: YSK1M02 DATE: 2016/09/28	SCALE 2/1	DESIGN UNITS METRIC	THIRD ANGLE PROJECTION
	DRAFT WHERE APPLICABLE MUST REMAIN WITHIN DIMENSIONS	MATERIAL NO. ENTER PART	TITLE MSD/NSIM COMBO SOCKET BAR-PUSH TRAY TYPE 2.45H 8P/6P	DOCUMENT NO. SD-104277-001	SHEET NO. 5 OF 5	
	THIS DRAWING CONTAINS INFORMATION THAT IS PROPRIETARY TO MOLEX INCORPORATED AND SHOULD NOT BE USED WITHOUT WRITTEN PERMISSION	molex				
	SIZE A3	INCORPORATED AND SHOULD NOT BE USED WITHOUT WRITTEN PERMISSION				

F

E

D

C

B

A

F

E

D

C

B

A

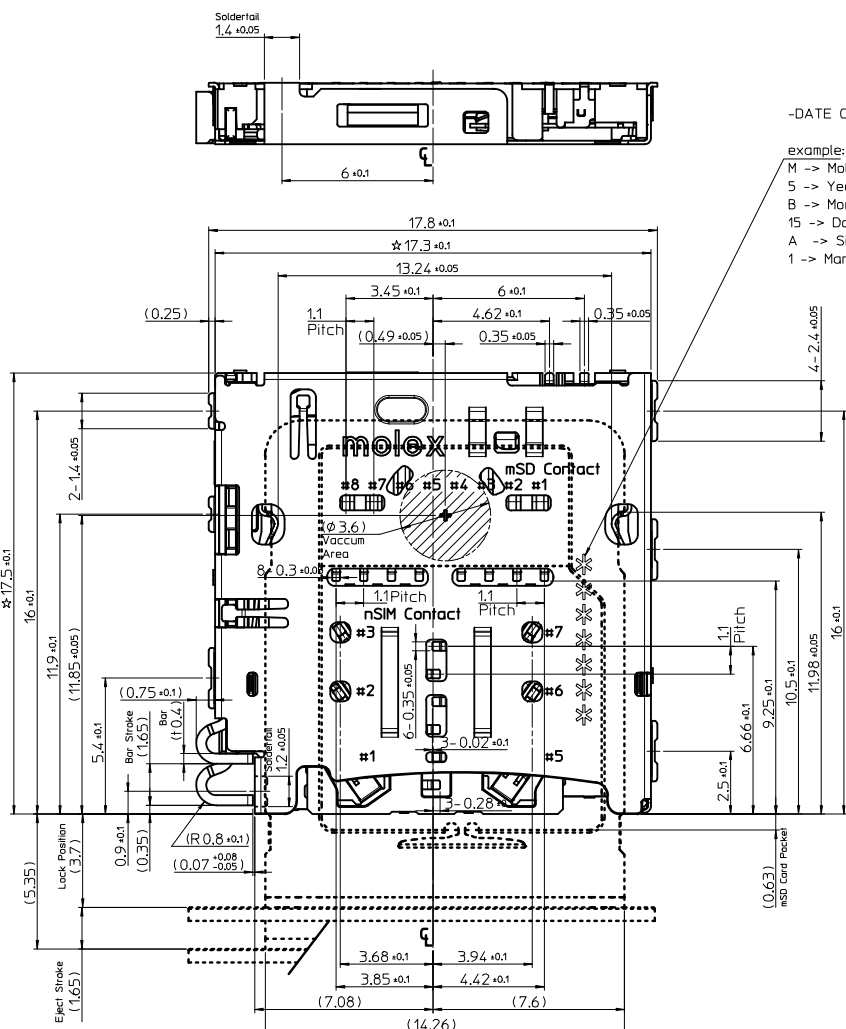

-DATE CODE-
 example: **M5B15A1**
 M -> Molex initial
 5 -> Year(2015)
 B -> Month(November) 1, ..., 9, A, B, C
 15 -> Date(15th)
 A -> Site initial(Ansant)
 1 -> Manufacture line number

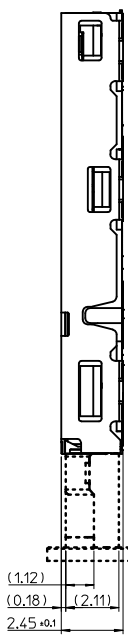

1. MATERIALS:
 - 1-1. HOUSING : HIGH TEMPERATURE THERMOPLASTIC,UL 94V-0, BLACK
 - 1-2. CONTACT & DETECT & SWITCH TER'L : COPPER ALLOY
 - 1-3. METAL SHELL & EJECT BAR & EJECT HINGE & RIGHT/LEFT LATCH : STAINLESS STEEL
2. FINISHES:
 - 2-1. CONTACT TER'L : 1.25-5.5 MICRON NICKEL UNDER-PLATED"
 - MIN. 0.05 MICRON GOLD ON CONTACT AREA,
 - MIN. 0.20 MICRON PALLADIUM-NICKEL ON mSD CONTACT AREA,
 - MIN. 0.30 MICRON PALLADIUM-NICKEL ON nSIM CONTACT AREA,
 - MIN. 0.05 MICRON GOLD ON SOLDER AREA
 - 2-2. DETECT & SWITCH TER'L : 1.25-5.5 MICRON NICKEL UNDER-PLATED"
 - MIN. 0.20 MICRON PALLADIUM-NICKEL ON CONTACT AREA,
 - MIN. 0.05 MICRON GOLD ON CONTACT AREA,
 - MIN. 0.05 MICRON GOLD ON SOLDER AREA
 - 2-3. METAL SHELL & EJECT HINGE & RIGHT/LEFT LATCH :
 - 1.25-5.5 MICRON NICKEL OVER ALL
- ★ 3. COPLANARITY OF SOLDER TAILS : 0.08mm MAX.(BEFORE & AFTER REFLOW)
4. PRODUCT SPECIFICATION : PS-104277-001
5. PACKAGING SPECIFICATION : SPK-104277-002
6. ★ IS CTF DIMENSION EQUAL TO MOLEX MAJOR QUALITY SYMBOLS

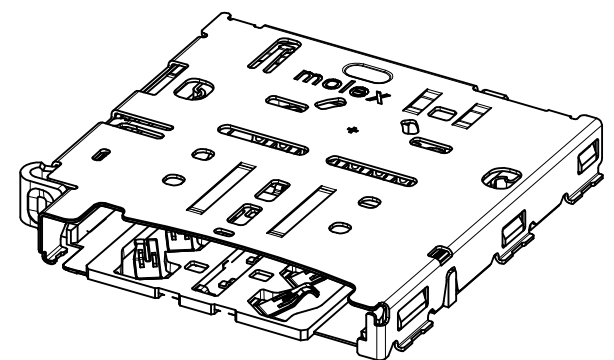

[Circuit diagram for Detection Switch of Card Tray]

Tray insertion condition	Tray detection switch	Circuit
Without Tray	Open	
Tray inserted	Close	

1042771421	104277-1421
MATERIAL NO.	ORDER NO.

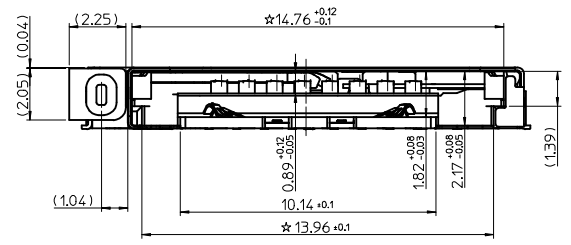

PROPOSAL
 EC NO: KOR2016-0090
 DRWN: IHYOU 2016/09/24
 CHKD: 2016/09/28
 APPR: YSKI M02
 REV

QUALITY SYMBOLS	GENERAL TOLERANCES (UNLESS SPECIFIED)
▽=0	mm INCH
▽=0	4 PLACES ± --- ± ---
	3 PLACES ± 0.12 ± ---
	2 PLACES ± 0.12 ± ---
	1 PLACE ± 0.15 ± ---
	0 PLACE ± 0.15 ± ---
	ANGULAR ± 1 °
	DRAFT WHERE APPLICABLE MUST REMAIN WITHIN DIMENSIONS

DIMENSION STYLE		SCALE	DESIGN UNITS	THIRD ANGLE PROJECTION
MM ONLY		5/1	METRIC	
DRAWN BY	DATE	TITLE		
IHYOU	2016/01/21	MSD/NSIM COMBO SOCKET BAR-PUSH TRAY TYPE 2.45H 8P/6P		
CHECKED BY	DATE	MATERIAL NO.		
SHCHU	2016/01/21	DOCUMENT NO.		
APPROVED BY	DATE	SHEET NO.		
YSKIM02	2016/09/28	1 OF 5		
MATERIAL NO.		SEE TABLE		
SIZE		THIS DRAWING CONTAINS INFORMATION THAT IS PROPRIETARY TO MOLEX INCORPORATED AND SHOULD NOT BE USED WITHOUT WRITTEN PERMISSION		
A3				

Detail_A
(Scale 8/1)
Solderfall : G3,G4

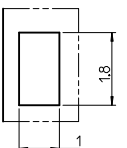

Detail_B
(Scale 8/1)
Solderfall : G2,G6,G7,G8

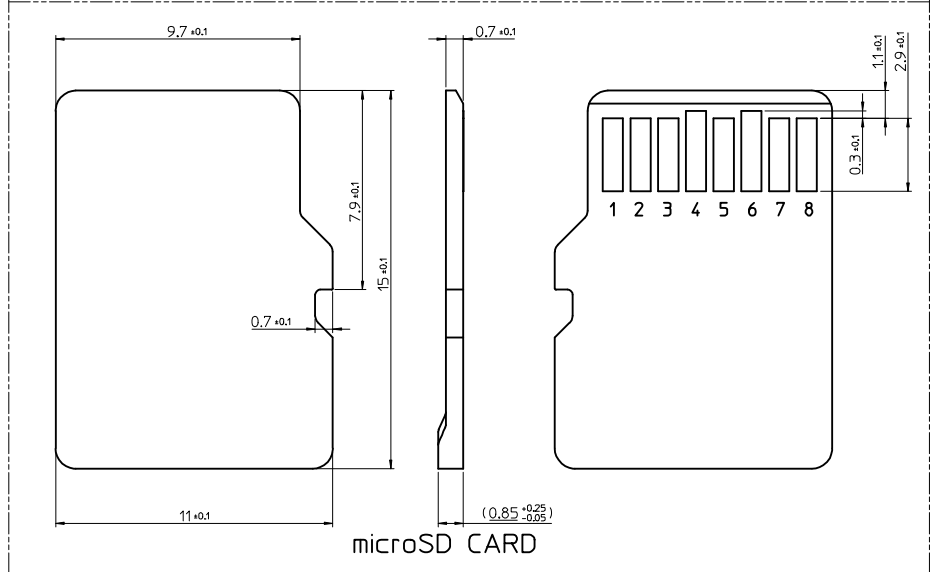
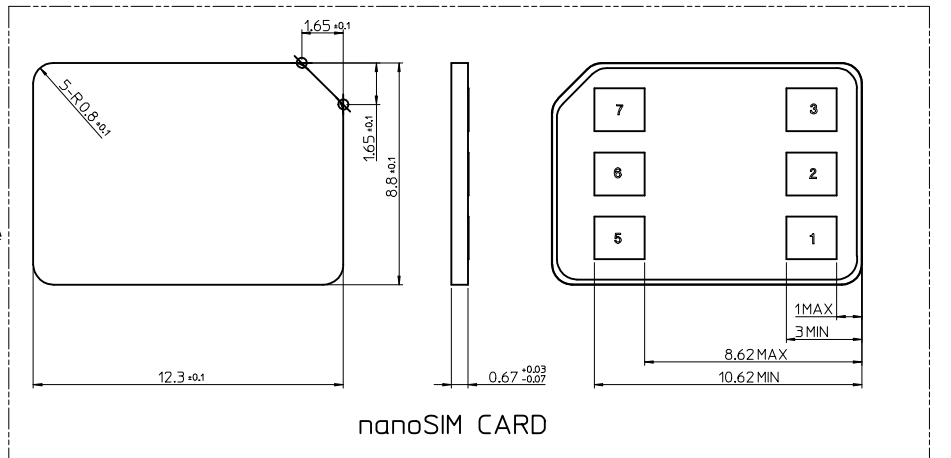
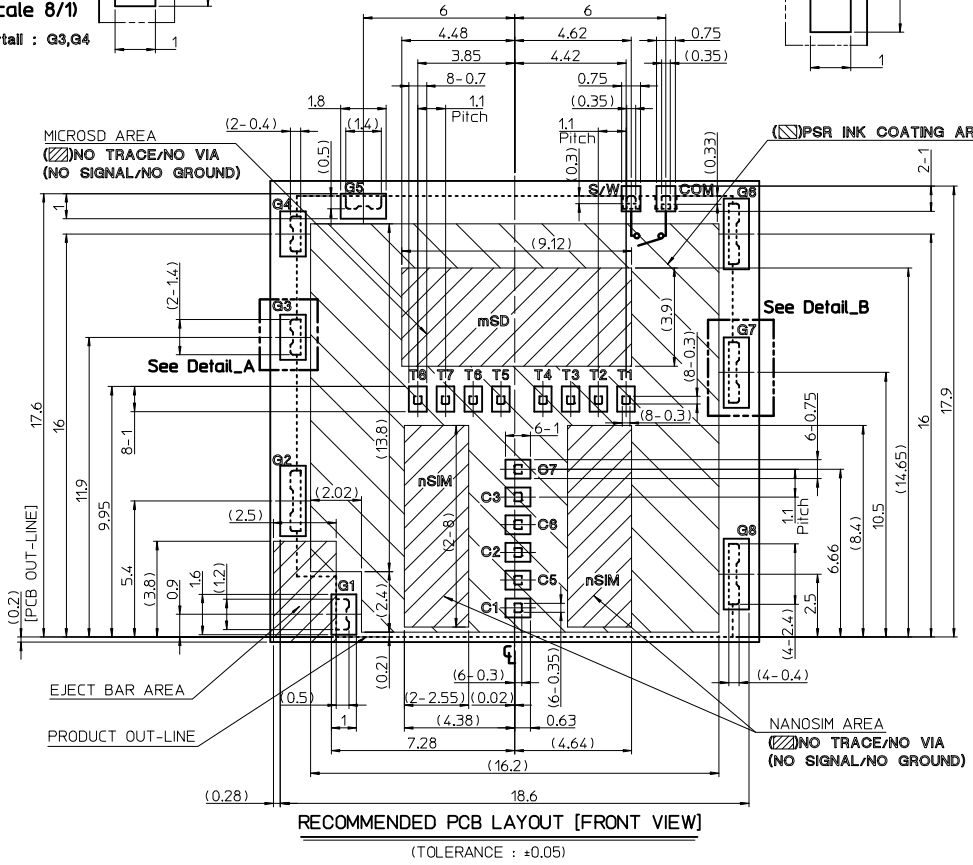
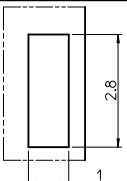

* This product has no C4, C8 Contact terminal [nanoSIM CARD PIN-MAP]

*There is only one tray insertion/removal detection switch physically.

Therefore, After tray detection, This product is necessary to detect the SIM or SD Card separately in software.

PIN NO.	DESCRIPTION
C1	Vcc(Supply V)
C2	RST(Reset)
C3	CLK(Clock)
(C4)	(None)
C5	GND(Ground)
C6	Vpp(Program V)
C7	I/O
(C8)	(None)

[microSD CARD PIN-MAP]

PIN NO.	DESCRIPTION
T1	DAT2
T2	CD/DAT3 ²
T3	COM
T4	V _{DD}
T5	CLK
T6	V _{SS} (GND)
T7	DAT0
T8	DAT1

G1-G8	GROUND or NOT CONNECT
S/W	TRAY DETECTOR
COM	GND or COMMON

PROPOSAL	EC NO: KOR2016-0090	2016/09/24
	DRWN:HYOU	2016/09/28
	CHKD:	
	APPR:YSK1M02	2016/09/28
REV	DESCRIPTION	

QUALITY SYMBOLS	GENERAL TOLERANCES (UNLESS SPECIFIED)	
	mm	INCH
▽=0	4 PLACES ± ---	± ---
◻=0	3 PLACES ± 0.12	± ---
	2 PLACES ± 0.12	± ---
	1 PLACE ± 0.15	± ---
	0 PLACE ± 0.15	± ---
	ANGULAR ± 1 °	
	DRAFT WHERE APPLICABLE MUST REMAIN WITHIN DIMENSIONS	

DIMENSION STYLE		SCALE	DESIGN UNITS	THIRD ANGLE PROJECTION
MM ONLY		5/1	METRIC	☉ □
DRAWN BY	DATE	TITLE		
IHYOU	2016/01/21	MSD/NSIM COMBO SOCKET BAR-PUSH TRAY TYPE 2.45H 8P/6P		
CHECKED BY	DATE			
SHCHU	2016/01/21			
APPROVED BY	DATE			
YSK1M02	2016/09/28			
MATERIAL NO.		DOCUMENT NO.		SHEET NO.
ENTER PART		SD-104277-001		2 OF 5
SIZE	THIS DRAWING CONTAINS INFORMATION THAT IS PROPRIETARY TO MOLEX INCORPORATED AND SHOULD NOT BE USED WITHOUT WRITTEN PERMISSION			
A3				

[Reference Standards]
 -. microSD Card Specification Addendum Version 4.00
 -. ETSI TS 102 221 V12.0.0, Smart Cards, UICC-Terminal interface, Physical and logical characteristics

- METAL MASK(Stencil): REFERENCE DRAWING
CONTACT 130%(C), SHELL & DETECT & SWITCH 150%(D)
- SCALE : 10/1
- SUS THICKNESS : 0.08t & 0.10t

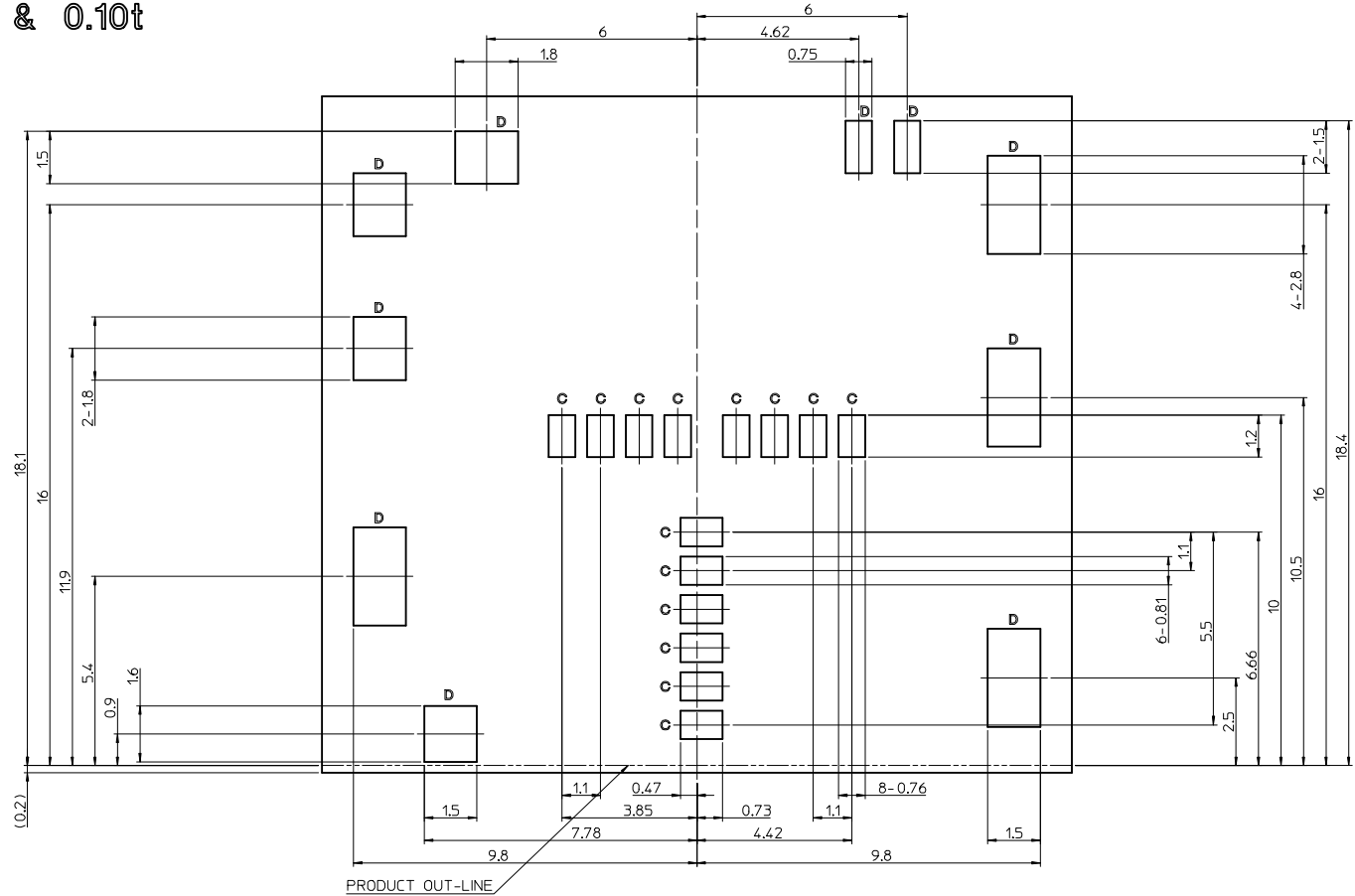

PROPOSAL EC NO: KOR2016-0090 DRWN: IHYOU 2016/09/24 CHKD: APPR: YSK1M02 2016/09/28	QUALITY SYMBOLS ▼=0 ◻=0	GENERAL TOLERANCES (UNLESS SPECIFIED) <table border="1"> <thead> <tr> <th></th> <th>mm</th> <th>INCH</th> </tr> </thead> <tbody> <tr> <td>4 PLACES</td> <td>± ---</td> <td>± ---</td> </tr> <tr> <td>3 PLACES</td> <td>± 0.12</td> <td>± ---</td> </tr> <tr> <td>2 PLACES</td> <td>± 0.12</td> <td>± ---</td> </tr> <tr> <td>1 PLACE</td> <td>± 0.15</td> <td>± ---</td> </tr> <tr> <td>0 PLACE</td> <td>± 0.15</td> <td>± ---</td> </tr> </tbody> </table>		mm	INCH	4 PLACES	± ---	± ---	3 PLACES	± 0.12	± ---	2 PLACES	± 0.12	± ---	1 PLACE	± 0.15	± ---	0 PLACE	± 0.15	± ---	DIMENSION STYLE MM ONLY	SCALE 7/1	DESIGN UNITS METRIC	THIRD ANGLE PROJECTION
		mm	INCH																					
	4 PLACES	± ---	± ---																					
	3 PLACES	± 0.12	± ---																					
	2 PLACES	± 0.12	± ---																					
1 PLACE	± 0.15	± ---																						
0 PLACE	± 0.15	± ---																						
DESCRIPTION ENTER PART	DRAWN BY IHYOU	DATE 2016/01/21	TITLE MSD/NSIM COMBO SOCKET BAR-PUSH TRAY TYPE 2.45H 8P/6P																					
DRAFT WHERE APPLICABLE MUST REMAIN WITHIN DIMENSIONS	CHECKED BY SHCHU	DATE 2016/01/21	molex																					
	APPROVED BY YSK1M02	DATE 2016/09/28	MATERIAL NO.	DOCUMENT NO. SD-104277-001	SHEET NO. 3 OF 5																			
	SIZE A3	THIS DRAWING CONTAINS INFORMATION THAT IS PROPRIETARY TO MOLEX INCORPORATED AND SHOULD NOT BE USED WITHOUT WRITTEN PERMISSION																						

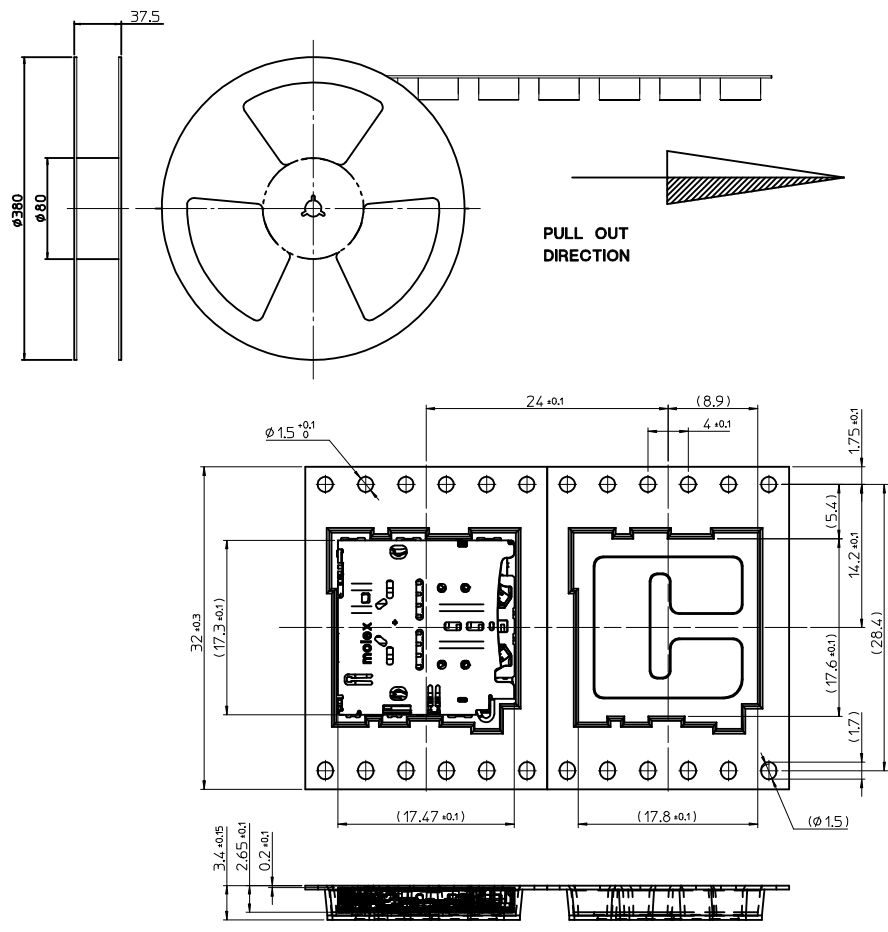

NOTES

- 1. QUANTITY OF CONNECTORS : 1,000PCS/REEL
- 2. LEAD LENGTH

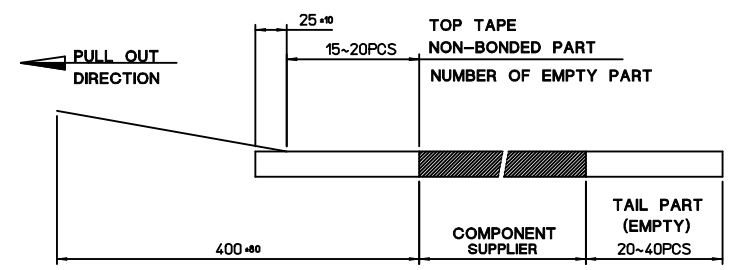

- 3. PEELING OFF FORCE OF COVER TAPE : 0.1N~0.59N(10.2GF~60GF)
(PEELING DIRECTION AS SHOW IN FOLLOW FIG.)
- PEELING OFF SPEED : 300mm/Min.(Ref.)

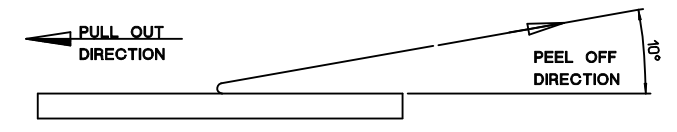

PROPOSAL EC NO: KOR2016-0090 DRWN: IHYOU 2016/09/24 CHKD: APPR: YSK1M02 2016/09/28	QUALITY SYMBOLS	GENERAL TOLERANCES (UNLESS SPECIFIED)	DIMENSION STYLE	SCALE	DESIGN UNITS	THIRD ANGLE PROJECTION																		
	$\nabla = 0$ $\sphericalangle = 0$	<table border="1"> <thead> <tr> <th></th> <th>mm</th> <th>INCH</th> </tr> </thead> <tbody> <tr> <td>4 PLACES</td> <td>± ---</td> <td>± ---</td> </tr> <tr> <td>3 PLACES</td> <td>± ---</td> <td>± ---</td> </tr> <tr> <td>2 PLACES</td> <td>± ---</td> <td>± ---</td> </tr> <tr> <td>1 PLACE</td> <td>± 0.25</td> <td>± ---</td> </tr> <tr> <td>0 PLACE</td> <td>± ---</td> <td>± ---</td> </tr> </tbody> </table>		mm	INCH	4 PLACES	± ---	± ---	3 PLACES	± ---	± ---	2 PLACES	± ---	± ---	1 PLACE	± 0.25	± ---	0 PLACE	± ---	± ---	MM ONLY	2/1	METRIC	
		mm	INCH																					
	4 PLACES	± ---	± ---																					
3 PLACES	± ---	± ---																						
2 PLACES	± ---	± ---																						
1 PLACE	± 0.25	± ---																						
0 PLACE	± ---	± ---																						
ANGULAR ± 1 ° DRAFT WHERE APPLICABLE MUST REMAIN WITHIN DIMENSIONS	DRAWN BY: IHYOU CHECKED BY: SHCHU APPROVED BY: YSK1M02 DATE: 2016/01/21 DATE: 2016/01/21 DATE: 2016/09/28	TITLE	MSD/NSIM COMBO SOCKET BAR-PUSH TRAY TYPE 2.45H 8P/6P																					
ENTER PART SIZE: A3 THIS DRAWING CONTAINS INFORMATION THAT IS PROPRIETARY TO MOLEX INCORPORATED AND SHOULD NOT BE USED WITHOUT WRITTEN PERMISSION	MATERIAL NO.	DOCUMENT NO.	molex SD-104277-001																					
REV						SHEET NO. 5 OF 5																		