

DO NOT SCALE FROM THIS PRINT

DESIGNED & DIMENSIONED IN MILLIMETERS [INCHES]

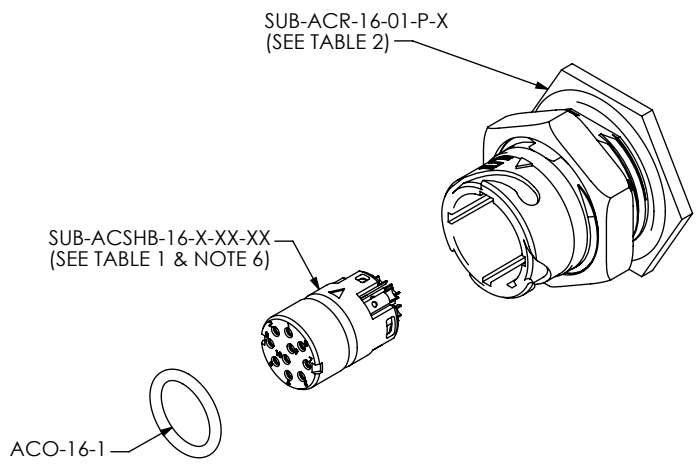

FIG 1
ACRK-16-02-X-S-C-P-1 SHOWN

ACRK-16-XX-X-X-XX-P-X

RECEPTACLE KIT
SIZE

KEY FEATURE (SEE NOTE 2, SHT. 4)
-1: ORANGE
-2: GREEN
-3: BLUE
-4: YELLOW

STYLE
-P: PLASTIC

- LEAD STYLE
- 01: 14 POS (0.5 TERM/SKT), 26 - 30 AWG
 - 02: 10 POS (1.0 TERM/SKT), 20 - 24 AWG
 - 03: 4 POS PWR (1.5 TERM/SKT), 14 - 18 AWG
 - * -04: 4 POS COMBO (2 X COAX PLUG/JACK), CCA-316 (2 X 1.0 TERM/SKT), 20 - 24 AWG
 - * -05: 4 POS COMBO (3 X 1.5 TERM/SKT), 14 - 18 AWG (1 X COAX PLUG/JACK), CCA-316
 - 06: 10 POS COMBO (2 X 1.5 TERM/SKT), 14 - 18 AWG (8 X 0.5 TERM/SKT), 26 - 30 AWG
 - * -07: 7 POS COMBO (1 X COAX PLUG/JACK), CCA-316 (6 X 1.0 TERM/SKT), 20 - 24 AWG

TERMINATION (SEE SHT. 4)
-C: SOLDER CUP
-B1: .062 BOARD MOUNT (NOT AVAILABLE WITH -04, -05, OR -07 LEAD STYLES.)

GENDER
-T: TERMINAL
-S: SOCKET

PLATING
-G: 10µ" GOLD ON CONTACT
-H: 30µ" GOLD ON CONTACT

* = NOT RELEASED FOR PRODUCTION

SUB-ACTHB-16-X-XX-XX (SEE TABLE 1 & NOTE 6)

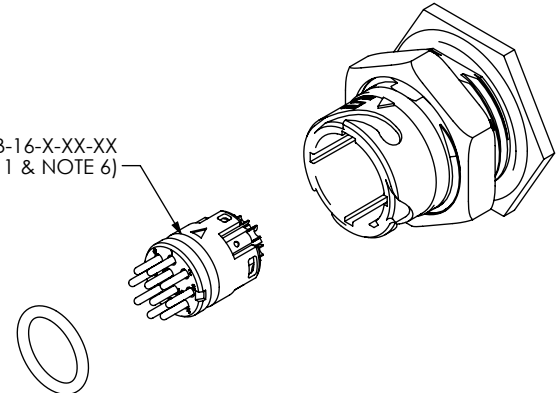

FIG 2
ACRK-16-02-X-T-C-P-1 SHOWN (SAME AS FIG 1, EXCEPT AS SHOWN)

KEY FEATURE	SUB-ACR-16-XX-P-X
-1	SUB-ACR-16-01-P-1
-2	SUB-ACR-16-01-P-2
-3	SUB-ACR-16-01-P-3
-4	SUB-ACR-16-01-P-4

NOTES:

1. KIT COMPONENTS TO BE PACKAGED IN BAGS PER PACKAGING STANDARD CO-RF-WI-3001-M.
2. KEY FEATURE DETERMINES COLOR OF COLOR KEY RING AND DUSTCAP LANYARD IF APPLICABLE.
3. REFER TO DCA-ACR-16-P-X PRINT FOR DUST CAP.
4. PANEL THICKNESS RANGE: 0.80[.031] - 5.20[.205].
5. TORQUE SPECIFICATION FOR PANEL NUT: 1.7Nm[15.00 IN-LB] - 2.3Nm[20.00 IN-LB].
6. RECOMMENDED INSERTION TOOL: CAT-AC-16-M.
7. NOTE DELETED.

LEAD STYLES	GENDER	TERMINATION					
		-C: SOLDER CUP			-B1: BOARD MOUNT		
		SUB-ASSEMBLY/HOLDER BODY PART #		COAX PLUG/JACK PART #		SUB-ASSEMBLY PART #	
		PLATING		AC-X-CH-ST-CA1	QTY	PLATING	
-G	-H	-G	-H				
-01	-T	SUB-ACTHB-16-G-01	SUB-ACTHB-16-H-01	NA		SUB-ACTHB-16-G-01-B1	SUB-ACTHB-16-H-01-B1
-02	-T	SUB-ACTHB-16-G-02	SUB-ACTHB-16-H-02	NA		SUB-ACTHB-16-G-02-B1	SUB-ACTHB-16-H-02-B1
-03	-T	SUB-ACTHB-16-G-03	SUB-ACTHB-16-H-03	NA		SUB-ACTHB-16-G-03-B1	SUB-ACTHB-16-H-03-B1
-04	-T	SUB-ACTHB-16-G-04	SUB-ACTHB-16-H-04	AC-P-C-H-ST-CA1	2	NA	NA
-05	-T	SUB-ACTHB-16-G-05	SUB-ACTHB-16-H-05	AC-P-C-H-ST-CA1	1	NA	NA
-06	-T	SUB-ACTHB-16-G-06	SUB-ACTHB-16-H-06	NA		SUB-ACTHB-16-G-06-B1	SUB-ACTHB-16-H-06-B1
-07	-T	SUB-ACTHB-16-G-07	SUB-ACTHB-16-H-07	AC-P-C-H-ST-CA1	1	NA	NA
-01	-S	SUB-ACSHB-16-G-01	SUB-ACSHB-16-H-01	NA		SUB-ACSHB-16-G-01-B1	SUB-ACSHB-16-H-01-B1
-02	-S	SUB-ACSHB-16-G-02	SUB-ACSHB-16-H-02	NA		SUB-ACSHB-16-G-02-B1	SUB-ACSHB-16-H-02-B1
-03	-S	SUB-ACSHB-16-G-03	SUB-ACSHB-16-H-03	NA		SUB-ACSHB-16-G-03-B1	SUB-ACSHB-16-H-03-B1
-04	-S	SUB-ACSHB-16-G-04	SUB-ACSHB-16-H-04	AC-J-C-H-ST-CA1	2	NA	NA
-05	-S	SUB-ACSHB-16-G-05	SUB-ACSHB-16-H-05	AC-J-C-H-ST-CA1	1	NA	NA
-06	-S	SUB-ACSHB-16-G-06	SUB-ACSHB-16-H-06	NA		SUB-ACSHB-16-G-06-B1	SUB-ACSHB-16-H-06-B1
-07	-S	SUB-ACSHB-16-G-07	SUB-ACSHB-16-H-07	AC-J-C-H-ST-CA1	1	NA	NA

UNLESS OTHERWISE SPECIFIED, DIMENSIONS ARE IN MILLIMETERS. TOLERANCES ARE:
DECIMALS ANGLES
X.X: ±0.3 [.01] 2°
X.XX: ±0.13 [.005]
X.XXX: ±0.051 [.0020]

PROPRIETARY NOTE
THIS DOCUMENT CONTAINS CONFIDENTIAL AND PROPRIETARY INFORMATION AND ALL DESIGN, MANUFACTURING, REPRODUCTION, USE, PATENT RIGHTS AND SALES RIGHTS ARE EXPRESSLY RESERVED BY SAMTEC, INC. THIS DOCUMENT SHALL NOT BE DISCLOSED, IN WHOLE OR PART, TO ANY UNAUTHORIZED PERSON OR ENTITY NOR REPRODUCED, TRANSFERRED OR INCORPORATED IN ANY OTHER PROJECT IN ANY MANNER WITHOUT THE EXPRESS WRITTEN CONSENT OF SAMTEC, INC.

520 PARK EAST BLVD, NEW ALBANY, IN 47150
PHONE: 812.944.6733 FAX: 812.948.5047
e-Mail: info@SAMTEC.com code 53322

MATERIAL: DO NOT SCALE DRAWING SHEET SCALE: 1:1
SHELL/NUT: NYLON, COLOR: BLACK
HOLDER BODY: PBT, COLOR: BLACK
O-RING: NITRILE
COLOR RING: SILICONE
TERMINALS: BRASS
CONTACTS: BRASS/BeCu

DESCRIPTION:
ACCLIMATE CIRC. FIELD TERM. KIT
DWG. NO.
ACRK-16-XX-X-X-XX-P-X
BY: J. BORGELT 3/7/2011 SHEET 1 OF 4

-T END OPTIONS

-01: 14 POS
Ø0.5 TERMINALS

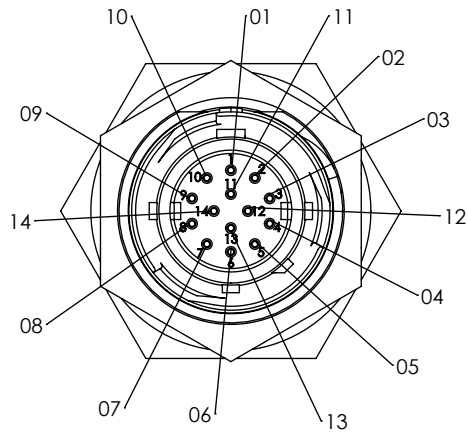

-02: 10 POS
Ø1.0 TERMINALS

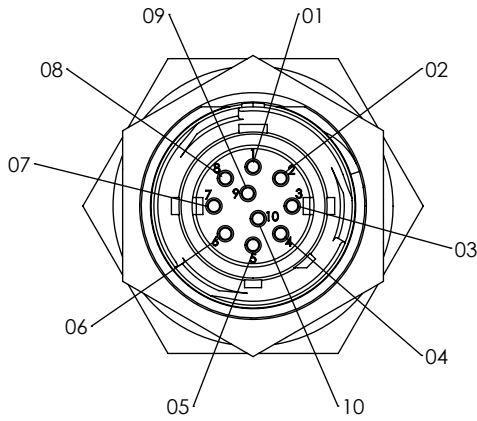

-03: 4 POS
Ø1.5 TERMINALS

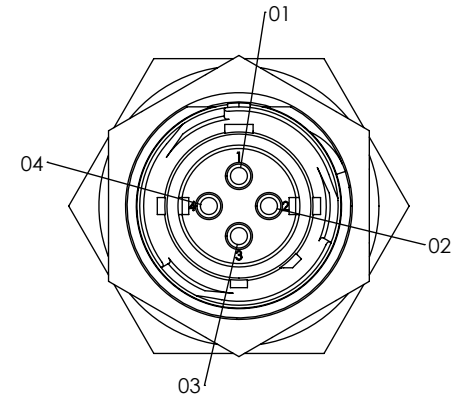

-04: 3 POS COMBO
2 X COAX PLUGS
2 X Ø1.0 TERMINALS

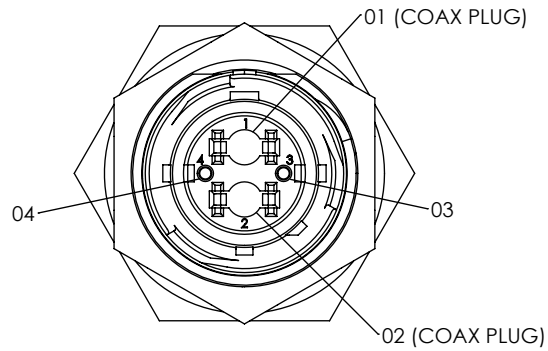

-05: 4 POS COMBO
3 X Ø1.5 TERMINALS
1 X COAX PLUG

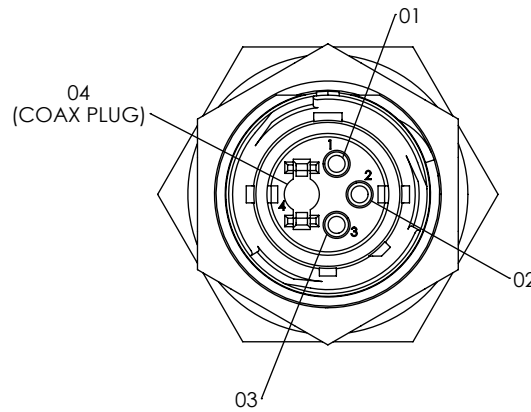

-06: 10 POS COMBO
2 X Ø1.5 TERMINALS
8 X Ø0.5 TERMINALS

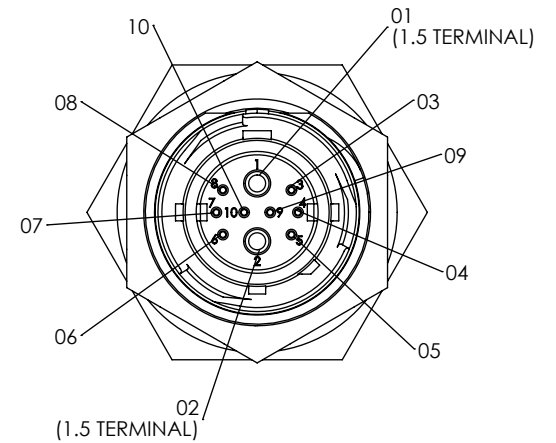

-07: 7 POS COMBO
1 X COAX PLUG
6 X Ø1.0 TERMINALS

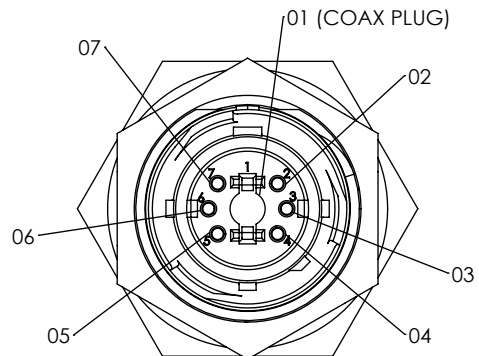

PROPRIETARY NOTE
THIS DOCUMENT CONTAINS CONFIDENTIAL AND PROPRIETARY INFORMATION AND ALL DESIGN, MANUFACTURING, REPRODUCTION, USE, PATENT RIGHTS AND SALES RIGHTS ARE EXPRESSLY RESERVED BY SAMTEC, INC. THIS DOCUMENT SHALL NOT BE DISCLOSED, IN WHOLE OR PART, TO ANY UNAUTHORIZED PERSON OR ENTITY NOR REPRODUCED, TRANSFERRED OR INCORPORATED IN ANY OTHER PROJECT IN ANY MANNER WITHOUT THE EXPRESS WRITTEN CONSENT OF SAMTEC, INC.

DO NOT SCALE DRAWING

SHEET SCALE: 1:5:1



520 PARK EAST BLVD, NEW ALBANY, IN 47150
PHONE: 812-944-6733 FAX: 812-948-5047
e-Mail info@SAMTEC.com code 55322

DESCRIPTION: ACCLIMATE CIRC. FIELD TERM. KIT

DWG. NO. ACRK-16-XX-X-X-XX-P-X

BY: J. BORGELT 3/7/2011 SHEET 2 OF 4

-S END OPTIONS

-01: 14 POS
Ø0.5 SOCKETS

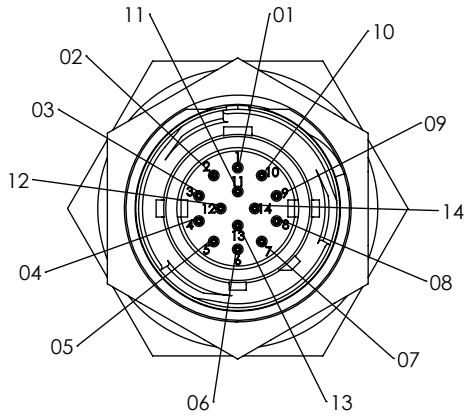

-02: 10 POS
Ø1.0 SOCKETS

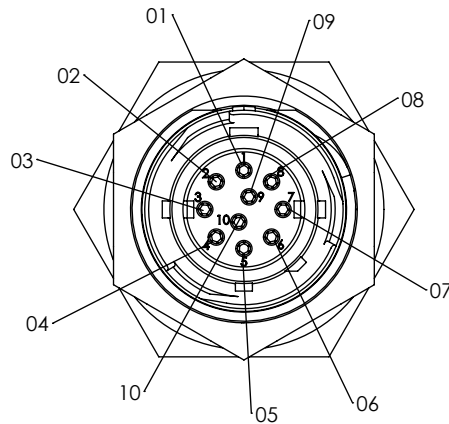

-03: 4 POS
Ø1.5 SOCKETS

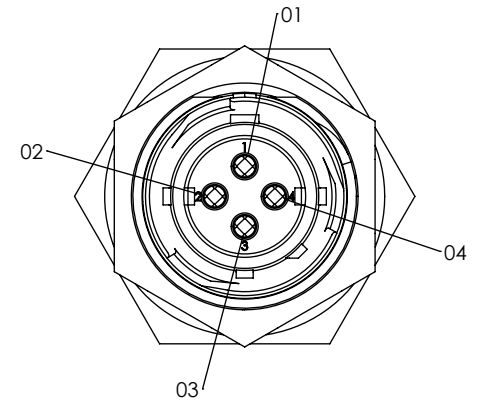

-04: 4 POS COMBO
2 X COAX JACKS
2 X Ø1.0 TERMINALS

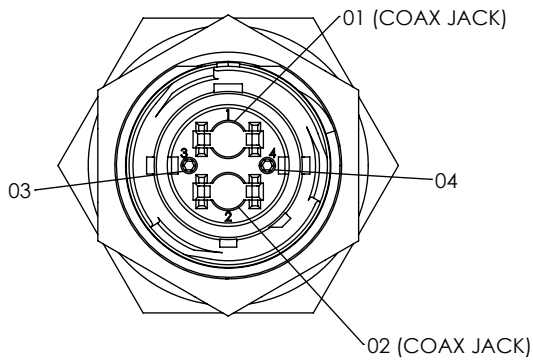

-05: 4 POS COMBO
3 X Ø1.5 SOCKETS
1 X COAX JACK

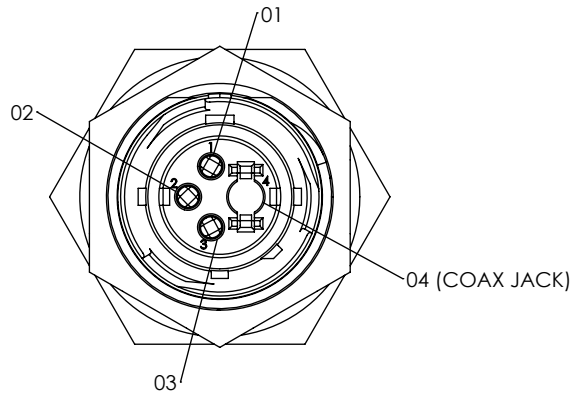

-06: 10 POS COMBO
2 X Ø1.5 SOCKETS
8 X Ø0.5 SOCKETS

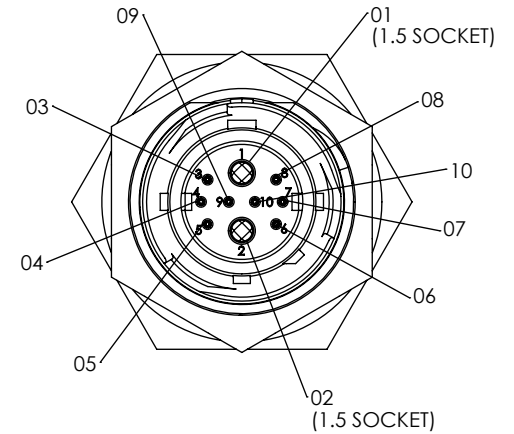

-07: 7 POS COMBO
1 X COAX JACK
6 X Ø1.0 SOCKETS

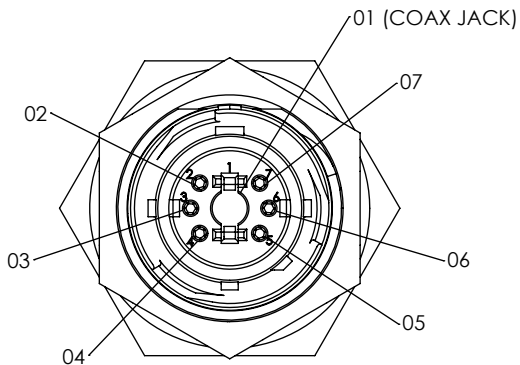

PROPRIETARY NOTE
THIS DOCUMENT CONTAINS CONFIDENTIAL AND PROPRIETARY INFORMATION AND ALL DESIGN, MANUFACTURING, REPRODUCTION, USE, PATENT RIGHTS AND SALES RIGHTS ARE EXPRESSLY RESERVED BY SAMTEC, INC. THIS DOCUMENT SHALL NOT BE DISCLOSED, IN WHOLE OR PART, TO ANY UNAUTHORIZED PERSON OR ENTITY NOR REPRODUCED, TRANSFERRED OR INCORPORATED IN ANY OTHER PROJECT IN ANY MANNER WITHOUT THE EXPRESS WRITTEN CONSENT OF SAMTEC, INC.

DO NOT SCALE DRAWING

SHEET SCALE: 1.5:1

samtec

520 PARK EAST BLVD, NEW ALBANY, IN 47150
PHONE: 812-944-6733 FAX: 812-948-5047
e-Mail info@SAMTEC.com code 55322

DESCRIPTION: ACCLIMATE CIRC. FIELD TERM. KIT

DWG. NO. ACRK-16-XX-X-X-XX-P-X

BY: J. BORGELT 3/7/2011 SHEET 3 OF 4

REVISION B

-C: SOLDER CUP
ACRK-16-02-X-S-C-P-1 SHOWN

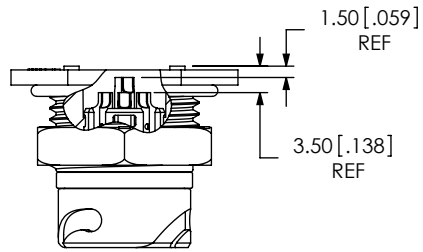
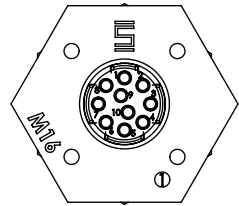
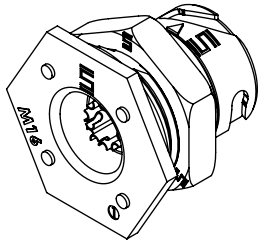

-B1: BOARD MOUNT
ACRK-16-02-X-S-B1-P-1 SHOWN

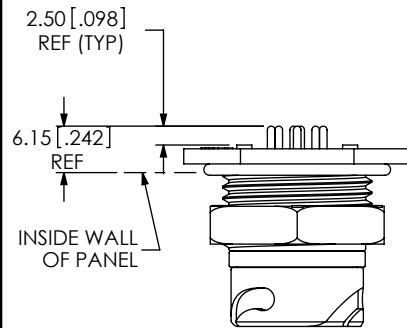
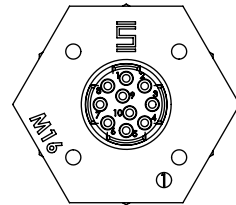
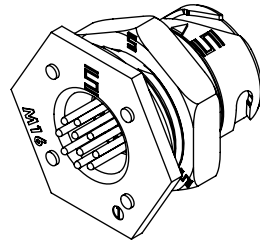

RECOMMENDED PANEL OPENING
SEE NOTE 4

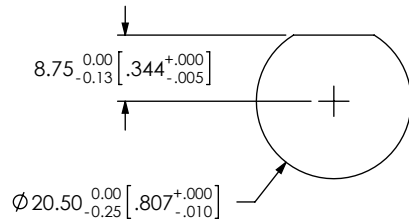

KEY FEATURE
SEE NOTE 2

-1
ORANGE KEY RING

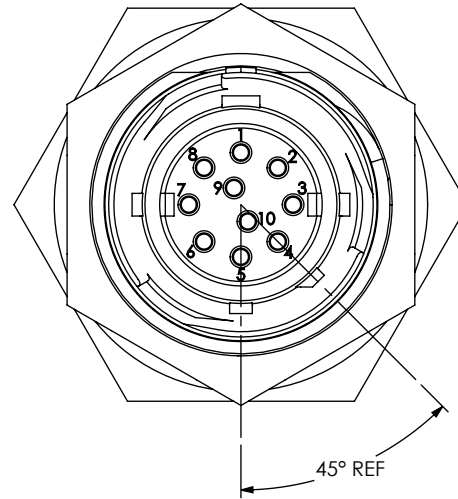

-2
GREEN KEY RING

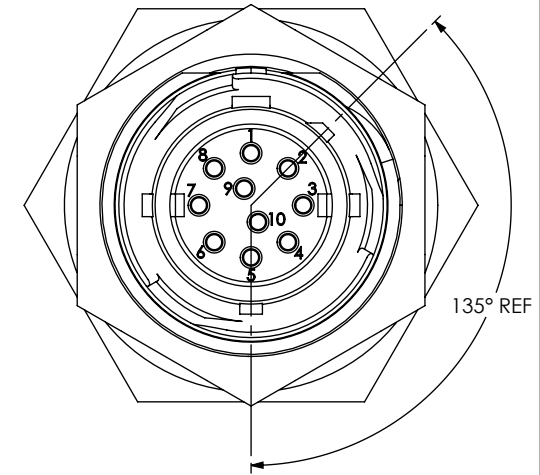

-3
BLUE KEY RING

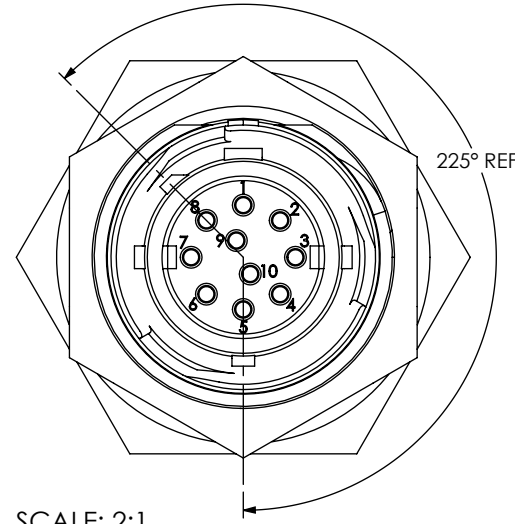

-4
YELLOW KEY RING

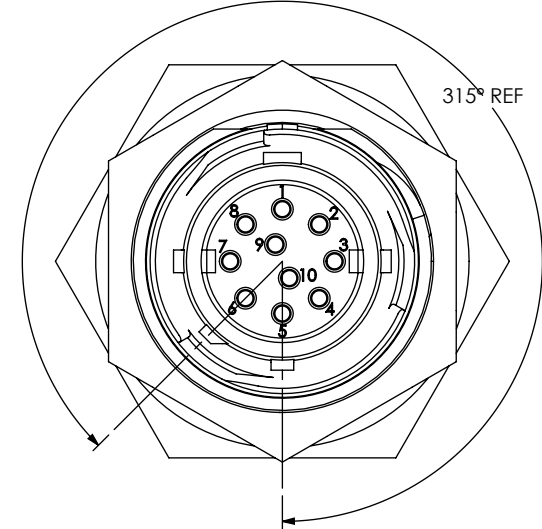

SCALE: 2:1

PROPRIETARY NOTE

THIS DOCUMENT CONTAINS CONFIDENTIAL AND PROPRIETARY INFORMATION AND ALL DESIGN, MANUFACTURING, REPRODUCTION, USE, PATENT RIGHTS AND SALES RIGHTS ARE EXPRESSLY RESERVED BY SAMTEC, INC. THIS DOCUMENT SHALL NOT BE DISCLOSED, IN WHOLE OR PART, TO ANY UNAUTHORIZED PERSON OR ENTITY NOR REPRODUCED, TRANSFERRED OR INCORPORATED IN ANY OTHER PROJECT IN ANY MANNER WITHOUT THE EXPRESS WRITTEN CONSENT OF SAMTEC, INC.

DO NOT SCALE DRAWING

SHEET SCALE: 1:1



520 PARK EAST BLVD, NEW ALBANY, IN 47150
PHONE: 812-944-6733 FAX: 812-948-5047
e-Mail info@SAMTEC.com code 55322

DESCRIPTION: ACCLIMATE CIRC. FIELD TERM. KIT

DWG. NO. ACRK-16-XX-X-X-XX-P-X

BY: J. BORGELT 3/7/2011 SHEET 4 OF 4