

THIS DRAWING IS UNPUBLISHED. RELEASED FOR PUBLICATION
 © COPYRIGHT BY TYCO ELECTRONICS CORPORATION. ALL RIGHTS RESERVED.

LOC	DIST	REVISIONS					
FT	0	P	LTR	DESCRIPTION	DATE	DWN	APVD
		G		REVISED PER ECO-05-2193	5/17/05	SS	CR

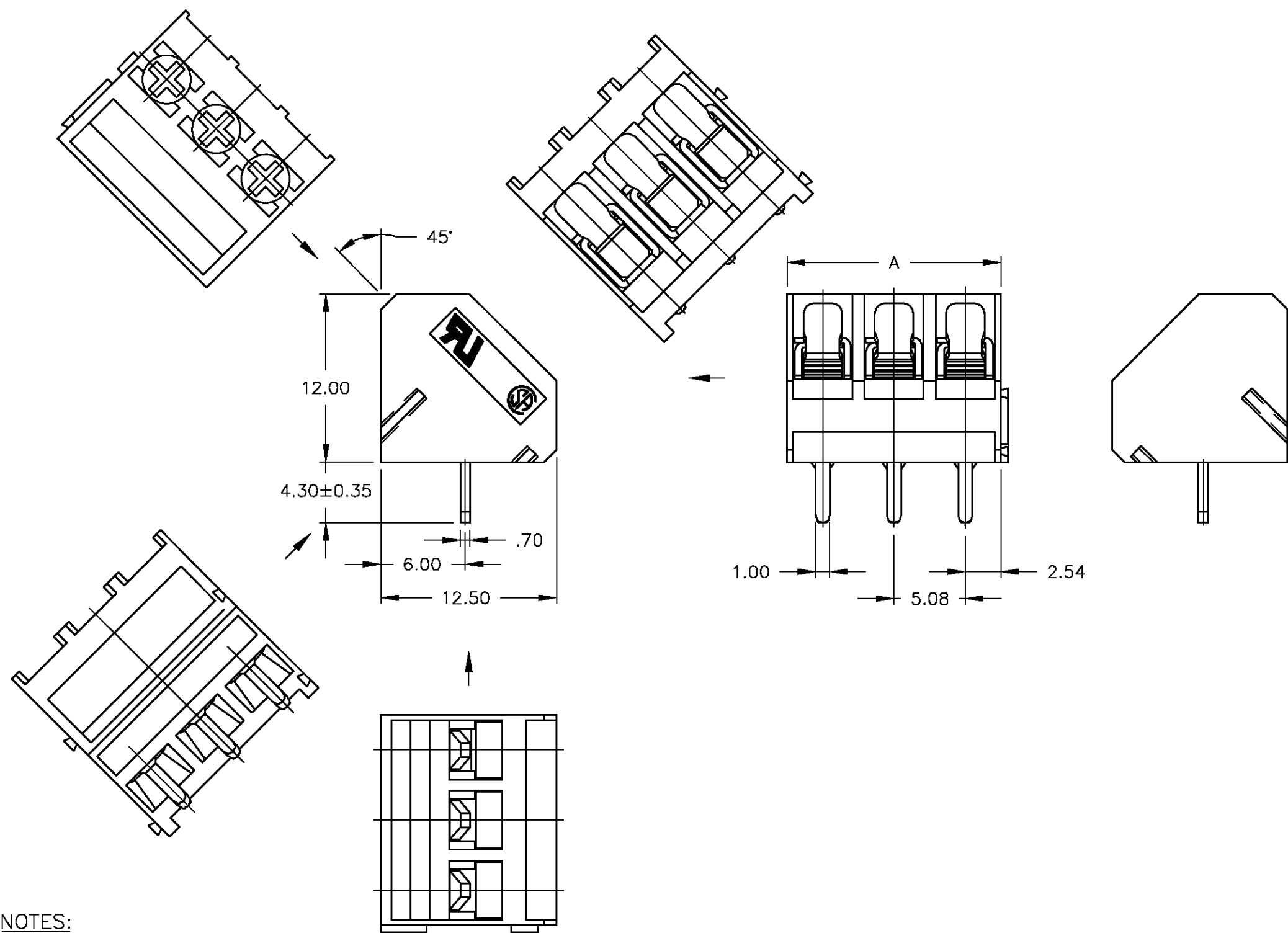

DIM. A	NO. OF POS.	PART NUMBER
15.24	3	3-796423-3
10.16	2	3-796423-2
86.36	17	2-796423-7
71.12	14	2-796423-6
10.16	2	2-796423-5
121.92	24	2-796423-4
116.84	23	2-796423-3
111.76	22	2-796423-2
106.68	21	2-796423-1
101.60	20	2-796423-0
96.52	19	1-796423-9
91.44	18	1-796423-8
86.36	17	1-796423-7
81.28	16	1-796423-6
76.20	15	1-796423-5
71.12	14	1-796423-4
66.04	13	1-796423-3
60.96	12	1-796423-2
55.88	11	1-796423-1
50.80	10	1-796423-0
45.72	9	796423-9
40.64	8	796423-8
35.56	7	796423-7
30.48	6	796423-6
25.40	5	796423-5
20.32	4	796423-4
15.24	3	796423-3
10.16	2	796423-2

- NOTES:
- ALL DIMENSIONS ARE IN MM.
 - BUCHANAN LOGO TO APPEAR ON HOUSING LOCATION OPTIONAL WHERE SPACE PERMITS.
- ③ MARKED WITH PERMANENT INK.
 - ④ PRELIMINARY PART NUMBER.
 - ⑤ SLOTTED HEAD SCREW, NOT PHILLIPS AS SHOWN.

THIS DRAWING IS A CONTROLLED DOCUMENT.		DWN E. ZANOLINI 25JAN01	Tyco Electronics Corporation Harrisburg, Pa 17105-3608	
DIMENSIONS: mm		CHK E. ZANOLINI 25JAN01		
TOLERANCES UNLESS OTHERWISE SPECIFIED:		APVD D. BIEVENOUR 25JAN01	NAME	
0 PLC ± - 1 PLC ± .3 2 PLC ± .25 3 PLC ± - 4 PLC ± - ANGLES ± -		PRODUCT SPEC	TERMINAL BLOCK 45 DEGREE INLET W/INTERLOCK, 5.08mm PITCH (LT)	
MATERIAL		APPLICATION SPEC	SIZE	RESTRICTED TO
FINISH		WEIGHT	A3	
		CUSTOMER DRAWING	CAGE CODE	DRAWING NO
			00779	796423
		SCALE	SHEET	REV
		NTS	1 OF 2	G

THIS DRAWING IS UNPUBLISHED. RELEASED FOR PUBLICATION
 © COPYRIGHT BY TYCO ELECTRONICS CORPORATION. ALL RIGHTS RESERVED.

LOC	DIST	REVISIONS					
FT	0	P	LTR	DESCRIPTION	DATE	DWN	APVD
				SEE SHEET 1			

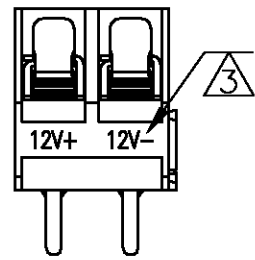

2-796423-5

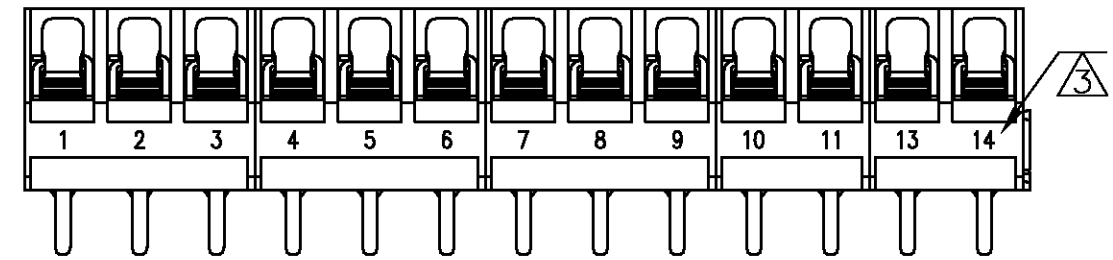

2-796423-6

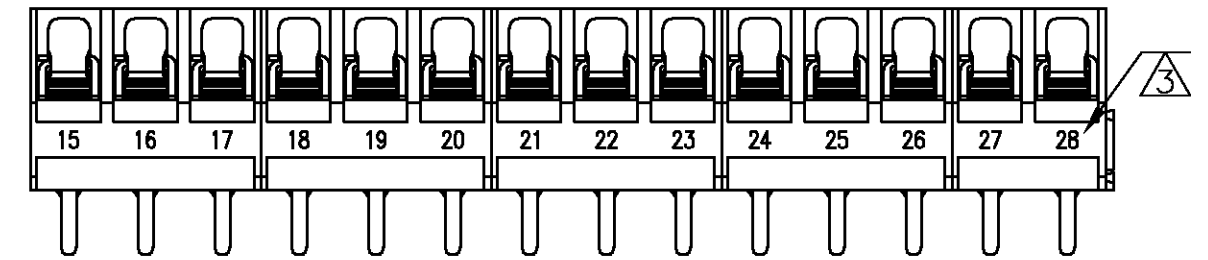

2-796423-7

1. Application and Features:

- 1-1. This series of terminal block has a built-in self lift wire guard clamp to protect against wire pinching.
- 1-2. Standard sizes are 2 and 3 way-blocks, but every number of contact can be combined, by simply plugging them together and can be ordered as required**
- 1-3. Since the wire inlet and the screw are in a 45° position, these terminal blocks are designed specifically to solve poor accessibility problems.

2-2. Electrical:

- 2-2-1. Current rating: 10 Amps/way max.
- 2-2-2. Contact resistance: 20mΩ (Max).
- 2-2-3. Insulation resistance: 5000MΩ /1000V.
- 2-2-4. Withstanding Voltage: 1500VAC (1min).
test time =60sec/1pcs
- 2-2-5. Operation Voltage: 300 VAC.
- 2-2-6. Wire Range: 14-22 AWG.

2. Technical Data:

2-1. Material:

- 2-1-1. HOUSING: PBT (Glass filled), or NY-FR15 UL 94 V-0 (Blue).
- 2-1-2. Contact: Brass(Cu Zn)
Cu, Tin plated.
- 2-1-3. Screw: Steel galvanized and chromitized, M2.6

2-3. Mechanical:

- 2-3-1. Torque: 4 Kg.cm (Max).
- 2-3-2. Operating temperature: -55°C to +105°C.
- 2-3-3. Solderability: 95% coverage (min).
test temperature=230°C±10°C
test time= 3sec ± 0.5sec.

THIS DRAWING IS A CONTROLLED DOCUMENT.		DWN	E. ZANOLINI	25JAN01	 Tyco Electronics Corporation Harrisburg, Pa 17105-3608			
DIMENSIONS: mm		CHK	E. ZANOLINI	25JAN01				
		APVD	D. BIEVENOUR	25JAN01				
TOLERANCES UNLESS OTHERWISE SPECIFIED:		PRODUCT SPEC			NAME TERMINAL BLOCK 45 DEGREE WIRE INLET W/INTERLOCK, 5.08mm PITCH (LT)			
0 PLC ± - 1 PLC ± - 2 PLC ± - 3 PLC ± - 4 PLC ± - ANGLES ± -		APPLICATION SPEC						
MATERIAL		WEIGHT			SIZE	CAGE CODE	DRAWING NO	RESTRICTED TO
-		-			A3	00779	C-796423	-
CUSTOMER DRAWING					SCALE	NTS	SHEET	2 OF 2
							REV	G