

THIS DRAWING IS UNPUBLISHED. RELEASED FOR PUBLICATION
 © COPYRIGHT 2010 BY TYCO ELECTRONICS CORPORATION. ALL RIGHTS RESERVED.

| | | | | | |
|-----|-----|-----------------|-----------|-----|------|
| LOC | DW | DIST | REVISIONS | | |
| P | LTR | DESCRIPTION | DATE | DWN | APVD |
| F | | (ECO-19-011949) | 26NOV2019 | R.R | S.H |

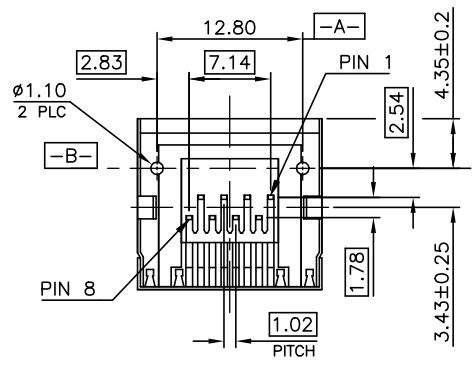
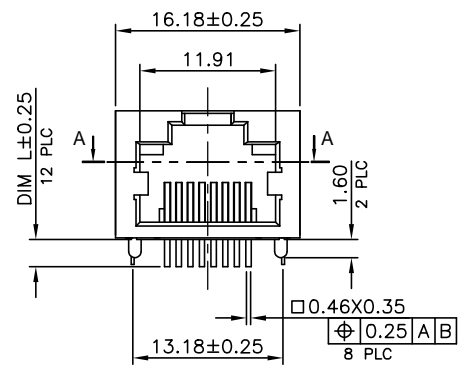
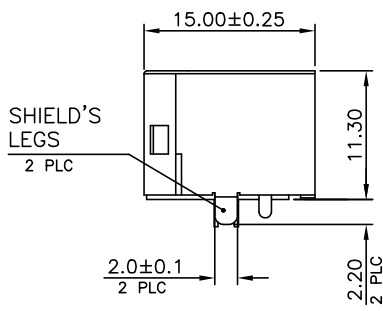
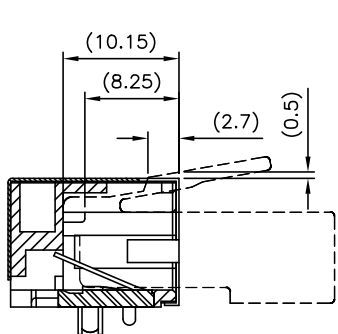
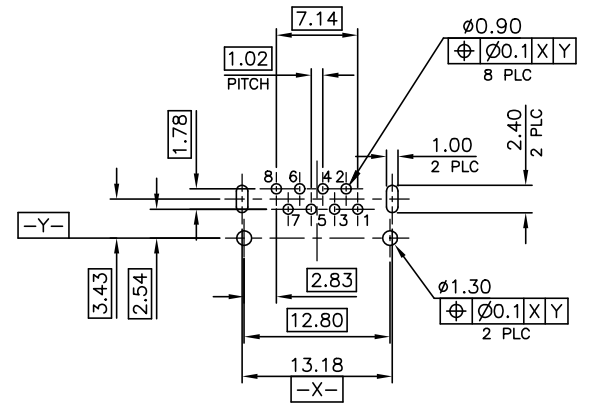
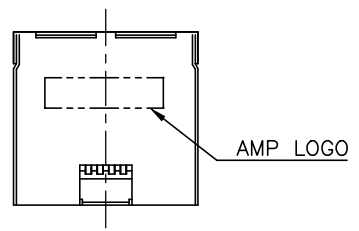
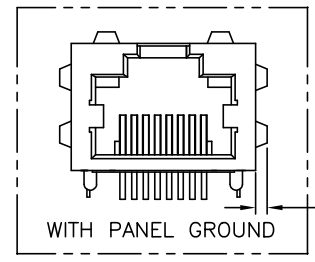
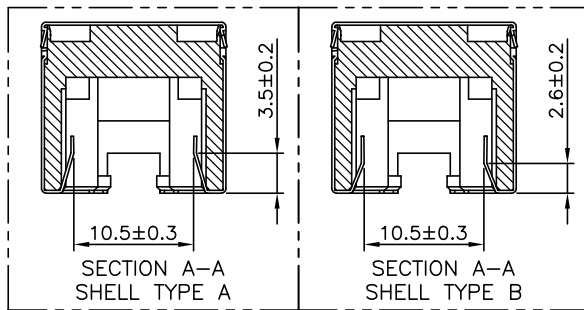

RECOMMENDED PCB LAYOUT (THICKNESS: 1.6MM)
 (DIMENSION TOLERANCE: 1 PLC: ±0.1, 2 PLC: ±0.05)

- NOTE:
- MATERIAL:
 - HOUSING: PA9T WITH 30% GF, UL94 V-0, BLACK COLOR.
 - CONTACTS: PHOSPHOR BRONZE.
 - SHELL: BRASS.
 - FINISH:
 - CONTACTS: (SEE TABLE) GOLD PLATED ON CONTACT AREA. GOLD FLASH ON SOLDER TAIL. 1.27um [50u"] MIN. NICKEL UNDERPLATED OVERALL.
 - SHELL: 0.51um [20u"] MIN. NICKEL PLATED.
 - WAVE SOLDER CAPABLE TO 265°C PER TYCO TEST SPEC. 109-202, CONDITION B.
- ⚠ OBSOLETE PART : OBSOLETE CIS STREAMLINING PER D.RENAUD/D.SINISI
 ⚠ HOUSING: PA4T WITH GLASS FIBER, UL94 V-0, BLACK COLOR.
 ⚠ LOW BR/CL AS DEFINED IN TEC-138-702.

| TAPE & REEL | W/O | TYPE A | 2.2 | 6u" | 3-1734795-2 | |
|--------------|--------------|--------|------------|-------|----------------------|-------------|
| OBSOLETE | W/ | W/O | 1.5 | 6u" | 3-1734795-1 | |
| | | | | 50u" | 1734795-8 | |
| | | | | 30u" | 1734795-7 | |
| | | | | 15u" | 3-1734795-6 | |
| | | | | 15u" | 1734795-6 | |
| | | | | 6u" | 1734795-5 | |
| TRAY | W/O | W/O | 2.4 | 50u" | 1734795-4 | |
| | | | | 30u" | 1734795-3 | |
| | | | | 15u" | 1734795-2 | |
| | | | | 6u" | 1734795-1 | |
| PACKAGE TYPE | PANEL GROUND | LED | SHELL TYPE | DIM L | MIN. GOLD THICKNESS | PART NUMBER |

THIS DRAWING IS A CONTROLLED DOCUMENT.

| | | | | | | | |
|------------------|-----------|-----------|---|-------|-----------|------------|---------------|
| DWN | O. HU | 14SEP2007 | TE Connectivity MODULAR JACK CONNECTOR RJ45, 8P8C, SHIELDED TAB UP, DIP TYPE, H=11.3mm | | | | |
| CHK | S. HOU | 14SEP2007 | | | | | |
| APVD | W.J. KE | 14SEP2007 | | | | | |
| PRODUCT SPEC | 108-57535 | | | | | | |
| APPLICATION SPEC | | | NAME | | | | |
| MATERIAL | SEE NOTE | FINISH | SEE NOTE | SIZE | CAGE CODE | DRAWING NO | RESTRICTED TO |
| | | | | A3 | 00779 | C=1734795 | |
| WEIGHT | 3.5 GRAMS | | SCALE | SHEET | | 1 OF 5 | REV F |
| CUSTOMER DRAWING | | | | | | | |

THIS DRAWING IS UNPUBLISHED. RELEASED FOR PUBLICATION
 © COPYRIGHT 2010 BY TYCO ELECTRONICS CORPORATION. ALL RIGHTS RESERVED.

| LOC | | DIST | | REVISIONS | | | | | |
|--------------|--|------|--|-----------|-----|-------------|------|-----|------|
| DW | | | | P | LTR | DESCRIPTION | DATE | DWN | APVD |
| SEE SHEET 1. | | | | | | | | | |

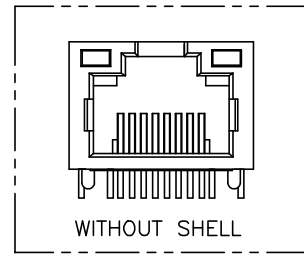

1-1734795-9

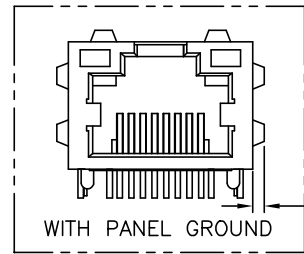

0.8~2.0
6 PLC

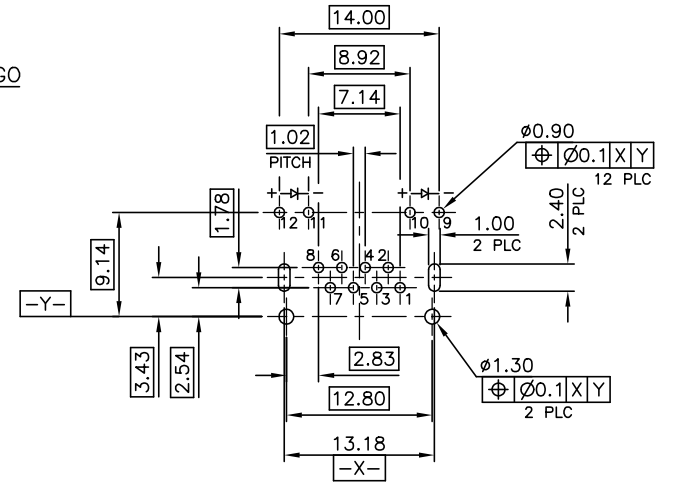
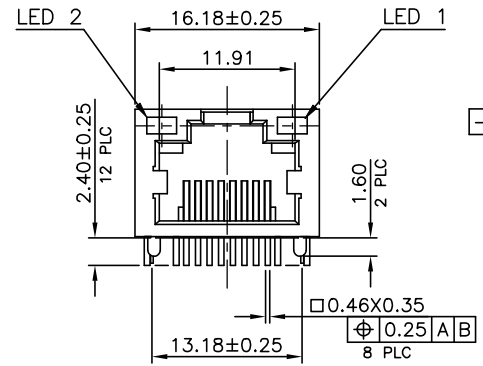
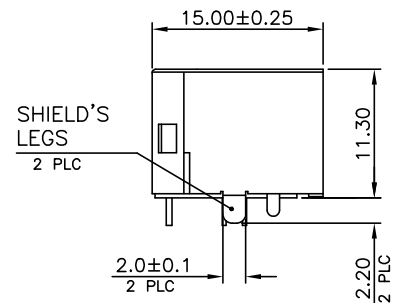
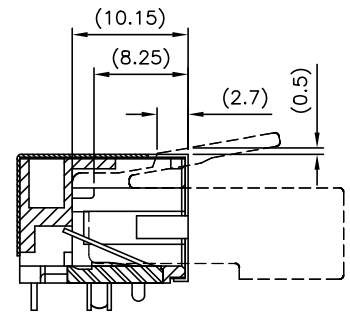
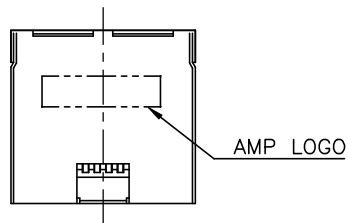

NOTE:

- MATERIAL:
 - 1.1 HOUSING: PA9T WITH 30% GF, UL94 V-0, BLACK COLOR.
 - 1.2 CONTACTS: PHOSPHOR BRONZE.
 - 1.3 SHELL: BRASS.
 - 1.4 LED LIGHT: EPOXY RESIN & STEEL
- FINISH:
 - 2.1 CONTACTS: (SEE TABLE) GOLD PLATED ON CONTACT AREA. GOLD FLASH ON SOLDER TAIL.
 - 1.27um [50u"] MIN. NICKEL UNDERPLATED OVERALL.
 - 2.2 SHELL: 0.51um [20u"] MIN. NICKEL PLATED.
 - 2.3 LED: 1.02um [40u"] COPPER UNDERPLATED OVERALL.
 - 1.27um [50u"] NICKEL OVERALL.
 - 1.27um [50u"] SILVER ON BONDING AREA.
 - 2.54um [100u"] BRIGHT-TIN ON SOLDER AREA.
- WAVE SOLDER CAPABLE TO 265°C PER TYCO TEST SPEC. 109-202, CONDITION B.
 - ⚠ OBSOLETE PART : OBSOLETE CIS STREAMLINING PER D.RENAUD/D.SINISI
 - ⚠ LED: 1.02um [40u"] COPPER UNDERPLATED OVERALL
 - 0.5um [20u"] NICKEL OVERALL
 - 1.27um [50u"] SILVER ON BONDING AREA
 - 2.54um [100u"] BRIGHT-TIN ON SOLDER AREA
 - ⚠ WITHOUT OUTER SHELL

| FINISH | W/O | GREEN/YELLOW | GREEN/YELLOW | LUBRICATION GOLD PLATE CONTACT AREA | PART NUMBER |
|--------|-----|--------------|--------------|-------------------------------------|-------------|
| | | | | 50u" | 2-1734795-8 |
| | | | | 15u" | 2-1734795-2 |
| | | | | 50u" | 1-1734795-8 |
| | | | | 30u" | 1-1734795-7 |
| | | | | 15u" | 1-1734795-6 |
| | | | | 6u" | 1-1734795-5 |
| | | | | 50u" | 1-1734795-4 |
| | | | | 30u" | 1-1734795-3 |
| | | | | 15u" | 1-1734795-2 |
| | | | | 6u" | 1-1734795-9 |
| | | | | 6u" | 1-1734795-1 |
| | | | | MIN. GOLD THICKNESS | PART NUMBER |

THIS DRAWING IS A CONTROLLED DOCUMENT.

DWN _____

CHK _____

APVD _____

PRODUCT SPEC _____

APPLICATION SPEC _____

WEIGHT 3.5 GRAMS

CUSTOMER DRAWING

SCALE _____ SHEET 2 of 5 REV F

TE Connectivity

MODULAR JACK CONNECTOR
RJ45, 8P8C, SHIELDED
TAB UP, DIP TYPE, H=11.3mm

SIZE A3 CAGE CODE 00779 C=1734795

THIS DRAWING IS UNPUBLISHED. RELEASED FOR PUBLICATION
 © COPYRIGHT 2010 BY TYCO ELECTRONICS CORPORATION. ALL RIGHTS RESERVED.

| LOC | DIST | REVISIONS | | | |
|-----|------|--------------|------|-----|------|
| P | LTR | DESCRIPTION | DATE | DWN | APVD |
| DW | | SEE SHEET 1. | | | |

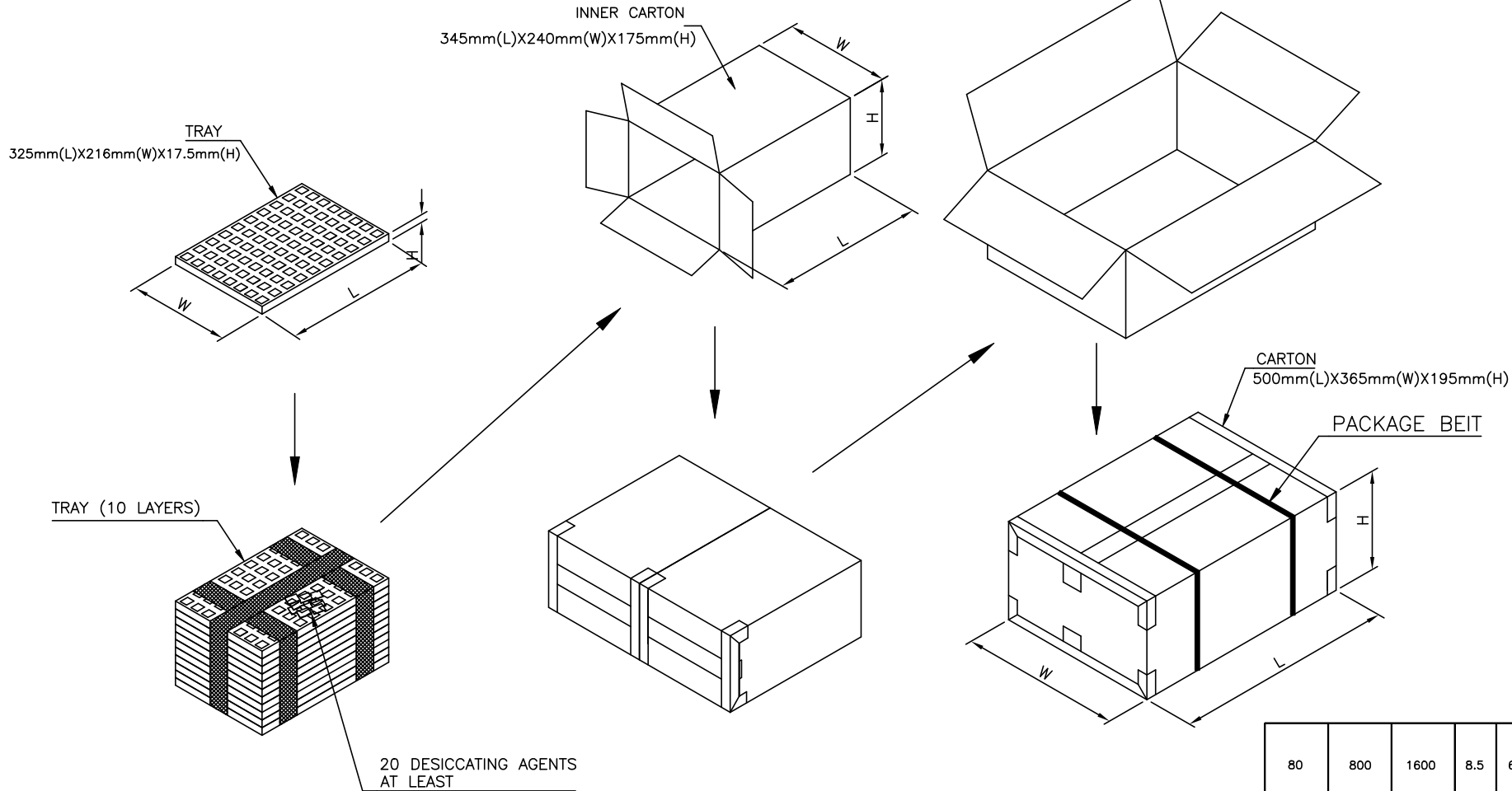

| | | | | | 1734795-4 |
|----------|--------------|----------------|----------|----------|----------------------|
| | | | | | 1734795-3 |
| | | | | | 1734795-2 |
| | | | | | 1734795-1 |
| PCS/TRAY | TRAYS/CARTON | QUANTITY (PCS) | G/W (Kg) | N/W (Kg) | PART NUMBER |
| 80 | 800 | 1600 | 8.5 | 6.5 | |

| | | | | | |
|--|--|------------------|--|-----------|------------|
| THIS DRAWING IS A CONTROLLED DOCUMENT. | | DWN | TE Connectivity | | |
| DIMENSIONS: mm | | CHK | NAME | | |
| TOLERANCES UNLESS OTHERWISE SPECIFIED | | APVD | MODULAR JACK CONNECTOR RJ45, 8P8C, SHIELDED TAB UP, DIP TYPE, H=11.3mm | | |
| MATERIAL | | PRODUCT SPEC | SIZE | CAGE CODE | DRAWING NO |
| FINISH | | APPLICATION SPEC | A3 | 00779 | C=1734795 |
| WEIGHT | | RESTRICTED | CUSTOMER DRAWING | | |
| SCALE | | SHEET 3 OF 5 | | REV F | |

4

3

2

1

THIS DRAWING IS UNPUBLISHED. RELEASED FOR PUBLICATION
© COPYRIGHT 2010 BY TYCO ELECTRONICS CORPORATION. ALL RIGHTS RESERVED.

| | | | | | |
|-----------|------|--------------|------|-----|------|
| LOC DW | DIST | REVISIONS | | | |
| P | LTR | DESCRIPTION | DATE | DWN | APVD |
| | | SEE SHEET 1. | | | |

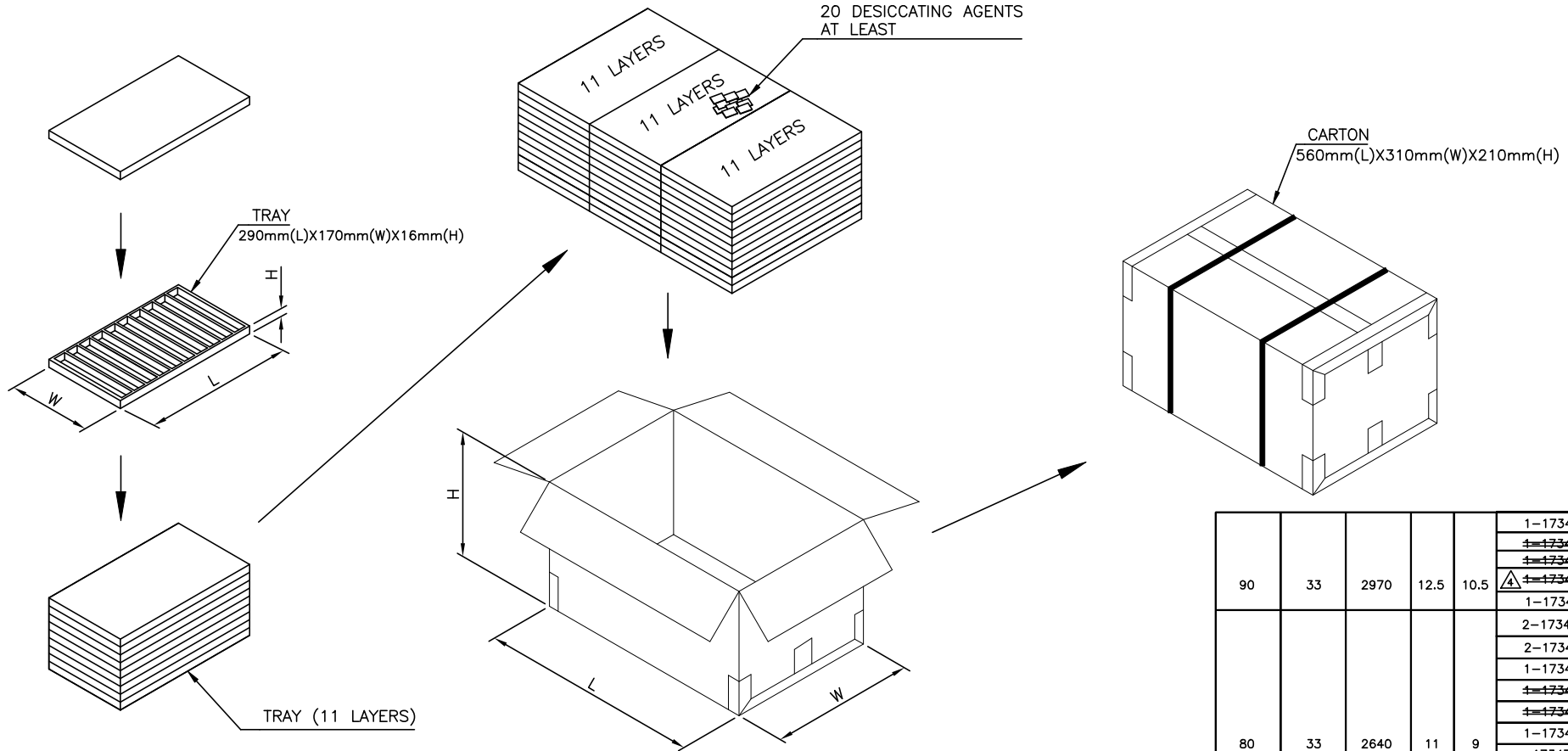

| | | | | | |
|----------|--------------|----------------|----------|----------|------------------------|
| 90 | 33 | 2970 | 12.5 | 10.5 | 1-1734795-9 |
| | | | | | 1-1734795-4 |
| | | | | | 1-1734795-3 |
| | | | | | 1-1734795-2 |
| | | | | | 1-1734795-1 |
| | | | | | 2-1734795-8 |
| | | | | | 2-1734795-2 |
| | | | | | 1-1734795-8 |
| | | | | | 1-1734795-7 |
| | | | | | 1-1734795-6 |
| 80 | 33 | 2640 | 11 | 9 | 1-1734795-5 |
| | | | | | 1-1734795-8 |
| | | | | | 1734795-7 |
| | | | | | 3-1734795-6 |
| | | | | | 1734795-6 |
| | | | | | 1734795-5 |
| | | | | | 1734795-5 |
| PCS/TRAY | TRAYS/CARTON | QUANTITY (PCS) | G/W (kg) | N/W (kg) | PART NUMBER |

| | | | | | |
|--|--------|------------------|----------------------------|-----------|------------|
| THIS DRAWING IS A CONTROLLED DOCUMENT. | | DWN | TE Connectivity | | |
| DIMENSIONS: mm | | CHK | NAME | | |
| TOLERANCES UNLESS OTHERWISE SPECIFIED: | | APVD | MODULAR JACK CONNECTOR | | |
| 0 PLC ± - | | PRODUCT SPEC | RJ45, 8P8C, SHIELDED | | |
| 1 PLC ± 0.3 | | APPLICATION SPEC | TAB UP, DIP TYPE, H=11.3mm | | |
| 2 PLC ± 0.2 | | WEIGHT | SIZE | CAGE CODE | DRAWING NO |
| 3 PLC ± 0.15 | | CUSTOMER DRAWING | A3 | 00779 | C=1734795 |
| 4 PLC ± - | | | RESTRICTED TO | | |
| ANGLES ± 3' | | | SCALE | | |
| MATERIAL | FINISH | | SHEET | | 4 of 5 |
| | | | REV | | F |

THIS DRAWING IS UNPUBLISHED. RELEASED FOR PUBLICATION
 © COPYRIGHT 2010 BY TYCO ELECTRONICS CORPORATION. ALL RIGHTS RESERVED.

| LOC | DIST | REVISIONS | | | |
|-----|------|--------------|------|-----|------|
| P | LTR | DESCRIPTION | DATE | DWN | APVD |
| | | SEE SHEET 1. | | | |

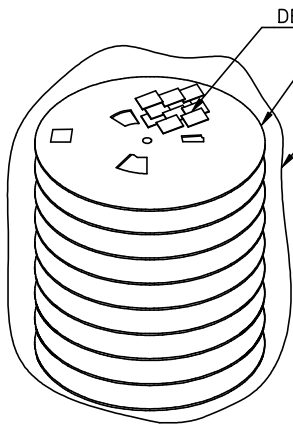
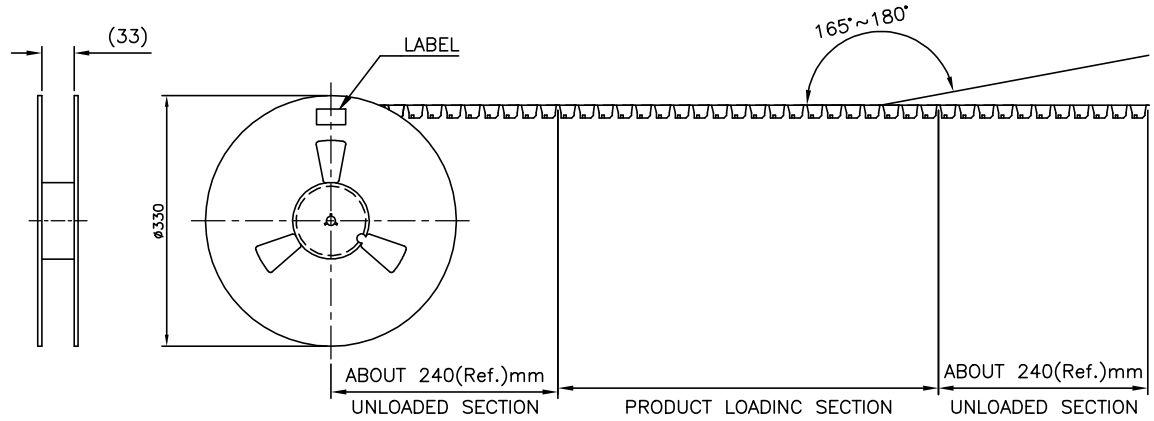

- NOTE:
- EACH BAG SHALL BE INCLUDED:
*DESICCANT
 - PEELING STRENGTH: 0.1~1.3N(1~130 GRAMS) FOR 12~56mm WIDE CARRIER TAPES
 - PEELING SPEED: 300mm/MINUTES.
 - PACKAGING MATERIAL:
 - COVER TAPE—COMPOSITE OF POLYETHYLENE TEREPHTHALATE (PET)
 - CARRIER—POLYSTYRENE (PS)
 - CARRIER REEL—POLYSTYRENE

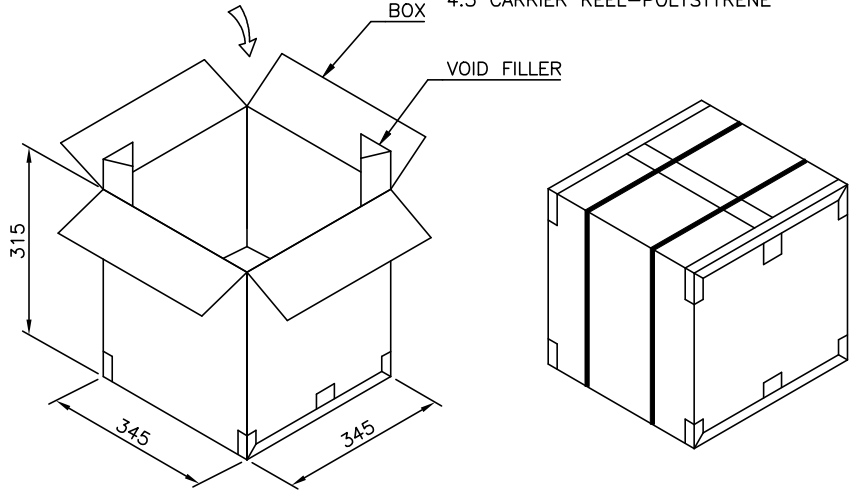
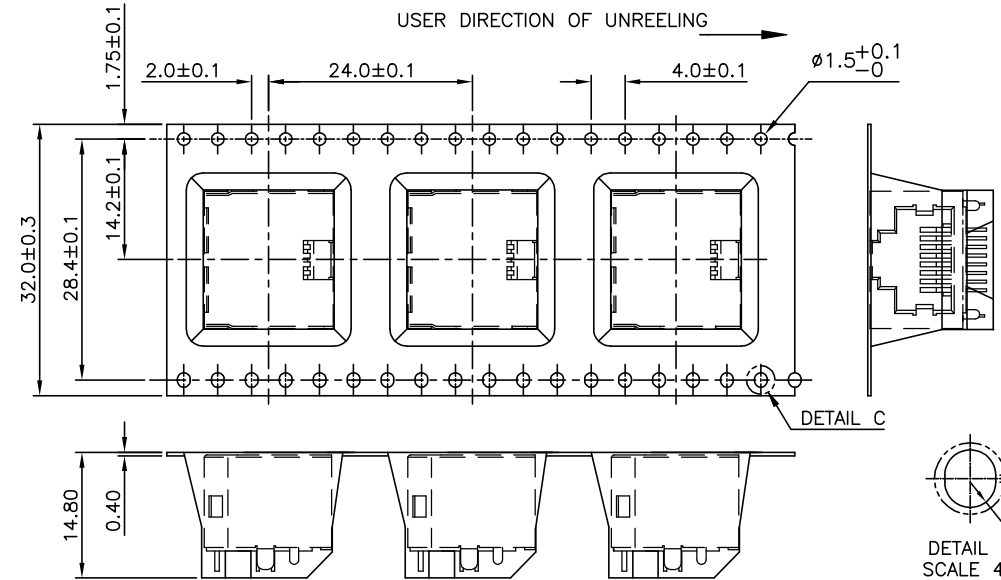

| | | | | | |
|--------------|------------|--------------|----------|---------|-------------|
| 8.7 KG | 5.05 KG | 180 | 8 | 1440 | 3-1734795-2 |
| GROSS WEIGHT | NET WEIGHT | PCS/REEL/BOX | REEL/BOX | PCS/BOX | PART NUMBER |
| | | | | | 3-1734795-1 |

| | | | | | |
|---|--|------------------|---|-----------|--------------|
| THIS DRAWING IS A CONTROLLED DOCUMENT. | | DWN | TE Connectivity MODULAR JACK CONNECTOR RJ45, 8P8C, SHIELDED TAB UP, DIP TYPE, H=11.3mm | | |
| DIMENSIONS: mm | | CHK | | | |
| TOLERANCES UNLESS OTHERWISE SPECIFIED: | | APVD | | | |
| MATERIAL | | PRODUCT SPEC | | | |
| FINISH | | APPLICATION SPEC | SIZE | CAGE CODE | DRAWING NO |
| 0 PLC ± - 1 PLC ± 0.3 2 PLC ± 0.2 3 PLC ± 0.15 4 PLC ± - ANGLES ± 3° | | WEIGHT | A3 | 00779 | C=1734795 |
| | | CUSTOMER DRAWING | RESTRICTED TO | SCALE | SHEET 5 of 5 |
| | | | | | REV F |