

REVISIONS				
P	LTR	DESCRIPTION	DATE	APVD
E1		REVISED PER ECO-17-008114	04JUN2018	RS DR

AMP WIRE RANGE	E13288 Listed	LR7189 Certified
12-10 AWG SOLID OR STRANDED	12-10 AWG SOLID OR STRANDED	12-10 AWG SOLID OR STRANDED

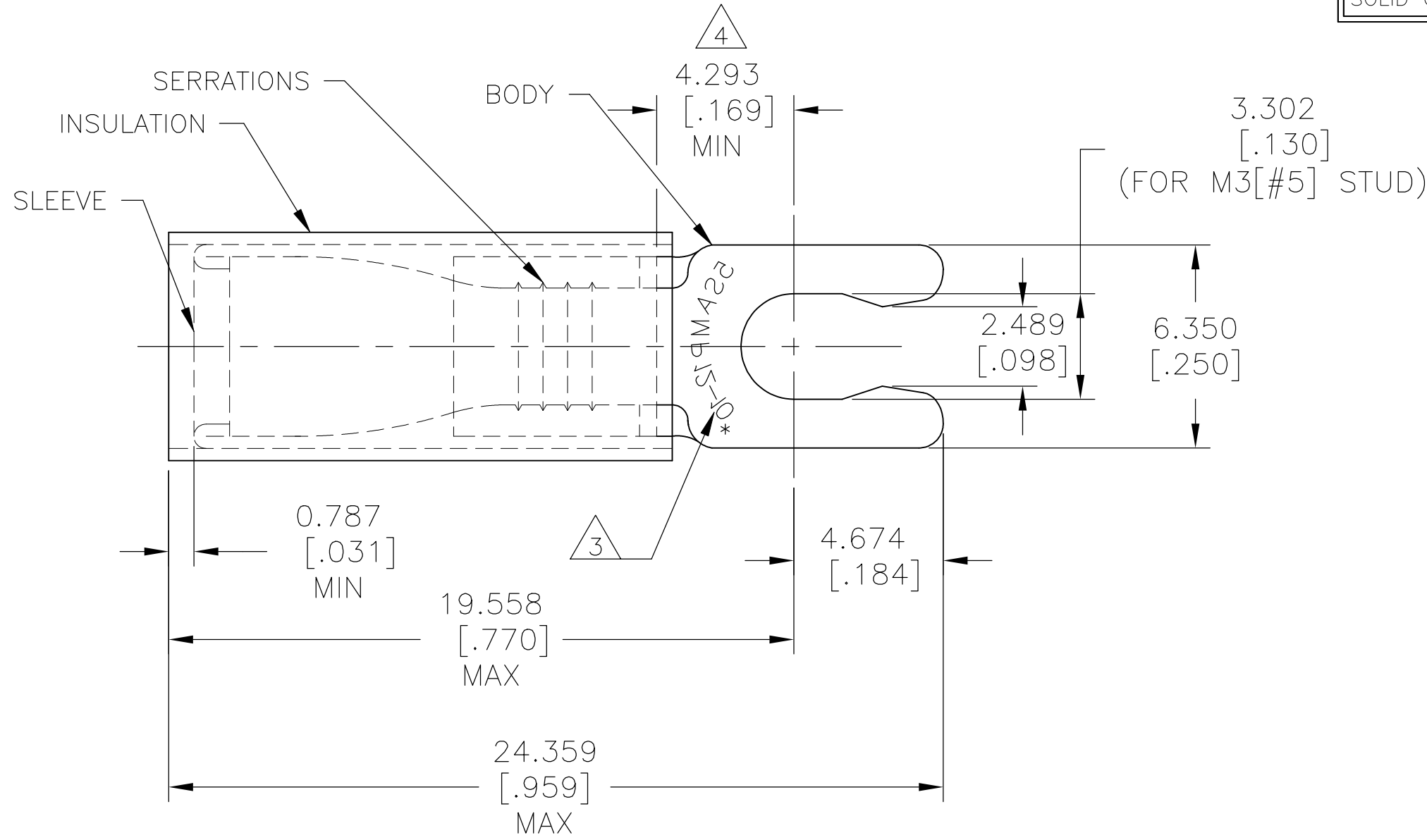

- 1 FOR 3.810 TO 6.350 [.150 TO .250] WIRE INS. DIA
- 2 BODY MATERIAL THK: 0.991±0.051 [.039±.002]
- 3 STAMP 5S AMP 12-10* APPROX AS SHOWN
- 4 APPLIES FROM EDGE OF METAL WIRE BARREL TO CNTER OF STUD HOLE
- 5 MATERIAL:
BODY: PHOSPHOR BRONZE PER ASTM B103
SLEEVE: COPPER PER ASTM B152
INSULATION: NYLON
- 6 FINISH:
BODY & SLEEVE: TIN PLATE PER ASTM B545
INSULATION: COLOR - YELLOW

500	LOOSE PIECE	52940
QTY	PACKAGE TYPE	PART NO

AMP INCORPORATED CUSTOMER SERVICE SYSTEMS		THIS DRAWING IS A CONTROLLED DOCUMENT.		DWN RAVI S 04JUN2018	TE Connectivity Ltd.				
FOR ADDITIONAL PRODUCT INFORMATION OR COPIES OF DRAWINGS AND TECHNICAL DOCUMENTS PRODUCT INFORMATION CENTER 1-800-522-6752		DIMENSIONS: mm [INCHES]		CHK ROHDE DANIEL F 04JUN2018					
FOR APPLICATION TOOLING ASSISTANCE CENTER TOOLING INFORMATION 1-800-722-1111		TOLERANCES UNLESS OTHERWISE SPECIFIED: 0 PLC ± - 1 PLC ± - 2 PLC ± - 3 PLC ± 0.127[.005] 4 PLC ± - ± 5°		APVD ROHDE DANIEL F 04JUN2018	NAME WIRE TERMINAL P.I.D.G - SPRING SPADE (STUB), WIRE SIZE: 12-10 AWG				
FOR ORDER ENTRY 1-800-526-5142		MATERIAL 5		FINISH 6	PRODUCT SPEC UL 486 A-B	SIZE A3	CAGE CODE 00779	DRAWING NO C-52940	RESTRICTED TO -
MAX RECOMMENDED OPERATING TEMPERATURE: 105°C [221°F]		VOLTAGE RATING: 300 V MAX		APPLICATION SPEC 114-2157		SCALE 6:1		SHEET 1 OF 1	
WIRE CROSS SECTIONAL AREA RANGE, 2.62-6.64mm²[5,180-13,100] CIR MILS SOLID OR STRANDED		MATERIAL 5		FINISH 6		CUSTOMER DRAWING		REV E1	