

10 9 8 7 6 5 4 3 2 1

MAT'L NO.	ENG NO.	PLATING OPTION
15-24-4345	A-8981-4V5	TIN/LEAD
15-24-4745	A-8981-4V5-LF	TIN

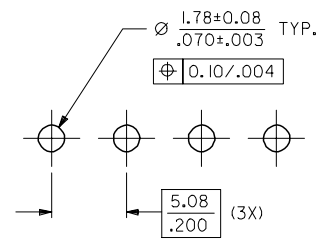
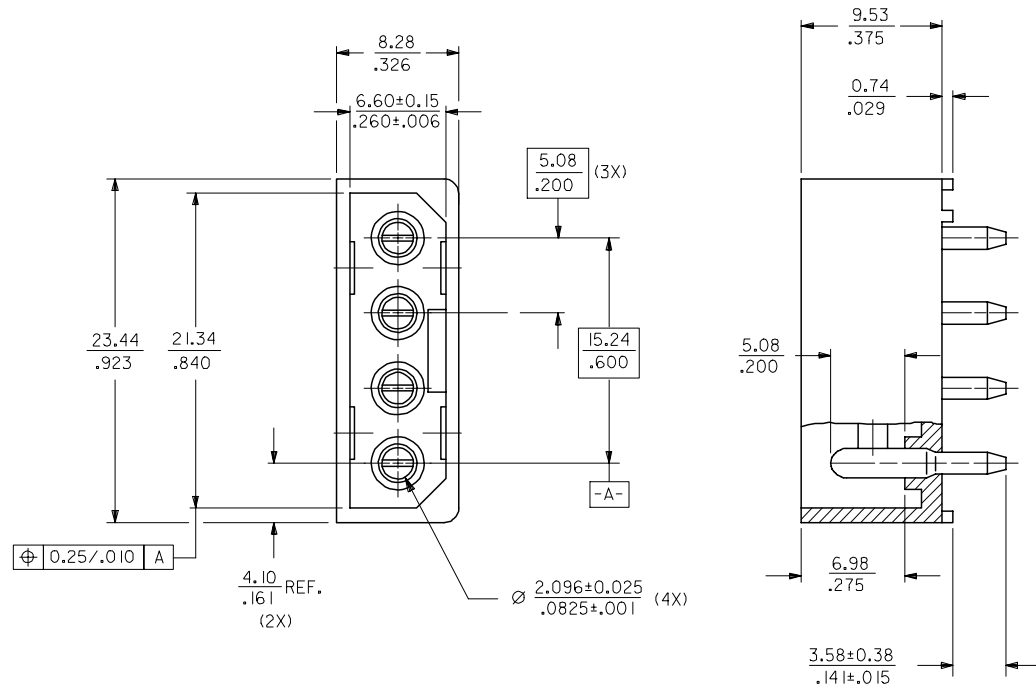

- NOTES :
1. PLATING  
POSTPLATE 0.0025/4.000100 MIN. TIN/LEAD OR TIN OVER 0.00127/.000050 MIN. NICKEL OVERALL.
  2. PART TO MATE WITH 8981-4P\*.
  3. PRODUCT SPEC PS-8981-4V4/4R1-P APPLIES.
  4. MATERIAL:  
HOUSING - G.F. PCT UL94V-0  
COLOR BLACK  
TERMINAL - PHOS BRONZE

<b>EDIT NOTE 3</b> EC NO: S2006-0765 DRWN: LO/IAO CHKD: BOKOK APPR: PTL/IM	2006/01/26 2006/01/26 2006/02/06	QUALITY SYMBOLS ▽=0 ◻=0	GENERAL TOLERANCES (UNLESS SPECIFIED)		DIMENSION STYLE		SCALE	DESIGN UNITS	THIRD ANGLE PROJECTION			
					MM/IN		NTS	METRIC				
					mm	INCH	DRAWN BY		DATE		TITLE	
					4 PLACES ± ---	± ---	SKTOH	1991/10/17		POWER CONNECTOR, 4 CKTS VERTICAL MOUNT		
		3 PLACES ± ---	± .008	CHECKED BY		DATE						
		2 PLACES ± 0.20	± ---	MLA1		1991/10/17						
		1 PLACE ± ---	± ---	APPROVED BY		DATE						
		ANGULAR ± 3 °		RWONG		1991/10/18		molex MOLEX INCORPORATED				
		DRAFT WHERE APPLICABLE MUST REMAIN WITHIN DIMENSIONS		MATERIAL NO.		DOCUMENT NO.		SHEET NO.				
				SEE TABLE		SD-8981-4V5		1 OF 1				
				THIS DRAWING CONTAINS INFORMATION THAT IS PROPRIETARY TO MOLEX INCORPORATED AND SHOULD NOT BE USED WITHOUT WRITTEN PERMISSION								

9 8 7 6 5 4 3 2 1