

SECTION A-A

DETAIL "A"

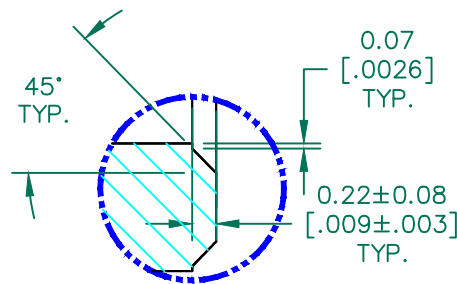

DETAIL "A"
(TYP.)

SCALE DRAWING 1:1

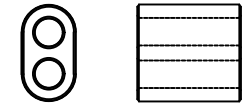

28N0525-600

ELECTRICAL TESTING

TEST:	NET Z	NET Z
# TURNS	1	1
AWG	-	-
FREQUENCY	25 MHz	100 MHz
NOMINAL	59 Ω	91 Ω
MINIMUM	-	72 Ω
WEIGHT/K	10.09 KGS	



NOTES: UNLESS OTHERWISE SPECIFIED

1. COSMETIC SPECIFICATION REFER TO WI-QA-038.

CORE DIMENSIONS:

A	13.34 [.525]	±	0.38 [.015]
B	7.49 [.295]	±	0.38 [.015]
C	14.35 [.565]	±	0.40 [.016]
D	3.81 [.150]	±	0.13 [.005]
E	5.72 [.225]	±	0.25 [.010]

DIMENSIONS ARE IN mm [INCHES].				This print is the property of Laird Tech. and is loaned in confidence subject to return upon request and with the understanding that no copies shall be made without the written consent of Laird Tech. All rights to design or invention are reserved.							
REV	DESCRIPTION	DATE	INT								
				PROJECT/PART NUMBER:	28N0525-600	REV	A	PART TYPE:	BALUN	DRAWN BY:	WS
				DATE:	04/13/2020	SCALE:	2 : 1	MATERIAL:	Ferrite		
				GAD #	28N0525-600-A	TOOL #	N0525A				