

Power Inductor

HPC3015TF-SERIES

1. Features

1. This specification applies Low Profile Power Inductors.
2. 100% Lead(Pb) & Halogen-Free and RoHS compliant.
3. Operating temperature : -40~+125°C (Including self - temperature rise).



2. Dimension

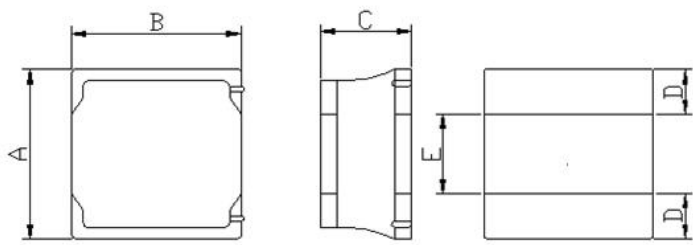

Series	A(mm)	B(mm)	C(mm)	D(mm)	E(mm)
HPC3015TF	3.0±0.2	3.0±0.2	1.5 max.	1.0 ref.	1.0 ref.

Units: mm

3. Part Numbering

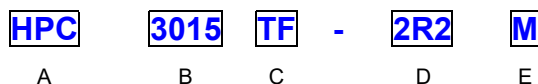

- A: Series
 B: Dimension
 C: Lead Free
 D: Inductance 2R2=2.2uH
 E: Inductance Tolerance M=±20%; Y=±30%

4. Specification

TAI-TECH Part Number	Inductance (uH)	Tolerance (%)	Test Frequency (Hz)	DCR (Ω) ±20%	I sat (A)	I rms (A)
HPC3015TF-1R0Y	1.0	±30%	1V100K	0.030	2.20	2.20
HPC3015TF-1R5Y	1.5	±30%	1V100K	0.040	2.00	2.00
HPC3015TF-2R2M	2.2	±20%	1V100K	0.060	1.70	1.70
HPC3015TF-3R3M	3.3	±20%	1V100K	0.080	1.40	1.40
HPC3015TF-4R7M	4.7	±20%	1V100K	0.120	1.20	1.20
HPC3015TF-6R8M	6.8	±20%	1V100K	0.160	1.00	1.00
HPC3015TF-100M	10	±20%	1V100K	0.220	0.75	0.80
HPC3015TF-150M	15	±20%	1V100K	0.320	0.65	0.70
HPC3015TF-220M	22	±20%	1V100K	0.460	0.55	0.60
HPC3015TF-330M	33	±20%	1V100K	0.800	0.40	0.45
HPC3015TF-470M	47	±20%	1V100K	1.200	0.35	0.40
HPC3015TF-680M	68	±20%	1V100K	2.000	0.30	0.35

Note:

I_{sat} : Saturation Current (I_{sat}) will cause L₀ to drop approximately 30%.I_{rms} : Heat Rated Current (I_{rms}) will cause the coil temperature rise approximately ΔT of 40°C.Rated DC Current : The less value which is I_{rms} or I_{sat}.

5. Typical Performance Curves

