

## SECTION A-A

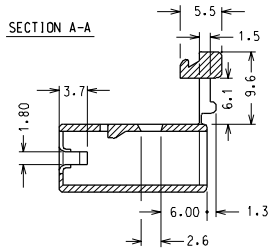

## SECTION B-B

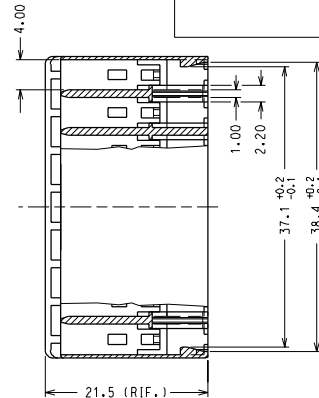
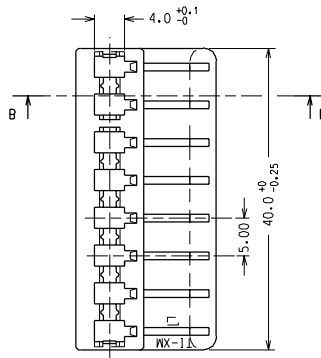
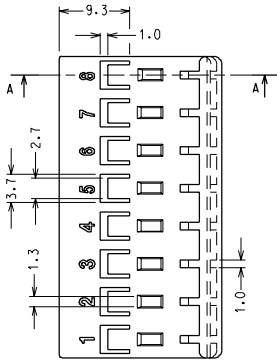
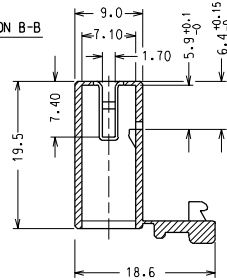

DIMA 8 VIE PER C.S. spess. 1.5 ±0.1  
VISTA LATO COMPONENTI  
RECOMMENDED PCB LAYOUT, PCB THICK.: 1.5 ±0.1  
VIEW FROM COMPONENT SIDE

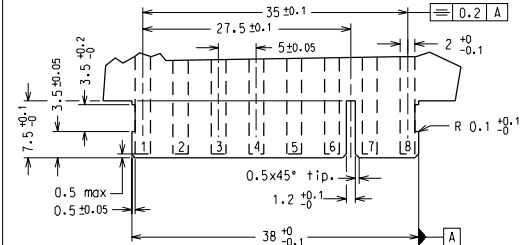

MATERIALE: NYLON 66 NERO UL94 V2, GWT 850 °C  
MATERIAL: NYLON 66 BLACK UL94 V2, GWT 850 °C

NOTA: LE DIMENSIONI VANNO MISURATE CON CORPI STABILIZZATI SECONDO NG 2301.  
(AUMENTO IN PESO DEL 2.7 %)

NOTE: PARTS SHALL BE DIMENSIONALLY CHECKED AFTER ATTAINING EQUILIBRIUM CONDITIONS, E.G. 27 % INCREASE IN WEIGHT FOR HUMIDITY ABSORPTION FROM DRY STATUS.

CARATTERISTICHE DEL PRODOTTO SECONDO PS 94529  
PRODUCT CHARACTERISTICS ACCORDING TO PS 94529 E

CONFEZIONE: 3000 pz. in scatola  
PACKAGING: 3000 pcs. in carton box

SPQ: 3000 DZ.

REV	DESCRIPTION	GENERAL TOLERANCES: (UNLESS SPECIFIED)		SCALE	DESIGN UNITS	FIRST ANGLE PROJECTION	DIMENSIONS:			SHT	REV
		mm	INCH				mm	INCH	mm		
A1	EC NO. Z2001-0099 DRWNG. GOTTARDO 13-02-01 CH'K: M. TESTAGAZZA 13-02-01 APPR: R. MARTUCCI 13-02-01 MAJOR M SIGNIF. S CRITICAL C	4 PLACES	±0.2	±.	2:1	mm	mm	mm	mm		
		3 PLACES	±0.2	±.		mm	mm	mm	mm		
		2 PLACES	±0.1	±.		mm	mm	mm	mm		
		1 PLACE	±0.2	±.		mm	mm	mm	mm		
		ANGULAR: ± 2°									
		DRAFT WHERE APPLICABLE MUST REMAIN WITHIN DIMENSIONS									
		Descr. Std: HSG FOR FORK TERMINAL 8 CKT									
		DRAWN BY & DATE									
		F. GOTTARDO 12-02-98									
		CHECKED BY & DATE									
		S. SORATO 12-02-98									
		APPROVED BY & DATE									
		R. MARTUCCI 12-02-98									
		CAD FILENAME									
		94529019.DGN									
		MATERIAL NO.									
		94529-8208									
		DRAWING NO.									
		SD-94529-019									
		SHEET NO.									
		1/1									
		THIS DRAWING CONTAINS INFORMATION THAT IS PROPRIETARY TO MOLEX INCORPORATED AND SHOULD NOT BE USED WITHOUT WRITTEN PERMISSION.									
		SIZE									
		A3									

MOLEX INCORPORATED

MATERIAL NO. 94529-8208  
DRAWING NO. SD-94529-019

SHEET NO. 1/1