

PANDUIT PART NUMBER	PACKAGE QUANTITY	CONDUCTOR SIZE	STUD SIZE	OVERALL LENGTH "A" ±.12	BARREL LENGTH "B" MIN.	I.D. ±.01	O.D. ±.01	TONGUE WIDTH "W" ± .06	TONGUE THICKNESS "T" ±.02	TONGUE LENGTH "P" MIN.	HOLE OFFSET "G" ± .03	STUD HOLE DIA "D" ±.02	WRENCH CLEARANCE "C" REF	WIRE STRIP LENGTH	PANDUIT DIE COLOR CODE PANDUIT DIE INDEX NUMBER (BURNDY DIE INDEX NUMBER)
LAA300-38-15	15	300 kcmil	3/8"	4.00	2.25	0.65	1.01	1.38	0.34	1.31	0.63	0.41	0.68	2-5/16"	BLUE DIE P76 (470)
LAA350-12-15	15	350 kcmil	1/2"	4.28	2.25	0.72	1.11	1.51	0.38	1.31	0.63	0.53	0.68	2-5/16"	BROWN DIE P87 (299)
LAA400-58-XR	10	400 kcmil	5/8"	4.88	2.50	0.76	1.19	1.61	0.41	1.25	0.63	0.66	0.62	2-9/16"	GREEN DIE P94 (472)
LAA500-12-6	6	500 kcmil	1/2"	5.50	3.00	0.84	1.32	1.74	0.45	1.50	0.63	0.53	0.87	3-1/16"	PINK DIE P99 (300)
LAA750-12-E	20	750 kcmil	1/2"	6.50	3.38	1.03	1.59	1.74	0.54	1.88	0.88	0.53	1.00	3-7/16"	RED DIE P125 (301)
LAA750-58-E	20		5/8"									0.66			
LAA1000-58-X	10	1000 kcmil	5/8"	7.31	4.50	1.19	1.84	2.56	0.63	1.88	0.88	0.66	1.00	4-3/4"	BROWN DIE P161 (302)

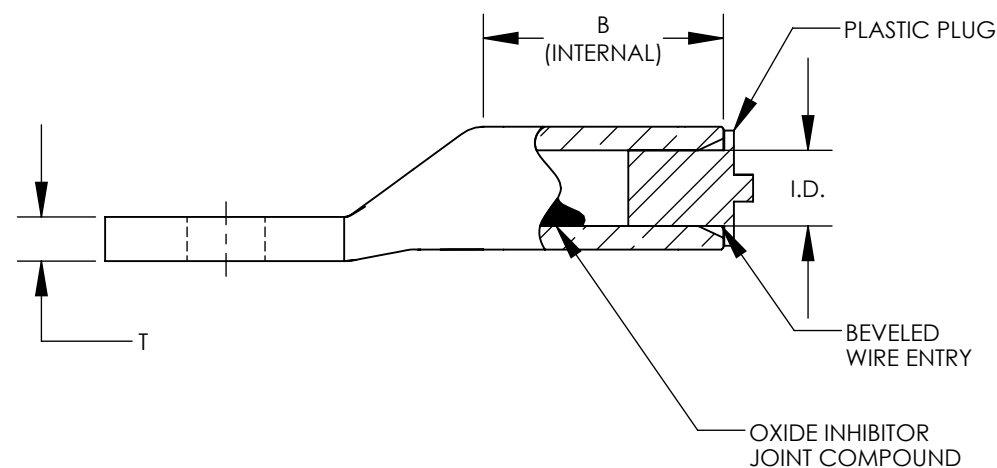

NOTES:

1. MATERIAL: SEAMLESS ALUMINUM TUBING, TIN PLATED
2. BARREL COLOR CODED WITH DIE SET INDEX NUMBER
3. WIRE TYPE:  
COPPER CLASS B CONCENTRIC, COMPRESSED AND COMPACT STRANDED WIRE  
COPPER CLASS C CONCENTRIC STRANDED WIRE  
ALUMINUM CLASS B, CONCENTRIC, COMPRESSED AND UNIDIRECTIONAL LAY COMPACT STRANDED WIRE
4. UL LISTED & CSA CERTIFIED TEMPERATURE RATED 90° C (AL9CU)
5. UL LISTED & CSA CERTIFIED VOLTAGE RATING 35 KV
6. ALL DIMENSIONS IN INCHES

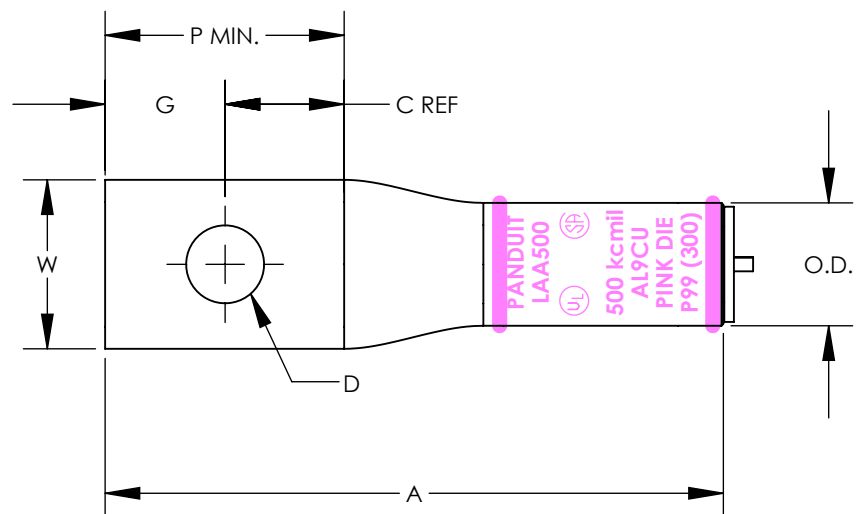

LISTED



CERTIFIED



LISTED  
(LAA750-12-1 ONLY)

REV	DATE	BY	CHK	APR	DESCRIPTION	ECN
00	8/22	JHNU	JHNU	JADE	DRAWING RELEASED	

TITLE		LAA SERIES 300kcmil-1000kcmil ALUMINUM LUGS CUSTOMER DRAWING	
ITEM REVISION NAME	02903NBC/00		
DATASET FILE NAME	02903NBC-DC r00.SLDDRW		
UNLESS OTHERWISE SPECIFIED, DIMENSIONAL TOLERANCES ARE: IN [mm]		MATERIAL	
.X ±	.XXX ±	SEE NOTES	
.XX ±	ANGLES ±	DRAWING NUMBER 02903NBC-DC	
THIRD ANGLE PROJECTION		SHEET 1 OF 1	
DRAWN BY	DATE	CHK	SCALE
JHNU	8/22	JADE	NONE
SIZE		B	