

CR3-005GPP SERIES

**GLASS PASSIVATED JUNCTION
GENERAL PURPOSE
SILICON RECTIFIER
3 AMP, 50 THRU 1200 VOLTS**

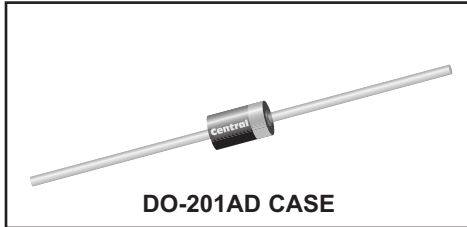

www.centrasemi.com



DESCRIPTION:

The CENTRAL SEMICONDUCTOR CR3-005GPP Series types are 3.0 Amp Glass Passivated Junction Silicon Rectifiers which are high quality, well constructed, highly reliable components designed for use in all types of military, commercial, industrial, entertainment, computer, and automotive applications.

THIS DEVICE IS MANUFACTURED WITH A GLASS PASSIVATED CHIP FOR OPTIMUM RELIABILITY.

MARKING: FULL PART NUMBER

MAXIMUM RATINGS: ($T_A=25^\circ\text{C}$ unless otherwise noted)

		CR3 -005	CR3 -010	CR3 -020	CR3 -040	CR3 -060	CR3 -080	CR3 -100	CR3 -120	UNITS
	SYMBOL	GPP	GPP	GPP	GPP	GPP	GPP	GPP	GPP	
Peak Repetitive Reverse Voltage	V_{RRM}	50	100	200	400	600	800	1000	1200	V
DC Blocking Voltage	V_R	50	100	200	400	600	800	1000	1200	V
RMS Reverse Voltage	$V_{R(RMS)}$	35	70	140	280	420	560	700	840	V
Average Forward Current ($T_A=55^\circ\text{C}$)	I_O					3.0				A
Peak Forward Surge Current	I_{FSM}					150				A
Operating and Storage Junction Temperature	T_J, T_{stg}					-65 to +150				$^\circ\text{C}$
Thermal Resistance	θ_{JA}					20				$^\circ\text{C/W}$

ELECTRICAL CHARACTERISTICS: ($T_A=25^\circ\text{C}$ unless otherwise noted)

SYMBOL	TEST CONDITIONS	TYP	MAX	UNITS
I_R	$V_R=\text{Rated } V_{RRM}$		5.0	μA
I_R	$V_R=\text{Rated } V_{RRM}, T_A=100^\circ\text{C}$		100	μA
V_F	$I_F=3.0\text{A}$		1.2	V
C_J	$V_R=4.0\text{V}, f=1.0\text{MHz}$	30	50	pF

CR3-005GPP SERIES
GLASS PASSIVATED JUNCTION
GENERAL PURPOSE
SILICON RECTIFIER
3 AMP, 50 THRU 1200 VOLTS



DO-201AD CASE - MECHANICAL OUTLINE

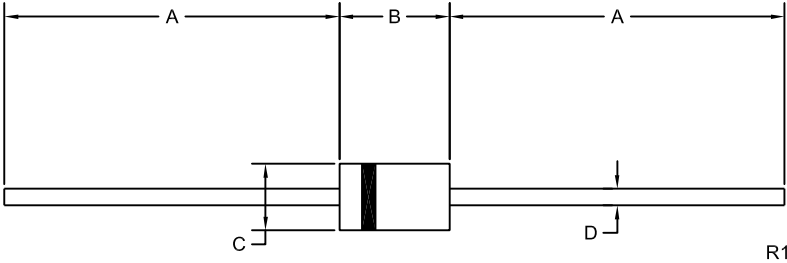

DIMENSIONS				
SYMBOL	INCHES		MILLIMETERS	
	MIN	MAX	MIN	MAX
A	1.000	-	25.40	-
B	0.283	0.375	7.20	9.53
C	0.189	0.210	4.80	5.33
D	0.047	0.052	1.20	1.32

DO-201AD (REV: R1)

MARKING: FULL PART NUMBER

R4 (24-October 2011)

OUTSTANDING SUPPORT AND SUPERIOR SERVICES



PRODUCT SUPPORT

Central's operations team provides the highest level of support to insure product is delivered on-time.

- Supply management (Customer portals)
- Inventory bonding
- Consolidated shipping options
- Custom bar coding for shipments
- Custom product packing

DESIGNER SUPPORT/SERVICES

Central's applications engineering team is ready to discuss your design challenges. Just ask.

- Free quick ship samples (2nd day air)
- Online technical data and parametric search
- SPICE models
- Custom electrical curves
- Environmental regulation compliance
- Customer specific screening
- Up-screening capabilities
- Special wafer diffusions
- PbSn plating options
- Package details
- Application notes
- Application and design sample kits
- Custom product and package development

REQUESTING PRODUCT PLATING

1. If requesting Tin/Lead plated devices, add the suffix "TIN/LEAD" to the part number when ordering (example: 2N2222A TIN/LEAD).
2. If requesting Lead (Pb) Free plated devices, add the suffix "PBFREE" to the part number when ordering (example: 2N2222A PBFREE).

CONTACT US

Corporate Headquarters & Customer Support Team

Central Semiconductor Corp.
145 Adams Avenue
Hauppauge, NY 11788 USA
Main Tel: (631) 435-1110
Main Fax: (631) 435-1824
Support Team Fax: (631) 435-3388
www.centrasemi.com

Worldwide Field Representatives:
www.centrasemi.com/wwreps

Worldwide Distributors:
www.centrasemi.com/wwdistributors

For the latest version of Central Semiconductor's **LIMITATIONS AND DAMAGES DISCLAIMER**, which is part of Central's Standard Terms and Conditions of sale, visit: www.centrasemi.com/terms



<http://www.centrasemi.com>

Product End of Life Notification

PDN ID:	PDN01099
Notification Date:	6/07/18
Last Buy Date:	12/07/18
Last Shipment Date	6/07/19

Summary: The CR3-005GPP silicon rectifier series is being discontinued; these devices are now classified as End of Life (EOL).

Although Central Semiconductor Corp. makes every effort to continue to produce devices that have been proclaimed EOL (End of Life) by other manufacturers, it is an accepted industry practice to discontinue certain devices when customer demand falls below a minimum level of sustainability. Accordingly, the following product(s) have been transitioned to End of Life status as part of Central's ongoing Product Management Process. Any replacement products are noted below. The effective date for placing last purchase orders will be six (6) months from the date of this notice and twelve (12) months from the notice date for final shipments, and minimum order quantities may apply. The last purchase and shipment dates may be extended if inventory is available.

<u>Central Part Number</u>	<u>Replacement</u>
CR3-005GPP BK	N/A
CR3-005GPP TR	N/A
CR3-010GPP BK	N/A
CR3-010GPP TR	N/A
CR3-020GPP BK	N/A
CR3-020GPP TR	N/A
CR3-040GPP BK	N/A
CR3-040GPP TR	N/A
CR3-060GPP BK	N/A
CR3-060GPP TR	N/A
CR3-080GPP BK	N/A
CR3-100GPP BK	N/A
CR3-100GPP TR	N/A
CR3-120GPP BK	N/A
CR3-120GPP TR	N/A

Central would be happy to assist you by providing additional information or technical data to help locate an alternate source if we have no replacement available. Please email your requests to engineering@centrasemi.com.

DISCLAIMER: This End of Life (EOL) notification is in accordance with JEDEC standard JESD48 - Product Discontinuance. Central Semiconductor Corp. will make every effort to offer life-time buy (LTB) opportunities and/or offer replacement devices to existing customers for discontinued devices, however, one or both may not be possible for all devices. Please contact your local Central Semiconductor sales representative for LTB opportunities/additional information.