

REV	DATE	DESCRIPTION	DATE	APPD
CM 53	10-25-89	RELEASED PER PR CM 89-170	10-25-89	PC 25

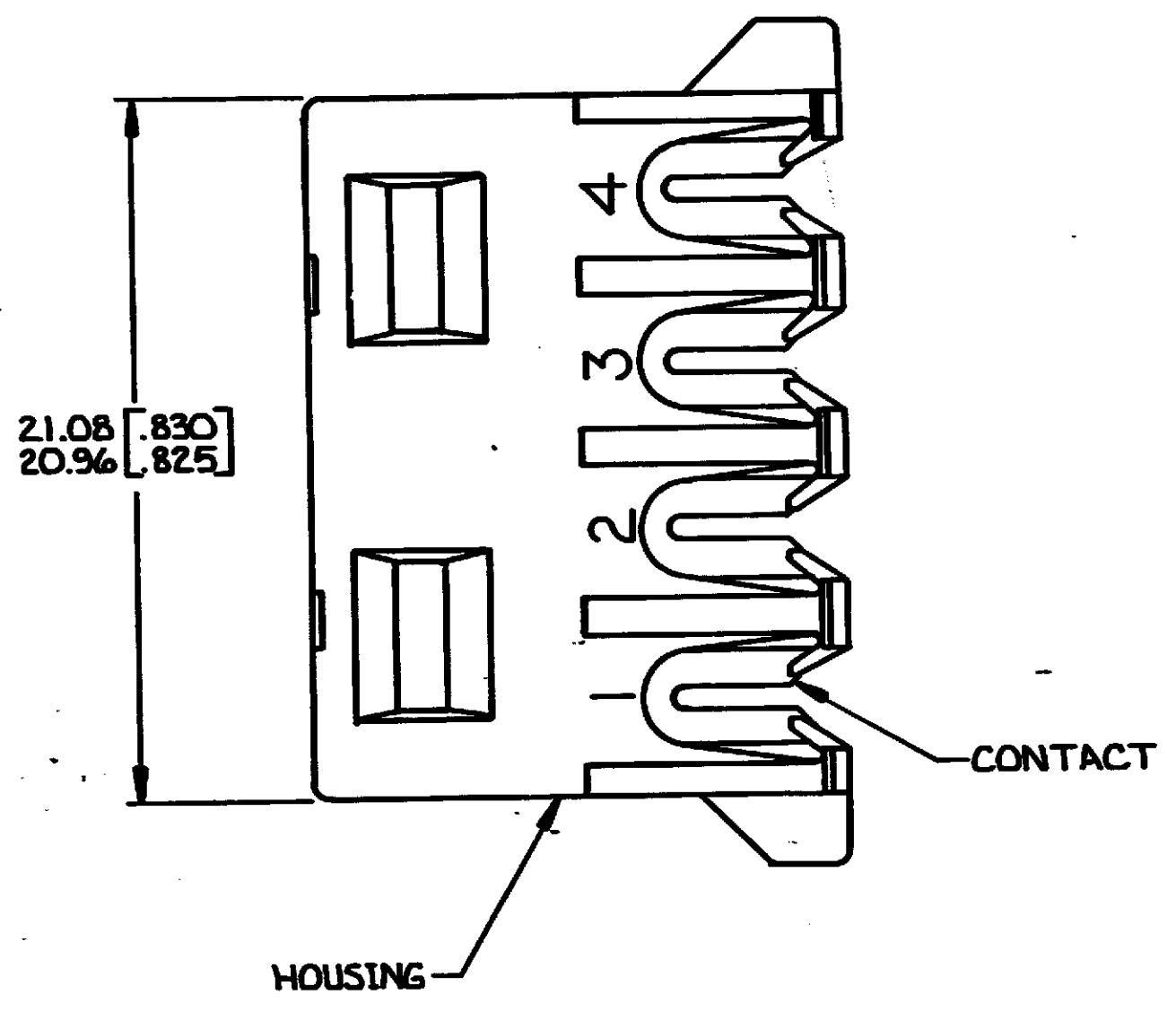

⚠ MATERIAL: HOUSING-NYLON, 94V-2, NATURAL
 CONTACT-PH BRZ (PRE-TIN PLATE
 0.00076 [.000030] MIN. THK)
 2. DIMENSIONS IN BRACKETS ARE IN INCHES.

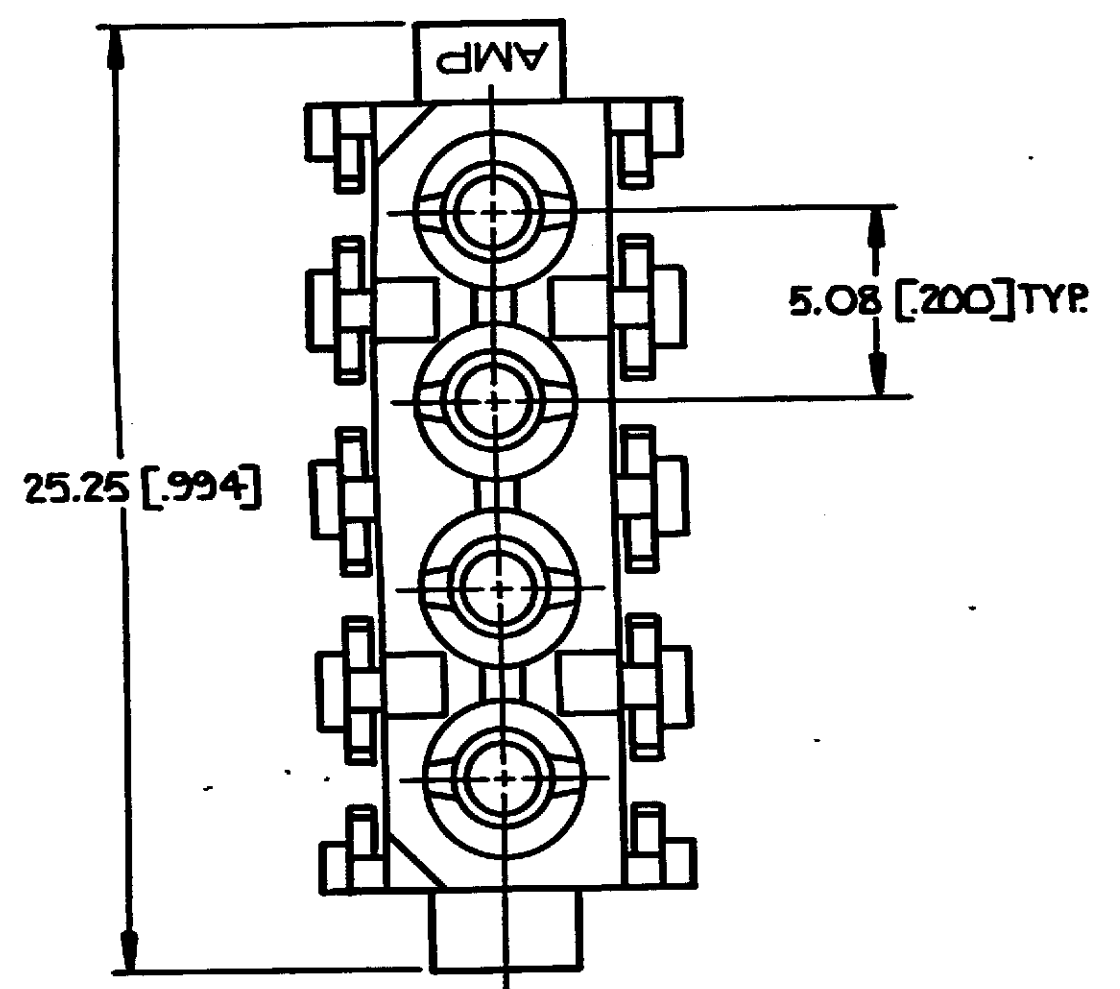
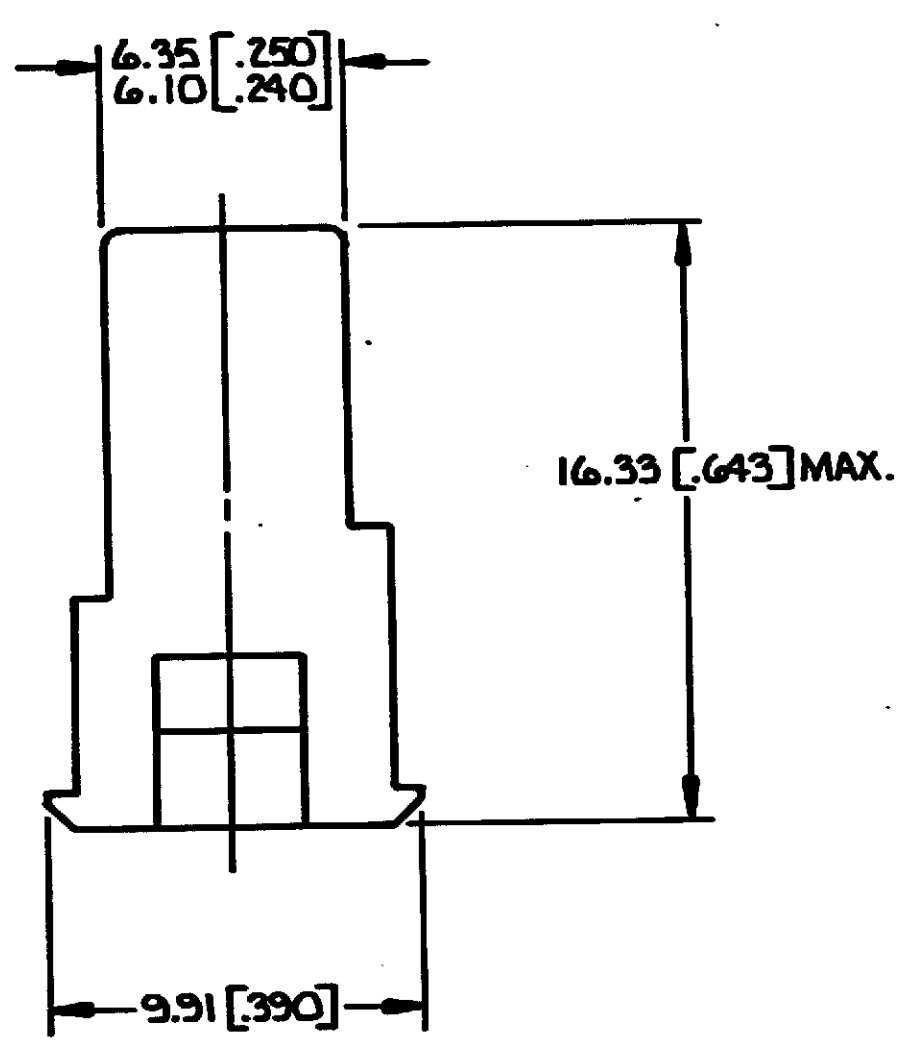

METRIC

UNLESS OTHERWISE SPECIFIED DIMENSIONS ARE IN MM		DR	P. Collins 10-25-89	
TOLERANCES ON		CHK	R. Irving 10-30-89	
2 PL DEC ±		APP	G. Brown 10-30-89	
3 PL DEC ± 0.13 [.005]		APPD		
ANGLES ±		PRODUCT SPEC		
MATERIAL	⚠	APPLICATION SPEC	SIZE	FSCM NO
FINISH	⚠	WEIGHT	C	00779
			SCALE	5:1
		DRAWING NO		770643
		SHEET		1 OF 1

18 AWG	770643 -1
WIRE SIZE	PART NO

AMP | AMP INCORPORATED
 Harrisburg, Pa. 17105
 NAME
 PLUG ASSEMBLY, INSULATION DISPLACEMENT,
 COMMERCIAL MATE-N-LOK™