

IN THE CONSTANT PURPOSE OF IMPROVING ITS PRODUCTS, Amphenol Socapex RESERVES THE RIGHT TO MODIFY ANY DIMENSION OR CHARACTERISTICS.  
FM.NPD.0036.THYZE.PUNE rev C

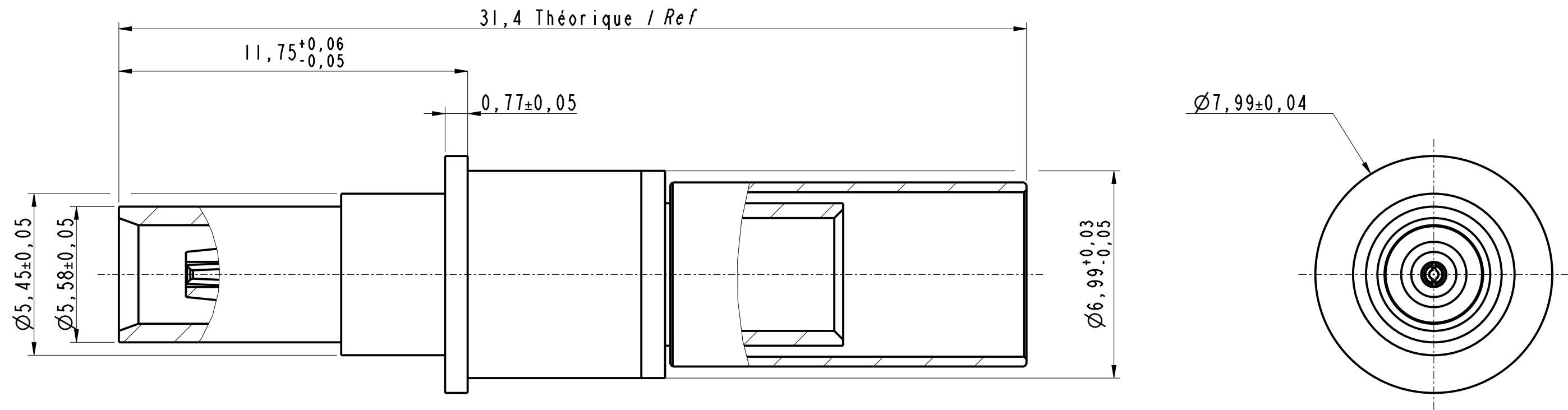

**Note**

- ① - Contact livré non assemblé  
*Contact delivered unassembled*
- ② - Cable compatible: CXN3671  
*Cable compatible: CXN3671*
- ③ - Outil de sertissage:  
Contact intérieur TBD  
Contact extérieur TBD  
- *Crimping tool:*  
Inner contact TBD  
Outer contact TBD
- ④ - *Matières:*
  - Contact extérieur: inox
  - Contact intérieur: alliage de cuivre
  - Fut de sertissage et ferrule: laiton
  - Isolants: PTFE ou équivalent*Material:*
  - Outer contact: Stainless steel
  - Inner contact: copper alloy
  - Crimping barrel and ferrule: brass
  - Inserts: PTFE or equivalent
- ⑤ - *Traitements:*
  - Contact extérieur: passivation
  - Contact intérieur, fut de sertissage et ferrule: dorure*Finish:*
  - Outer contact: passivation
  - Inner contact, crimping barrel and ferrule: Gold

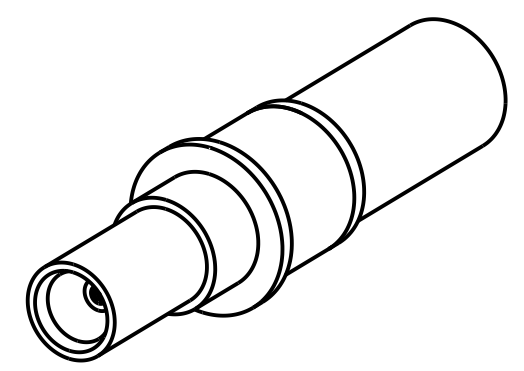

<b>Broche Coax T8 75 ohms 12G-SDI</b> <b>Pin coax S8 75 ohms 12G-SDI</b> <b>Ref : 612460</b>			
DRAWN BY : M.PRUD'HOM		UPDATED BY : M.LAINE	
		LAST APPROVED BY : L.LAGRANGE	
<small>ALL DIMENSIONS ARE IN MM</small> 	<b>AMPHENOL SOCAPEX</b>		<small>ORIGINAL DRAWING DATE :</small> 24/02/21
	B.P. 29 74311 THYZE CEDEX		<small>CONFIGURATION DATA ARE AVAILABLE IN PDM</small>
SCALE : 7			<small>REV :</small> B <small>PAGE :</small> 1/1
			<b>172-PLC-271-00</b>