



## RAYCHEM GEL IN-LINE SPLICE KIT (GILS) (1000V)

### KEY FEATURES

- PowerGel sealant filled splice for buried, underground, and overhead applications
- Fast and simple to install, requires just a 5/16" Allen wrench or a torque wrench and a knife
- PowerGel sealant easily peels away leaving a clean connection
- Can be used on aluminum or copper cables
- Meets requirements of ANSI C119.1

TE Connectivity's (TE) Raychem gel in-line splice kit offers a state-of-the-art sealed splice for both underground, buried and overhead applications. With its revolutionary PowerGel sealing gel, it covers and seals the splice quickly and easily, saving both time and effort. PowerGel sealant is rated to 95°C.

The kit's range-taking mechanical connector splices aluminum and copper cables. Since everything is included in one convenient kit (even the connectors) you will not get caught without all the right equipment.

Closing the rugged GILS closure is literally a snap. Small housings allow for installation in cramped locations. The GILS-4/0 splice closure is 4.25" long, while the GILS-350 is 7.1" long.

The GILS closure is simple to re-enter because the PowerGel sealant pulls away leaving a clean connection. The only tools required to deploy the GILS closure in the field are a 5/16" Allen wrench or a torque wrench and a knife.

Customers can count on consistent, high quality products, driven by TE's proven innovation and backed by our extraordinary customer support.



Molded cover of UV stable, impact resistant polypropylene provides rugged protection for underground or overhead applications.

Frangible fingers provide wide cable range.

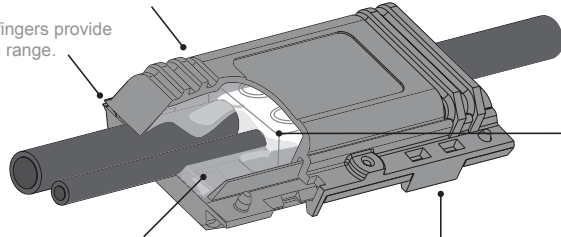

Range-taking mechanical connector made of aluminum. Accepts both copper and aluminum conductors.

Silicone gel is high dielectric insulation and provides constant pressure on cable and connector to provide waterseal. PowerGel sealing gel is specially formulated for high temperature environments.

Snap-lock ensures that cover remains closed.

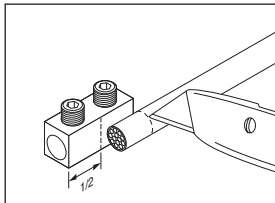

1. Remove insulation equivalent to half the connector length.

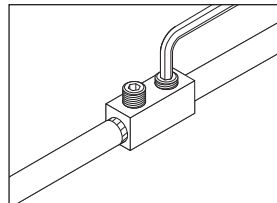

2. a. Insert conductors into connector.  
b. Using 5/16" Allen wrench, tighten set screws.  
c. Torque screws to 225 in-lb (25.4 Nm)  
d. Flex cable.  
e. Torque again.

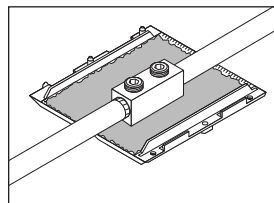

3. Center connector over GILS gel cover.

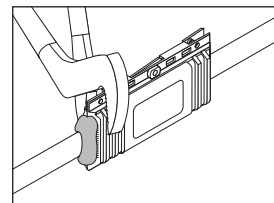

4. Snap shut both locks. Use pliers, if needed, to close.

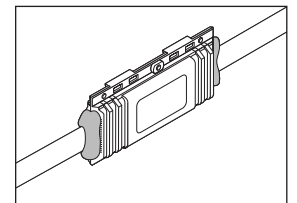

5. Completed splice.

## INSTALLED DIMENSIONS

Kit Description	Length inches (mm)	Width inches (mm)	Height inches (mm)
GILS-4/0	4.25 (108)	2 (51)	1.1 (30)
GILS-350	7.1 (180)	2.75 (71)	1.57 (40)

## SELECTION INFORMATION

Description	Use Range	Recommended Torque
GILS 4/0	#2 - 4/0 AWG (33 - 107 mm <sup>2</sup> )	225 in-lb. (25.4 N•m)
GILS 350	1/0 - 350kcmil (50 - 150 mm <sup>2</sup> )	225 in-lb. (25.4 N•m)

Meets requirements of ANSI C119.1

Related Product Information: EDR-5298 GILS-4/0  
EDR-5394 GILS-350

[te.com/energy](http://te.com/energy)

©2015 TE Connectivity Ltd. family of companies. All Rights Reserved. EPP-2600-DDS-5/16-EN-AMS-GILS-Raychem E105

Raychem, TE, TE Connectivity and TE connectivity (logo) are trademarks. Other logos, product and/or company names might be trademarks of their respective owners. While TE has made every reasonable effort to ensure the accuracy of the information in this brochure, TE does not guarantee that it is error-free, nor does TE make any other representation, warranty or guarantee that the information is accurate, correct, reliable or current. TE reserves the right to make any adjustments to the information contained herein at any time without notice. TE expressly disclaims all implied warranties regarding the information contained herein, including, but not limited to, any implied warranties of merchantability or fitness for a particular purpose. The dimensions in this catalog are for reference purposes only and are subject to change without notice. Specifications are subject to change without notice. Consult TE for the latest dimensions and design specifications.

## FOR MORE INFORMATION: TE Technical Support Centers

USA: + 1 800 327 6996  
France: + 33 380 583 200  
UK: + 44 0870 870 7500  
Germany: + 49 896 089 903  
Spain: + 34 916 630 400  
Italy: + 39 333 250 0915  
Benelux: + 32 16 351 731  
Canada: + 1 (905) 475-6222  
Mexico: + 52 (0) 55-1106-0800  
Latin/S. America: + 54 (0) 11-4733-2200  
China: + 86 (0) 400-820-6015