

APPROVED: _____
 DATE: _____ TITLE: _____

| Rev | AWO # | Description | Date | Appr |
|-----|-------|---------------|----------|-------|
| - | 7440 | RELEASED | 02/27/07 | |
| A | | REVISED SHAPE | 11/10/09 | |
| B | | REDRAWN | 7/3/13 | |
| C | | REVISED SHAPE | 10/24/13 | AV/LW |

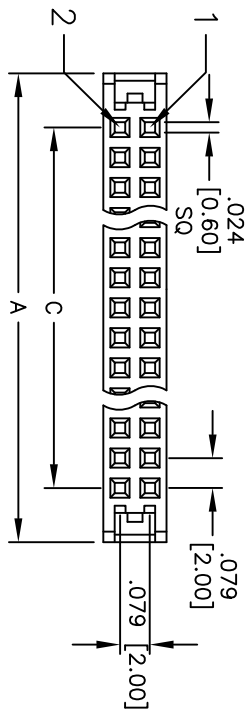
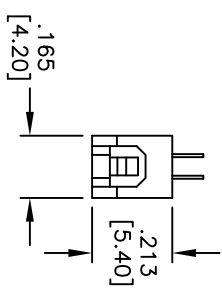
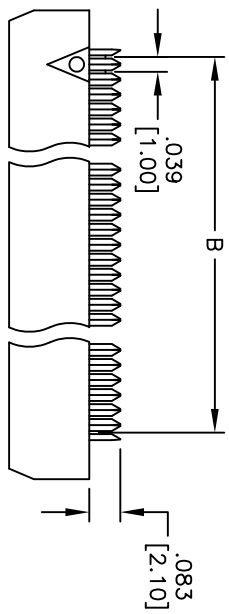
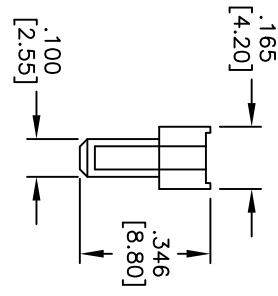
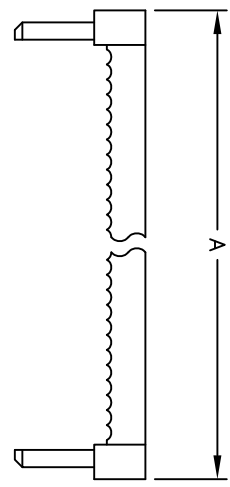

Positions: 6 thru 40, 44, 48, 50, 54, 56, 60, 62, 64, & 68, 80
 A = .079 [2.00] x No. of Positions per Row + .205 [5.20]
 B = .079 [2.00] x No. of Spaces + .039 [1.00]
 C = .079 [2.00] x No. of Spaces + .039 [1.00]

SPECIFICATIONS:
 Material: PBT, glass reinforced, rated UL 94V-0
 Insulator color: Black
 Contacts: Copper Alloy
 Plating: Gold flash over Nickel on contact area, Tin over copper underplate on IDC area.
 Electrical: Contact resistance: 20 mohms max. initial
 Insulation resistance: 1,000 Mohms min.
 Dielectric withstanding voltage: 500 VAC for 1 minute
 Temperature Rating: Operating temperature: -40°C to +105°C
 Environmental: Lead free, RoHS compliant



ADAM TECH

909 Rahway Avenue, Union, NJ 07083
 Phone: 908-687-5000 Fax: 908-687-5710

TITLE: .079 [2.00] FLAT CABLE IDC SOCKET

| | |
|--|----------|
| UNLESS OTHERWISE SPECIFIED ALL DIMENSIONS ARE INCHES [MM] | |
| TOLERANCES EXCEPT AS NOTED | |
| INCHES | HOLDS |
| .X ± .10 | ± .10 |
| .XX ± .020 | ± .015 |
| .XXX ± .015 | ± .010 |
| APPROVALS | DATE |
| DRAWN BW | 01/16/07 |
| CHECKED | |
| APPROVED | |

| | | |
|--------------|---------------------|--------------|
| SIZE X | PART NO. 2FCS-XX-SG | REV. C |
| REF: S00087T | SCALE: NTS | SHEET 1 OF 1 |