

PRODUCT NUMBER
98451-XXX-XXLF

WHEN REQUIRED, ADD SUFFIX LETTER "LF"
INDICATES THE PRODUCT IS ROHS COMPLIANT
& COMPATIBLE, SEE NOTE 7

TOTAL NB OF POSITIONS 04 TO 72
PACKAGING OPTIONS, NOTE 3

PIN STYLE	"A"	"F"
01	5.4	7.8

PLATING:

- 1 = 0.76µm FULL GOLD, OVER 1.27µm Ni MIN
- 3 = 3.81µm FULL TIN/LEAD OVER 1.27µm Ni MIN.
WHEN "LF" IS REQUIRED, 2µm MATTE TIN OVER 1.27µm MIN NICKEL IS PROVIDED INSTEAD OF TIN-LEAD
- 8 = 0.38µm FULL GOLD, OVER 1.27µm Ni MIN

NOTES:

1. HOUSING MAT'L : HIGH TEMPERATURE THERMOPLASTIC. UL94V-0 COLOR: BLACK
2. PIN MATERIAL : PHOSPHOR BRONZE
3. PACKAGING OPTIONS:
- = POLY BAGS
A = TAPE & REEL WITH PICK UP CAP, AS AVAILABLE
9N MIN RETENTION IN EITHER DIRECTION
5. TO DETERMINE DIMENSIONS :
N = NUMBER OF POSITIONS PER ROW
EXAMPLE : 8 POS PER ROW, N x 2.54 = 20.32mm
6. RECOMMENDED IR PROFILE PER TA-842
7. ROHS COMPATIBLE PRODUCT SPECIFICATIONS

- d - PLATING:
- "LF" MEANS THE PRODUCT IS LEAD-FREE, 2µm MINIMUM MATTE TIN OVER 1.27µm MINIMUM NICKEL UNDERPLATE.
- b - MANUFACTURING PROCESS COMPATIBILITY
- THE HOUSING WILL WITHSTAND EXPOSURE TO 260°C PEAK TEMPERATURE FOR 30 SECONDS MAX IN A CONVECTION, INFRA-RED OR VAPOR PHASE OR REFLOW OVEN.

- c - LABELLING:
- MEETS PACKAGING SPECS AS PER GS-14-920
- d - THIS PRODUCT MEETS EUROPEAN UNION DIRECTIVES AND OTHER COUNTRY REGULATIONS AS DESCRIBED IN GS-22-008

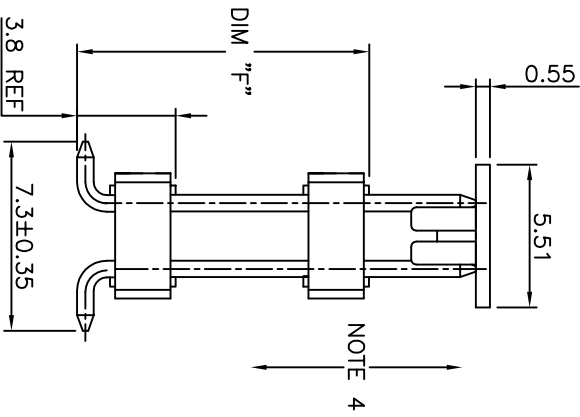
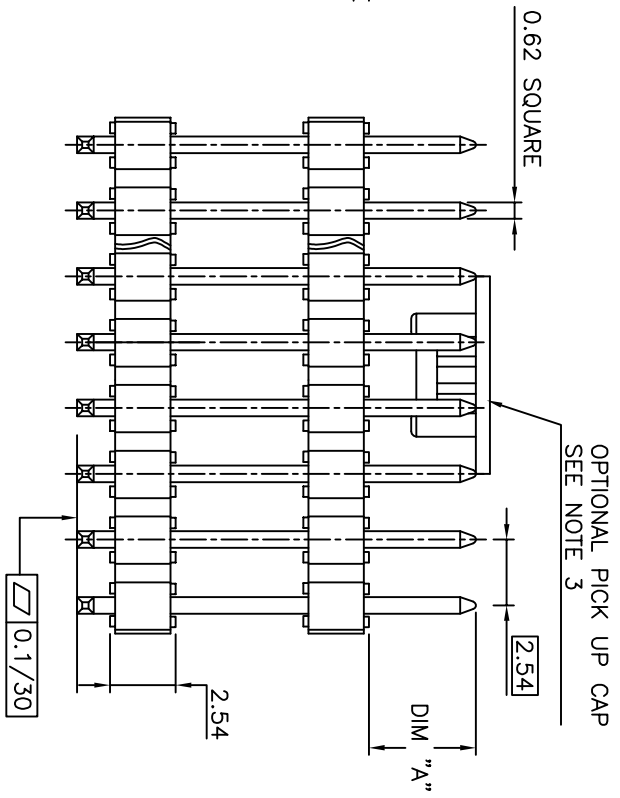
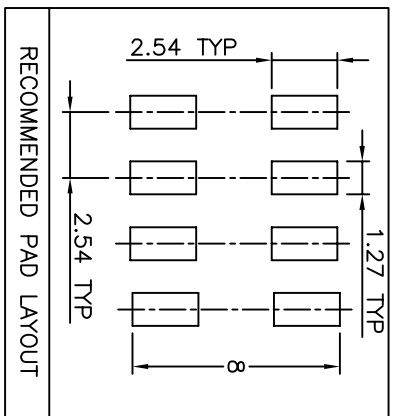
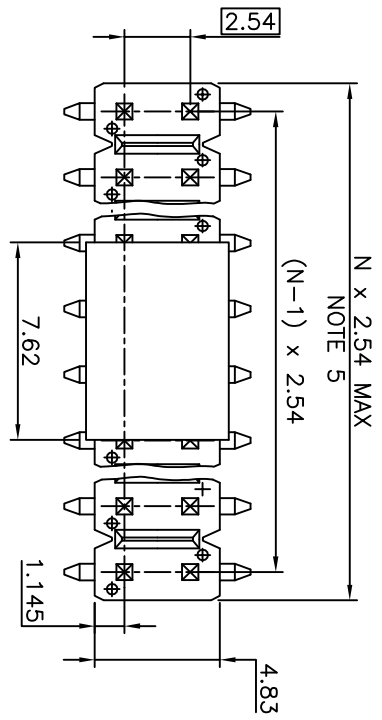

mat'l. code	ISO 1302	tolerance
ISO 1302	ISO 406	ISO 1101

ltr	ecn no	dr	date	tolerances unless otherwise specified	angles	linear	xxx	±0.3
A	F00143	LWU	00.03.01				xxx	±0.3
B	F00171	LWU	27.03.00				xxx	±0.13
C	F20116	DLE	02.01.17				xxx	±0.05
D	F20149	DLE	02.02.19				xxx	±0.05
E	F06-0166	LWU	06.04.14	ENGR COMPAGNON				99.07.21
F	F06-0208	JCO	06.06.22	chr				99.07.21
G	F-23186	AMA	16.02.01	qppd				99.07.21

projection	scale	product family	title
projection	scale 5:1	BERSSTIK	HDR, DR, DB

dwg no	sheet	size
98451	1 of 1	A3

sheet	revision	sheet	index	sheet	index