

REVISIONS		
LTR	DESCRIPTION	DATE
A1	REVISED PER ECO-13-016159	10/11/2013

**NOTES**

- ALL DIMENSIONS ARE IN INCHES  
[MILLIMETERS]
- DIMENSIONS APPEARING IN TABLE ARE AS FOLLOWS:  
a - AS SUPPLIED  
b - AFTER UNRESTRICTED RECOVERY
- COATING IS OPTIONAL. AS SUPPLIED DIMENSIONS APPEARING IN TABLE ARE FOR UNCOATED PARTS WHEN COATING IS ADDED, ENTRY DIAMETERS WILL BE REDUCED BY 0.06 MAX.

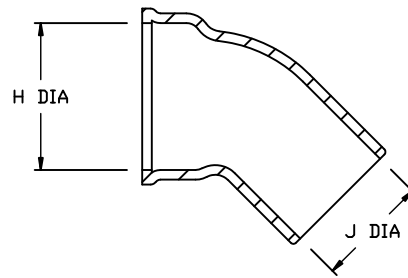

AS SUPPLIED

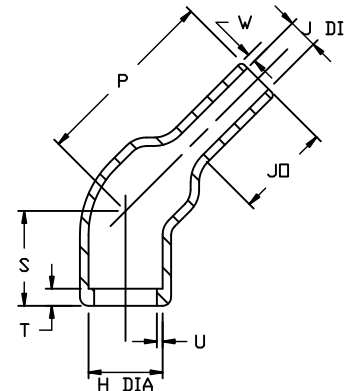

AFTER UNRESTRICTED RECOVERY

**ORDERING INFORMATION**

BASE PART NUMBER 245W0XX -X /XX -0

MATERIAL DASH NUMBER \_\_\_\_\_

-3 POLYOLEFIN, SEMI RIGID (RT-301)  
-4 POLYOLEFIN, FLEXIBLE (RT-1304)  
-12 FLUORO ELASTOMER, FLEXIBLE (RT-1312)  
-25 ELASTOMER, FLUID RESISTANT (RW-2070)

ADHESIVE SLASH NUMBER \_\_\_\_\_  
SEE COMPATIBILITY CHART BELOW

COLOR DESIGNATOR \_\_\_\_\_

PART DESCRIPTION	H		J		P	S	T	U	JO	W
	MIN	MAX	MIN	MAX	±10%	±10%	±10%	±10%	±10%	±20%
	a	b	a	b	b	b	b	b	b	b
245W032	.60 [15,4]	.55 [14,0]	.35 [8,8]	.23 [5,8]	1.15 [29,2]	.50 [12,7]	.12 [3,0]	.04 [1,0]	.67 [17,0]	.06 [1,5]
245W042	.88 [22,4]	.68 [17,3]	.61 [15,6]	.28 [7,1]	1.50 [38,1]	.50 [12,7]	.12 [3,0]	.04 [1,0]	.88 [22,4]	.07 [1,7]
245W053	1.16 [29,5]	.90 [22,8]	.89 [22,7]	.33 [8,5]	1.65 [41,9]	.50 [12,7]	.12 [3,0]	.05 [1,3]	.86 [21,8]	.08 [2,0]
245W063	1.44 [36,6]	1.11 [28,3]	1.17 [29,7]	.40 [10,1]	1.93 [49,0]	.50 [12,7]	.12 [3,0]	.07 [1,8]	.96 [24,4]	.09 [2,3]
245W074	1.72 [43,6]	1.35 [34,4]	1.45 [36,8]	.61 [15,6]	2.25 [57,2]	.50 [12,7]	.12 [3,0]	.07 [1,8]	1.00 [25,4]	.12 [3,0]

Raychem Molded Parts  
**CUSTOMER DRAWING**

**COMPATIBILITY CHART**

MATERIAL DASH NO.	ADHESIVE (COATING) SLASH NUMBER	ADHESIVE (COATING) S NUMBER
-3	/42; /86	S-1017; S-1048
-4	/42; /86	S-1017; S-1048
-12	N/A	N/A
-25	/86; /225	S-1048; S-1206

UNLESS OTHERWISE SPECIFIED DIMENSIONS ARE METRIC AND INCHES ARE IN BRACKETS. DECIMAL TOLERANCES XXX ± 0.13 (.005) XX ± 0.25 (.01) X ± 0.50 (.10) ANGLE TOLERANCE .X ± 1 DEG.	DRAWN <b>M Mazariegos</b> 10/17/11	APPROVED <b>D.Hurrell</b> 10/17/11		TE Connectivity
	RPN _____	CAD FILE: <b>245W0XX_CD</b>		TITLE <b>45° BOOT (SPIN LOCK BOOT)</b>
	THIRD ANGLE PROJECTION 	SIZE <b>B</b>		CODE IDENT. NO. <b>06090</b>

© 2011-2013 Tyco Electronics Corporation. All rights reserved. DO NOT SCALE THIS DRAWING SHEET 1 OF 1