

Bores for countersunk screws
DIN 7991

Swiveling range

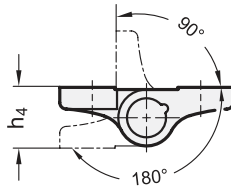

4 Type

A 2x2 bores for countersunk screws

Metric table

Dimensions in: millimeters - inches

2 l_1	3 l_2	d	h_1	h_2	h_3	h_4	l_3	m_1	m_2
60 2.36	60 2.36	8.3 0.33	18.5 0.73	7.5 0.30	9.5 0.37	19 0.75	20 0.79	36 1.42	36 1.42

Specification

- Body
Zinc die-cast **ZD**
Powder coated
Black, RAL 9005, textured finish **●SW**
Silver, RAL 9006, textured finish **●SR**
- Cover cap
Plastic
Technopolymer (Polyacetal POM)
Temperature resistant up to 176 °F (80 °C)
- *Plastic Characteristics* → page 2135
- **RoHS compliant**

Accessory

- Spacer plates GN 2370 → page 1380
- Spacer plates with tapped holes GN 2372 → page 1381

Information

GN 437.1 hinges fit perfectly into a wide range of application thanks to their timeless design. They are also matched with the GN 437 functional hinge family as complementary hinges.

see also...

- *List of Hinge Types* → page 1324
- *Hinges GN 437 (with Adjustable Friction)* → page 1416
- *Hinges GN 437.2 (with Adjustable Lever)* → page 1420
- *Hinges GN 437.3 (with Spring-Loaded Return)* → page 1422
- *Hinges GN 437.4 (with 4 Indexing Positions)* → page 1418

<p>How to order</p> <p>GN 437.1-ZD-60-60-A-SR</p>	1 Material
	2 Width l_1
	3 Length l_2
	4 Type
	5 Color

3.1
3.2
3.3
3.4
3.5
3.6
3.7
3.8
3.9
3.10

