

THIS DRAWING IS UNPUBLISHED.

RELEASED FOR PUBLICATION

© COPYRIGHT - BY TYCO ELECTRONICS CORPORATION. ALL RIGHTS RESERVED.

LOC GP DIST 00

REVISIONS

P	LTR	DESCRIPTION	DATE	DWN	APVD
	T	REVISE PER 06-019072 ECO	30/AUG/06	ECC	JS

AMPOWER is a registered trademark of AMP Incorporated.

- CABLE LENGTH TOLERANCE = 0.2% OF TOTAL CABLE LENGTH, WITH A MINIMUM TOLERANCE OF ±3.18 [.125]. I.E. 6096 [240.0] * .002 = ± 12.2 [.480]
- PRODUCT AND PROCESSING MUST MEET REQUIREMENTS OF TYCO ELECTRONICS STANDARD 230-702.

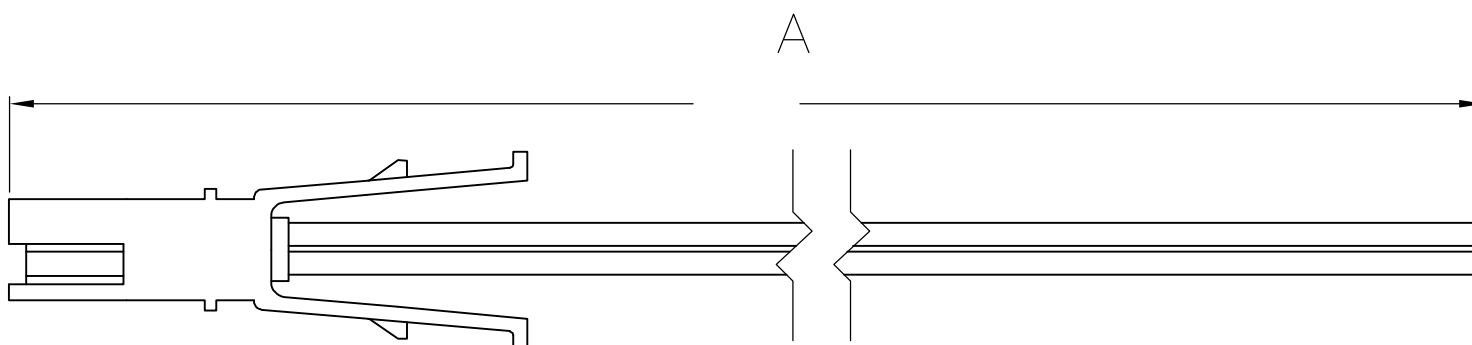
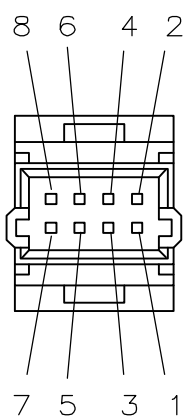

	8	7	6	5	4	3	2	1						
	-	-	-	-	-	-	BLK	RED	-	-	1828.8 [72.00]	PVC	22 AWG	1-765362-4
OBSOLETE	X	X	X	X	X	X	X	X	-	-	942.3 [37.10]	TEF	22 AWG	1-765362-3
OBSOLETE	X	X	X	X	X	X	X	X	-	-	1247.1 [49.10]	TEF	22 AWG	1-765362-2
OBSOLETE	X	X	X	X	X	X	X	X	-	-	437.4 [17.22]	PVC	22 AWG	1-765362-1
OBSOLETE	X	X	X	X	X	X	X	X	-	-	285.0 [11.22]	PVC	22 AWG	1-765362-0
OBSOLETE	X	X	X	X	X	X	X	X	-	-	1092.2 [43.00]	PVC	22 AWG	765362-9
OBSOLETE	X	X	X	X	X	X	X	X	-	-	575.6 [22.66]	PVC	22 AWG	765362-8
OBSOLETE	X	X	X	X	X	X	X	X	-	-	660.4 [26.00]	PVC	22 AWG	765362-7
OBSOLETE	X	X	X	X	X	X	X	X	-	-	304.8 [12.00]	TEF	22 AWG	765362-6
OBSOLETE	X	X	X	X	X	X	X	X	-	-	152.4 [6.00]	PVC	22 AWG	765362-5
OBSOLETE	X	X	X	X	X	X	X	X	-	-	609.6 [24.00]	PVC	22 AWG	765362-4
OBSOLETE	GW	GW	GW	GW	GW	GW	GW	GW	△	-	939.8 [36.00]	PVC	22 AWG	765362-3
OBSOLETE	X	X	X	X	X	X	X	X	-	-	340.4 [13.30]	TEF	22 AWG	765362-2
OBSOLETE	X	X	X	X	X	X	X	X	-	-	152.4 [6.00]	TEF	22 AWG	765362-1
	8	7	6	5	4	3	2	1	:		CABLE ASSEMBLY LENGTH	STYLE	CONDUCTOR THICKNESS	

THIS DRAWING IS A CONTROLLED DOCUMENT.

DWN D. BABOW 01-23-92

CHK SRS 01-23-92

APVD - 01-23-92 - ALG

PRODUCT SPEC 01-23-92 JEL

APPLICATION SPEC

114-49005

WEIGHT -

CUSTOMER DRAWING

tyco Electronics Tyco Electronics Corporation Harrisburg, PA 17105-3608

NAME AMPOWER Wave Crimp System MODULE ASSY, PLUG, 8 SIG

SIZE CAGE CODE DRAWING NO RESTRICTED TO

A3 00779 C-765362

SCALE FULL SHEET 1 OF 1 REV T

DIMENSIONS: mm [INCHES]

TOLERANCES UNLESS OTHERWISE SPECIFIED:

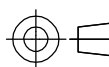

0 PLC	± -
1 PLC	± -
2 PLC	± -
3 PLC	± -
4 PLC	± -
ANGLES	± -
FINISH	-