

PRODUCT NUMBER
10119856 -XYHFLF

LEAD FREE OPTION SEE NOTE 12

HIGH TEMPERATURE PLASTIC
SEE NOTE 1

NO OF
POSITIONS
SEE NOTE 3

PIN PLATING
SEE SHEET 2

BASE PART NO.

OPEN KNIT LINE
PERMISSIBLE IN THIS AREA

NOTE 8

.100
2.54 TYP

.100
2.54

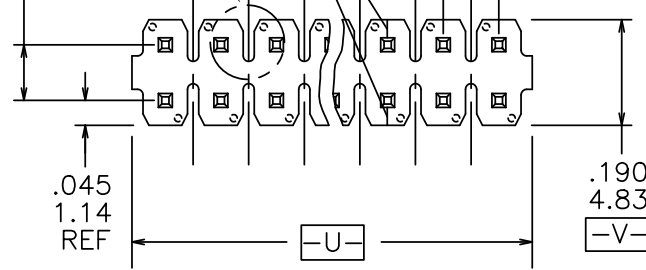

DOUBLE ROW TOP VIEW

MATING LENGTH
DIM H ±.008
±.20

TOTAL PIN LGTH
DIM F REF

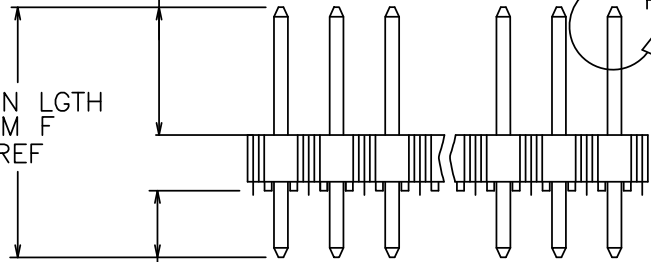

DOUBLE ROW
SIDE VIEW

TAIL LENGTH
DIM G ±.010
±.25

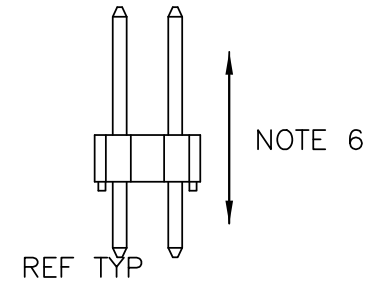

DOUBLE ROW
END VIEW

.013 [0.33]
MAX TYP

.025 [0.64] ±.001 [0.03]
TYP

⌀.020/0.51 ⌀U(M)V(S)
NOTE 4

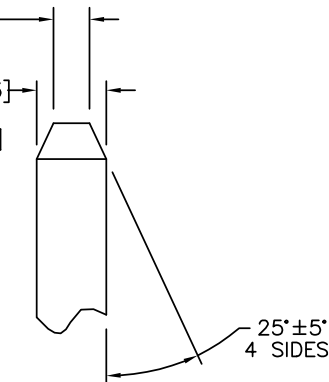

DETAIL P
SCALE 5:1
TYP BOTH ENDS

mat'l. code SEE NOTE 1 & 2		surface ISO 1302 ✓		tolerance ISO 406 ISO 1101		projection INCH/MM		product family BERGSTIK	
ltrlecn nōdr		date		tolerances unless otherwise specified		title		BERGSTIK™ HEADER. D/R	
A	-	J.Z	2012-02-29	angles	linea	XXX±.01/XXX±.03	.100/2.54cc STRAIGHT		dwg no
				0°±2'		XXX±.005/XXX±.013	scale 1:1		sheet of 2
						XXX±.0020/XXX±.005	FCJ		size
				dr	J.ZHOU	2012-02-29	10119856		A3
				engr	J.ZHOU	2012-02-29	type Product Customer Drawing		
				chr	J.ZHOU	2012-02-29			
				appd	R.BIAN	2012-02-29			
sheet index	revision	2	2						
	sheet	1	2						



Copyright FCI

PRODUCT NUMBER	TOT. PIN LGTH.		TAIL LENGTH		MATING LENGTH		PACKAGING
	DIM F	DIM F	DIM G	DIM G	DIM H	DIM H	
	ENGLISH	METRIC	ENGLISH	METRIC	ENGLISH	METRIC	
10119856-400HLF	0.575	14.6	0.098	2.50	0.376	9.56	REEL

NOTES

- ① BODY MATERIAL : MANUFACTURER'S OPTION OF LCP
FLAME RETARDENT PER UL-94V-0.
COLOR: BLACK
- ② PIN MATERIAL : BRASS.
- ③ EVEN NUMBER OF POSITIONS FROM 2 (2X1) THROUGH 72 (2X36)
FOR BERGSTIK. -X00H INDICATES BERGSTRIIP PRODUCT.
FOR SPECIAL GEOMETRY OF THIS CONTINUOUS STRIP PRODUCT.
AUTOMATED REELS WILL CONTAIN 20,000 PINS.
SEE SPECIFIC PART NUMBERS FOR AVAILABILITY.
- ④ MEASURED WITH PART IN RESTRAINED CONDITION.
- 5. TWO SIDES OF PIN TIPS NOT PLATED. TYPICAL BOTH ENDS.
- ⑥ 2LBS/0.9KG MIN PIN RETENTION IN EITHER DIRECTION.
- ⑦ ±.010/0.25 TOL APPLIES TO ALL "G" TAILS EXCEPT
INDICATED PARTS ON TABLE WHERE +.010/0.25 -.000/0.00
APPLIES.
- ⑧ NOTCH CONFIGURATION WILL VARY PER VENDOR'S DISCRETION.
- ⑨ TAIL LENGTH (DIM. G) TO BE ±.008/.0.20.

- 10. POSITIONS PER ROW 37 TO 50 CAN BE PRODUCED,
BUT FLATNESS AND CURVATURE MAY NOT BE
HELD AS CLOSE AS 36 POSITIONS.
- ⑩ TOTAL LENGHT= .100 [2.54] X NO DE COLUMNS
- 12. ADD "LF" SUFFIX AT THE END OF PART NUMBER FOR LEAD FREE OPTION.

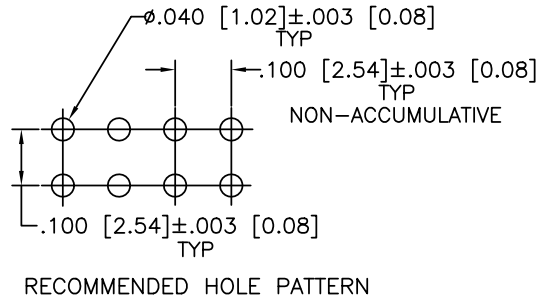
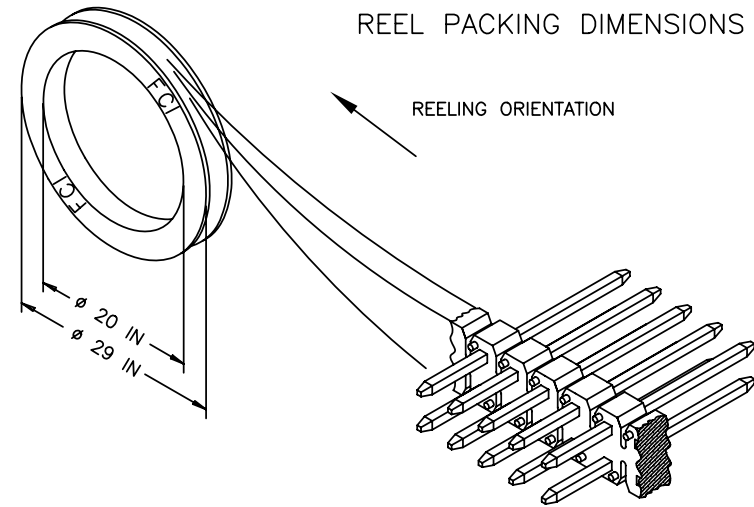

PIN PLATING CODES:	WIRE CODES:
10119856-4YYHLF	100u"/2.54u MIN TIN OVER 50u"/1.27u MIN Ni

mat'l. code SEE NOTE 1 & 2	surface ISO 1302 ✓	tolerance ISO 406 ISO 1101	projection ASME Y14.5	product family BERGSTIK
ltr/electn n°dr date	tolerances unless otherwise specified		INCH/MM	title BERGSTRIIP™ HEADER. D/R .100/2.54cc STRAIGHT
A	angles	linear	scale 1:1	dwg no 10119856
	0°±2'	XXX±.01/XXX±.03 XXX±.005/XXX±.013 XXX±.0020/XXX±.005		shee 2 of 2 size A3
	dr	J.ZHOU	2012-02-29	type Product Customer Drawing
	engr	J.ZHOU	2012-02-29	
	chr	J.ZHOU	2012-02-29	
	appd	R.BIAN	2012-02-29	
sheet index	revision sheet			