

## I.167 p | Tapered handles

with protection, Duroplast

METRIC

RoHS

PF

PA

+230 °F  
-4 °F

### MATERIAL

Phenolic based (PF) Duroplast body, polyamide based (PA) technopolymer flange, black colour, glossy finish.

### STANDARD EXECUTION

Zinc-plated steel threaded stud, chamfered flat end according to UNI 947 : ISO 4753 (see Technical data on page A-10).



## I.126 | Shaped handles

Duroplast

METRIC

RoHS

PF

+230 °F  
-4 °F

### MATERIAL

Phenolic based (PF) Duroplast, black colour, glossy finish.

### STANDARD EXECUTIONS

- **I.126:** threaded blind hole.
- **I.126-p:** zinc-plated steel threaded stud, chamfered flat end UNI 947 : ISO 4753 (see Technical data on page A-10).



| Conversion Table  |      |
|-------------------|------|
| 1 mm = 0,039 inch |      |
| L                 |      |
| mm                | inch |
| 65                | 2.56 |
| 75                | 2.95 |
| 80                | 3.15 |
| 90                | 3.54 |
| 95                | 3.74 |
| 104               | 4.09 |
| 110               | 4.33 |

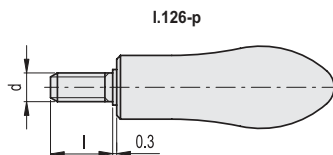
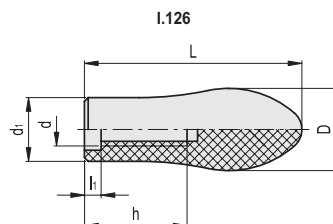
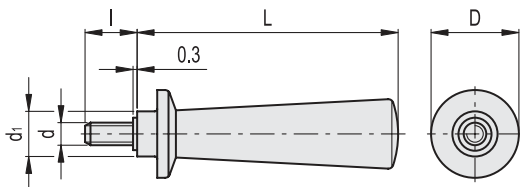

|       |                   | METRIC |     |     |    |    |    |
|-------|-------------------|--------|-----|-----|----|----|----|
| Code  | Description       | D      | L   | d6g | d1 | l  | ⚖  |
| 20306 | I.167/103 p-M8x16 | 35     | 104 | M8  | 18 | 16 | 90 |
| 20311 | I.167/103 p-M8x25 | 35     | 104 | M8  | 18 | 25 | 94 |

|       |               | METRIC |     |     |    |    |     |     |
|-------|---------------|--------|-----|-----|----|----|-----|-----|
| Code  | Description   | D      | L   | d   | d1 | h  | l1  | ⚖   |
| 18201 | I.126/75-M8   | 28     | 75  | M8  | 22 | 30 | 7.5 | 40  |
| 18202 | I.126/75-M10  | 28     | 75  | M10 | 22 | 40 | 7.5 | 38  |
| 18401 | I.126/95-M12  | 33     | 95  | M12 | 25 | 58 | 8   | 67  |
| 18501 | I.126/110-M14 | 37     | 110 | M14 | 28 | 70 | 4   | 109 |

|       |                    | METRIC |     |     |    |    |     |
|-------|--------------------|--------|-----|-----|----|----|-----|
| Code  | Description        | D      | L   | d6g | d1 | l  | ⚖   |
| 18211 | I.126/75 p-M8x25   | 28     | 75  | M8  | 22 | 25 | 63  |
| 18411 | I.126/95 p-M10x30  | 33     | 95  | M10 | 25 | 30 | 107 |
| 18511 | I.126/110 p-M12x30 | 37     | 110 | M12 | 28 | 30 | 158 |

