

- NOTES:
 1. MATERIAL:PHOSPHOR BRONZE
 2. FINISH: PER ES-88
 102-TIN: .000200 MICROINCHES MIN OVER COPPER
 501-GOLD: .000020 MICROINCHES MIN OVER NICKEL
 THE PRIMARY SHIPPING CARTON WILL BE LABELED
 *COMPLIANT TO RoHS DIRECTIVE 2002/95/EC & ELV
 ANNEX II OF DIRECTIVE 2003/53/EC*. CARTONS W/O
 THIS LABEL MAY CONTAIN PRODUCT WITH TIN-LEAD
 IN THE PC TAIL AREA.
 3. PRODUCT SPECIFICATION & PROCESSING PARAMETERS: NONE.
 4. DIMENSIONS GIVEN ARE BEFORE PLATING.
 5. SOLDERABILITY SPECIFICATION: SMES-152 AFTER PLATING.
 6. CAMBER SPECIFICATION: .003 MM/MM OR .003 IN/IN.
 7. BURR SPECIFICATION ES-151.
 8. RECOMMENDED PCB HOLE SPECIFICATION FOR PRESS FIT PINS:
 .062 THK. PCB
 PUNCHED HOLES: .030±.002/.762±0.05
 DRILLED HOLES: .031±.0015/.0787±0.038
 PLATED THRU HOLES: .0295±.0025/.749±0.064

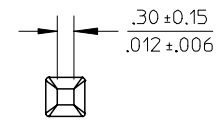
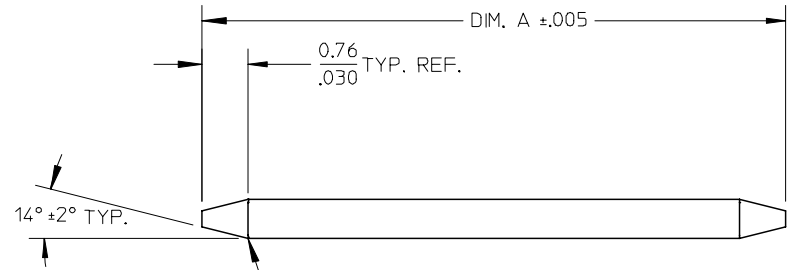

PART TO BE FREE OF ALL TOOL MARKS DUE TO COINING & TRIMMING OPERATION.

| | | | |
|----|----------------|----|----------------|
| 33 | 26.21 1.032 | | |
| 31 | 31.75 1.250 | 74 | 31.24 1.230 |
| 30 | 30.48 1.200 | 69 | 20.85 .821 |
| 27 | 21.39 .842 | 68 | 18.29 .720 |
| 25 | 9.65 .380 | 67 | 16.94 .667 |
| 22 | 15.88 .625 | 66 | 15.49 .610 |
| 20 | 20.32 .800 | 65 | 14.61 .575 |
| 18 | 11.71 .461 | 64 | 13.08 .515 |
| 17 | 11.99 .472 | 60 | 10.01 .394 |
| 15 | 12.70 .500 | 58 | 8.56 .337 |
| 12 | 22.23 .875 | 47 | 19.69 .775 |
| 11 | 16.51 .650 | 46 | 17.86 .703 |
| 10 | 28.58 1.125 | 43 | 38.10 1.500 |
| 9 | 18.69 .736 | 42 | 13.84 .545 |
| 8 | 25.40 1.000 | 41 | 29.21 1.150 |
| 7 | 14.99 .590 | 40 | 34.93 1.375 |
| 5 | 11.10 .437 | 39 | 24.38 .960 |
| 4 | 13.46 .530 | 38 | 27.00 1.063 |
| 3 | 17.45 .687 | 37 | 19.05 .750 |
| 2 | 10.29 .405 | 35 | 23.80 .937 |
| 1 | 14.22 .560 | 34 | 32.26 1.270 |
| N | DIM. A | N | DIM. A |

EC NO: UCP2004-1675
 DRWN: JSCHAFFER2004/03/08
 CHK'D: 2004/03/11
 APPR: YMARGULI 2004/03/17

| | | | | | | |
|---|---------------------------------------|-------|-------------|-----------------|------------------------|---------------------|
| QUALITY SYMBOLS | GENERAL TOLERANCES (UNLESS SPECIFIED) | | SCALE | DESIGN UNITS | THIRD ANGLE PROJECTION | REVISE ON CAD ONLY |
| | mm | INCH | 8:1 | INCH | | |
| | 4 PLACES | ± --- | ± --- | DIMENSION STYLE | | TITLE |
| | 3 PLACES | ± --- | ± --- | MM/IN | | |
| | 2 PLACES | ± --- | ± --- | DRAWN BY | DATE | |
| 1 PLACE | ± --- | ± --- | SCHAFFER | 2004/03/01 | | |
| ANGULAR ±1/2° | | | CHECKED BY | DATE | MOLEX INCORPORATED | |
| DRAFT WHERE APPLICABLE MUST REMAIN WITHIN DIMENSIONS | | | APPROVED BY | DATE | MATERIAL NO. | DOCUMENT NO. |
| | | | MARGULIS | 2004/03/05 | SEE CHART | SD-4166-001 |
| THIS DRAWING CONTAINS INFORMATION THAT IS PROPRIETARY TO MOLEX INCORPORATED AND SHOULD NOT BE USED WITHOUT WRITTEN PERMISSION | | | | | | SHEET NO. 1 OF * |

| PART NO: | ENG NO: | PART NO: | ENG NO: |
|------------|--------------|----------|--------------|
| 08-52-0711 | 4166-1(224) | | 4166-33(224) |
| | 4166-2(224) | | |
| | 4166-3(224) | | 4166-35(224) |
| | 4166-4(224) | | 4166-38(224) |
| | 4166-5(224) | | 4166-39(224) |
| | 4166-7(224) | | 4166-41(224) |
| | 4166-8(224) | | 4166-42(224) |
| | 4166-9(224) | | 4166-43(224) |
| | 4166-10(224) | | 4166-46(224) |
| | 4166-11(224) | | 4166-47(224) |
| | 4166-12(224) | | 4166-58(224) |
| | 4166-15(224) | | 4166-60(224) |
| | | | 4166-64(224) |
| | 4166-18(224) | | 4166-65(224) |
| | 4166-20(224) | | 4166-66(224) |
| | 4166-22(224) | | 4166-67(224) |
| | 4166-25(224) | | 4166-68(224) |
| 08-52-0727 | 4166-27(224) | | 4166-69(224) |
| | 4166-30(224) | | 4166-74(224) |
| | 4166-31(224) | | |
| | | | |
| | | | |
| | | | |
| | | | |
| | | | |
| | | | |
| | | | |
| | | | |
| | | | |

| PART NO: | ENG NO: | PART NO: | ENG NO: |
|------------|--------------|------------|--------------|
| 08-58-0611 | 4166-1(501) | 08-58-0633 | 4166-33(501) |
| | 4166-2(501) | 08-58-0634 | 4166-34(501) |
| 08-58-0613 | 4166-3(501) | 08-58-0635 | 4166-35(501) |
| | 4166-4(501) | | 4166-38(501) |
| | 4166-5(501) | | 4166-39(501) |
| | 4166-7(501) | 08-58-0641 | 4166-41(501) |
| 08-58-0668 | 4166-8(501) | | 4166-42(501) |
| | 4166-9(501) | 08-58-0643 | 4166-43(501) |
| | 4166-10(501) | | 4166-46(501) |
| | 4166-11(501) | | 4166-47(501) |
| 08-58-0612 | 4166-12(501) | | 4166-58(501) |
| | 4166-15(501) | | 4166-60(501) |
| 08-58-0614 | 4166-17(501) | | 4166-64(501) |
| 08-58-0608 | 4166-18(501) | | 4166-65(501) |
| 08-58-0646 | 4166-20(501) | | 4166-66(501) |
| 08-58-0688 | 4166-22(501) | | 4166-67(501) |
| | 4166-25(501) | | 4166-68(501) |
| | 4166-27(501) | | 4166-69(501) |
| 08-58-0630 | 4166-30(501) | 08-58-0674 | 4166-74(501) |
| 08-58-0631 | 4166-31(501) | | |
| | | | |
| | | | |
| | | | |
| | | | |
| | | | |
| | | | |
| | | | |
| | | | |
| | | | |

| | | | |
|---|--|---------------------------------|---------------------------------|
| REV: AJ | SEE SHEET 1 | TITLE: KK .025 SQ PIN | SHEET No. - 5 - |
| DOCUMENT NUMBER: SD- 4166-001 | CREATED / REVISED BY: SCHAFFER | CHECKED BY: SAMIEC | APPROVED BY: MARGULIS |

