

PART NUMBER	REV	FIRST USED
565864-2	R	1-471273-2

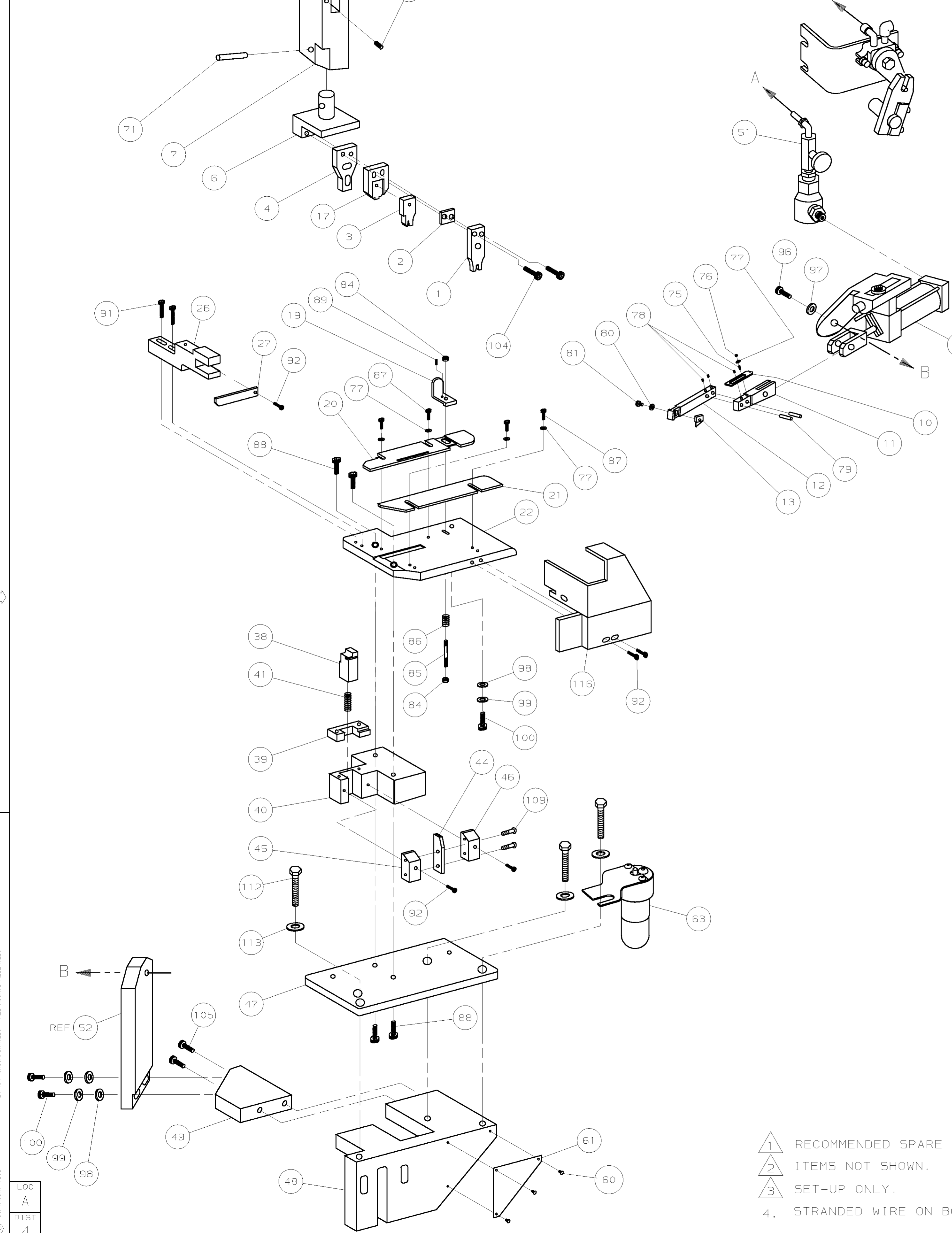

TERMINAL NAME:	
SPLICE	61300
TERM APPL SPEC	114-2088

CRIMPING DATA			
CRIMP HEIGHT	ROD DIA	WIRE SIZE	
.129	.091	18 STRANDED	
-	-	-	
-	-	-	
CRIMP WIRE	SIZE	TYPE	RANGE
INSUL	.180	F	10K-16K CMA
FEED	.230	0	.140-.185
.620	-	APPL INST	SET UP GAGE LAYOUT
WIRE STRIP LENGTH .275-.315			

1	-	-	453602-1	MOUNT, BRACKET 30°	122
1	-	A	2-21002-0	BHCS, 8-32 X .25	121
-	-	-	-	-	120
-	-	-	-	-	119
-	-	-	-	-	118
-	-	-	-	-	117
1	-	B	461028-2	GUARD	116
-	-	-	-	-	115
-	-	-	-	-	114
3	-	A	371178	BASE MOUNT WASHER	113
3	-	A	3-21015-1	SCR, HEX HD 3/8-16 X 1.00	112
-	-	-	-	-	111
-	-	-	-	-	110
2	-	A	2-21002-1	SCR, BHC 8-32 X .38	109
-	-	-	-	-	108
-	-	-	-	-	107
-	-	-	-	-	106
2	-	A	1-21001-0	SCR, SHC, 1/4-20 X 2.0	105
2	-	A	21001-7	SCR, SHC, 1/4-20 X 1.25	104
-	-	-	-	-	103
-	-	-	-	-	102
-	-	-	-	-	101
2	-	A	21001-5	SCR, SHC 1/4-20 X .88	100
2	-	A	21024-6	WASHER, LOCK #1/4	99
2	-	A	21055-8	WASHER, FLAT #1/4	98
-	-	-	-	-	97
-	-	-	-	-	96
-	-	-	-	-	95
-	-	-	-	-	94
-	-	-	-	-	93
3	-	A	2-21000-8	SCR, SHC 8-32 X .63	92
-	-	-	-	-	91
-	-	-	-	-	90
1	-	A	3-21008-0	SCR, SET SELF-LOC 6-32 X .32	89
5	-	A	21001-3	SCR, SHC 1/4-20 X .62	88
4	-	A	2-21000-7	SCR, SHC 8-32 X .50	87
1	-	A	373469	STOCK DRAG SPRING	86
1	-	B	370573	DRAG STUD	85
2	-	A	21021-4	NUT, HEX, SELF-LOC 10-32	84
-	-	-	-	-	83
-	-	-	-	-	82
1	-	A	2-21000-6	SCR, SHC 8-32 X .38	81
1	-	A	21024-4	WASHER, LOCK #8	80
2	-	A	1-21030-5	FEED FINGER PIN, DOWEL	79
3	-	A	3-21006-8	SCR, SET 8-32 X .12	78
5	-	A	21055-6	WASHER, FLAT #8	77
1	-	A	21018-6	NUT, JAM 8-32	76
1	-	A	4-21006-4	SCR, SET 8-32 X .50	75
-	-	-	-	-	74
-	-	-	-	-	73
1	-	A	2-21549-3	SCR, SET SELF-LOC 1/4-20 X .50	72
1	-	A	6-21029-9	PIN, SLOTTED SPR .312 X 1.50	71
-2	U/M	DWG SIZE	PART NO	DESCRIPTION	ITEM NO
-	-	-	-	REVISION OF EACH ASSY NO (WHEN BLANK, USE DWG REVISION)	-

-	-	-	-	-	70
-	-	-	-	-	69
-	-	-	-	-	68
-	-	-	-	-	67
-	-	-	-	-	66
-	-	-	-	-	65
-	-	-	-	-	64
1	-	C	465184-8	LUBRICATOR ASSY	63
-	-	-	-	-	62
1	-	B	452373-1	PLATE I.D.	61
3	-	A	21017-6	SCR, RH DRIVE	60
-	-	-	-	-	59
-	-	-	-	-	58
-	-	-	-	-	57
-	-	-	-	-	56
-	-	-	-	-	55
-	-	-	-	-	54
-	-	-	-	-	53
1	-	B	690021-1	AIR FEED CYLINDER SUB-ASSY	52
1	-	C	692655-5	AIR FEED VALVE SUB-ASSY	51
-	-	-	-	-	50
-	-	-	-	-	49
1	-	-	465319-2	EXTENSION, BASE 30°	48
1	-	C	570238	BASE MOUNT	47
1	-	B	465317-1	BASE PLATE	46
1	-	-	811839-3	AUX ANVIL HOLDER	45
1	-	B	811838-3	ANVIL HOLDER	44
1	-	C	692183-2	ANVIL	43
-	-	-	-	-	42
-	-	-	-	-	41
1	-	A	387083	SHEAR SPRING	40
1	-	B	565076-1	BASE BLOCK	39
1	-	B	811239-1	SHEAR, PLATE	38
1	-	B	465324-4	SHEAR, FLOATING	37
-	-	-	-	-	36
-	-	-	-	-	35
-	-	-	-	-	34
-	-	-	-	-	33
-	-	-	-	-	32
-	-	-	-	-	31
-	-	-	-	-	30
-	-	-	-	-	29
-	-	-	-	-	28
1	-	A	811266-2	STRIPPER	27
1	-	B	692875-1	MOUNT, STRIPPER	26
-	-	-	-	-	25
-	-	-	-	-	24
-	-	-	-	-	23
1	-	B	692187-1	STRIP GUIDE PLATE	22
1	-	B	465320-5	FRONT STRIP GUIDE	21
1	-	B	465350-5	REAR STRIP GUIDE	20
1	-	B	387650-4	DRAG, STOCK	19
-	-	-	-	-	18
1	-	-	465340-1	ADJ CRIMP MOUNT ASSY	17
-	-	-	-	-	16
-	-	-	-	-	15
-	-	-	-	-	14
1	-	A	811645-1	TIP, FEED FINGER	13
1	-	B	811644-1	FINGER, FEED	12
1	-	A	810131	ARM, FEED FINGER	11
1	-	A	374999	TENSION ADJUSTING PLATE	10
-	-	-	-	-	9
-	-	-	-	-	8
1	-	B	471167	RAM	7
1	-	B	465325-1	TOOL HOLDER	6
-	-	-	-	-	5
1	-	B	387265	SHEAR DEPRESSOR	4
1	-	-	2-472817-4	INSULATION CRIMPER 3	3
1	-	B	370692	SPACER	2
1	-	C	453910-1	WIRE CRIMPER	1
-2	U/M	DWG SIZE	PART NO	DESCRIPTION	ITEM NO
-	-	-	-	REVISION OF EACH ASSY NO (WHEN BLANK, USE DWG REVISION)	-

- 1 RECOMMENDED SPARE PARTS.
- 2 ITEMS NOT SHOWN.
- 3 SET-UP ONLY.
- 4. STRANDED WIRE ON BOTTOM.

THIS DRAWING IS UNCLASSIFIED AND IS NOT CONTROLLED DOCUMENTS. AMP INCORPORATED. THE NUMBERING CHANGE AND REVISIONS ARE THE PROPERTY OF AMP INCORPORATED. ORGANIZATION SHOULD BE CONTACTED FOR THE LATEST REVISION.