

THIS DRAWING IS UNPUBLISHED.  
 © COPYRIGHT BY TYCO ELECTRONICS CORPORATION. ALL RIGHTS RESERVED.

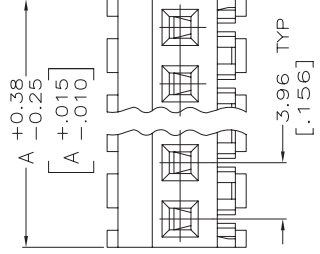
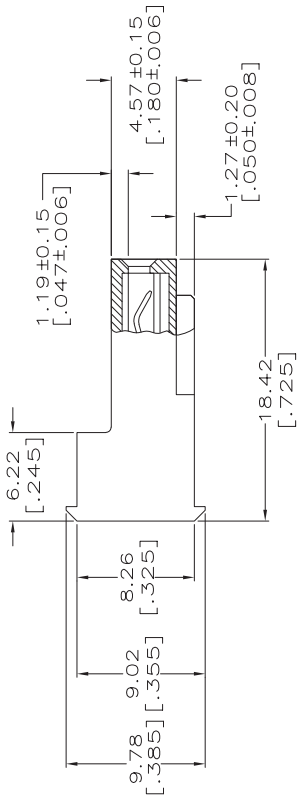
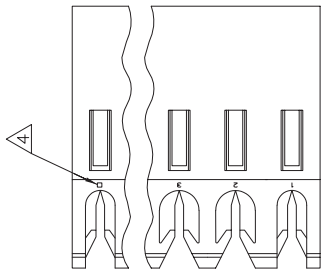

**MATERIAL:**  
 CONNECTOR - NYLON UL94V-2 (ORANGE).  
 CONTACTS - 0.30[.012] THICK COPPER ALLOY.  
 PLATING - 0.00038[.000015] GOLD IN CONTACT AREA.  
 0.00203[.000080] MIN THICKNESS BRIGHT TIN LEAD IN  
 SLOT AREA FOR 641173-2 THRU 2-641173-4 OR  
 MATTE WHISKER MITIGATED TIN IN SLOT AREA FOR  
 3-641173-2 THRU 5-641173-4 OVER NICKEL  
 UNDERPLATE.

2. CONTACTS ACCEPT 18 AWG WIRE WITH 2.41[.095] MAX INSULATION DIAMETER.
3. CONTACTS MUST ACCEPT 1.14±0.03[.045±.001] SQUARE POST AND REMAIN LOCKED IN POSITION.

IDENTIFICATION NUMBER FOR LAST CIRCUIT MAY NOT APPEAR ON ALL ASSEMBLIES.

DIMENSIONS IN BRACKETS ARE IN INCHES.

HOUSING FEATURES ARE: FEED-THRU WITHOUT LOCKING RAMP.

NOTE DELETED.

NOTE DELETED.

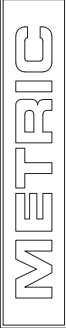

LOC CM O

DIST J

REVISONS ECO-07-012878

DATE	BY	APP'D
20JUN07	KW	DB

NO.	DESCRIPTION	DATE	BY	APP'D
24	5-641173-4	5-641173-4		
23	5-641173-3	5-641173-3		
22	5-641173-2	5-641173-2		
21	5-641173-1	5-641173-1		
20	5-641173-0	5-641173-0		
19	4-641173-9	4-641173-9		
18	4-641173-8	4-641173-8		
17	4-641173-7	4-641173-7		
16	4-641173-6	4-641173-6		
15	4-641173-5	4-641173-5		
14	4-641173-4	4-641173-4		
13	4-641173-3	4-641173-3		
12	4-641173-2	4-641173-2		
11	4-641173-1	4-641173-1		
10	4-641173-0	4-641173-0		
9	3-641173-9	3-641173-9		
8	3-641173-8	3-641173-8		
7	3-641173-7	3-641173-7		
6	3-641173-6	3-641173-6		
5	3-641173-5	3-641173-5		
4	3-641173-4	3-641173-4		
3	3-641173-3	3-641173-3		
2	3-641173-2	3-641173-2		
24	2-641173-4	2-641173-4		
23	2-641173-3	2-641173-3		
22	2-641173-2	2-641173-2		
21	2-641173-1	2-641173-1		
20	2-641173-0	2-641173-0		
19	1-641173-9	1-641173-9		
18	1-641173-8	1-641173-8		
17	1-641173-7	1-641173-7		
16	1-641173-6	1-641173-6		
15	1-641173-5	1-641173-5		
14	1-641173-4	1-641173-4		
13	1-641173-3	1-641173-3		
12	1-641173-2	1-641173-2		
11	1-641173-1	1-641173-1		
10	1-641173-0	1-641173-0		

NO.	DESCRIPTION	DATE	BY	APP'D
24	5-641173-4	5-641173-4		
23	5-641173-3	5-641173-3		
22	5-641173-2	5-641173-2		
21	5-641173-1	5-641173-1		
20	5-641173-0	5-641173-0		
19	4-641173-9	4-641173-9		
18	4-641173-8	4-641173-8		
17	4-641173-7	4-641173-7		
16	4-641173-6	4-641173-6		
15	4-641173-5	4-641173-5		
14	4-641173-4	4-641173-4		
13	4-641173-3	4-641173-3		
12	4-641173-2	4-641173-2		
11	4-641173-1	4-641173-1		
10	4-641173-0	4-641173-0		