

REVISIONS					
REV	ECO	DESCRIPTION	DATE	BY	APPR
A1	-	RELEASE NEW DWG FORMAT	-	-	-
A2	CNR	ADDED TOLERANCES	16FEB16	MRF	-
A3	-	MODIFIED DIMS TO METRIC	9/14/2021	RO	-
A4	-	UPDATED DESCRIPTION WITH CORRECT WIRE SIZE AND PART COLOR.	12/22/2021	RO	RO

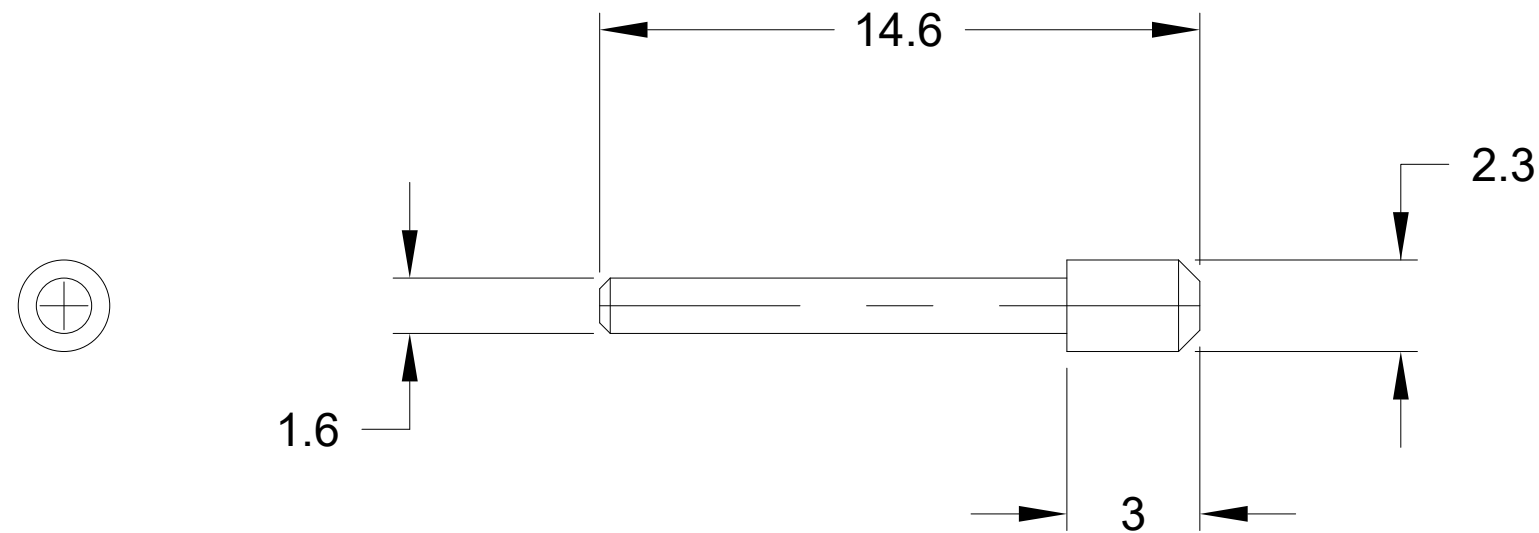

NOTES: UNLESS OTHERWISE SPECIFIED

- MATERIAL: THERMOPLASTIC; RoHS COMPLIANT
- COLOR: WHITE
- END CAP SIZES: 16 (1.6mm) & 20 (1.0mm)
- DIMENSIONS ARE IN METRIC
- ALL DIMENSIONS ARE FOR REFERENCE USE ONLY.

QUANTITY	PART NUMBER	DESCRIPTION	ITEM
<b>MATERIALS LIST</b>			
<p>UNLESS OTHERWISE SPECIFIED</p> <p>1) All dimensions are in metric(mm).</p> <p>2) Tolerances are as follows:</p> <p>1 PL DEC ±0.30     Fractions ±1/64</p> <p>2 PL DEC ±0.15     Angles ±1°</p> <p>3 PL DEC ±0.08</p> <p>3) Note reference = </p>		<p><b>SIGNATURES</b></p> <p>DRAWN: MRF</p> <p>CHECKED:</p> <p>ENGINEER:</p> <p>APPROVAL:</p> <p>CUSTOMER:</p>	<p><b>DATE</b></p> <p>29JAN16</p>
<p>MATERIAL SPECIFICATIONS:</p>		<p><b>Amphenol</b></p> <p>Sine Systems - www.amphenol-sine.com</p> <p>44724 Morley Drive</p> <p>Clinton Township, MI 48036</p>	
<p>PROCESS SPECIFICATIONS:</p>		<p>SEALING PLUG, WHITE, SIZE 20 (1.0MM)</p> <p>SIZE 16 (1.6MM)</p>	
<p>NEXT ASS'Y:</p>		<p>THIS DRAWING IS SUPPLIED FOR INFORMATION ONLY. DESIGN FEATURES, SPECIFICATIONS AND PERFORMANCE DATA SHOWN HEREON ARE THE PROPERTY OF THE AMPHENOL CORPORATION. NO RIGHTS OF REPRODUCTION ARE IMPLIED. ALL DIMENSIONS ARE SUBJECT TO NORMAL MANUFACTURING VARIATIONS.</p>	<p>SIZE: <b>A</b>    TYPE: <b>C-</b>    DWG NO: <b>CA-4020-59</b>    REVISION: <b>A4</b></p>
		<p>SCALE: <b>NONE</b></p>	<p><b>C-CA-4020-59</b>    SHEET <b>1</b> OF <b>1</b></p>