

THIS DRAWING IS UNPUBLISHED. RELEASED FOR PUBLICATION
 © COPYRIGHT BY TYCO ELECTRONICS CORPORATION. ALL RIGHTS RESERVED.

| COMPONENT | MATERIAL | FINISH |
|---------------------------|--|----------------------------|
| HOUSING | STAINLESS STEEL PER ASTM-A-484 OR ASTM-A-582 TYPE 303 | NICKEL PLATED PER QQ-N-290 |
| DIELECTRIC | PTFE FLUOROCARBON PER ASTM-D-484 | - |
| CENTER CONTACT | BERYLLIUM COPPER PER ASTM-B-196 OR 197 ALLOY C17300, CONDITION H | GOLD PLATED PER ASTM-B-488 |
| BUSHING CONTACT EXTENSION | IRON-NICKEL-COBALT ALLOY PER MIL-I-23011 CLASS 1 (KOVAR) | GOLD PLATED PER ASTM-B-488 |
| HERMETIC SEAL | GLASS BEAD | - |
| BUSHING | SOFT COPPER ALLOY 110 | GOLD PLATED PER ASTM-B-488 |

| ENVIRONMENTAL | |
|----------------------|---|
| TEMPERATURE RATING: | -65°C TO +125°C |
| VIBRATION: | MIL-STD-202, METHOD 204, CONDITION D |
| SHOCK: | MIL-STD-202, METHOD 213, CONDITION 1 |
| MOISTURE RESISTANCE: | MIL-STD-202, METHOD 106 |
| CORROSION: | MIL-STD-202, METHOD 101, CONDITION B. 5% SALT SPRAY |
| THERMAL SHOCK: | MIL-STD-202, METHOD 107, CONDITION B |

| MECHANICAL | |
|--|--|
| INTERFACE DIMENSIONS: | MIL-STD-348A FIG. 310.2 |
| RECOMMENDED MATING TORQUE: | N/A |
| FORCE TO ENGAGE & DISENGAGE (IN-LBS MAX.): | 2.0 |
| WEIGHT (GRAMS): | TBD |
| MATING CHARACTERISTICS: | INSERTION (MAX LBS): 3.0 WITHDRAWAL (MIN OZ): 1.0 |
| CABLE RETENTION: | AXIAL FORCE (LBS): N/A TORQUE (IN-OZ): N/A |
| CENTER CONTACT CAPTIVATION: | AXIAL (LBS): 6.0 MIN RADIAL (IN-OZ): - |

| ELECTRICAL | |
|--|---|
| NORMAL IMPEDANCE (OHMS): | 50 |
| FREQUENCY RANGE (GHz): | DC TO 18.0 |
| VOLT RATING @ SEA LEVEL (VRMS MAX): | 335 |
| VSWR: | 1.04+.009f(GHz) |
| INSERTION LOSS: (dB MAX): | .05 √f(GHz) |
| RF LEAKAGE (dB MIN): | -[100-f(GHz)] |
| CORONA 70,000 FT (VRMS MIN): | 190 |
| DIELECTRIC WITHSTANDING VOLTAGE (VRMS MIN) AT SEA LEVEL: | 1,000 |
| I.R. (MEGOHMS MIN): | 5,000 |
| RF HIGH POTENTIAL AT SEA LEVEL (VRMS MIN @ 5 MHz): | 670 |
| CONTACT RESISTANCE (MILLIOHMS MAX): | CENTER CONTACT: 12.0 OUTER CONTACT: 2.0 CABLE TO HOUSING: N/A |

| LOC | DIST | REVISIONS | | | |
|-----|------|-------------|------|-----|------|
| P | LTR | DESCRIPTION | DATE | DWN | APVD |
| DF | X0 | RELEASED | 4-03 | CT | RG |

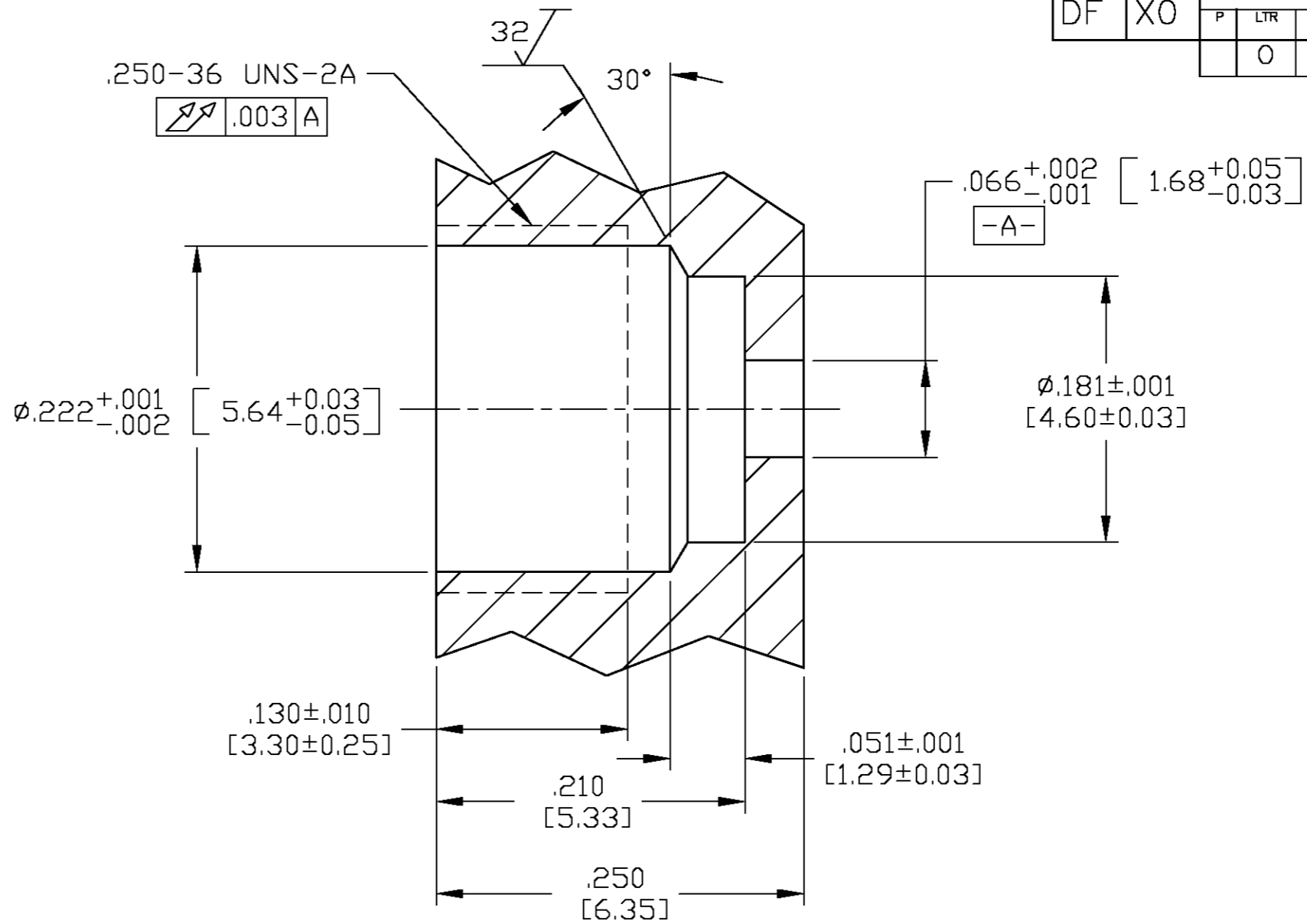

RECOMMENDED MOUNTING HOLE

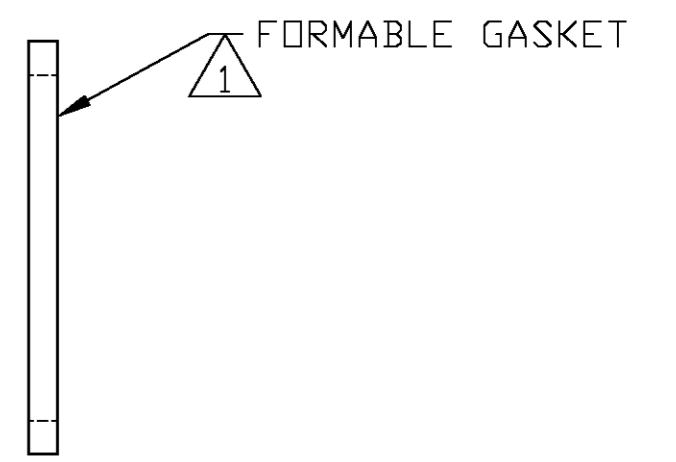
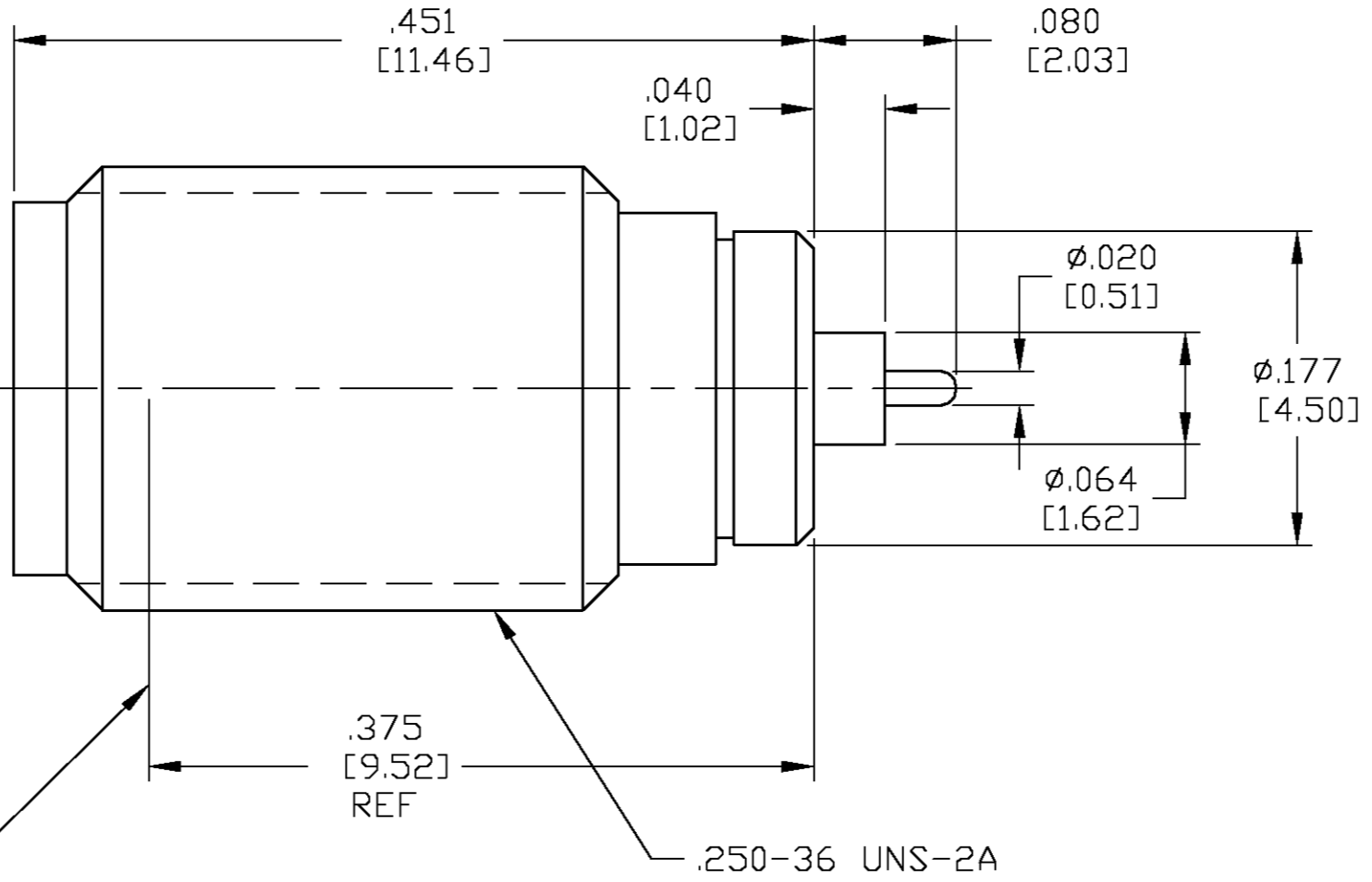

$\triangle 1$ ITEM #1 NOT ASSEMBLED, SHIPPED WITH CONNECTOR.

| | | | | |
|---|--|------------------------------|--|--------------------|
| THIS DRAWING IS A CONTROLLED DOCUMENT. | | DWN C.C.THOMAS 09APR03 | Tyco Electronics Corporation Harrisburg, PA 17105 | |
| DIMENSIONS: INCHES [mm] | | CHK R.GROSS 4-10-03 | NAME OSM ENVIRONMENTALLY DURABLE SPARK PLUG, HERMETICALLY SEALED | |
| TOLERANCES UNLESS OTHERWISE SPECIFIED: 0 PLC ± - 1 PLC ± - 2 PLC ± - 3 PLC ± .005 [0.13] 4 PLC ± - 1° ANGLES ± 1° | | APVD R.GROSS 4-10-03 | APPLICATION SPEC 408-04859 | |
| MATERIAL SEE TABLE | | FINISH SEE TABLE | WEIGHT - | RESTRICTED TO - |
| CUSTOMER DRAWING | | SCALE 10:1 | SHEET 1 OF 1 | REV 0 |

1663386-1
PART NO.