

PRODUCT NUMBER
10127400-02H1410LF

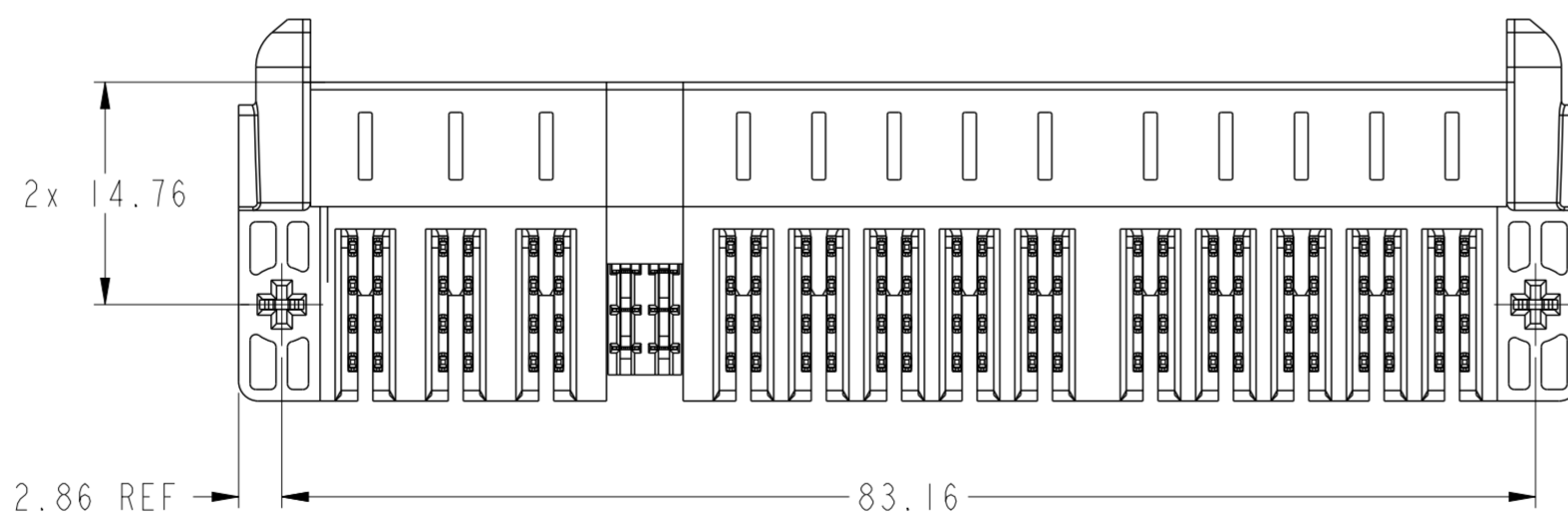
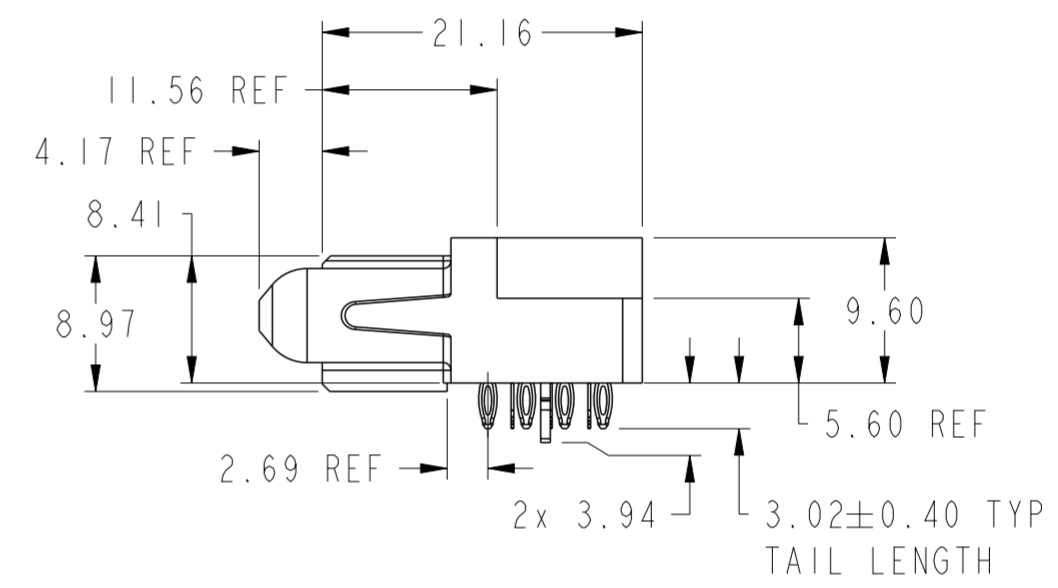
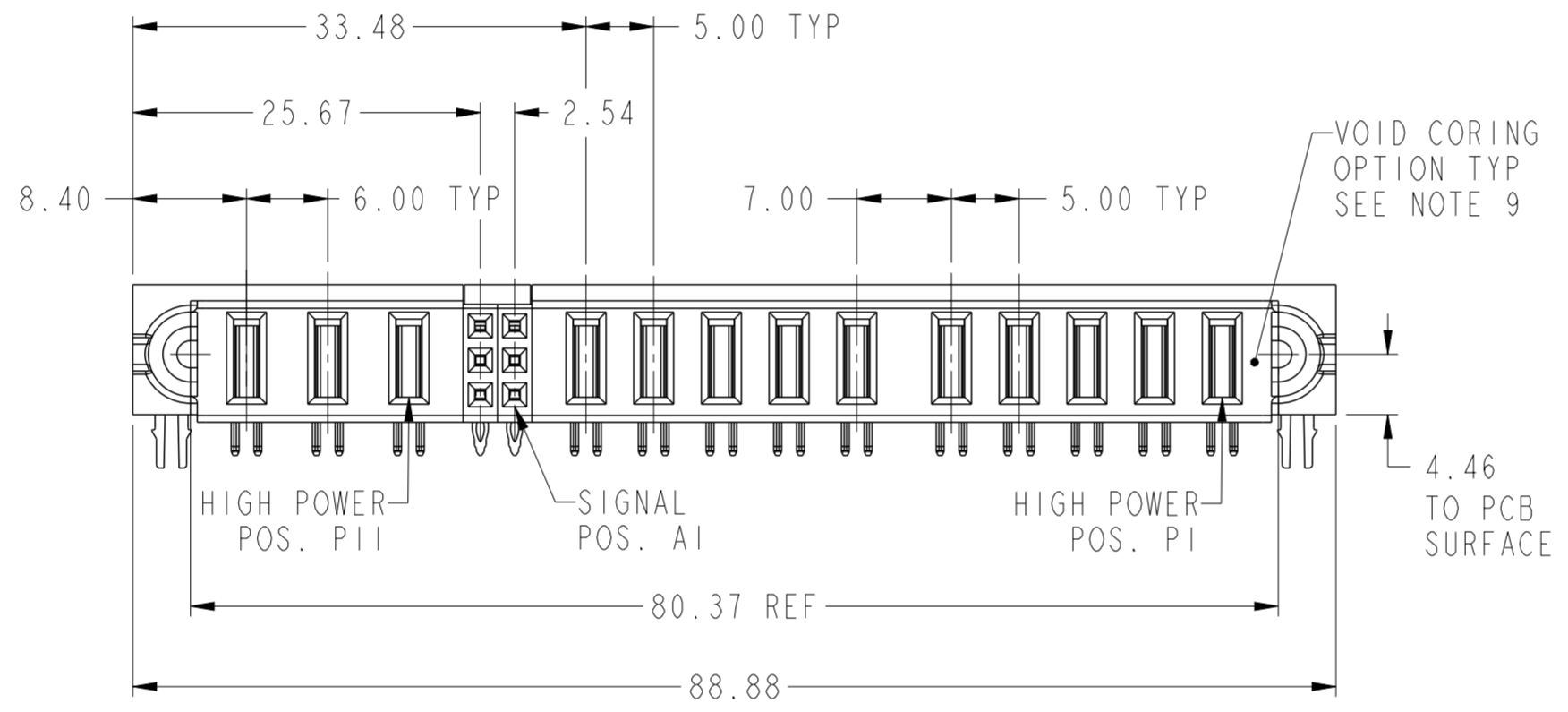
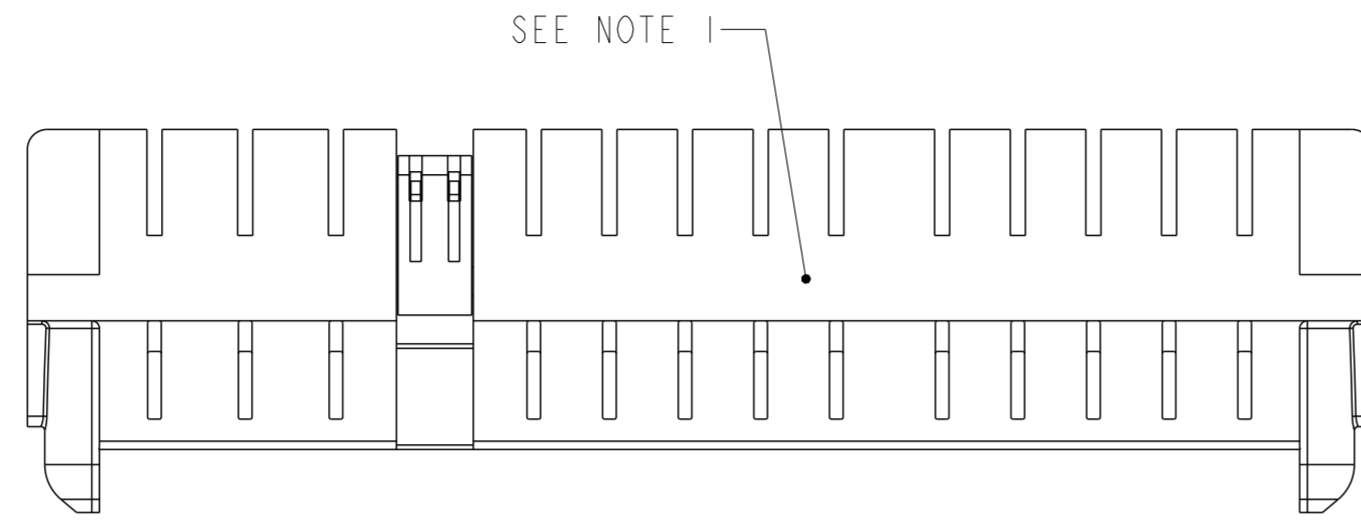

| | | | | | | | | | | | | | | | | | | | | | |
|---------------------------------------|---|--------|-------------|------------|------------|----|----------------|----------------|-----------|-----|----------|--------|---------|----|-----|------|----------------|------------|-------------|----------|---|
| spec ref | - | dr | Kaka Zhang | 2015/05/28 | projection | MM | size | A2 | scale | 2:1 | | | | | | | | | | | |
| tolerance std | ASME Y14.5 | eng | De-Ming Lu | 2015/12/29 | | | ecn no | - | rel level | | Released | | | | | | | | | | |
| TOLERANCES UNLESS OTHERWISE SPECIFIED | | chr | Fancy Zhang | 2015/12/29 | | | product family | PwrBlade ULTRA | | | rev | A | | | | | | | | | |
| surface | <table border="1"> <tr> <td>linear</td> <td>0.X</td> <td>±0.50</td> </tr> <tr> <td></td> <td>0.XX</td> <td>±0.25</td> </tr> <tr> <td></td> <td>0.XXX</td> <td>±0.130</td> </tr> <tr> <td>angular</td> <td>0°</td> <td>±2°</td> </tr> </table> | linear | 0.X | ±0.50 | | | | 0.XX | ±0.25 | | 0.XXX | ±0.130 | angular | 0° | ±2° | appr | Pei-Ming Zheng | 2015/12/29 | www.fci.com | cat. no. | - |
| linear | 0.X | ±0.50 | | | | | | | | | | | | | | | | | | | |
| | 0.XX | ±0.25 | | | | | | | | | | | | | | | | | | | |
| | 0.XXX | ±0.130 | | | | | | | | | | | | | | | | | | | |
| angular | 0° | ±2° | | | | | | | | | | | | | | | | | | | |

PDS: Rev :A

STATUS:Released

Printed: Dec 30, 2015

Copyright FCI. FCI

PRODUCT NO.

ROWS

HIGH POWER

SIGNAL

HIGH POWER

| CODE | DESCRIPTION |
|------|---------------------|
| RA | RIGHT POWER CONTACT |
| LA | LEFT POWER CONTACT |
| N | SIGNAL CONTACT |
| P | SIGNAL CONTACT |
| R | SIGNAL CONTACT |
| HA | HOLD DOWN |

10127400-02H1410LF

C
B
A

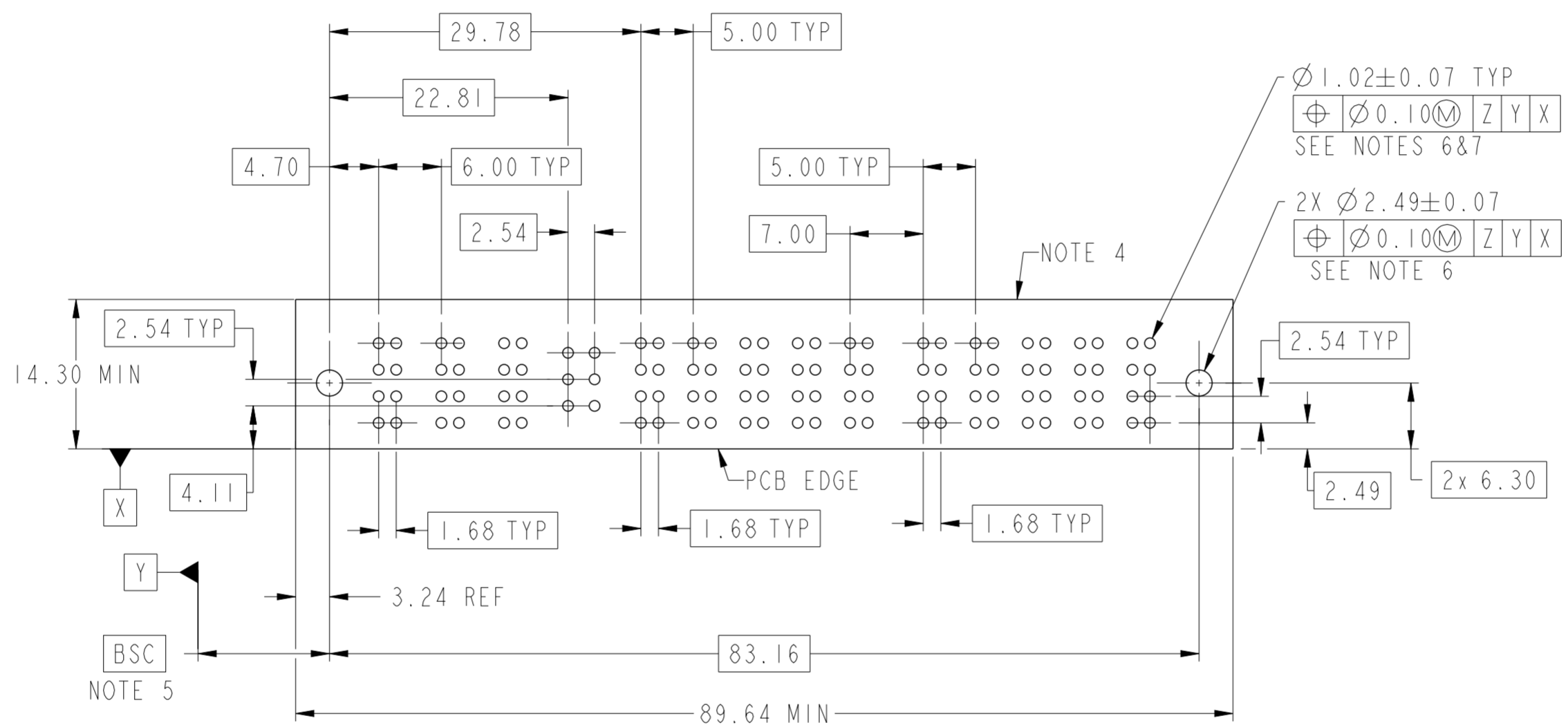
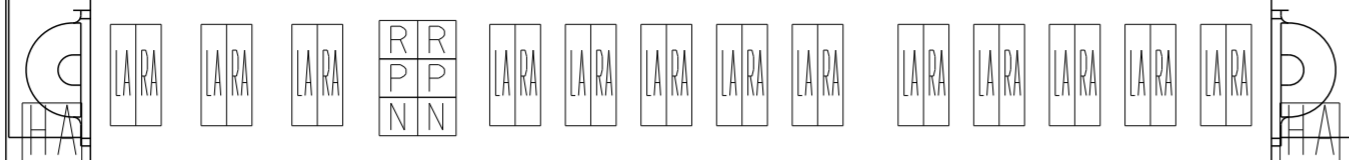

Copyright FCI.

| | | | | | | | | | | |
|---------------------------------------|------------|---------|----------------|---------------|------------|----|----------------|----------------|--------------|------------------|
| spec ref | - | dr | Kaka Zhang | 2015/05/28 | projection | MM | size | A2 | scale | 2:1 |
| tolerance std | ASME Y14.5 | eng | De-Ming Lu | 2015/12/29 | | | ecn no | - | rel level | Released |
| TOLERANCES UNLESS OTHERWISE SPECIFIED | | chr | Fancy Zhang | 2015/12/29 | | | | | | |
| | | appr | Pei-Ming Zheng | 2015/12/29 | | | | | | |
| surface | ASME Y14.5 | linear | 0.X | ± 0.50 | | | product family | PwrBlade ULTRA | div no | 10127400-02H1410 |
| | | | 0.XX | ± 0.25 | | | product | Customer Drw | rev | A |
| | | angular | 0° | $\pm 2^\circ$ | | | cat. no. | - | sheet 2 of 3 | |

PDS: Rev :A

STATUS:Released

Printed: Dec 30, 2015

PRODUCT NUMBER

10127400-02HI410LF

NOTES:

- 1. "FCI", PART NUMBER AND DATE CODE TO BE MARKED ON THIS SURFACE.
THE P/N CAN BE OMITTED IF THERE IS NOT ENOUGH SPACE ON THIS SURFACE.
- 2. MATERIALS:
HOUSING: GLASS FILLED WITH HIGH TEMP POLYAMIDE, UL94V-0.
POWER CONTACTS: COPPER ALLOY.
SIGNAL CONTACTS: COPPER ALLOY.
HOLD DOWN: COPPER ALLOY.
- 3. PLATING SPECIFICATION: FCI 10135186.
- 4. DENOTES CONNECTOR KEEP OUT ZONE.
- 5. DATUM AND BASIC DIMENSION ARE ESTABLISHED BY CUSTOMER.
- 6. ALL HOLE DIAMETERS ARE FINISHED HOLE SIZES.
- 7. 1.150±0.025mm DRILLED HOLE PLATED WITH 7.62µm MIN Sn OVER
25.4µm-76.2µm Cu PLATING TO ACHIEVE A 1.02±0.07mm FINISHED HOLE.
- 8. PRODUCT SPECIFICATION: FCI GS-12-1176.
APPLICATION SPECIFICATION: FCI GS-20-0389.
PRODUCT PACKAGE SPECIFICATION: FCI GS-14-2354.
- 9. THE VOID CORING BETWEEN POWER MODULES, SIGNAL MODULES AND END MODULES ARE
OPTIONAL AND THE SHAPE MAY BE DIFFERENT TO OPTIMIZE THE MOLDING
PROCESS. THE VOID CORING WILL NOT EFFECT THE PRODUCT FUNCTION.



Copyright FCI.

| | | | | | | | | | | |
|---------------|---------------------------------------|----------------|----------------|------------|--------------------------------|------------------------|--------|--------------|------------------|------------------------|
| spec ref | - | dr | Kaka Zhang | 2015/05/28 | projection | MM | size | A2 | scale | 2:1 |
| tolerance std | - | eng | De-Ming Lu | 2015/12/29 | | | ecn no | - | rel level | Released |
| ASME Y14.5 | TOLERANCES UNLESS OTHERWISE SPECIFIED | chr | Fancy Zhang | 2015/12/29 | | | | | | |
| | | appr | Pei-Ming Zheng | 2015/12/29 | | | | | | |
| surface | ✓ | product family | PwrBlade ULTRA | | title | 10HP+6S+3HP, PRESS-FIT | | dwg no | 10127400-02HI410 | |
| ASME Y14.5 | linear | www.fci.com | cat. no. | | R/A RECEPTACLE, PwrBlade ULTRA | | rev | A | | Product - Customer Drw |
| | angular | | | | | | | sheet 3 of 3 | | |

PDS: Rev :A

STATUS:Released

Printed: Dec 30, 2015