

4

3

2

1

PROPRIETARY NOTICE: THE INFORMATION CONTAINED IN THIS DOCUMENT IS PROPRIETARY TO AMPHENOL AND SHALL NOT BE DISCLOSED IN WHOLE OR IN PART IN ANY FORM OR FOR ANY REASON EXCEPT AS EXPRESSLY STATED IN WRITING BY AMPHENOL.

NOTES:

1. CONTINUOUS OPERATING TEMPERATURE -40 TO 150 DEGREES CELCIUS.
2. CONNECTOR: METRI-PACK 150.2 OR GT150 3.5mm (MATING APTIV(DELPHI) PART NUMBER: 12162193,15336004 OR EQUIVILANT)
3. VOLTAGE: 5V

| TEMP (°C) | RESISTANCE (OHMS) | RES TOL (+%) | RES TOL (-%) |
|-----------|-------------------|--------------|--------------|
| -40 | 101770 | 5.74 | 9.27 |
| 25 | 2820 | 5.15 | 4.86 |
| 50 | 988.1 | NOMINAL | |
| 100 | 179.6 | 2.82 | 2.51 |
| 125 | 89.11 | 2.96 | 3.46 |

| REVISIONS | | | | |
|-----------|--|----------|-----|------|
| REV | REVISION HISTORY | DATE | DWN | APVD |
| A | INITIAL DRAFT | 11/21/17 | DAM | |
| B | UPDATED TOL'S & RES-TABLE, REVISED NOTES & ULTEM ADDED TERMINAL O-RING & CIRCUIT NOTES | 1/29/19 | MED | STS |
| C | UPDATED NOTES & RES TBL. ULTEM 2300-BLACK WAS ULTEM 2300. 59.4 +/- 1.0 WAS 59.35 +/- 1.0, 25.3 +/- .5 WAS 25.25 +/- .5 | 5/31/19 | MED | STS |

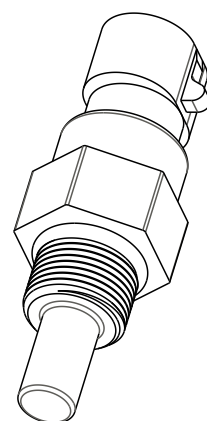
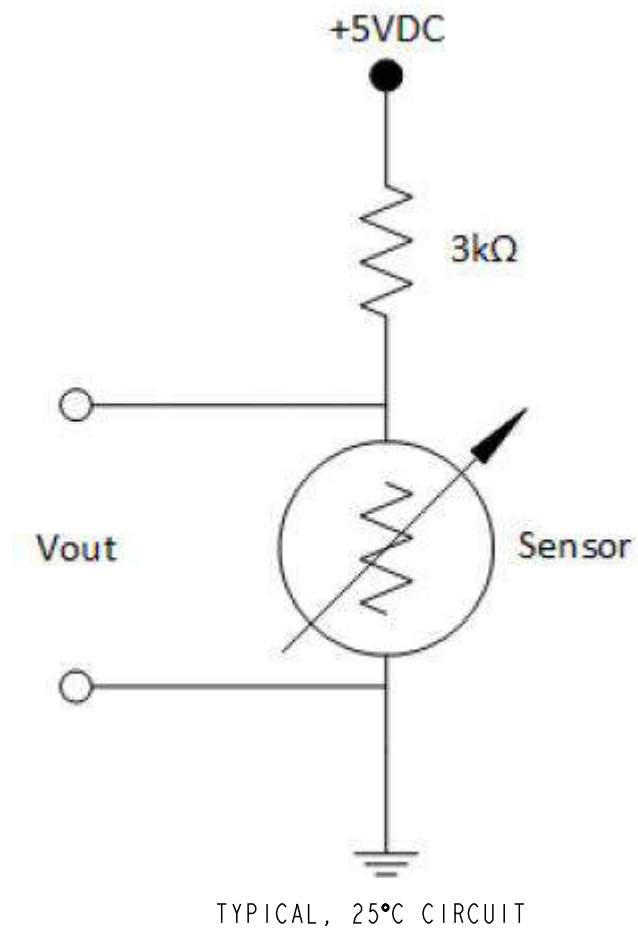
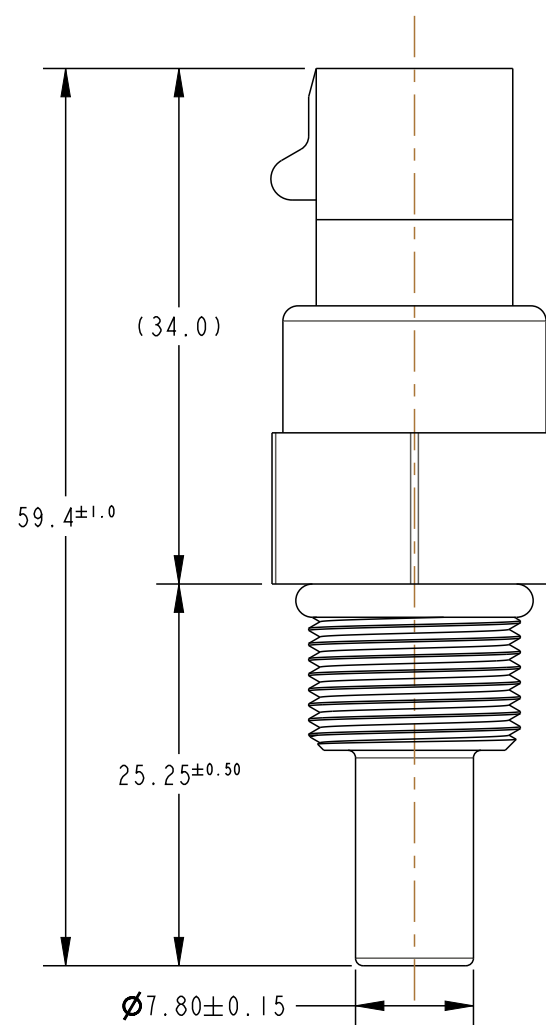
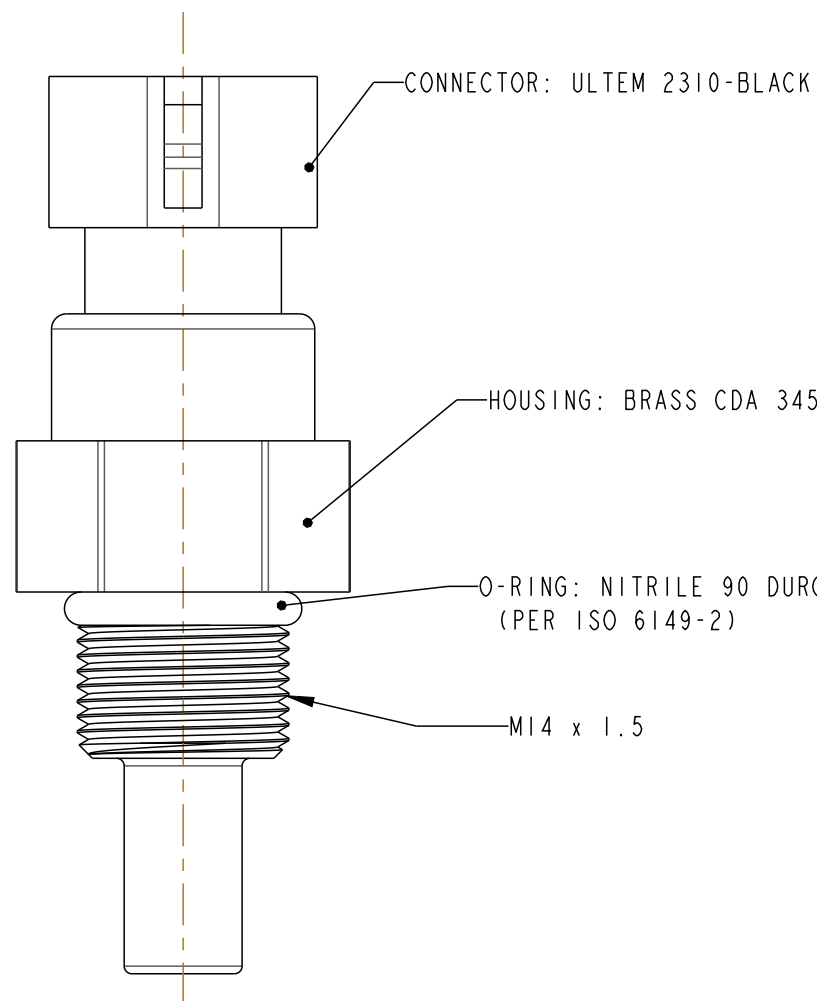
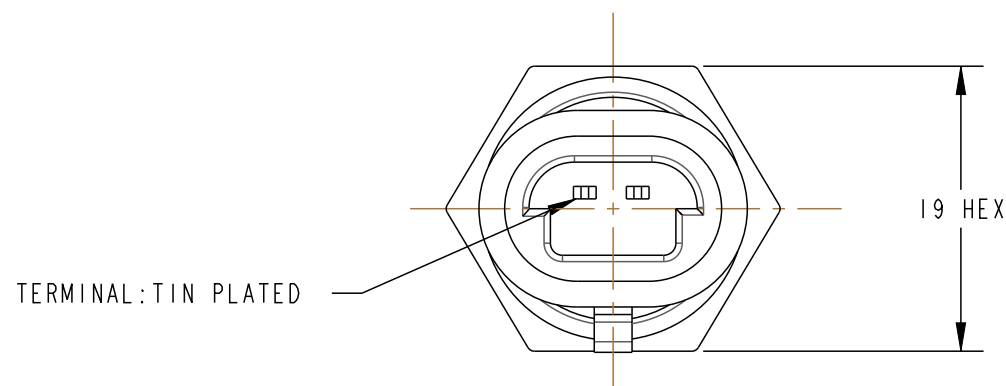

SCALE 1:1

| | | | |
|---|-----------------|---------------------|------------|
| Amphenol | | St. Marys, PA 15857 | |
| Advanced Sensors | | | |
| TITLE: FLUID TEMPERATURE SENSOR | | | |
| UNLESS OTHERWISE SPECIFIED DIMENSIONS ARE IN MM TOLERANCES ARE: | | APPROVALS | DATE |
| .X ± 0.5 | ANGLES ± 2° | DRAWN DAM | 11/21/2017 |
| .XX ± 0.25 | | CHECKED STS | 11/21/2017 |
| DO NOT SCALE DRAWING | | ENGR STS | 11/21/2017 |
| THIRD ANGLE PROJECTION | | OC | |
| INTERPRET DRAWING IAW ASME Y14.5 | | MFG | |
| MATERIAL SEE DRAWING | | | |
| SIZE B | DWG NO. GE-1022 | | REV C |
| SCALE 2:1 | | SHEET 1 OF 1 | |

LEGAL NOTICE - THIS DRAWING AND ANY INTELLECTUAL PROPERTY RIGHTS THERE IN ARE PROPERTY OF AMPHENOL AND NO LICENSES ARE GRANTED UNDER THOSE RIGHTS.

4

3

2

1