

10 9 8 7 6 5 4 3 2 1

ASSEMBLY #	CONTACT PLATING
74029-6000	SEE NOTE 2.
74029-6050	SEE NOTE 3.

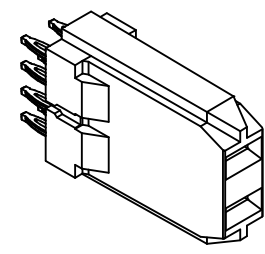
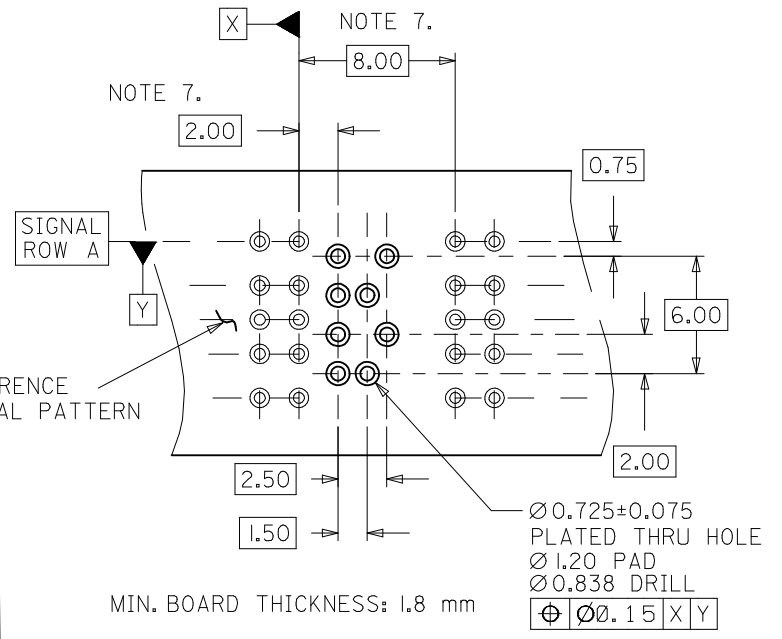
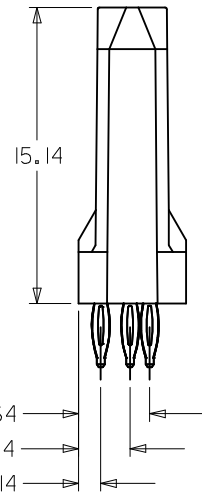
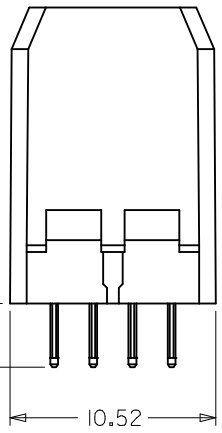
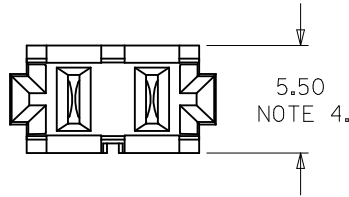
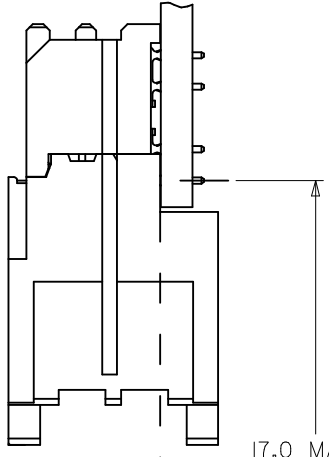

12.44 MAX.
NOTE 5.
REF.

THE PRIMARY CARTON WITH A LABEL STATING "ELV AND RoHS COMPLIANT" IS LEAD FREE. CARTONS WITHOUT THIS LABEL MAY CONTAIN LEAD.

- NOTES:**
1. MATERIALS: HOUSING - GLASS FILLED LIQUID CRYSTAL POLYMER, UL 94V-0, BLACK; TERMINAL - COPPER ALLOY.
 2. FINISH: SELECT GOLD IN CONTACT AREA, 30 microINCH THICK; MATTE TIN IN COMPLIANT AREA.
 3. FINISH: SELECT GOLD IN CONTACT AREA, 50 microINCH THICK; MATTE TIN IN COMPLIANT AREA.
 4. USE 6.0 mm NOMINAL FOR BACKPLANE LAYOUT.
 5. DIMENSION IS MEASURED FROM BOTTOM OF HOUSING.
 6. PACKED PER PK-70873-0876.
 7. THIS DIMENSION TO BE MULTIPLE OF 2.00 mm AS REQUIRED.

LEAD FREE CONVERSION EC NO: B DRAWN BY: RWHIPPLE CHKD: MWOLFE APPR: SMILLER	DESCRIPTION 2012/12/07 2012/12/07 2012/12/17	QUALITY SYMBOLS F=0 F=0 F=0	GENERAL TOLERANCES (UNLESS SPECIFIED)		DIMENSION STYLE MM ONLY		SCALE 4:1	DESIGN UNITS INCH	THIRD ANGLE PROJECTION	
			mm	INCH	DRAWN BY RWHIPPLE	DATE 2012/12/07	TITLE HSD POWER 5 ROW BACKPLANE SALES ASSEMBLY molex DOCUMENT NO. SD-74029-006 SHEET NO. 1 OF 1			
			4 PLACES ± --- ± ---	3 PLACES ± --- ± ---	CHECKED BY MWOLFE	DATE 2012/12/10				
			2 PLACES ± --- ± ---	1 PLACE ± --- ± ---	APPROVED BY SMILLER	DATE 2012/12/17				
0 PLACE ± --- ± ---	MATERIAL NO.		SEE CHART							
ANGULAR ±1/2° DRAFT WHERE APPLICABLE MUST REMAIN WITHIN DIMENSIONS			SIZE B		THIS DRAWING CONTAINS INFORMATION THAT IS PROPRIETARY TO MOLEX INCORPORATED AND SHOULD NOT BE USED WITHOUT WRITTEN PERMISSION					

9 8 7 6 5 4 3 2 1

10 9 8 7 6 5 4 3 2 1

NOTES:

1. MATERIALS:

HOUSING - LIQUID CRYSTAL POLYMER (LCP),
UL94 V-0, COLOR: BLACK.

TERMINAL - COPPER ALLOY

2. FINISH: SELECTIVE GOLD ON MATING SURFACE,
MATTE TIN ON TAILS; NICKEL UNDERPLATE.

3. THIS PART CONFORMS TO PRODUCT SPECIFICATION
PS-74031-999.

4. SINGLE ROW ASSEMBLY PACKAGED PER PK-70873-0876.

5. MATES WITH 74026 SERIES DAUGHTERCARD POWER ASSEMBLY.

6. MATING INTERFACE MEASURED FROM BOTTOM OF HOUSING.

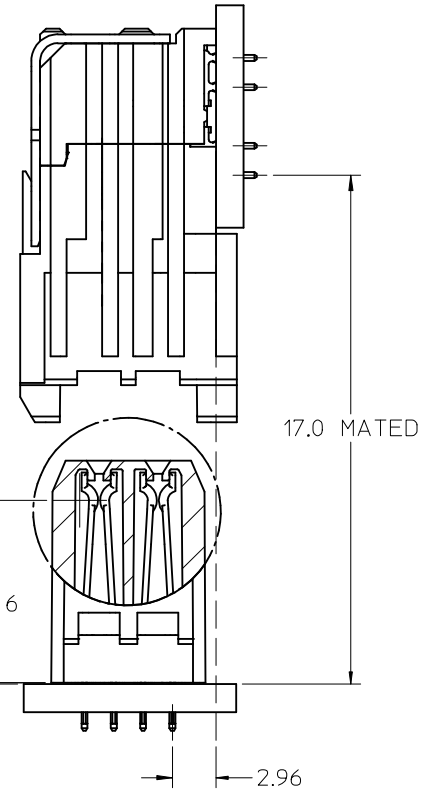
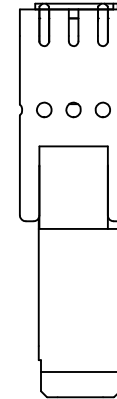
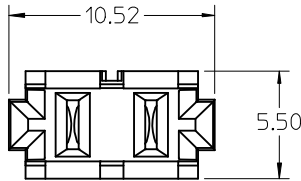

LEAD-FREE
PLATING

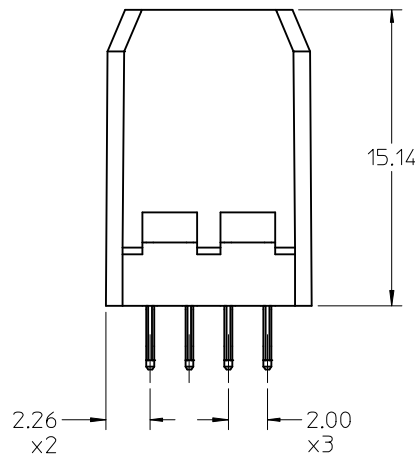
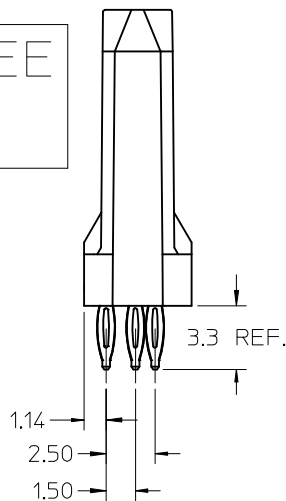

MOLEX P/N	GOLD THICKNESS (MINIMUM)	TAIL PLATING
74029-6000	30 MICROINCHES	MATTE TIN
74029-6050	50 MICROINCHES	

ADD LEADED P/N	DESCRIPTION
EC NO: UCP2013-0146	
DRW:SVANG01	2012/07/12
CHKD:WOLFE	2012/07/12
APPR:SMILLER	2012/08/06

QUALITY SYMBOLS
$\nabla = 0$
$\nabla = 0$
$\nabla = 0$

GENERAL TOLERANCES (UNLESS SPECIFIED)	
mm	INCH
4 PLACES ± ---	± ---
3 PLACES ± ---	± ---
2 PLACES ± 0.25	± ---
1 PLACE ± 0.38	± ---
0 PLACE ±	±
ANGULAR ± 1/2°	
DRAFT WHERE APPLICABLE MUST REMAIN WITHIN DIMENSIONS	

DIMENSION STYLE	
MM ONLY	
DRAWN BY	DATE
ELO	2003/07/14
CHECKED BY	DATE
STANFORD	2003/07/17
APPROVED BY	DATE
BIXLER	2003/07/21
MATERIAL NO.	
SEE TABLE	

SCALE	DESIGN UNITS	THIRD ANGLE PROJECTION
4:1	METRIC	
TITLE		
VHDM/HSD POWER 6 ROW BACKPLANE SALES DRAWING		
molex		
DOCUMENT NO.	SHEET NO.	
SD-74029-011	1 OF 3	

9 8 7 6 5 4 3 2 1

NOTES:

1. THIS DESIGN INTENDED AS OPTION TO HAVING TWO SINGLE ROW MODULES NEXT TO EACH OTHER.
2. FINISH: SELECTIVE GOLD ON MATING SURFACE; TIN/LEAD OR MATTE TIN ON TAILS; NICKEL UNDERPLATE.
3. DUAL ROW ASSEMBLIES PACKED PER PK-70873-545.

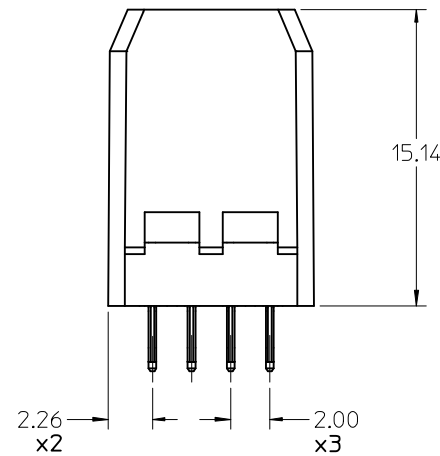
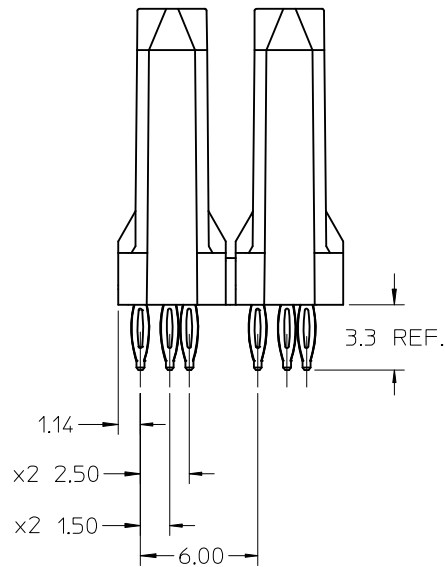
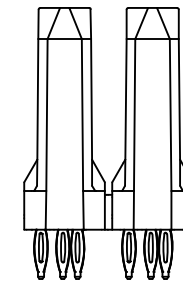
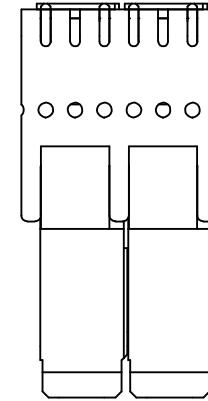
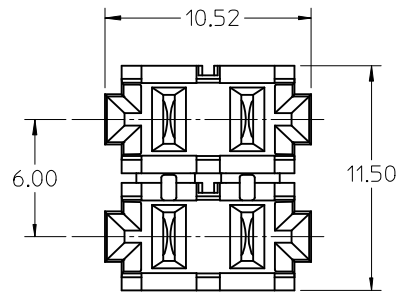

DUAL ROW ASSEMBLY

MOLEX P/N	GOLD THICKNESS (MINIMUM)	TAIL PLATING
74029-6002	30 MICROINCHES	MATTE TIN
74029-6052	50 MICROINCHES	
74029-6902	30 MICROINCHES	TIN/LEAD
74029-6952	50 MICROINCHES	

SEE SHEET 1 EC NO: UCP2013-0146 DRWN:SVANG01 2012/07/12 CHKD:MWOLF 2012/07/12 APPR:SMILLER 2012/08/06	QUALITY SYMBOLS	GENERAL TOLERANCES (UNLESS SPECIFIED)	DIMENSION STYLE	SCALE	DESIGN UNITS	THIRD ANGLE PROJECTION	
	▽=0	4 PLACES ± --- ± ---	MM ONLY	4:1	METRIC	⊙ □	
	▽=0	3 PLACES ± --- ± ---	mm INCH	DRAWN BY DATE	TITLE VHDM/HSD POWER 6 ROW BACKPLANE SALES DRAWING molex		
	▽=0	2 PLACES ± 0.25 ± ---	ELO 2003/07/14	CHECKED BY DATE			
REV	DESCRIPTION	1 PLACE ± 0.38 ± ---	APPROVED BY DATE	DOCUMENT NO. SD-74029-011 SHEET NO. 2 OF 3			
		0 PLACE ± ±	BIXLER 2003/07/21				
		ANGULAR ± 1/2°	MATERIAL NO.				
		DRAFT WHERE APPLICABLE MUST REMAIN WITHIN DIMENSIONS	SEE TABLE				
			SIZE B	THIS DRAWING CONTAINS INFORMATION THAT IS PROPRIETARY TO MOLEX INCORPORATED AND SHOULD NOT BE USED WITHOUT WRITTEN PERMISSION			

BOARD LAYOUTS: 1.8 mm MIN. BOARD THICKNESS

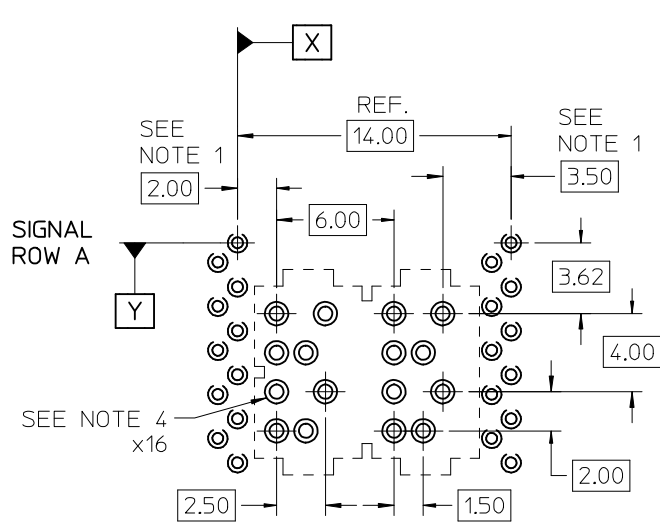

VHDM DUAL ROW POWER

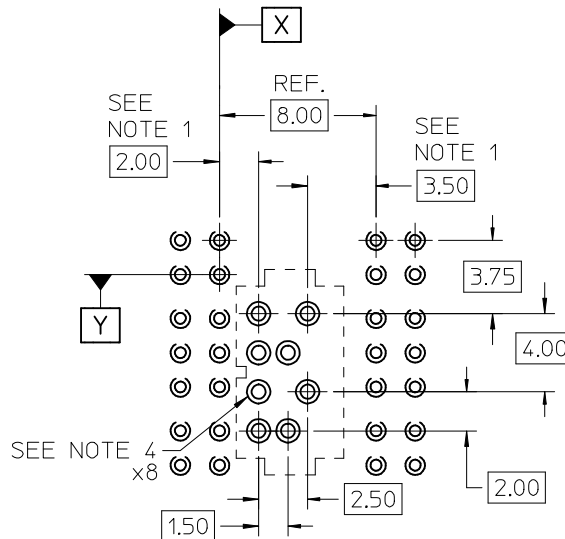

VHDM-HSD SINGLE ROW POWER

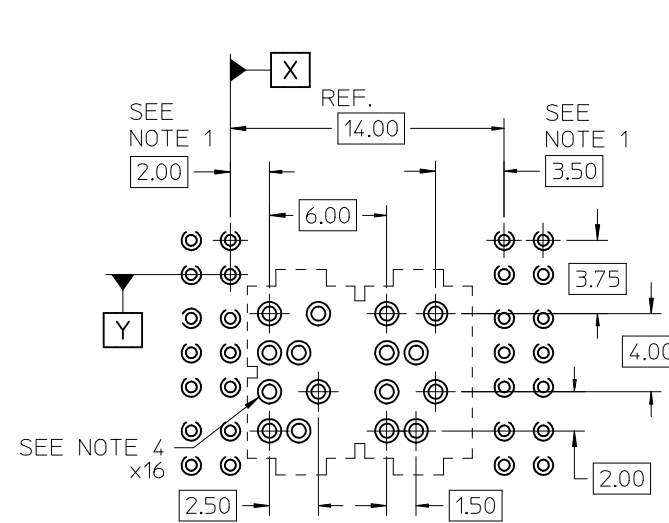

VHDM-HSD DUAL ROW POWER

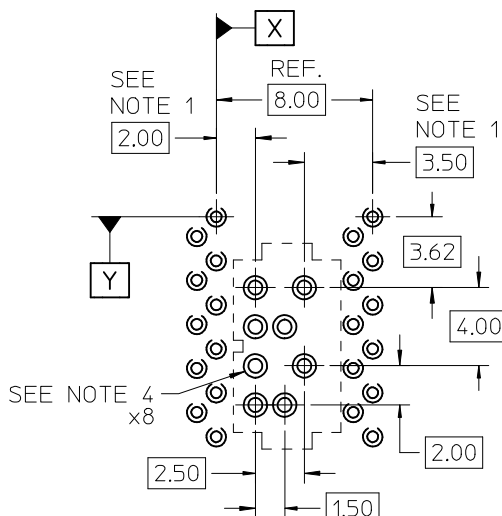

VHDM SINGLE ROW POWER

NOTES:

1. ADDITIONAL SPACING CAN BE ADDED IN MULTIPLES OF 2.0 mm AS REQUIRED. FOR EACH ADDITIONAL SINGLE ROW POWER, ADD 6.00 mm.
2. SIGNAL ROW A IS IN LINE WITH DATUM Y IN ALL FOUR LAYOUTS.
3. FOUR HOLES ARE USED PER POWER CONTACT.
4. EACH POWER HOLE TO BE MANUFACTURED AS FOLLOWS:

Ø0.725±0.075 PLATED THROUGH HOLE

Ø1.20 PAD

Ø0.838 DRILL

⊕ 0.10 X | Y

SEE SHEET 1 EC NO: UCP2013-0146 IDRWN: SVANG01 2012/07/12 CHKD: MWOLF 2012/07/12 APPR: SMILLER 2012/08/06	QUALITY SYMBOLS ▽=0 ▽=0 ▽=0	GENERAL TOLERANCES (UNLESS SPECIFIED)		DIMENSION STYLE MM ONLY		SCALE 4:1	DESIGN UNITS METRIC	THIRD ANGLE PROJECTION		
		mm	INCH	DRAWN BY ELO	DATE 2003/07/14	TITLE VHDM/HSD POWER 6 ROW BACKPLANE SALES DRAWING				
		4 PLACES ± --- ± ---	3 PLACES ± --- ± ---	CHECKED BY STANFORD	DATE 2003/07/17					
		2 PLACES ± 0.25 ± ---	1 PLACE ± 0.38 ± ---	APPROVED BY BIXLER	DATE 2003/07/21					
ANGULAR ±1/2°		DRAFT WHERE APPLICABLE MUST REMAIN WITHIN DIMENSIONS		MATERIAL NO. SEE TABLE		DOCUMENT NO. SD-74029-011	SHEET NO. 3 OF 3			
THIS DRAWING CONTAINS INFORMATION THAT IS PROPRIETARY TO MOLEX INCORPORATED AND SHOULD NOT BE USED WITHOUT WRITTEN PERMISSION										