



REED SWITCH DEVELOPMENTS CORP.

2524 Norwood Court

Racine, WI 53403

Ph: (262)883-9060

sales@reedswitchdevelopments.com

SPECIFICATION SHEET

2020-1710-100

Alternate Part Numbers:

AM2020-1710-10-01

3730-2020-1710-100-ND

Active / Equivalent Part Numbers:

2020-1710-100 - Magnetic Reed Sensor Only

AM2020-1710-10-01 - Magnetic Reed Sensor Only

3730-2020-1710-100-ND - Magnetic Reed Sensor Only

Sensor (Reed) - Specifications		1710
Physical	Configuration	SPDT
	Form	C
	Contact Position	OFFSET
	Glass L	32.89 mm
	Glass D	5.33 mm
	Total L*	85.98 mm
	Wire D	1.02 mm
	Gap Location	N/A
	Mount Spec*	THRU
	Contact Material	TUNGSTEN
	Max Vibration Resistance	N/A G
	Max Shock Resistance (11ms)	N/A G
	Lead Tensile Strength	N/A KG
Operating	Pull in (+/- 2AT)*	50 - 65 AT
	Drop out*	N/A AT
	Operate Time	4.00 ms
	Bounce Time	N/A ms
	Release Time	3.90 μs
	Resonant Frequency	N/A Hz
	Max Operating Frequency	N/A Hz
Electrical	Operating Temperature Range	-40 - 105 °C
	Storage Temperature	N/A °C
	DC Contact Rating	100 W
	AC Contact Rating	N/A VA
	DC Switching Voltage	120 VDC
	AC Switching Voltage	85 VAC
	DC Switching Current	3.00 A
	AC Switching Current	3.00 A
	DC Max Carry Current	3.60 A
	AC Max Carry Current	3.60 A
	Min Breakdown Voltage	150 VDC
	Max Initial Contact Resistance	500 mOhm
	Typical Initial Contact Resistance	N/A mOhm
Max Contact Capacitance	1.60 pF	
Min Insulation Resistance	10 ¹⁰ Ohm	

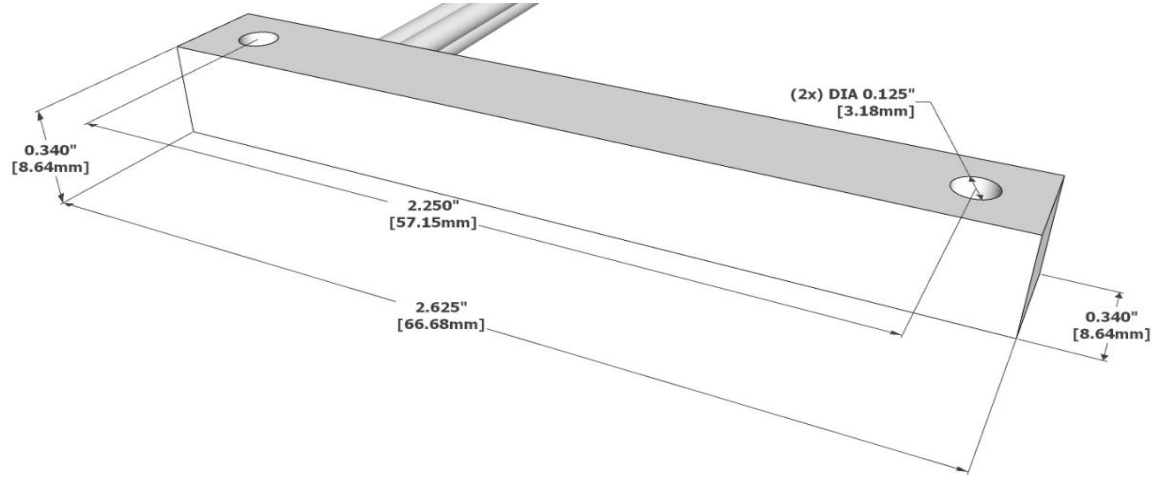

All measurements are in Inches [millimeters]

Sensor - Wire/Cable Characteristics (cont.)

Type	Wire
Conductor Count	3
Length	6.0"/152.4mm
Colors	RED, BLK, WHT
Insulation Material	PVC
Gauge	22 AWG
Stranded Copper	7 STR-TC
Maximum Temp	105°C

Conductor Configuration

Common (COM) - WHITE
Normally Open (NO) - RED
Normally Closed (NC) - BLACK

For More Information Visit:

www.reedswitchdevelopments.com

Or Call Us At:

262-883-9060

Housing Characteristics 2020

Rectangular w/ Mounting Holes	
Length	2.625"/66.68mm
Width	0.340"/8.64mm
Height	0.340"/8.64mm
Material	Celanex 3316

Standard Sensor/Actuator - Min. Actuation Distance

2020-4100-000	0.69"/17.5mm
---------------	--------------

Assembly Certifications

UL Recognized (File #: E102207)	Y
RoHS / Reach Compliant	Y
Conflict Free Material	Y

REV DATE: 04/20/2023

* Pre-processed, bare reed element

DISCLAIMER NOTICE: INFORMATION FURNISHED IS PROPRIETARY, AND IS BELIEVED TO BE ACCURATE AND RELIABLE, AND IS SUBJECT TO CHANGE WITHOUT NOTICE. IT SHALL BE THE RESPONSIBILITY OF THE BUYER TO ENSURE THAT THE GOODS ARE SUFFICIENT AND SUITABLE FOR THE PURPOSE OR PURPOSES INTENDED (WHETHER BY THE BUYER OR BY ANY THIRD PARTY) AND THAT THEIR CAPACITY AND PERFORMANCE IS NOT ADVERSELY AFFECTED BY ANY ITEMS USED IN THEIR INSTALLATION (WHERE RELEVANT) AND/OR IN CONNECTION WITH THEM.

MBE Certified - State of Wisconsin - MFR CAGE CODE: 32604

www.reedswitchdevelopments.com