

6

5

4

3

2

NOTES

1. MATERIALS:

HOUSING: POLYESTER UL 94V-0, COLOR: WHITE.  
STANDARD CONTACT: PHOSPHOR BRONZE.  
HIGH CURRENT CONTACT: BRASS.

2. FINISH:

STANDARD CONTACT: TIN-LEAD(Sn-Pb);  
THICKNESS=20 MICROINCH TO 80 MICROINCH.  
HIGH CURRENT CONTACT: SILVER; THICKNESS=200 MICROINCH,  
OVER NICKEL; THICKNESS=40 MICROINCH.

3. PRODUCT SPECIFICATION: NONE.

4. DIMENSIONS ARE FOR REFERENCE ONLY UNLESS INDICATED OTHERWISE.

5. HEADER ASSEMBLY MATES WITH: PLUG HOUSINGS .084/(2.13) DIS SERIES:(42021-\*\*).

6. CONTACTS ARE ON .250/(6.35) GRID CENTERLINE SPACING.

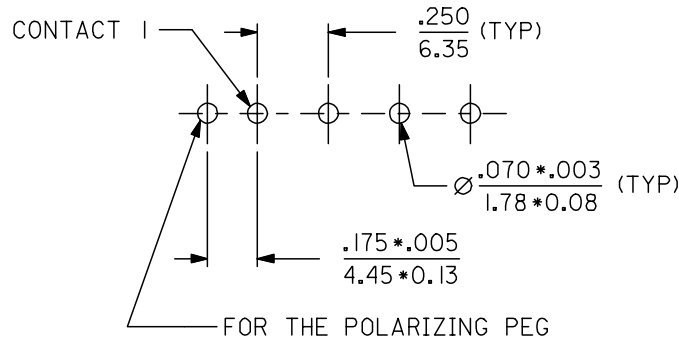
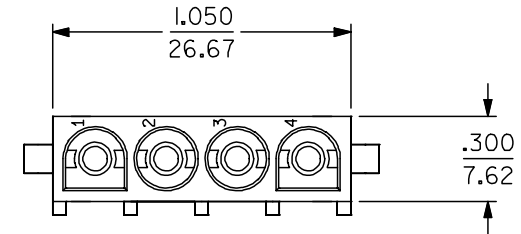

PCB LAYOUT: COMPONENT SIDE  
RECOMMENDED PCB THICKNESS: 0.062 / 1.57

LENGTH OF COMPLIANT POLARIZING PEG .200 / 5.08

HIGH CURRENT CONTACT (1 PLACE) STANDARD CONTACT (3 PLACES)

DD-MMM-YYYY  
HH:MM  
WORKAREA  
PLOT  
GRP###USERNAME##

EC No. I2004-0406  
DRWN: S.S 05/04/04  
CHK: G.L 05/04/04  
APPR: G.L 05/04/04

REV	DESCRIPTION	QUALITY SYMBOLS
MAJOR		▲ = 0
CRITICAL		▽ = 0

GENERAL TOLERANCES: (UNLESS SPECIFIED)	
mm	INCH
4 PLACES	±0.10
13 PLACES	±0.10
2 PLACES	±0.25
1 PLACE	±0.36
ANGULAR: ± 1/2°	

SCALE: 25:1  
DESIGN UNITS:  mm  INCH  
THIRD ANGLE PROJECTION:  THIRD ANGLE  FIRST ANGLE  
DRAWN BY & DATE: G.LOWE 22/10/99  
CHECKED BY & DATE: G.LOWE 22/10/99  
APPROVED BY & DATE: G.LOWE 22/10/99  
CAD FILENAME: S-3653701.S01

TITLE: HEADER ASSEMBLY  
.084 (2.13) SERIES  
COMPLIANT POLARIZING PEG  
MOLEX INCORPORATED  
MATERIAL NO. 36537-0001  
DRAWING No. SD-36537-001  
SHEET No. 1 OF 1  
DRAFT WHERE APPLICABLE MUST REMAIN WITHIN DIMENSIONS  
THIS DRAWING CONTAINS INFORMATION THAT IS PROPRIETARY TO MOLEX INCORPORATED AND SHOULD NOT BE USED WITHOUT WRITTEN PERMISSION.

5

4

3

2

1