

PRODUCT NUMBER

XXXXXXXX-YYHXLF

LEAD FREE

NONE= WITH TAPE(WITHOUT WATER PROOF BAG)
W= WITH TAPE(WITH WATER PROOF BAG)

HIGH TEMPERATURE PLASTIC
SEE NOTE 1

NO OF POSITIONS
SEE NOTE 3

PIN PLATING
SEE SHEET 2

BASE PART NO.

BERGSTRIPTM HEADER

NOTE 7

.100
2.54

.100
2.54

TYP < ! >

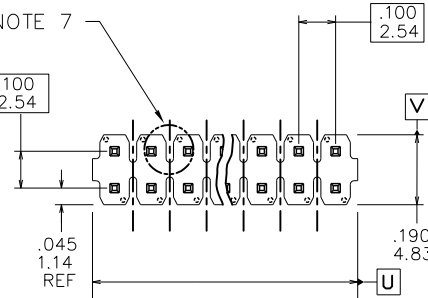

DOUBLE ROW TOP VIEW

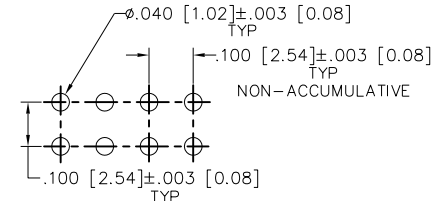

RECOMMENDED HOLE PATTERN

NOTE 8

NOTE 5

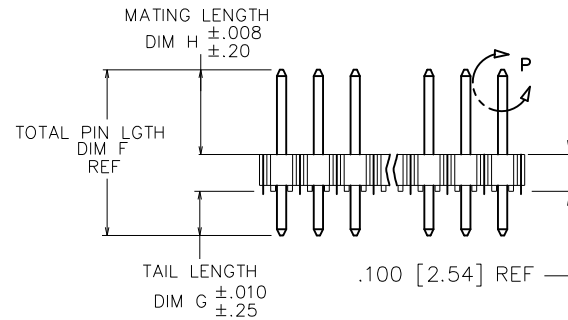

DOUBLE ROW SIDE VIEW

.0160 [.41]
REF TYP

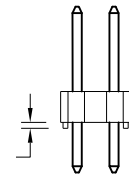

NOTE 6

DOUBLE ROW END VIEW

⌀ .020/0.51 (M) U M V S

NOTE 4

.025 [0.64] ± .001 [0.03]
TYP

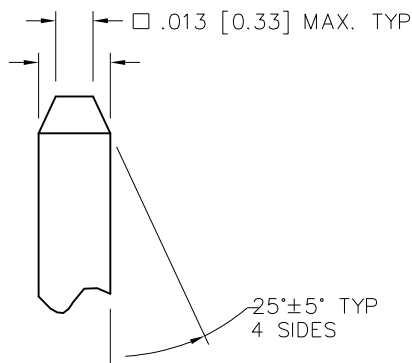

Mat'l. code NOTES 1 & 2		surface ISO 1302 ✓	tolerance ISO 406 ISO 1101	projection INCH/MM	product family BERGSTRIPTM
ltr	ecn no	dr	date	tolerances unless otherwise specified	
D	M06-0271	AGS	07/14/06	angles	linear
E	ELX-N-16988	ZK	02/19/14	linear	linear
F	ELX-N-32690	Mike	03/14/19	0°±2°	linear
		dr	T. BRUNGARD	11/4/04	title BERGSTRIPTM HDR. D/R .100/2.54cc STRAIGHT dwg no 10046593 sheet 1 of 2 size A3 type Product Customer Drawing
		enr	H. SUNDY	11/4/04	
		chr	H. SUNDY	11/4/04	
		appd	H. SUNDY	11/4/04	
sheet	revision	F	F		
index	sheet	1	2		

PRODUCT NUMBER	TOT. PIN LGTH.		TAIL LENGTH		MATING LENGTH		PACKAGING
	DIM F	DIM F	DIM G	DIM G	DIM H	DIM H	
	ENGLISH	METRIC	ENGLISH	METRIC	ENGLISH	METRIC	
10046593-XXXH	.695	17.65	.090	2.29	.505	12.83	REELS

PIN PLATING CODES:	
10046593-4XX	120u"/3.05u MIN 93/7 SnPb OVER 50u"/1.27u MIN Ni
10046593-4XXLF	100u"/2.54u MIN Sn OVER 50u"/1.27u MIN Ni

NOTES

- ① BODY MATERIAL : MANUFACTURER'S OPTION OF LCP OR PCT, GLASS FIBER REINFORCED, FLAME RETARDENT PER UL-94V-0. COLOR: BLACK
FOR HIGH-TEMPERATURE APPLICATIONS, SPECIFY AN "H" AT THE END OF THE PART NUMBER, AND PCT WILL BE SUPPLIED. BERGSTRIPTM PRODUCED WITH HIGH TEMPERATURE LCP THERMOPLASTIC, FLAME RETARDENT PER UL-94V-0. COLOR: BLACK
- ② PIN MATERIAL : BRASS.
- ③ -X00H INDICATES BERGSTRIPTM PRODUCT. SEE PAGE 1 FOR SPECIAL GEOMETRY OF THIS CONTINUOUS STRIP PRODUCT. AUTOMATED REELS WILL CONTAIN 20,000 PINS. SEE SPECIFIC PART NUMBERS FOR AVAILABILITY.
- ④ MEASURED WITH PART IN RESTRAINED CONDITION.
- ⑤ TWO SIDES OF PIN TIPS NOT PLATED. TYPICAL BOTH ENDS.
- ⑥ 2LBS/0.9KG MIN PIN RETENTION IN EITHER DIRECTION.
- ⑦ NOTCH CONFIGURATION WILL VARY PER VENDOR'S DISCRETION.
- ⑧ INDICATED SURFACES MUST BE PARALLEL TO DATUM -X- WITHIN ±4°
- 9. POSITIONS PER ROW 37 TO 50 CAN BE PRODUCED, BUT FLATNESS AND CURVATURE MAY NOT BE HELD AS CLOSE AS 36 POSITIONS. (MAKE FROM BERGSTRIPTM ONLY)
- 10. THIS <!> INDICATE CRITICAL DIMENSION FOR THIS DRAWING.

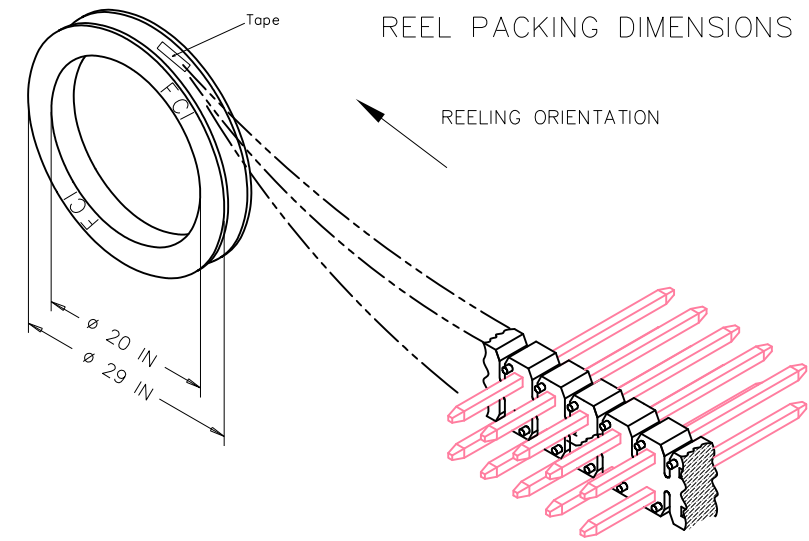

Mat'l. code NOTES 1 & 2	surface ISO 1302 ✓	tolerance ISO 406 ISO 1101	projection INCH/MM	product family BERGSTRIPTM
ltr ecn no dr date	tolerances unless otherwise specified		title BERGSTRIPTM HDR. D/R .100/2.54cc STRAIGHT	dwg no 10046593
F	angles linear	linear XX1.01/XX10.3 XXX1.005/XXX10.13 XXXX1.0020 XXX10.050	scale 1:1	sheet 2 of 2 size A3
	dr T. BRUNGARD	11/4/04	Amphenol FCI	type Product Customer Drawing
	enr H. SUNDY	11/4/04		
	chr H. SUNDY	11/4/04		
	appd H. SUNDY	11/4/04		
sheet index	revision sheet			