

REVISIONS			
REV	DESCRIPTION	DATE	APPROVED
A	INITIAL RELEASE	05/06/10	A.D.M.

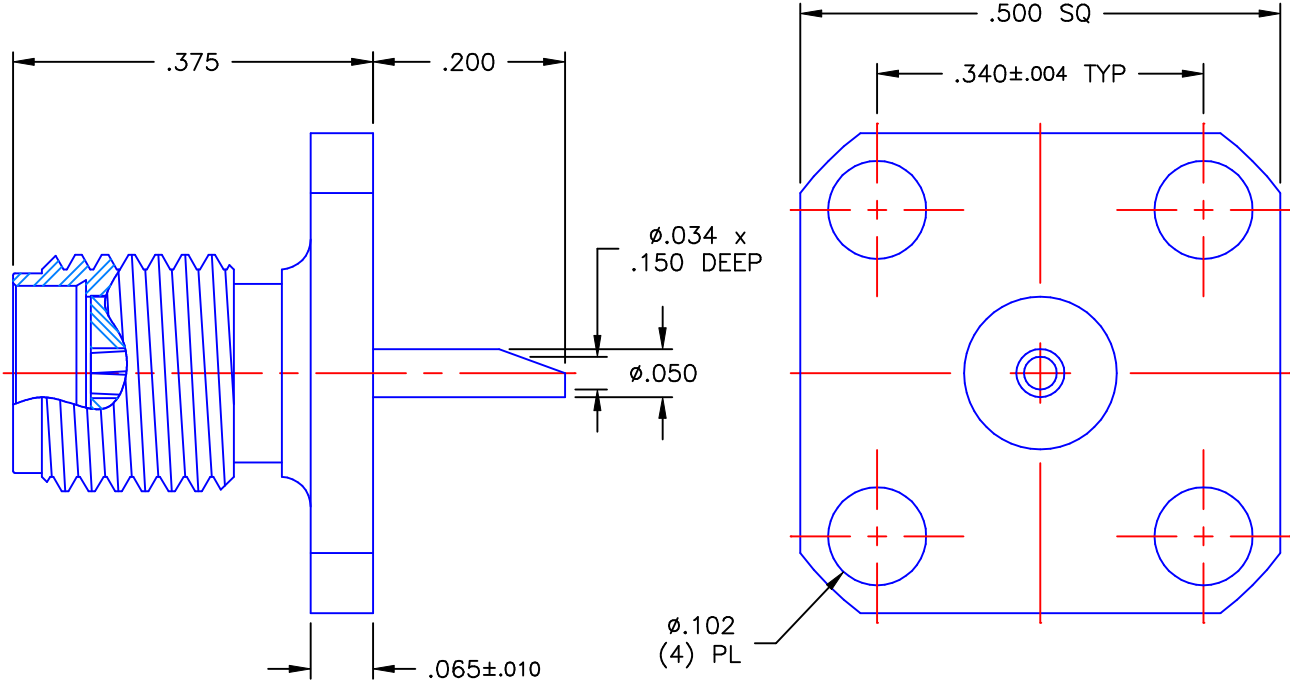

NOTES:

MATERIALS:

1. BODY = STAINLESS STEEL PER ASTM A582, ALLOY 303, CONDITION "A".
2. INSULATOR = VIRGIN WHITE TEFLON PER ASTM D1710, GRADE 1, TYPE I, CLASS "B".
3. CONTACT = BERYLLIUM COPPER PER ASTM B196, ALLOY C17300, TEMPER TD04.

FINISHES:

1. BODY = PASSIVATE PER QQ-P-35, TYPE VI.
2. CONTACT = GOLD PLATE PER MIL-G-45204, TYPE II, CLASS 1, GRADE C, OVER .00010 TO .00020 STRESS FREE SULFAMATE NICKEL PER QQ-N-290.

UNLESS OTHERWISE SPECIFIED DIMENSIONS ARE IN INCHES TOLERANCES ON	DWN:	DATE	
	A.D.M.	05/06/10	
	CHKD:	DATE	
DECIMAL	ANGLE	D.N.	05/06/10
		APVD:	DATE
		J.M.	05/06/10



Property of Radial  
This document cannot be reproduced or  
communicated to a third party without prior  
written permission of RADIAL.

SMA STRAIGHT JACK  
(4) HOLE FLANGE MOUNT  
SOLDER POT CONTACT

REFERENCE:	MATERIALS & FINISHES:
ORIGINATOR: A.D.M. DATE: 05/06/10	SEE NOTES

SIZE A	FSCM NO. 19505	DWG NO. 9404-9113-000	REV A
SCALE 5:1	THIRD ANGLE PROJECTION		SHEET 1 OF 1

9404-9113-000