

THIS COPY IS PROVIDED ON A RESTRICTED BASIS AND IS NOT TO BE USED IN ANY WAY DETRIMENTAL TO THE INTERESTS OF PANDUIT CORP.

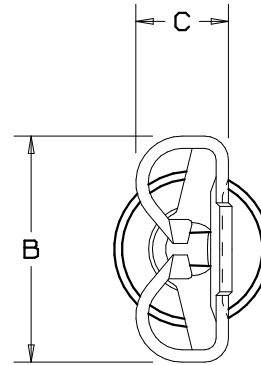
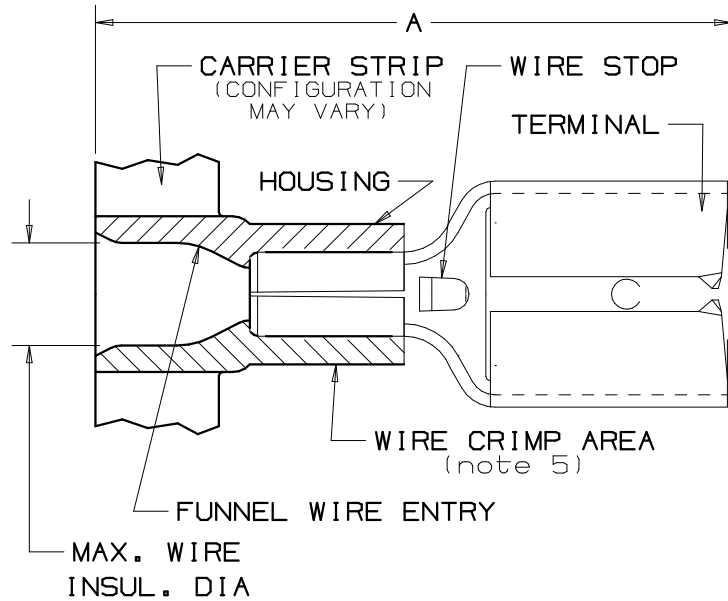

UL
LISTED*
20H3
E78522

CSA
CERTIFIED*
LR31212

		PANDUIT PRESS					
		CP-851 <i>DISCONTINUED</i>	CP-860 <i>DISCONTINUED</i>	CP-861	CP-862	CP-871 60HZ	CP-871/E 50HZ
APPLICATORS	CA-800		X	X			
	CA-800EZ	X				X	X
	CA9				X	X	X

PART NUMBER	TAB SIZE	WIRE RANGE mm (AWG)	COLOR	MAX. INSUL.	DIMENSIONS mm.		
					A ^{±.08} (.03)	B ^{±.03} (.01)	C ^{±.03} (.01)
DMV1-63B-3K	6,3 X 0,8 (.250 X .032)	5-1,0 (22-18)	RED	4,06 (.160)	21,1 (.83)	7,4 (.29)	3,0 (.12)
DMV1-488B-3K	4,8 X 0,8 (.187 X .032)	5-1,0 (22-18)	RED	4,06 (.160)	18,8 (.74)	5,8 (.23)	2,5 (.10)
DMV1-485B-3K	4,8 X 0,5 (.187 X .020)	5-1,0 (22-18)	RED	4,06 (.160)	19,3 (.76)	5,8 (.23)	2,5 (.10)
DMV2-63B-3K	6,3 X 0,8 (.250 X .032)	1,5-2,5 (16-14)	BLUE	4,52 (.178)	21,1 (.83)	7,4 (.29)	3,0 (.12)
DMV2-488B-3K	4,8 X 0,8 (.187 X .032)	1,5-2,5 (16-14)	BLUE	4,52 (.178)	19,6 (.77)	5,3 (.23)	2,5 (.10)
DMV2-485B-3K	4,8 X 0,5 (.187 X .020)	1,5-2,5 (16-14)	BLUE	4,52 (.178)	19,6 (.77)	5,3 (.23)	2,5 (.10)
DMV6-63-2K*	6,3 X 0,8 (.250 X .032)	4,0-6,0 (12-10)	YELLOW	5,84 (.230)	24,1 (.95)	7,4 (.29)	3,0 (.12)

NOTES:

- UL LISTED AND CSA CERTIFIED FOR:
 - A. 600V MAX VOLTAGE RATING
 - B. 105°C (221°F) MAX TEMP RATING
 - C. AWG STRANDED COPPER WIRE ONLY
 - D. 26.4-53.7N INITIAL INSERTION/WITHDRAWAL FORCE
- PACKAGE QTY:
 - 2K=2000 PIECES, 3K=3000 PIECES
 - CONTINUOUS MOLDED STRIP CARRIER
- MATERIAL:
 - A. STAMPING-CDA 260 BRASS, TIN PLATED
 - B. HOUSING-PVC
- DIMENSIONS IN BRACKETS ARE IN INCHES
- PART NUMBER DMV6-63 IS CONSTRUCTED WITH BRASS SLEEVE IN WIRE CRIMP AREA
- WIRE STRIP LENGTH 7,1^{+.08}₋₀ (9/32^{+.1/32}₋₀) FOR DV6-63-2K) (8,7^{+.08}₋₀ (11/32^{+.1/32}₋₀) FOR DV6-63-2K)

* DMV6-63-2K NOT UL LISTED OR CSA CERTIFIED

A41623_03

03	3/06	DAW	DAW	ADDED PANDUIT PRESS & APPLICATOR CHART	TRO0083			<p>TINLEY PARK, ILLINOIS</p> <p>METRIC DISCO-FEMALE DISCONNECTS, VINYL INSULATED 6,3 X 0,8 4,8 X 0,8/0,5</p>
02	2/05	KLFU	SKB	ADDED CP-862, CD9 & CA9 TO CHART				
01	7/98	TM	RLS	UPDATED WIRE RANGES AND PART NUMBERS	07035	DH	LA	
00	9/97	TM	WB	RELEASED	6192	DH	LA	
REV	DATE	BY	CHK	DESCRIPTION	ECN	PM	APP	DRAWN BY: TSM CHK'D: WB SCALE: NONE DRAWING NO./CAD FILENAME: A41623