

6

5

4

3

2

1

D

D

C

C

B

B

A

A

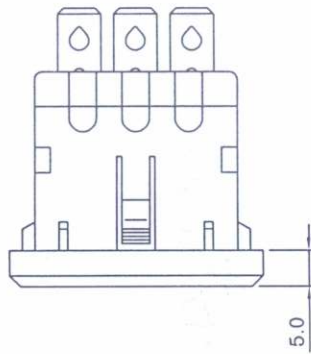

5.0

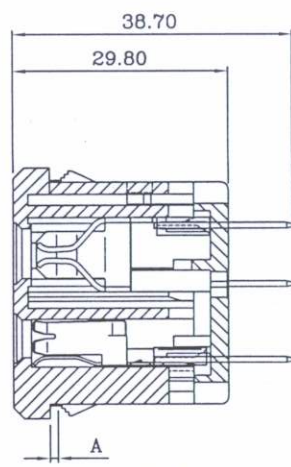
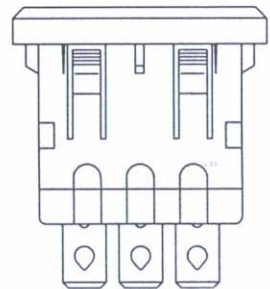
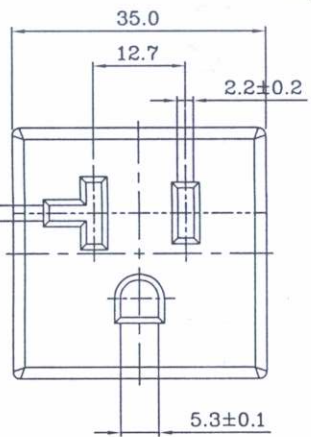

B-B

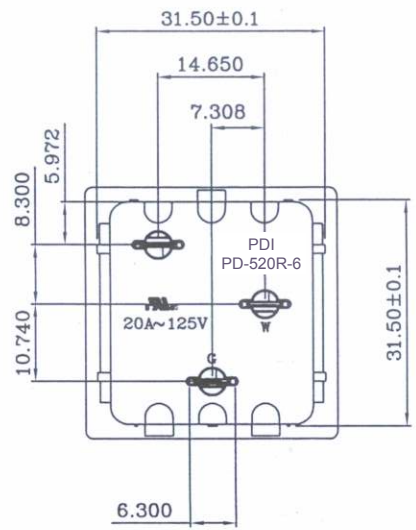

PDI
PD-520R-6

20A~125V

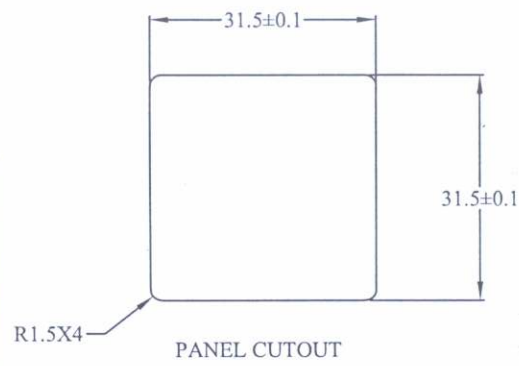

PANEL CUTOUT

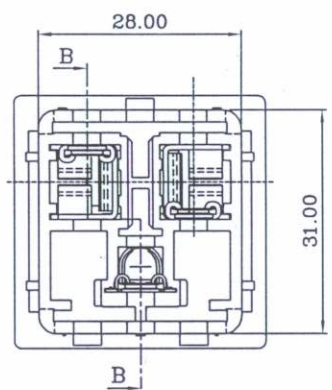

MATERIAL:
 Housing & Back Cover: Nylon, UL-94V-0 color black
 Contacts: Copper alloy

ELECTRICAL SPECIFICATIONS:
 Rated current & voltage: 20A 125VAC

APPROVALS: 

RoHS
COMPLIANT

REVISIONS	CHNG	CHK	APPR
REV	DATE	BY	

TOLERANCE UNLESS OTHERWISE SPECIFIED	
X	± 1
X.X	± 0.4
X.XX	± 0.20
DRAWN BY	PB
DATE:	4/14/09
CHECK BY	
DATE:	
APPR BY	
DATE:	

Power Dynamics, Inc.

Phone: 973 560-0019 Whippany, New Jersey Fax: 973 560-0076

PART: NEMA 5-15R / 5-20R; 6.4 Q.C. TAB
SNAP IN PANEL MOUNT RECEPTACLE

PART #: PD-520R-6		SHEET 1 of 1
SIZE: A	ALL DIMENSIONS FOR REFERENCE ONLY DIMENSIONS ARE IN MILLIMETERS	
SCALE: NTS		REV:

6

5

4

3

2

1