

REVISIONS			
REV.	ECN, ERN NO.	DATE	APPRD.
A	PROPOSAL	AUG.31/15	L.CHAN
B	ADD MYLAR TAPE NOTES PER EAR# RJ18006	JAN.23/18	L.CHAN

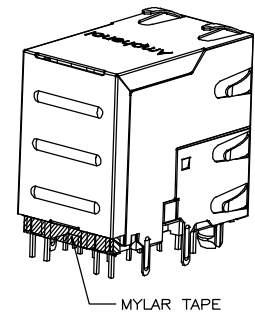

CONNECTOR AXONOMETRIC VIEW

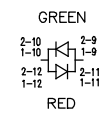

BI-COLOUR LED DETAIL  
(GREEN/YELLOW, RED/YELLOW AND GREEN/ORANGE ARE ALSO AVAILABLE)

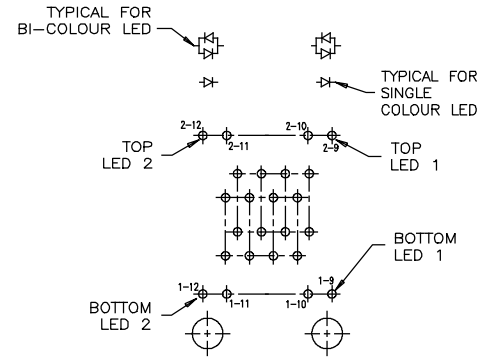

LED SCHEMATIC

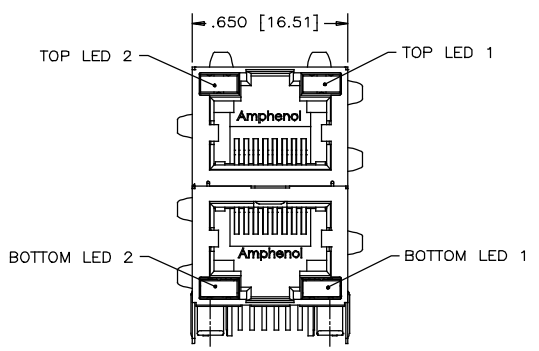

FRONT VIEW

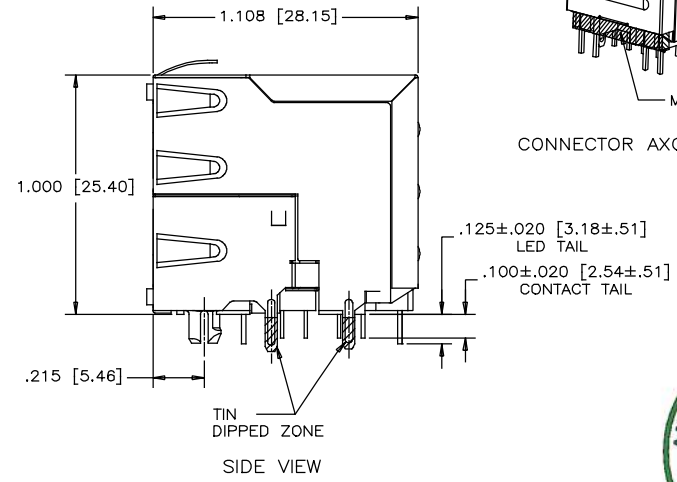

SIDE VIEW

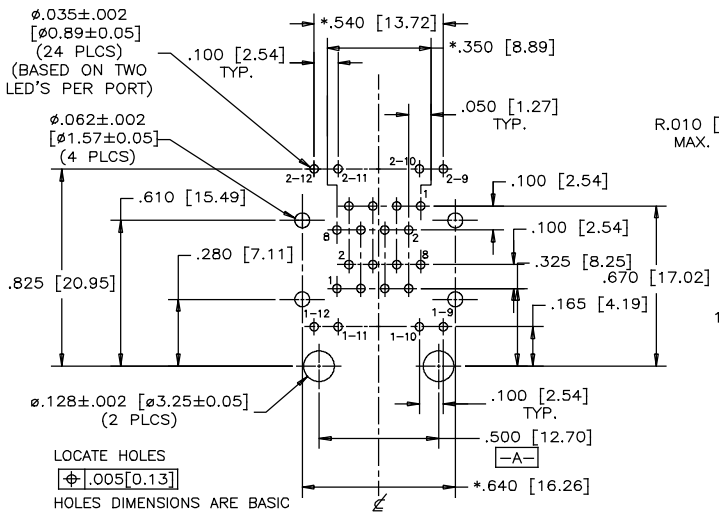

RECOMMENDED P.C.B. LAYOUT  
(COMPONENT SIDE OF BOARD)

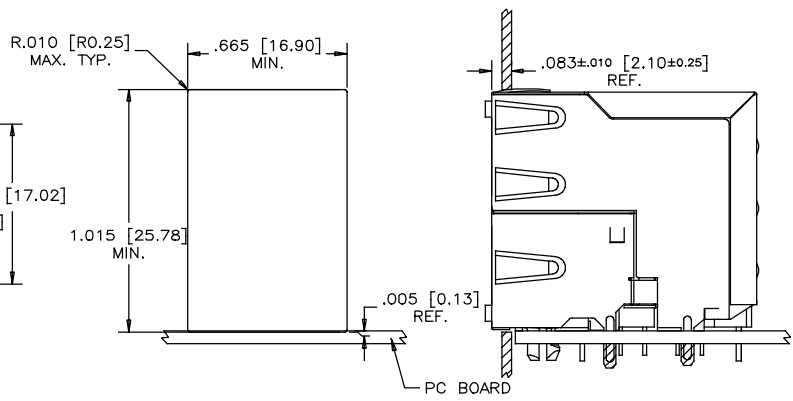

RECOMMENDED PANEL CUTOUT

**MATERIALS:**

**CONTACTS:** PHOSPHOR BRONZE, SELECTIVELY PLATED GOLD PLATING ON MATING AREAS REFER TO AMPHENOL PART NO. 50 MICROINCHES MIN. NICKEL OVERALL. 100 MICROINCHES MIN. MATTE TIN OR GOLD FLASH ON TAILS.

**HOUSING:** ENGINEERING PLASTIC. FLAMMABILITY RATING UL 94V-0, BLACK

**SHIELD:** COPPER ALLOY. PLATING: NICKEL WITH TIN DIPPED PCB TAILS.

**MYLAR TAPE:** POLYESTER FILM. 0.06MM THICKNESS.

**RECOMMENDED SOLDERING TEMPERATURE:**

WAVE SOLDERING AT 260°C MAXIMUM FOR 5 SEC MAXIMUM

AMPHENOL PART NO.: RJSAE-X38X-02X

GOLD PLATING OPTION:  
D=6u" GOLD PLATING  
C=15u" GOLD PLATING  
J=30u" GOLD PLATING  
5=50u" GOLD PLATING

REFER TO LED OPTIONS DRAWING FOR ORDERING CODES

DIMENSIONS MARKED WITH \* ARE SYMMETRICAL ABOUT CENTER LINE AS DEFINED BY DATUM -A-

UNLESS SPECIFIED OTHERWISE	DRAWN JACK.GUO	AUG31/15
PRIMARY UNITS INCHES	CHECKED	
SECONDARY MILLIMETERS	M.E. APP'D	
REFERENCE IN PARENTHESES	Q.A. APP'D	
	DWG APP'D L.CHAN	AUG31/15
	ENG. REL NO.	
1 DECIMAL PLACE	REF.	
2 DECIMAL PLACES		
3 DECIMAL PLACES ±0.015		
ANGULAR DEGREES ±1.5°		
	THIRD ANGLE PROJECTION	DO NOT SCALE DRAWING

Amphenol Canada Corp.  
www.amphenolcanada.com

STACKABLE 2x1 PORT MODULAR JACK,  
8 POSITION, 8 CONTACTS, WITH LEDS,  
SHIELDED- RoHS COMPLIANT

DWG NO.	P-RJSAE-X38X-02X	REV	B
CODE ID NO.	03554	DWG SIZE	SCALE
SHEET 1 OF 1			

REVISIONS			
REV	DESCRIPTION, ECN, EAR NO.	DATE	APP'D
H	PROPOSAL	JUL04/12	L.CHAN
J	PROPOSAL	MAR03/14	L.CHAN
K	ADD NEW COLOR OPTION	FEB09/17	L.CHAN
L	REPLACE THE DRAWING FRAME	JUL06/18	L.CHAN

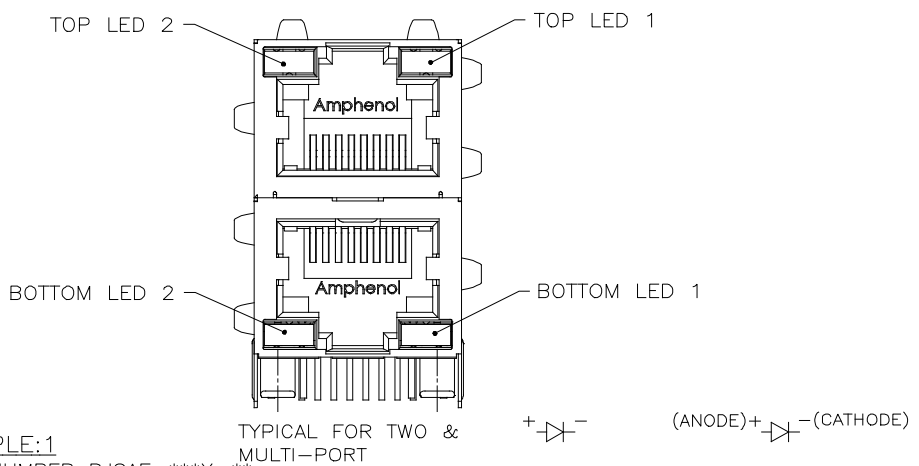

**LED SPECIFICATIONS:**  
 FORWARD VOLTAGE: 2.1 VOLTS TYP.  
 REVERSE VOLTAGE: 5.0 VOLTS MIN.  
 LUMINOUS INTENSITY: 0.5 mCd MIN.  
 (AT If=2mA)  
 STORAGE TEMPERATURE: -20° TO 85° C  
 PLATING ON TAILS: TIN OR TIN/COPPER ALLOY OVER SILVER

PRIMARY COLOR FOR BI-COLOR LEDS IN STANDARD ANODE/CATHODE CONFIGURATION IS:  
 RED-GREEN= RED  
 RED-YELLOW= RED  
 GREEN-YELLOW= GREEN  
 GREEN-ORANGE= GREEN



**LEGEND**  
 BiC=BI-COLOR LED  
 LOWC=LOW CURRENT LED  
 YE=YELLOW  
 GR=GREEN  
 RD=RED  
 OR=ORANGE

**NOTES:**  
 1. THE TWO DIGITS PRECEDING THE ADDITIONAL LED CODE MUST BE USED IN THE PART NUMBER, WHEN ORDERING ANY OF THE ADDITIONAL LED OPTIONS.  
 2. '\*' REPRESENT DIFFERENT OPTION OF CONNECTOR, DETAIL OPTION PLEASE SEE RELEVANT CONNECTOR DRAWING.

**EXAMPLE:1**

PART NUMBER RJS AE-\*\*\*X-\*\*  
 SEE NOTE 2 (pointing to first three asterisks)  
 SEE NOTE 2 (pointing to X)  
 SEE NOTE 2 (pointing to last two asterisks)  
 LED COLOR CODE

**EXAMPLE:2**

PART NUMBER RJS AE-\*\*\*U-\*\*-XX  
 SEE NOTE 2 (pointing to first three asterisks)  
 SEE NOTE 2 (pointing to U)  
 SEE NOTE 2 (pointing to last two asterisks)  
 SEE NOTE 2 (pointing to XX)  
 SPECIAL CODE FOR TOP & BOTTOM LEDS CONFIGURATION  
 BOTTOM ASSY LED (SAME AS STD CODE)  
 TOP ASSY LED (SAME AS STD CODE)

CODE	LED 2 (LEFT)	LED 1 (RIGHT)	CODE	LED 2 (LEFT)	LED 1 (RIGHT)	CODE	LED 2 (LEFT)	LED 1 (RIGHT)
0	BLOCKED	BLOCKED	9	GREEN	BLOCKED	J	BiC RD/GR	YELLOW
1	YELLOW	GREEN	A	BiC GR/YE	BiC GR/YE	K	YELLOW	BiC GR/OR
2	BLOCKED	GREEN	B	BiC RD/GR	BiC RD/GR	L	BiC GR/YE	RED
3	YELLOW	BLOCKED	C	BiC RD/GR	BiC GR/YE	M	RED	YELLOW
4	GREEN	YELLOW	D	GREEN	BiC GR/YE	N	BiC GR/RD	BiC GR/YE
5	GREEN	GREEN	E	YELLOW	BiC GR/YE	P	GREEN	BiC RD/GR
6	YELLOW	YELLOW	F	BiC GR/YE	YELLOW	R	BiC GR/OR	GREEN
7	RED	GREEN	G	BiC GR/OR	BiC GR/OR	T	RED	RED
8	GREEN	RED	H	BiC GR/YE	GREEN	V	BiC RD/GR	GREEN
						W	ADDITIONAL OPTIONS	
						U	SPECIAL CODE FOR TOP & BOTTOM LEDS CONFIGURATION	

**EXAMPLE:3**

PART NUMBER RJS AE-\*\*\*W-\*\*X  
 SEE NOTE 2 (pointing to first three asterisks)  
 SEE NOTE 2 (pointing to W)  
 SEE NOTE 2 (pointing to last two asterisks)  
 ADDITIONAL LED COLOR CODE  
 DENOTES ADDITIONAL LED OPTIONS TO BE USED

CODE	LED 2 (LEFT)	LED 1 (RIGHT)	CODE	LED 2 (LEFT)	LED 1 (RIGHT)	CODE	LED 2 (LEFT)	LED 1 (RIGHT)
0	DO NOT USE		5	BLOCKED	YELLOW	A	LOWC YE	LOWC YE
1	RED	BLOCKED	6	RED	BiC RD/GR	B	LOWC YE	LOWC GR
2	BiC GR/OR	YELLOW	7			C	LOWC GR	LOWC YE
3	YELLOW	RED	8	BiC RD/GR	BLOCKED	D	LOWC GR	LOWC GR
4	BLOCKED	RED	9	BiC GR/YE	BLOCKED	M	LOWC RD	LOWC YE
						N	GREEN	BiC GR/OR
						E	GREEN	ORANGE
						F	ORANGE	GREEN
						G	BiC YE/GR	BiC YE/GR
						P	BiC RD/YE	GREEN
						R	BiC RD/YE	BiC RD/YE
						T	BiC GR/YE	BiC RD/GR
						H	BLUE	RED

**EXAMPLE:4**

PART NUMBER RJS AE-\*\*\*X-\*\*\*X\*  
 SEE NOTE 2 (pointing to first three asterisks)  
 SEE NOTE 2 (pointing to X)  
 SEE NOTE 2 (pointing to last three asterisks)  
 LED COLOR CODE THE SAME AS EXAMPLE 1, 2, 3  
 LED COLOR CODE THE SAME AS EXAMPLE 1, 2, 3

UNLESS SPECIFIED OTHERWISE	DRAWN PAUL WANG	JUL22/05	Amphenol Canada Corp. Commercial Products
PRIMARY UNITS	CHECKED LAWRENCE	JUL22/05	
SECONDARY	M.E. APP'D		LED OPTIONS FOR RJS AE, MULTI-PORT CONNECTORS - RoHS COMPLIANT
REFERENCE IN PARENTHESES	Q.A. APP'D		
GENERAL TOLERANCES	DWG APP'D		DWG NO. P-RJS AE-LEDS
1 DECIMAL PLACE	ENG. REL NO.		
2 DECIMAL PLACES	REF.		CODE ID NO. 03554   DWG SIZE N/A   SCALE N/A   SHEET 1 OF 1
3 DECIMAL PLACES			
ANGULAR DEGREES	THIRD ANGLE PROJECTION	DO NOT SCALE DRAWING	REV L