

SIDE VIEW OF BOX

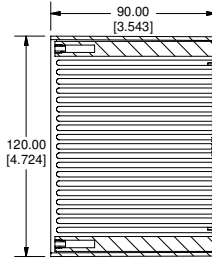

SECTION B-B

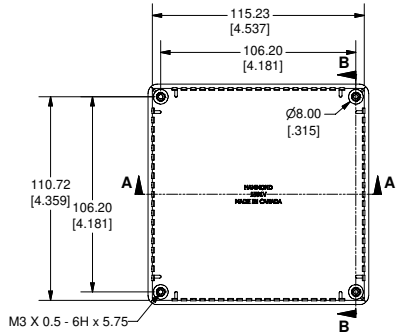
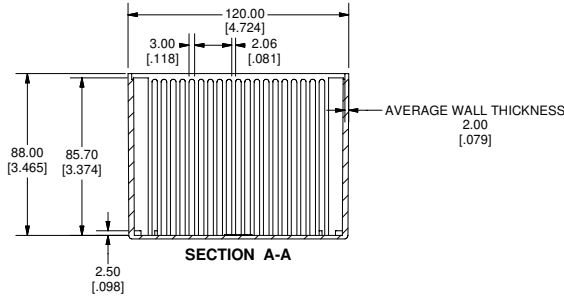

SECTION A-A

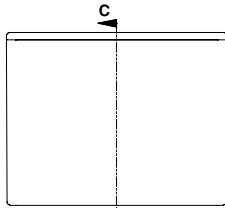

END VIEW OF ASSEMBLY

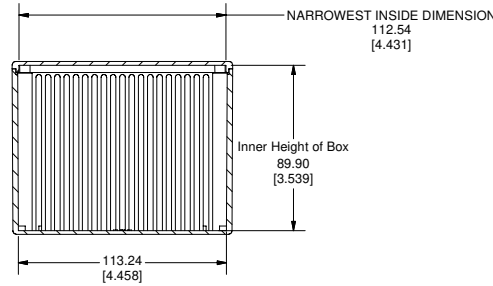

SECTION C-C

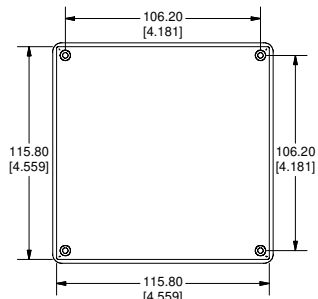

BOTTOM OF LID

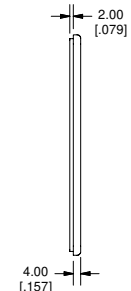

SIDE VIEW OF LID

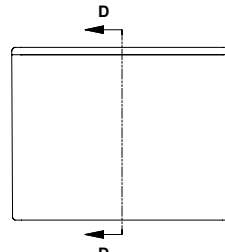

SIDE VIEW OF ASSEMBLY

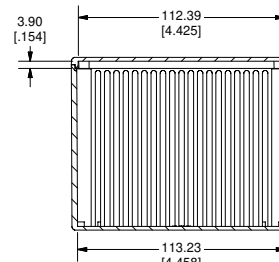

SECTION D-D

Note:
Enclosures can be Factory Modified (Milling, Drilling, Printing etc.)
Contact Factory mjm@hammondmfg.com for quotes
Solid models of this enclosure available in STEP or IGES Format.

PART NUMBERS		
1591V Enclosures		
Material	Colour	Part Number
FR ABS UL94 - V0	Beige	1591VBG
	Black	1591VBK
	Blue	1591VBU
	Grey	1591VGY
GP ABS	Black	1591VSBK
	Grey	1591VSGY
Accessories		
	Description	Part Number
Universal Use	PC Board Card Adapters	See Accessories Section
	Clear Lids - clear, flame retardant polycarbonate - Lid ONLY	1591VC
FR ABS	Replacement Screws, Flat Head Phillips Nickel Plated Pkg of 100	1591MS100 1591MS100BK (Black)
	Self Tapping Pkg of 100	1591TS100 1591TS100BK (Black)
Recommended Torque on Fasteners (no lubrication)		
	M3 - 0.5 x 10mm Screws	30-40 cN*m
	#4 x 0.5 Screws	30-40 cN*m

