

Coupling - VS-PPC-F2-MSTB-POBK-1R-SPSB5 - 1608304

Please be informed that the data shown in this PDF Document is generated from our Online Catalog. Please find the complete data in the user's documentation. Our General Terms of Use for Downloads are valid (<http://download.phoenixcontact.com>)



MSTB panel mounting frame, IP67, for push-pull interlocking, plastic, with integrated contact insert for conductor connection, spring-cage connection, 400 V, for square mounting cutout, with grommet, without mounting screws



Key commercial data

Packing unit	1 1
Weight per Piece (excluding packing)	21.0 GRM
Custom tariff number	85366990
Country of origin	Germany

Technical data

Mechanical characteristics

Number of positions	5
Connection profile	MSTB
Locking type	Push Pull
Insertion/withdrawal cycles	≥ 100
Connection method	Spring-cage conn.
Conductor cross section	0.75 mm ² ... 2.5 mm ²
Connection cross section AWG	18 ... 13
Cable exit	Straight
Color	black

Ambient conditions

Ambient temperature (operation)	-40 °C ... 70 °C
Degree of protection	IP65/67

Material data

Inflammability class according to UL 94	V0
Housing material	PA-GF

Coupling - VS-PPC-F2-MSTB-POBK-1R-SPSB5 - 1608304

Technical data

Material data

Contact carrier material	PA
Contact material	Copper alloy
Contact surface material	Gold over nickel
Material	Plastic
Sealing material	NBR
Seal material	NBR

Electrical characteristics

Number of positions	5
Nominal voltage U_N	400 V
Nominal current I_N	16 A
Rated current	16 A (at 20 °C)
Pollution degree	2

Classifications

eCl@ss

eCl@ss 4.0	27250313
eCl@ss 4.1	27250313
eCl@ss 5.0	27143423
eCl@ss 5.1	27143423
eCl@ss 6.0	27143423
eCl@ss 7.0	27449001
eCl@ss 8.0	27449001

ETIM

ETIM 3.0	EC001134
ETIM 4.0	EC002636
ETIM 5.0	EC002636

UNSPSC

UNSPSC 6.01	31261501
UNSPSC 7.0901	31261501
UNSPSC 11	31261501
UNSPSC 12.01	31261501
UNSPSC 13.2	31261501

Coupling - VS-PPC-F2-MSTB-POBK-1R-SPSB5 - 1608304

Approvals

Approvals

Approvals

GOST

Ex Approvals

Approvals submitted

Approval details

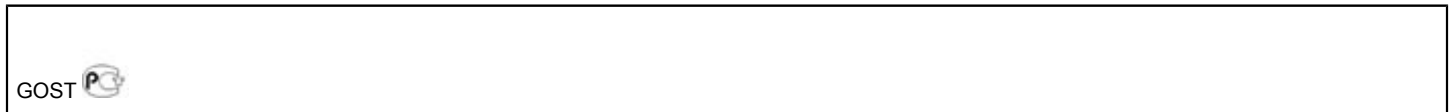

Drawings

Dimensioned drawing

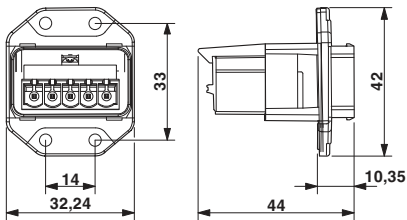

Push-Pull MSTB panel mounting frame

Dimensioned drawing

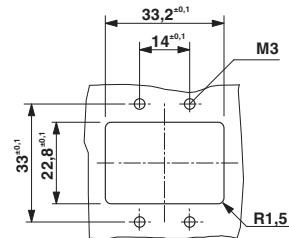

Panel cutout