

| REVISIONS |     |                           |           |     |      |
|-----------|-----|---------------------------|-----------|-----|------|
| P         | LTR | DESCRIPTION               | DATE      | OWN | APVD |
| A3        |     | REVISED PER ECO-20-013368 | 24SEP2020 | RZ  | HL   |

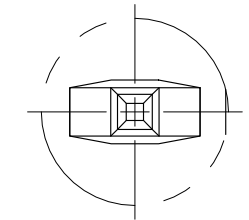

DETAIL Z  
SCALE 20:1

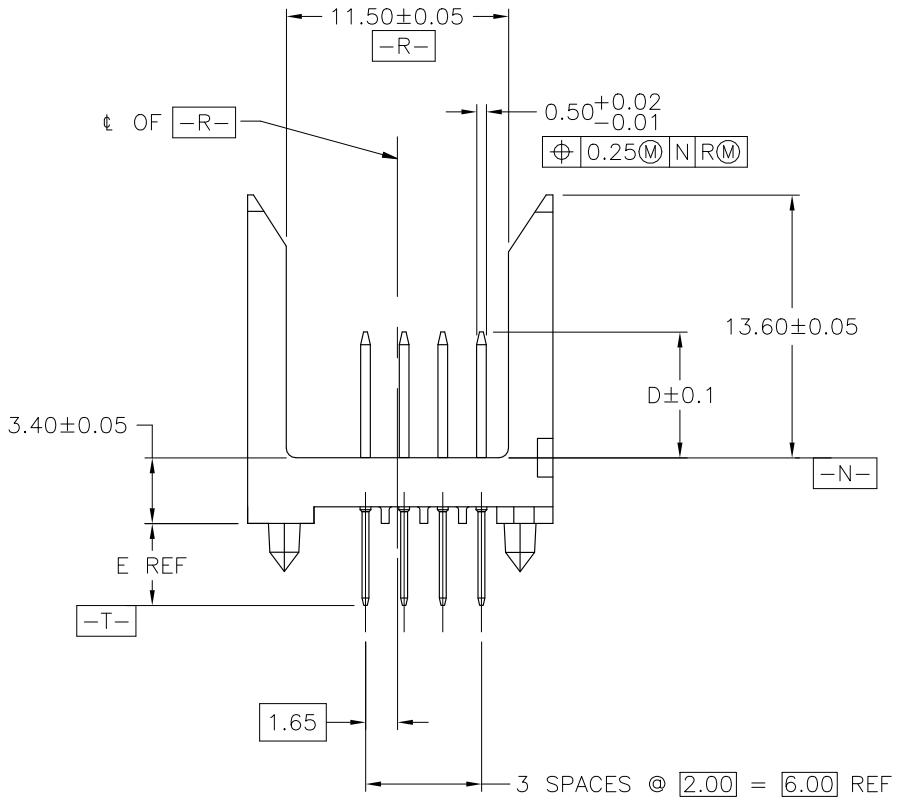
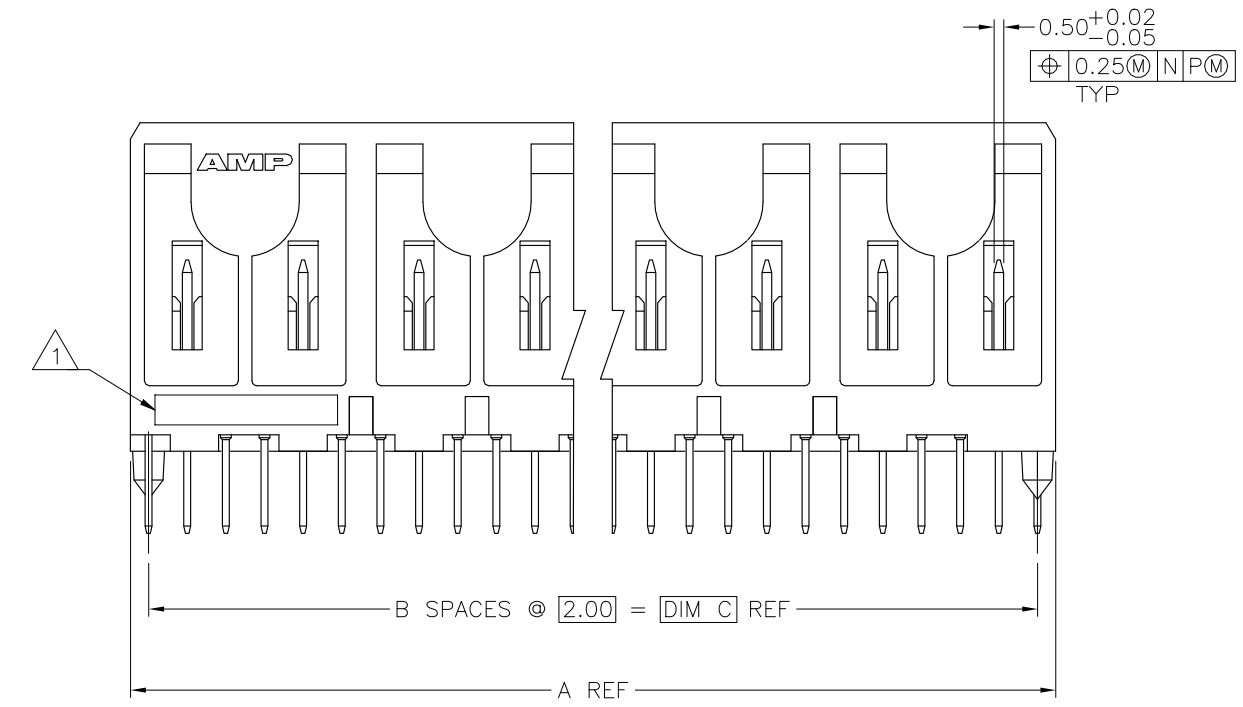
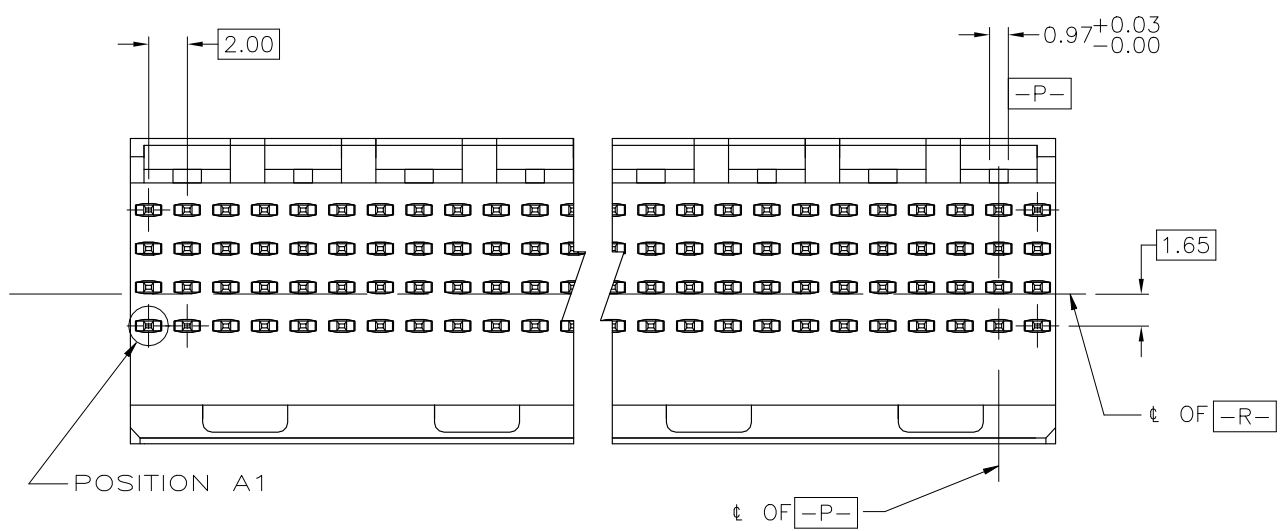
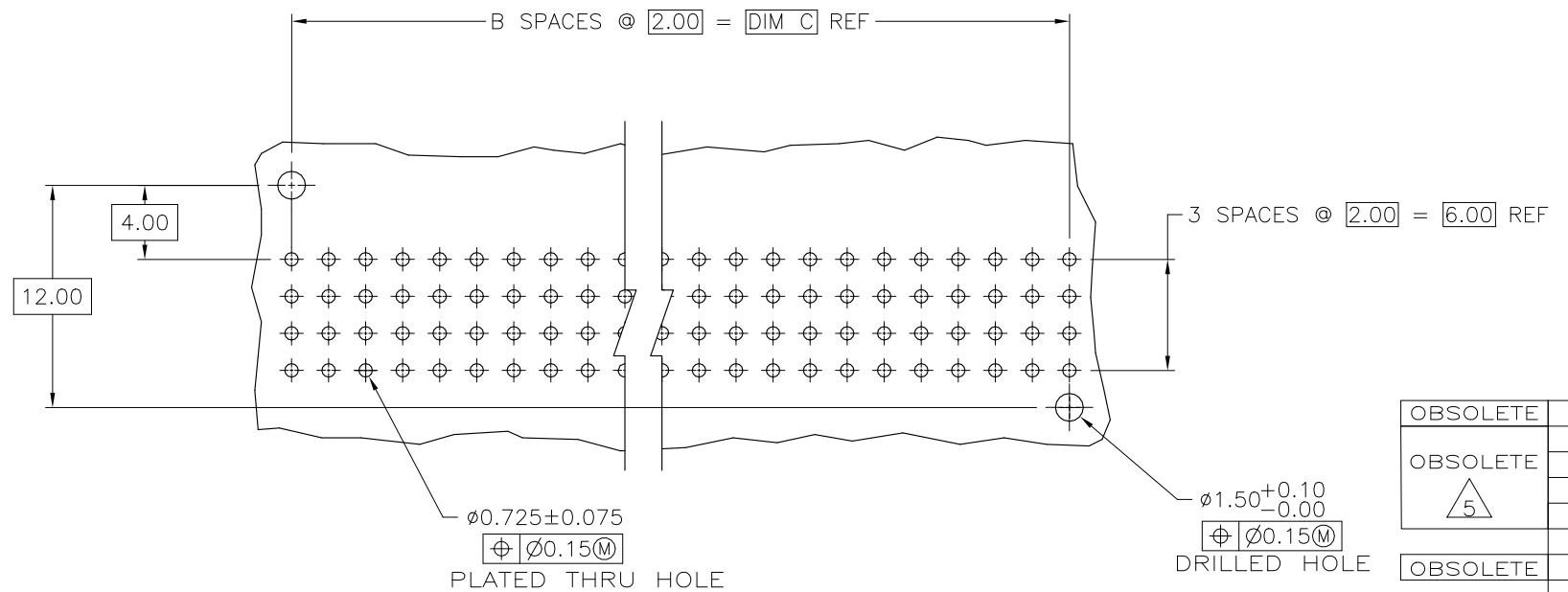
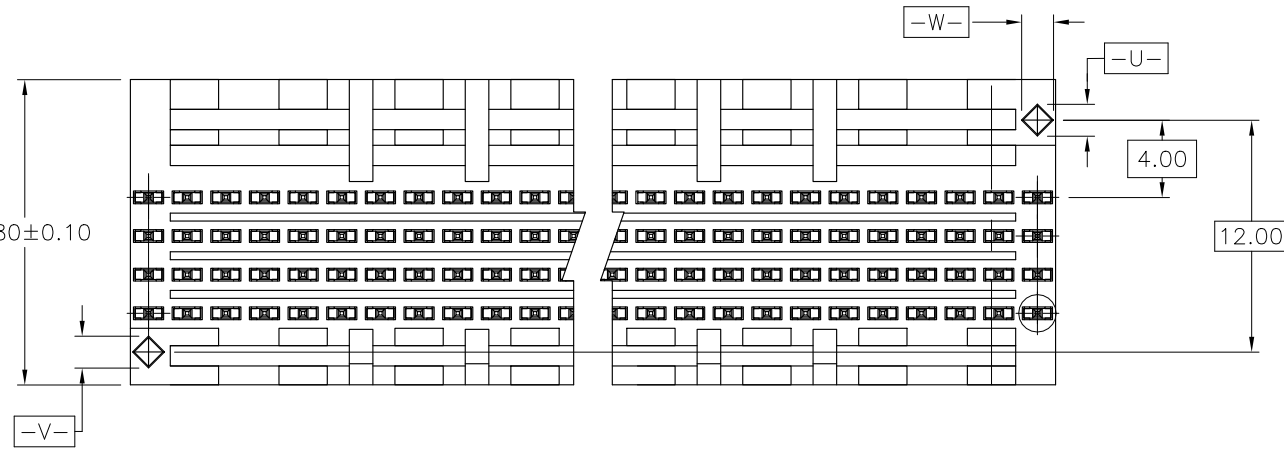

RECOMMENDED CIRCUIT PATTERN  
PER IPC-D300 TYPE II, CLASS C  
(COMPONENT SIDE)

- 1 HOUSING MATERIAL: LIQUID CRYSTAL POLYMER PER ASTM D5138 LCPO00 G30A 32250.
- 2 CONTACT MATERIAL: PHOSPHOR BRONZE.
- 3 CONTACT FINISH:  
UNDERPLATE (ENTIRE CONTACT):  
0.00127 MIN NICKEL PER SAE-AMS-QQ-N-290.  
ON MATING SURFACES:  
CONFORMS TO ALL TESTING SPECIFIED FOR TELCORDIA UNCONTROLLED ENVIRONMENT.  
ON LEADS  
0.00381 MIN TIN PER ASTM B 545 OVER UNDERPLATE.  
LUBRICATION (MIN MATING SURFACES):  
SURFACE CONDITIONER AFTER PLATING.
- 4 PART MARKING, LOCATED APPROXIMATELY AS SHOWN.
- 5 OBSOLETE PARTS: OBSOLETE CIS STREAMLINING PER D.RENAUD/D.SINISI

| OBsolete               | E | D | C | B | A | FINISH | NO OF POSN | PART NUMBER |
|------------------------|---|---|---|---|---|--------|------------|-------------|
| 4.25 6.5 34 17 35.88   |   |   |   |   |   | 3      | 72         | 1-5536501-1 |
| 4.25 6.5 130 65 131.88 |   |   |   |   |   | 3      | 264        | 1-5536501-0 |
| 4.25 6.5 106 53 107.88 |   |   |   |   |   | 3      | 216        | 5536501-9   |
| 4.25 6.5 118 59 119.88 |   |   |   |   |   | 3      | 240        | 5536501-8   |
| 4.25 6.5 82 41 83.88   |   |   |   |   |   | 3      | 168        | 5536501-7   |
| 4.25 6.5 58 29 59.88   |   |   |   |   |   | 3      | 120        | 5536501-6   |
| 4.25 6.5 70 35 71.88   |   |   |   |   |   | 3      | 144        | 5536501-5   |
| 4.25 6.5 94 47 95.88   |   |   |   |   |   | 3      | 192        | 5536501-4   |
| 4.25 6.5 46 23 47.88   |   |   |   |   |   | 3      | 96         | 5536501-3   |
| 4.25 6.5 22 11 23.88   |   |   |   |   |   | 3      | 48         | 5536501-2   |
| 4.25 6.5 10 5 11.88    |   |   |   |   |   | 3      | 24         | 5536501-1   |

THIS DRAWING IS A CONTROLLED DOCUMENT.

OWN: B. MCMASTER 30AUG04  
CHK: R. WERTZ 30AUG04  
APVD: R. WERTZ 30AUG04

TE Connectivity

Z-PACK 2mm FB, SIGNAL MODULE, PIN ASSEMBLY  
2mm

APPLIC. SPEC: PRODUCT SPEC

SIZE: A1 CAGE CODE: 00779 DRAWING NO: 5536501

WEIGHT: 0.000000

CUSTOMER DRAWING

SCALE: 4:1 SHEET: 1 of 1 REV: A3